



VALZANIA/SWARTZ RESIDENCE
27 MERRILL STREET
PORTLAND, MAINE



SRL Architects
Bethel Portland

93 Pitt Street
Portland, Maine 04103
207.747.5975 voice/fax

822 Grover Hill Rd.
Bethel, ME 04217
207.824.7237 voice/fax

info@smithreuter.com

DEMOLITION
FOUNDATION PLAN

4-5-16

287-1

A1

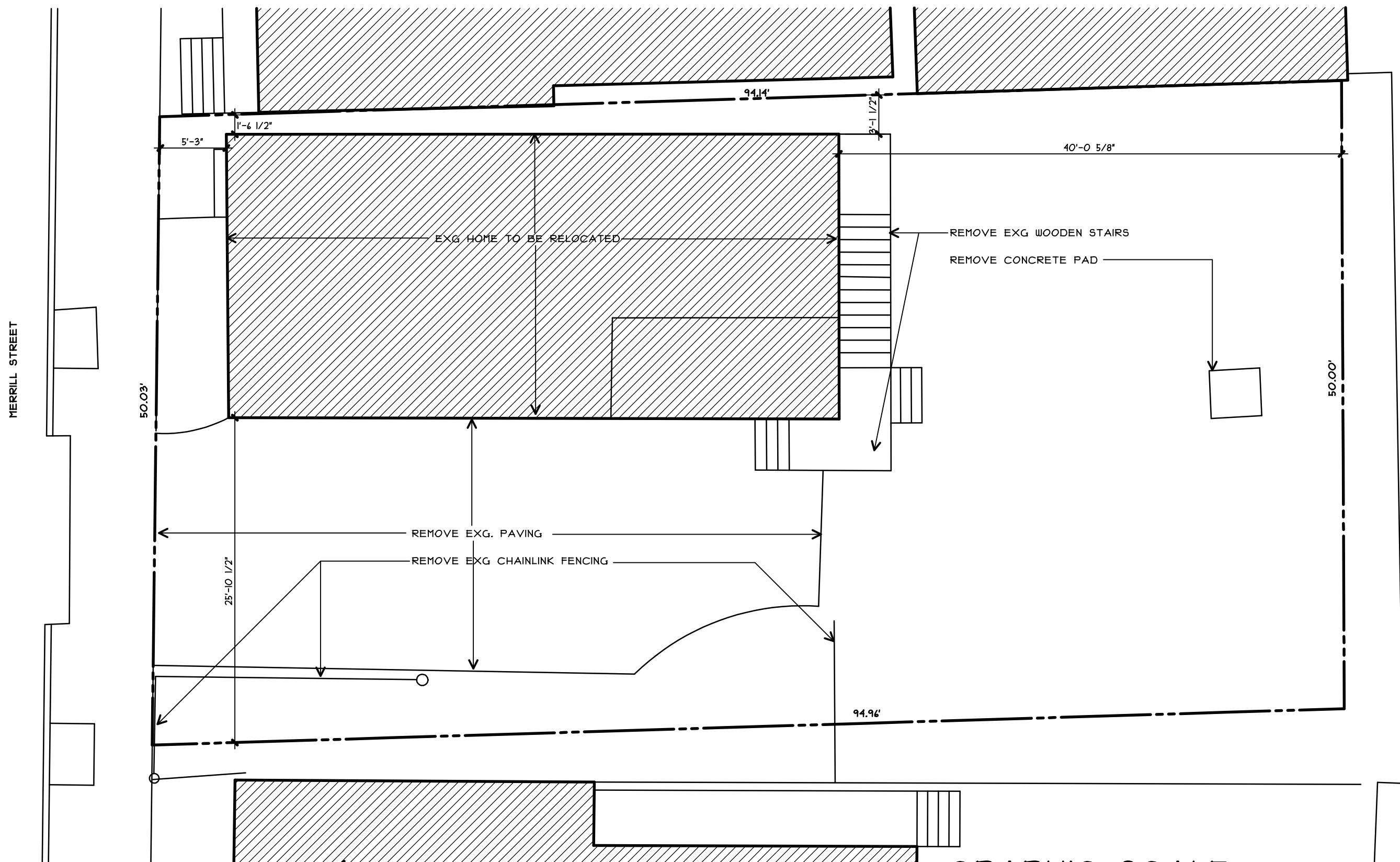

DEMOLITION FOUNDATION PLAN

1/8" = 1'-0"

GRAPHIC SCALE

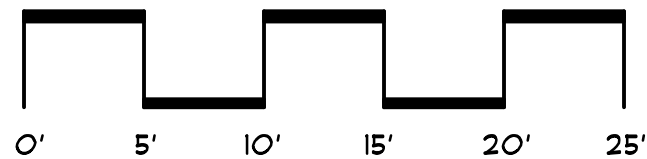

MERRILL STREET