

**City of Portland, Maine - Building or Use Permit Application**

389 Congress Street, 04101 Tel: (207) 874-8703, Fax: (207) 874-8716

<b>Permit No:</b> 09-1345	<b>Issue Date:</b> 11/24/2009	<b>CBL:</b> 014 E012001
------------------------------	----------------------------------	----------------------------

<b>Location of Construction:</b> 44 HOWARD ST	<b>Owner Name:</b> HANVEY FORREST R III	<b>Owner Address:</b> 44 HOWARD ST	<b>Phone:</b> 324-4440
<b>Business Name:</b>	<b>Contractor Name:</b> Maine Stove & Chimney	<b>Contractor Address:</b> 1725 Main St. Sanford	<b>Phone:</b>
<b>Lessee/Buyer's Name</b>	<b>Phone:</b>	<b>Permit Type:</b> Pellet/Wood stove	<b>Zone:</b> R6

<b>Past Use:</b> Two Family	<b>Proposed Use:</b> Two Family with wood pellet stove in first floor, direct vent vertical above 2nd floor windows	<b>Permit Fee:</b>	<b>Cost of Work:</b> \$6,500.00	<b>CEO District:</b> 1
<b>Proposed Project Description:</b> wood pellet stove in first floor, direct vent vertical above 2nd floor windows		<b>FIRE DEPT:</b> <input type="checkbox"/> Approved <input type="checkbox"/> Denied <b>INSPECTION:</b> Use Group: R3 Type: pellet stove IMC 2003/NFPA 211 Signature: JMB 11/24/09		<b>PEDESTRIAN ACTIVITIES DISTRICT (P.A.D.)</b> Action: <input type="checkbox"/> Approved <input type="checkbox"/> Approved w/Conditions <input type="checkbox"/> Denied Signature: _____ Date: _____

<b>Permit Taken By:</b> jmb	<b>Date Applied For:</b> 11/24/2009	<b>Zoning Approval</b>	
--------------------------------	--	------------------------	--

- This permit application does not preclude the Applicant(s) from meeting applicable State and Federal Rules.
- Building permits do not include plumbing, septic or electrical work.
- Building permits are void if work is not started within six (6) months of the date of issuance. False information may invalidate a building permit and stop all work..

Special Zone or Reviews	Zoning Appeal	Historic Preservation
<input type="checkbox"/> Shoreland <input type="checkbox"/> Wetland <input type="checkbox"/> Flood Zone <input type="checkbox"/> Subdivision <input type="checkbox"/> Site Plan Maj <input type="checkbox"/> Minor <input type="checkbox"/> MM <input type="checkbox"/> Date: <i>JMB</i>	<input type="checkbox"/> Variance <input type="checkbox"/> Miscellaneous <input type="checkbox"/> Conditional Use <input type="checkbox"/> Interpretation <input type="checkbox"/> Approved <input type="checkbox"/> Denied Date: _____	<input type="checkbox"/> Not in District or Landmark <input checked="" type="checkbox"/> Does Not Require Review <input type="checkbox"/> Requires Review <input type="checkbox"/> Approved <input type="checkbox"/> Approved w/Conditions <input type="checkbox"/> Denied Date: _____

**CERTIFICATION**

I hereby certify that I am the owner of record of the named property, or that the proposed work is authorized by the owner of record and that I have been authorized by the owner to make this application as his authorized agent and I agree to conform to all applicable laws of this jurisdiction. In addition, if a permit for work described in the application is issued, I certify that the code official's authorized representative shall have the authority to enter all areas covered by such permit at any reasonable hour to enforce the provision of the code(s) applicable to such permit.

SIGNATURE OF APPLICANT	ADDRESS	DATE	PHONE
RESPONSIBLE PERSON IN CHARGE OF WORK, TITLE		DATE	PHONE



FILL IN AND SIGN WITH INK

# APPLICATION FOR PERMIT HEATING OR POWER EQUIPMENT

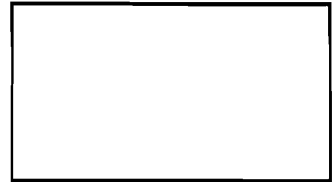

014 E 012

To the INSPECTOR OF BUILDINGS, PORTLAND, ME.

The undersigned hereby applies for a permit to install the following heating, cooking or power equipment in accordance with the Laws of Maine, the Building Code of the City of Portland, and the following specifications:

Location / CBL \_\_\_\_\_ Use of Building 2 F Date 11/24/2009  
 Name and address of owner of appliance Forrest R. Hanvey, III  
44 Howard St. Portland ME 04101  
 Installer's name and address Maine Stove & Chimney  
1725 Main St. #7, Sanford, ME 04073 Telephone (207) 324-4440

**Location of appliance:**  
 Basement  Floor  
 Attic  Roof

**Type of Fuel:**  
 Gas  Oil  Solid

**Appliance Name:** Wood Pellet Stove - Eco tek  
 U.L. Approved  Yes  No Model - Elena Airplus

Will appliance be installed in accordance with the manufacture's installation instructions?  Yes  No

IF NO Explain: \_\_\_\_\_

**Type of Chimney:**  
 Masonry Lined  
 Factory built \_\_\_\_\_

Metal  
 Factory Built U.L. Listing # \_\_\_\_\_

Direct Vent  
 Type Excel pellet vent UL# 641

**Type of Fuel Tank**  
 Oil  
 Gas

Size of Tank \_\_\_\_\_

**The Type of License of Installer:**  
 Master Plumber # \_\_\_\_\_  
 Solid Fuel # \_\_\_\_\_  
 Oil # \_\_\_\_\_  
 Gas # \_\_\_\_\_  
 Other \_\_\_\_\_

**RECEIVED**  
 NOV 24 2009  
 Dept. of Building Inspection  
 City of Portland Maine

Number of Tanks \_\_\_\_\_  
 Distance from Tank to Center of Flame \_\_\_\_\_ feet.  
 Cost of Work: \$ ~~600~~ 6,500  
 Permit Fee: \$ 0.00

**Approved**

**Approved with Conditions**

Fire: \_\_\_\_\_  
 Ele.: \_\_\_\_\_  
 Bldg.: JMB

See attached letter or requirement

Signature of Installer \_\_\_\_\_ Forrest Hanvey (owner) \_\_\_\_\_  
 Inspector's Signature \_\_\_\_\_ Date Approved \_\_\_\_\_  
Installation by Maine Stove & Chimney

White - Inspection    Yellow - File    Pink - Applicant's    Gold - Assessor's Copy

**BUILDING PERMIT INSPECTION PROCEDURES**

**Please call 874-8703 or 874-8693 (ONLY )**

**to schedule your inspections as agreed upon**

**Permits expire in 6 months, if the project is not started or ceases for 6 months.**

The Owner or their designee is required to notify the inspections office for the following inspections and provide adequate notice. Notice must be called in 48-72 hours in advance in order to schedule an inspection:

**By initializing at each inspection time, you are agreeing that you understand the inspection procedure and additional fees from a "Stop Work Order" and "Stop Work Order Release" will be incurred if the procedure is not followed as stated below.**

**A Pre-construction Meeting will take place upon receipt of your building permit.**

  X   **Final inspection required at completion of work.**

Certificate of Occupancy is not required for certain projects. Your inspector can advise you if your project requires a Certificate of Occupancy. All projects DO require a final inspection.

**If any of the inspections do not occur, the project cannot go on to the next phase, REGARDLESS OF THE NOTICE OR CIRCUMSTANCES.**

**CERIFICATE OF OCCUPANICES MUST BE ISSUED AND PAID FOR, BEFORE THE SPACE MAY BE OCCUPIED.**

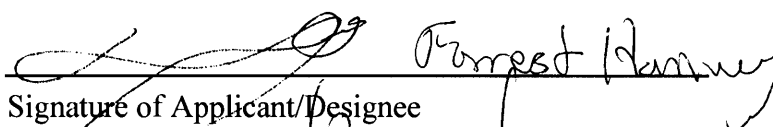
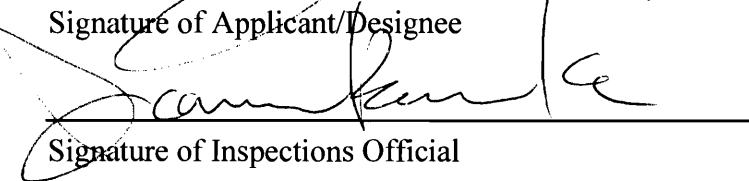
	<u>11/24/09</u>
Signature of Applicant/Designee	Date
	<u>11/24/09</u>
Signature of Inspections Official	Date

**City of Portland, Maine - Building or Use Permit**

389 Congress Street, 04101 Tel: (207) 874-8703, Fax: (207) 874-8716

<b>Permit No:</b> 09-1345	<b>Date Applied For:</b> 11/24/2009	<b>CBL:</b> 014 E012001
------------------------------	--	----------------------------

<b>Location of Construction:</b> 44 HOWARD ST	<b>Owner Name:</b> HANVEY FORREST R III	<b>Owner Address:</b> 44 HOWARD ST	<b>Phone:</b> ( ) 324-4440
<b>Business Name:</b>	<b>Contractor Name:</b> Maine Stove & Chimney	<b>Contractor Address:</b> 1725 Main St. Sanford	<b>Phone:</b>
<b>Lessee/Buyer's Name</b>	<b>Phone:</b>	<b>Permit Type:</b> Pellet/Wood stove	

<b>Proposed Use:</b> Two Family with wood pellet stove in first floor, direct vent vertical above 2nd floor windows	<b>Proposed Project Description:</b> wood pellet stove in first floor, direct vent vertical above 2nd floor windows
--	--

**Dept:** Zoning      **Status:** Approved      **Reviewer:** Jeanine Bourke      **Approval Date:** 11/24/2009  
**Note:**      **Ok to Issue:**

**Dept:** Building      **Status:** Approved with Conditions      **Reviewer:** Jeanine Bourke      **Approval Date:** 11/24/2009  
**Note:**      **Ok to Issue:**

- 1) This solid fuel appliance/stove/insert and vent shall be installed, operated and maintained per the manufacturers specifications, the UL listing, NFPA 211 and IMC 2003.
- 2) This permit DOES NOT certify the use of the property or building. It only authorizes the construction activities.
- 3) Permit approved based on the plans submitted and reviewed w/owner/contractor, with additional information as agreed on and as noted on plans.
- 4) Separate permits are required for any electrical, plumbing, sprinkler, fire alarm or HVAC or exhaust systems. Separate plans may need to be submitted for approval as a part of this process.
- 5) Application approval based upon information provided by applicant. Any deviation from approved plans requires separate review and approval prior to work.

**Comments:**

11/24/2009-jmb: Property owner came in for same day permit, had additional information faxed.

# Elena airplus



- Finished in black painted steel
- Majolica tiling in black, bordeaux, parchment and oriental earth color options
- Steel front section in black stove paint
- Combustion chamber in FIREX 600
- Steel baffle
- Fire-resistant steel burn-pot
- Glass-ceramic door with border, heat resistant up to 1,382°F
- Function controls with graphic display and remote control
- Timer thermostat as standard
- Double centrifugal fan heating and possibility of ducting
- Automatic glass-cleaning system

Nominal Thermal Output Min / Max	8,500 - 40,000 BTU
Efficiency	> 84%
Hopper Capacity	68 Lbs
Dimensions (Approx)	21"W 43.5"H 22"D

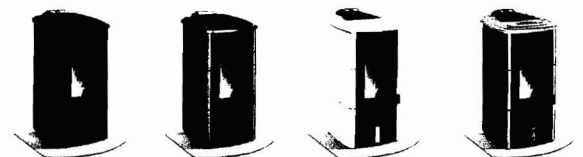

Black

Bordeaux

Parchment

Oriental Earth

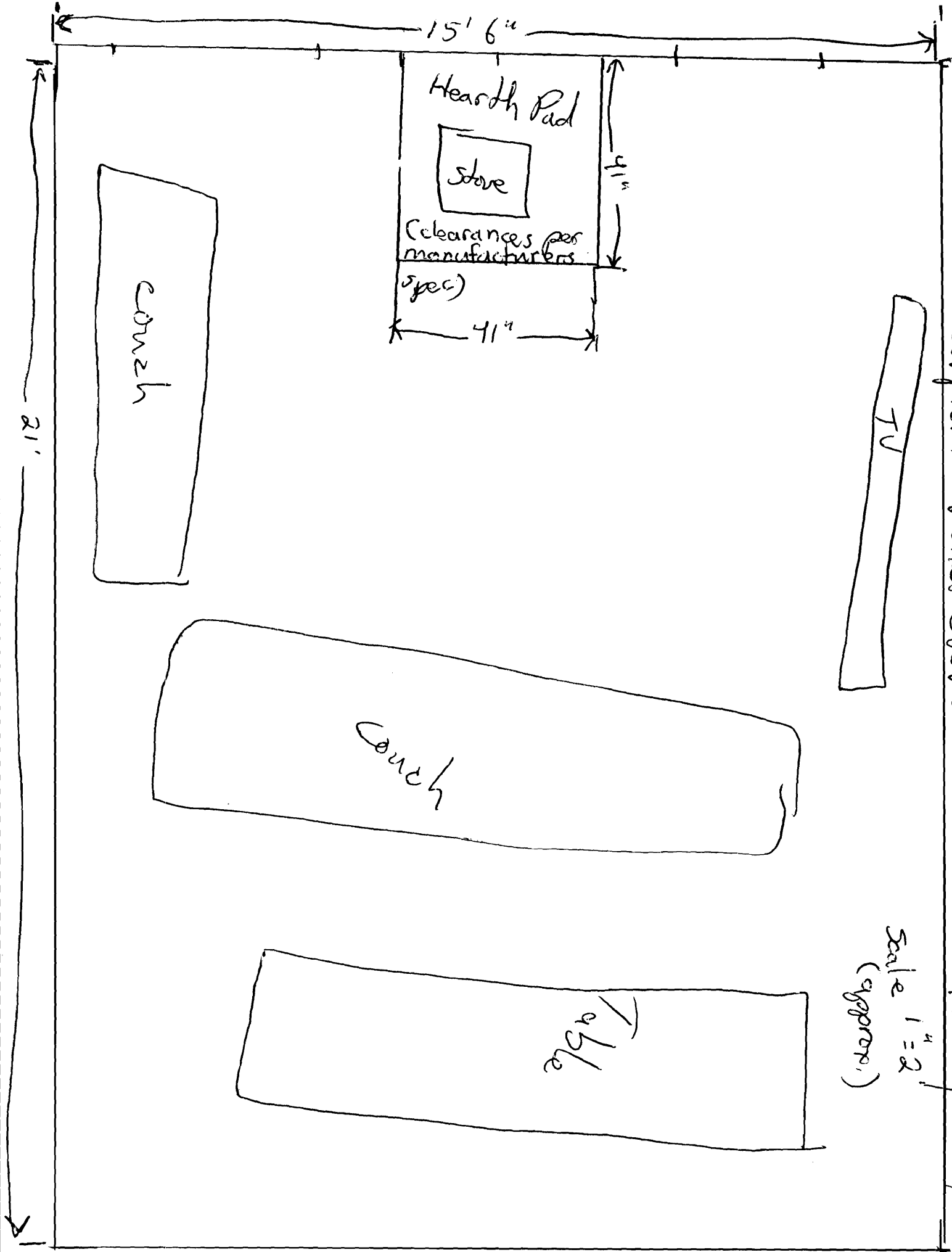

Floorplan - Pellet Stove

Ernest Henvey

11/24/2009

Scale 1" = 2'  
(approx.)

15' 6"

21'

Hearth Pad

Stove

(Clearances per  
manufacturer's  
spec)

41"

31"

Couch

TV

Couch

Table

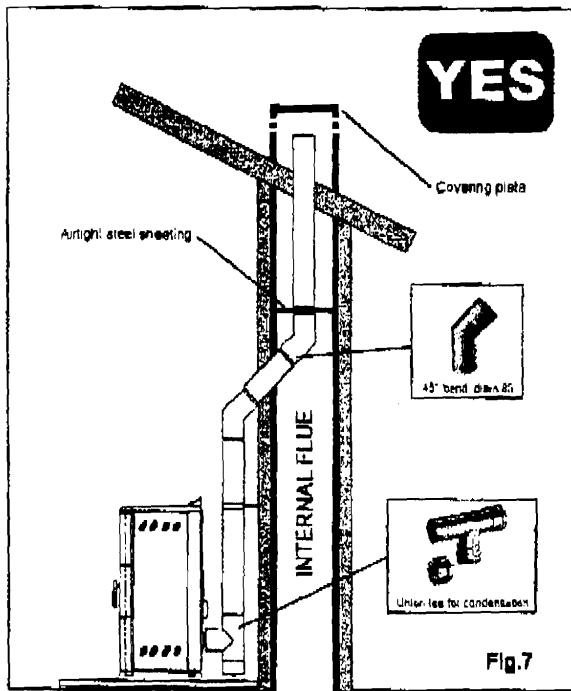

This type of installation (see Fig. 7) does not require an insulated flue as the exhaust pipe has been assembled partly inside the house and partly inside an existing flue. In the lower part of the flue a union tee has been installed with a cleanout cap.

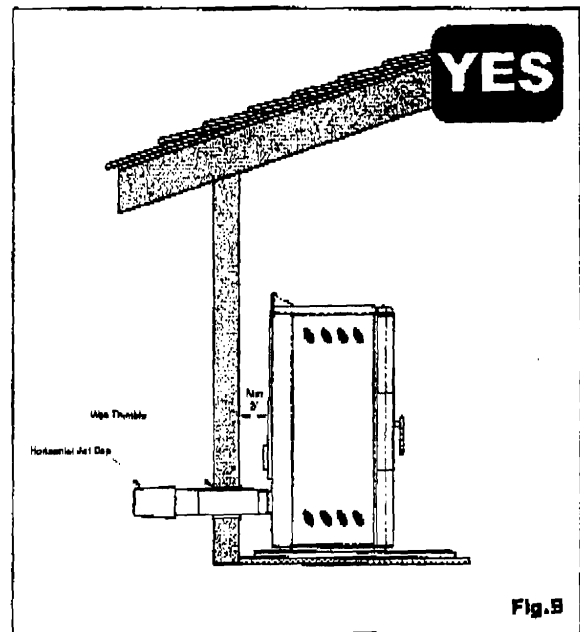
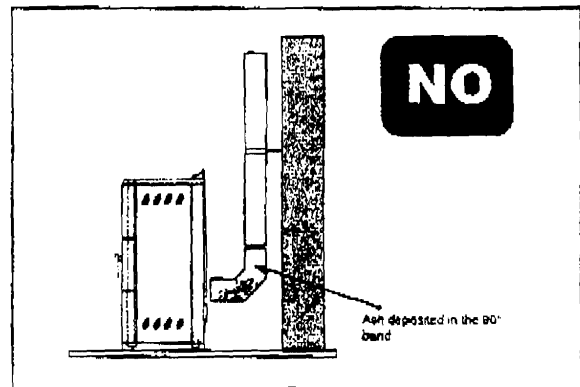

This type of installation (see Fig. 9) can be directly vented and terminated directly through the wall.

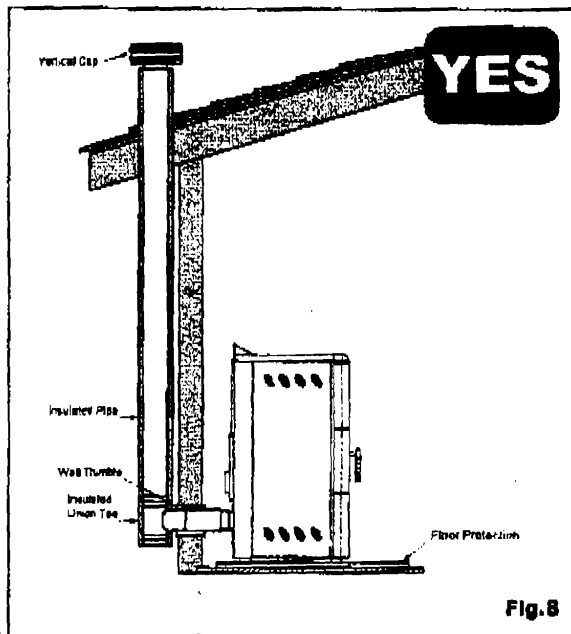

This type of installation (see Fig. 8) requires an insulated flue, as all the smoke pipe has been installed outside the house. In the lower part of the flue, a union tee has been mounted with an inspection cap.

**6.4. Operating faults due to flue draught problems or critical weather conditions**

Among all weather and geographical conditions that may have an impact on the operation of the draught flue (snow, rain, altitude above sl. fog, ...) wind is certainly the most important. In fact, in addition to the thermal depression caused by the temperature difference between the inside and the outside of the flue, there is another type of depression: dynamic depression caused by wind. Therefore, wind has an impact on the efficiency of the flue.

THE OPERATION OF THE PELLETS STOVE IS THEREFORE STRONGLY DEPENDENT ON THE POSITION AND CONSTRUCTION OF THE FLUE. PRECARIOUS CONDITIONS CAN ONLY BE RESOLVED WITH AN APPROPRIATE SETTING OF THE STOVE BY ECOTECK APPROVED TECHNICAL PERSONNEL.

### 6.3 Installation Examples

Min Distances (in inches)

- A: 3" Unprotected walls
- B: 6" Front & side of floor protection
- C: 3" Back of floor protection

Use these illustrations as a guide only. All units must be placed on a non-combustible floor protector with a minimum thickness of .018". All measurements are made at the top of the units. For additional information, please contact your local Ecoteck dealer.

Back & Side Walls

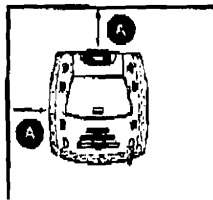

Corners

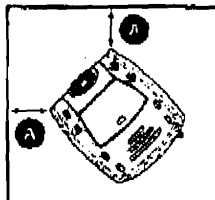

Floor Protection

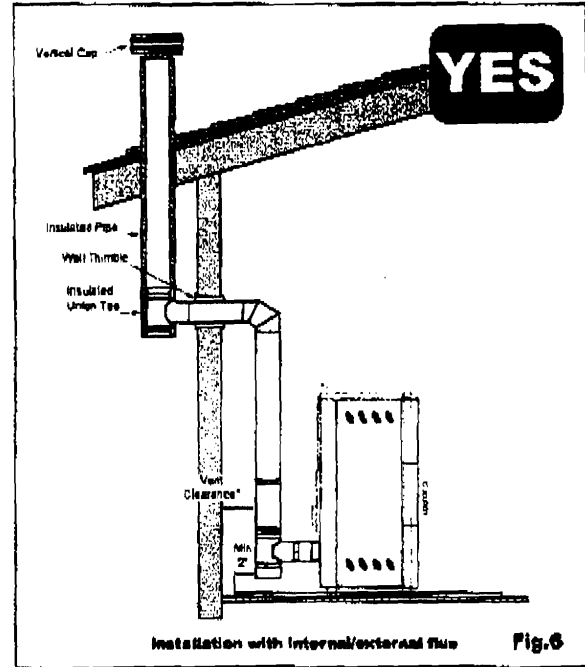
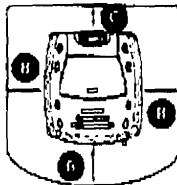

This type of installation (see fig. 6) does not require an insulated flue for the part inside the house, for the part outside an insulated tube must be used. In the lower part of the flue in the house, a union tee has been installed with a cleanout, but another one has also been installed outside, so that the part can be inspected. Two 90° bends should not be installed as the ash could quickly block the passage of smoke, causing problems for the draught of the stove.

Any pipe run longer than 3 feet must have a minimum 1/4 inch rise per 1 foot run.

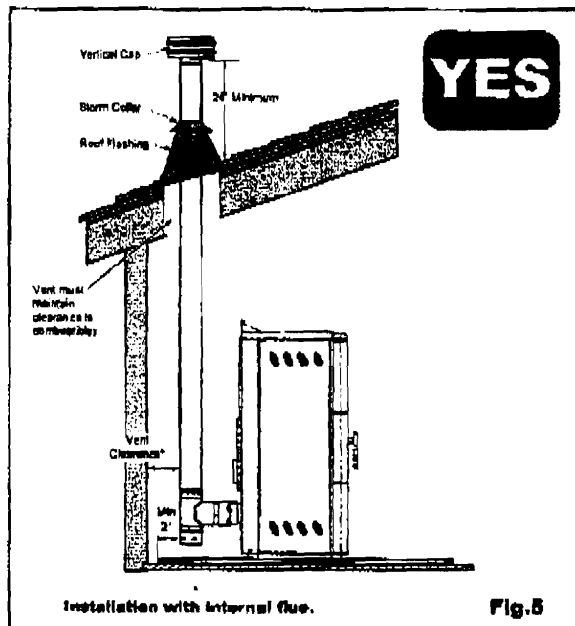

This type of installation (see Fig. 5), does not require an Insulated flue, as all the whole pipe has been assembled inside the house. A union tee has been mounted in the lower part of the flue with a cleanout.

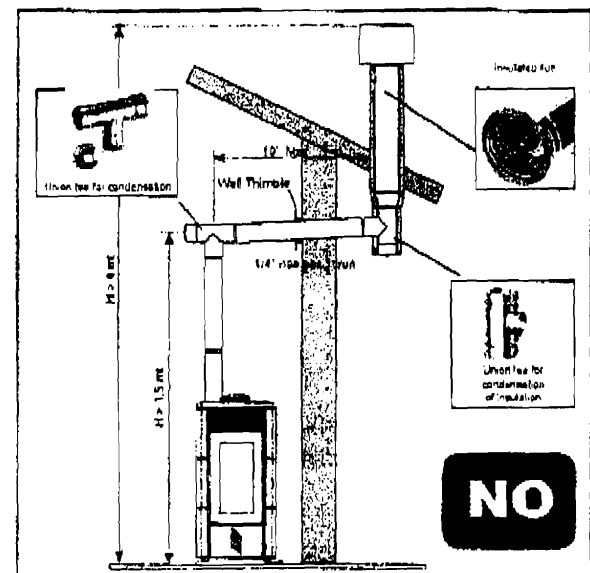



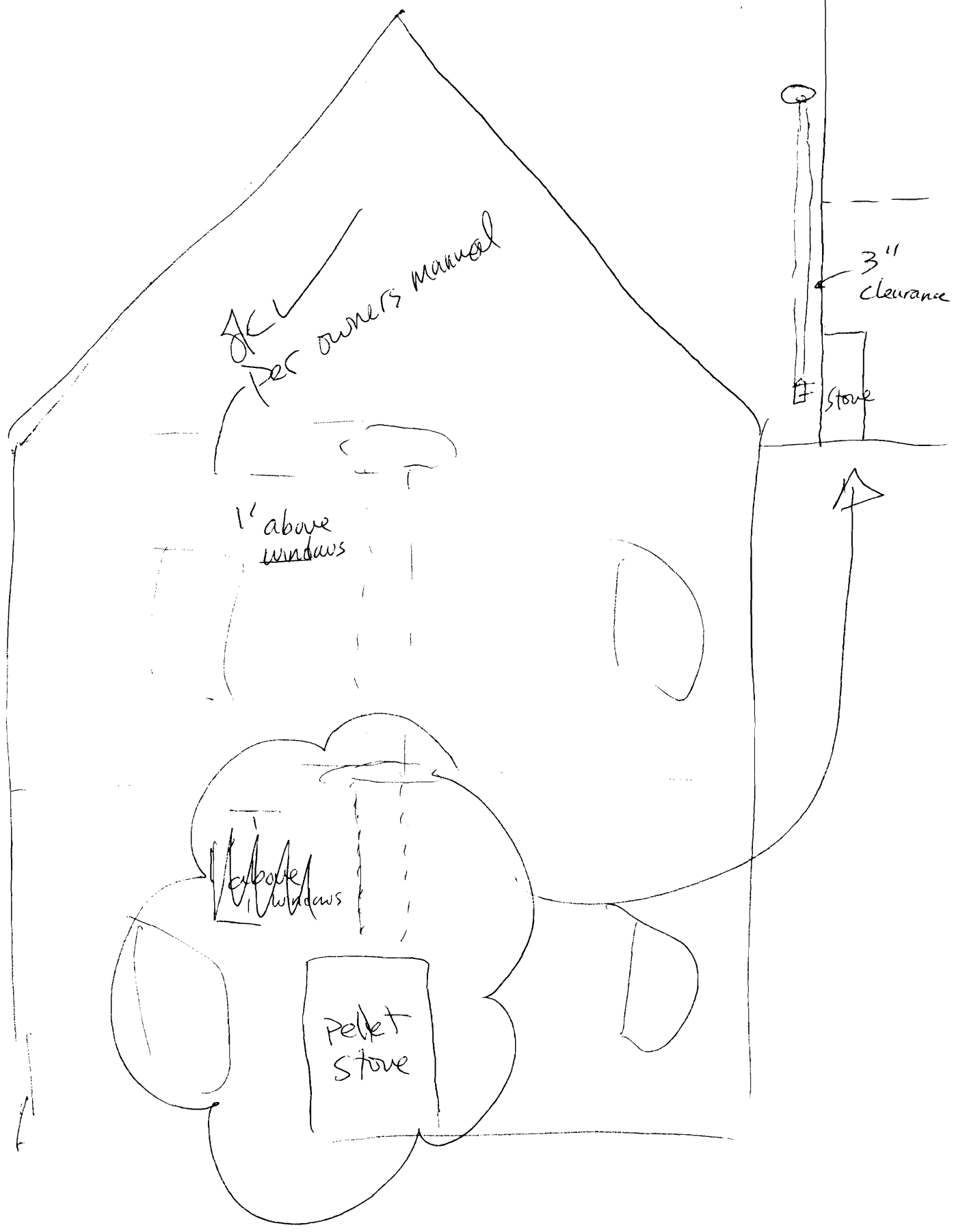

- 11
- 11
- A. The clearance above grade must be a minimum of 18".
  - B. The clearance to a window or door that may be opened must be a minimum of 48" to the side, 48" below the window/door, and 12" above the window/door. See note 1.
  - C. A 12" clearance to a permanently closed window is recommended to prevent condensation on the window.
  - D. The vertical clearance to a ventilated soffit located above the termination within a horizontal distance of 2 feet from the center-line of the termination must be a minimum of 16".
  - E. The clearance to an unventilated soffit must be a minimum of 12".
  - F. The clearance to an outside corner is 12" from center of pipe.
  - G. The clearance to an inside corner is 12".
  - H. A vent must not be installed within 3 feet above a gas meter/regulator assembly when measured from the horizontal center-line of the regulator. See note 1.
  - I. The clearance to service regulator vent outlet must be a minimum of 6 feet. See note 1.
  - J. The clearance to a non-mechanical air supply inlet to the building or the combustion air inlet to any other appliance must be a minimum of 48". See note 1.
  - K. The clearance to a mechanical air supply inlet must be a minimum of 10 feet. See note 1.
  - L. The clearance above a paved sidewalk or a paved driveway located on public property must be a minimum of 7 feet. A vent shall not terminate directly above a sidewalk or paved driveway which is located between two single family dwellings and serves both dwellings. See note 1.
  - M. The clearance under a veranda, porch, deck or balcony must be a minimum of 12". Only permitted if veranda, porch, deck, or balcony is fully open on a minimum of 2 sides beneath the floor. See note 1.

**Note 1:** Certain local codes or regulations may require different clearances.

12. Put a small amount of liquid dish soap on each gasket to make it easier to assemble the vent sections. Do not use a petroleum-based lubricant.

## PLANNING YOUR INSTALLATION

### GENERAL

Prior to starting your installation, we suggest you take the following into consideration:

1. Contact your local building authority and/or fire officials for permits, restrictions and installation inspections. You may also wish to contact your house insurance representative.
2. Review all your options for the appliance location and also venting configuration. Try to minimize the alteration and reframing of structural components of the building (wall studs, water pipes, electrical wiring, ceiling joists, roof rafters, etc.). It may be easier to change the location of your appliance than to modify the building structure.
3. Carefully read the appliance and the venting system instruction manuals. Good planning might save you time, work and money.
4. Use only authorized EXCELPellet listed components. Do not use damaged parts.

## **INSTALLATION NOTES**

1. For corn burning pellet appliances the EXCELPellet Interior flue needs to be made of type 304 Stainless Steel. Corn can be much more corrosive than standard wood pellets. Type 304 Stainless Steel is more corrosion resistant than the type 430. The EXCELPellet warranty will be void if Type 430 is used with corn.
2. Choose an appliance that has a label of a recognized Testing Laboratory (such as WH, UL, ULC, CSA and OMNI).
3. Install the pellet appliance as described in the Installation Instructions accompanying the pellet appliance. **BE CERTAIN TO MAINTAIN THE REQUIRED CLEARANCES TO COMBUSTIBLE CONSTRUCTION.**
4. The maximum height of un-guyed vent above the roof is 5 feet. If you have more than 5 feet use the EXCEL Chimney Roof Brace (XM-ERB).
5. Portions of the vent which extend through accessible spaces shall be enclosed in all cases to avoid personal contact with the vent and damage to the vent.
6. **DO NOT FILL THE AIR SPACE** around the vent with insulation or any other material. Do not fill the factory built supports with insulation. Insulation placed in this area could cause adjacent combustibles to overheat.
7. Do not allow sawdust or construction debris to accumulate around the vent. Clean all areas surrounding the vent before closing up any enclosed areas.
8. In attics, it is important to extend the Attic Shield (PM-PSA with PM-PSC) to the maximum height possible. This will prevent any contact of the insulation with the vent when loose fill insulation as cellulose type insulation is used. Also, it will prevent any contact to the vent if any type of insulation is added in the future.
9. The vent cap of a vertical through the roof installation shall extend at least 12 inches above the roof line.
10. The following does not apply to installations in single and two-family dwellings:  
  
Factory built vents which extend through any story above that on which the connected appliance is located are to be provided with enclosures having a fire resistance rating equal to or greater than that of the floor or roof assemblies through which they pass.
11. Rules for termination cap:

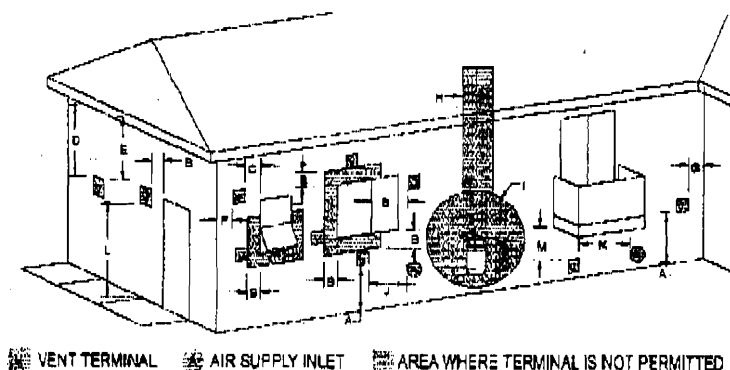

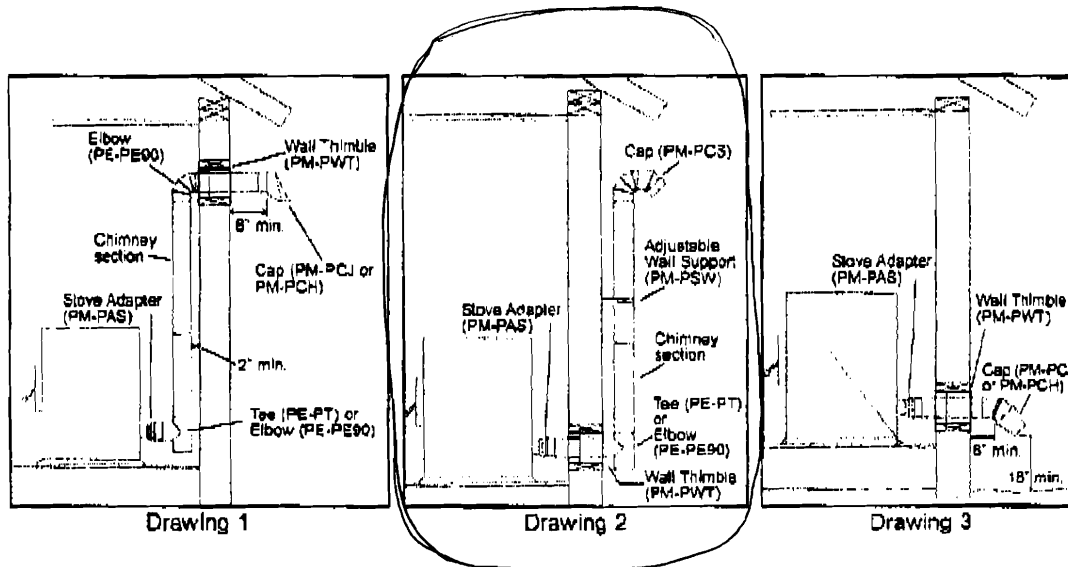

3. If the insulation sticks out more than 2" past the outside wall, trim it flush with the wall. Slide the exterior portion (the unpainted galvalume square plate) of the Wall Thimble over the insulation and screw it to the wall with four #8 x 1 1/2" wood screws. Seal the joint between the plate and the wall with silicone caulking. Bend the small tabs to the outside on the wall thimble plate. These tabs will have to be fastened to the chimney length passing to the wall thimble using two #6 x 1/4" screws provided.
4. Apply high temperature silicone caulking to the appliance flue collar. Fasten the Universal Slove Adapter (PM-PAS) to the appliance outlet using two #8 sheet metal screws. You may need to drill 1/8" diameter holes in the appliance flue collar if it is made of thick steel.
5. Fasten the first length, tee or elbow to the Universal Slove Adapter using three #8 x 1/4" sheet metal screws provided. Twist the part back and forth when you put them together. This turning motion will make the parts go together more easily. There is no need to apply silicone caulking to the exterior of the joint. The factory installed gasket on the flue will make a sealed connection. Put a small amount of liquid dish soap on each gasket to make it easier to assemble the vent sections. Do not use a petroleum-based lubricant.
6. Fasten additional parts as necessary. Refer to Drawings 1, 2 or 3 for typical installations.
7. If you are going up on the outside of the wall you will need to install an Adjustable Wall Support. Pre-assemble the support as shown on Drawing 4. The collar is adjustable for a 3" or 4" chimney. Install the wall support on the vent. Tighten the band locking bolt just enough to hold the wall support in place.

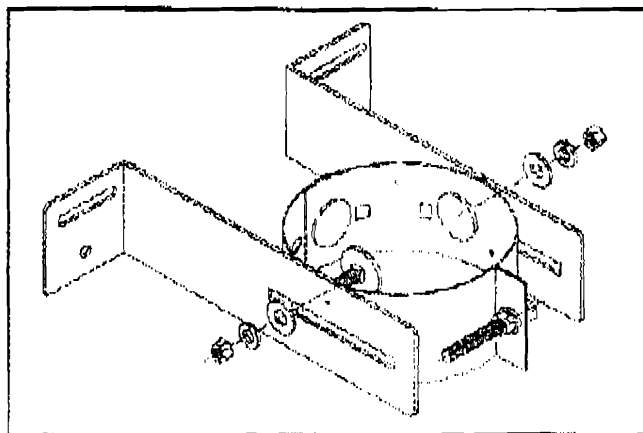

Drawing 4