

DISPLAY THIS CARD ON PRINCIPAL FRONTAGE OF WORK

# CITY OF PORTLAND

BUILDING DEPARTMENT

## PERMIT

Permit Number: 10884

## PERMIT ISSUED

Please Read Application And Notes, If Any, Attached

This is to certify that Harris Properties/RL Sanborn M onry

has permission to Frost wall for building extension JUL 28 2010

AT 10 Merrill St CB# 014 D001001

provided that the person or persons, firm or corporation accepting this permit shall comply with all of the provisions of the Statutes of Maine and of the Ordinances of the City of Portland regulating the construction, maintenance and use of buildings and structures, and of the application on file in this department.

Apply to Public Works for street line and grade if nature of work requires such information.

Notification of inspection must be given and written permission procured before this building or part thereof is lathed or otherwise finished-in. 24 HOUR NOTICE IS REQUIRED.

A certificate of occupancy must be procured by owner before this building or part thereof is occupied.

### OTHER REQUIRED APPROVALS

Fire Dept. \_\_\_\_\_

Health Dept. \_\_\_\_\_

Appeal Board \_\_\_\_\_

Other \_\_\_\_\_

Department Name

*Carrie Bonke* 7/28/10  
Director - Building & Inspection Services

**PENALTY FOR REMOVING THIS CARD**

**City of Portland, Maine - Building or Use Permit Application**  
 389 Congress Street, 04101 Tel: (207) 874-8703, Fax: (207) 874-8716

Permit No: 10-0884	Issue Date:	CBL: 014 D001001
-----------------------	-------------	---------------------

Location of Construction: 10 Merrill St (10 Cumberland)	Owner Name: Harris Properties	Owner Address: 48 Deering Ave.	Phone:
Business Name:	Contractor Name: RL Sanborn Masonry	Contractor Address: 1124 Brighton Ave. Portland	Phone: 2074797567
Lessee/Buyer's Name	Phone:	Permit Type: Alterations - Commercial	Zone: R-1

Past Use: Commercial / Multi Units (3)	Proposed Use: Commercial / Frost wall for building extension. (concrete)	Permit Fee: \$70.00	Cost of Work: \$5,000.00	CEO District: 1
Proposed Project Description: Frost wall for building extension. (concrete)		FIRE DEPT: <input type="checkbox"/> Approved <input type="checkbox"/> Denied	INSPECTION: Use Group: R2 Type: Foundation only	
		Signature:	Signature: JMB 7/28/10	

PEDESTRIAN ACTIVITIES DISTRICT (P.A.D.)

Action:  Approved  Approved w/Conditions  Denied

Signature: \_\_\_\_\_ Date: \_\_\_\_\_

Permit Taken By: gg	Date Applied For: 07/26/2010	<b>Zoning Approval</b>
------------------------	---------------------------------	------------------------

1. This permit application does not preclude the Applicant(s) from meeting applicable State and Federal Rules.  2. Building permits do not include plumbing, septic or electrical work.  3. Building permits are void if work is not started within six (6) months of the date of issuance. False information may invalidate a building permit and stop all work..	Special Zone or Reviews <input type="checkbox"/> Shoreland <input type="checkbox"/> Wetland <input type="checkbox"/> Flood Zone <input type="checkbox"/> Subdivision <input type="checkbox"/> Site Plan  Maj <input type="checkbox"/> Minor <input type="checkbox"/> MM <input type="checkbox"/> Date: 7/27/10 JMB	Zoning Appeal <input type="checkbox"/> Variance <input type="checkbox"/> Miscellaneous <input type="checkbox"/> Conditional Use <input type="checkbox"/> Interpretation <input type="checkbox"/> Approved <input type="checkbox"/> Denied  Date:	Historic Preservation <input checked="" type="checkbox"/> Not in District or Landmark <input type="checkbox"/> Does Not Require Review <input type="checkbox"/> Requires Review <input type="checkbox"/> Approved <input type="checkbox"/> Approved w/Conditions <input type="checkbox"/> Denied  Date: JMB
	PERMIT ISSUED JUL 28 2010 City of Portland		

**CERTIFICATION**

I hereby certify that I am the owner of record of the named property, or that the proposed work is authorized by the owner of record and that I have been authorized by the owner to make this application as his authorized agent and I agree to conform to all applicable laws of this jurisdiction. In addition, if a permit for work described in the application is issued, I certify that the code official's authorized representative shall have the authority to enter all areas covered by such permit at any reasonable hour to enforce the provision of the code(s) applicable to such permit.

SIGNATURE OF APPLICANT \_\_\_\_\_ ADDRESS \_\_\_\_\_ DATE \_\_\_\_\_ PHONE \_\_\_\_\_

RESPONSIBLE PERSON IN CHARGE OF WORK, TITLE \_\_\_\_\_ DATE \_\_\_\_\_ PHONE \_\_\_\_\_



# CITY OF PORTLAND, MAINE

Department of Building Inspections

## Original Receipt

July 26 2010

Received from

Al Santos Masonry

Location of Work

10 Cumberland Ave

Cost of Construction \$ \_\_\_\_\_

Building Fee: \_\_\_\_\_

Permit Fee \$ \_\_\_\_\_

Site Fee: \_\_\_\_\_

Certificate of Occupancy Fee: \_\_\_\_\_

Total: \_\_\_\_\_

Building (1L) \_\_\_\_\_

Plumbing (15) \_\_\_\_\_

Electrical (12) \_\_\_\_\_

Site Plan (U2) \_\_\_\_\_

Other \_\_\_\_\_

CBL: 014 12001

Check #: VISA

Total Collected \$ 50.00

**No work is to be started until permit issued.  
Please keep original receipt for your records.**

Taken by: [Signature]

WHITE - Applicant's Copy

YELLOW - Office Copy

PINK - Permit Copy

**City of Portland, Maine - Building or Use Permit**

389 Congress Street, 04101 Tel: (207) 874-8703, Fax: (207) 874-8716

<b>Permit No:</b> 10-0884	<b>Date Applied For:</b> 07/26/2010	<b>CBL:</b> 014 D001001
------------------------------	--	----------------------------

<b>Location of Construction:</b> 10 Merrill St	<b>Owner Name:</b> Harris Properties	<b>Owner Address:</b> 48 Deering Ave.	<b>Phone:</b>
<b>Business Name:</b>	<b>Contractor Name:</b> RL Sanborn Masonry	<b>Contractor Address:</b> 1124 Brighton Ave. Portland	<b>Phone</b> (207) 479-7567
<b>Lessee/Buyer's Name</b>	<b>Phone:</b>	<b>Permit Type:</b> Alterations - Commercial	

<b>Proposed Use:</b> Commercial / Frost wall for existing building extension.	<b>Proposed Project Description:</b> Frost wall for existing uilding extension.
--	--

**Dept:** Zoning      **Status:** Approved with Conditions      **Reviewer:** Ann Machado      **Approval Date:** 07/27/2010

**Note:**      **Ok to Issue:**

- 1) This permit is being issued with the condition that all the work will tke place within the existing footprint.
- 2) This building (#10 Cumberland) shall remain a three family dwelling. Any change of use shall require a separate permit application for review and approval.
- 3) This permit is being approved on the basis of plans submitted. Any deviations shall require a separate approval before starting that work.

**Dept:** Building      **Status:** Approved with Conditions      **Reviewer:** Jeanine Bourke      **Approval Date:** 07/28/2010

**Note:**      **Ok to Issue:**

- 1) Application approval based upon information provided by applicant. Any deviation from approved plans requires separate review and approrval prior to work.

## **BUILDING PERMIT INSPECTION PROCEDURES**

**Please call 874-8703 or 874-8693 (ONLY )**

**or email: [buildinginspections@portlandmaine.gov](mailto:buildinginspections@portlandmaine.gov)**

With the issuance of this permit, the owner, builder or their designee is required to provide adequate notice to the City of Portland Inspection Services for the following inspections. Appointments must be requested 48 to 72 hours in advance of the required inspection. The inspection date will need to be confirmed by this office.

- **Please read the conditions of approval that is attached to this permit!! Contact this office if you have any questions.**
- **Permits expire in 6 months, if the project is not started or ceases for 6 months.**
- **If the inspection requirements are not followed as stated below additional fees may be incurred due to the issuance of a "Stop Work Order" and subsequent release to continue with construction.**

  X   **Footing/Building Location Inspection: Prior to pouring concrete or setting precast piers**

  X   **Foundation Inspection: Prior to placing ANY backfill for below grade occupiable space**

  X   **Final inspection required at completion of work.**

**The project cannot move to the next phase prior to the required inspection and approval to continue, REGARDLESS OF THE NOTICE OR CIRCUMSTANCES.**

**IF THE PERMIT REQUIRES A CERTIFICATE OF OCCUPANCY, IT MUST BE PAID FOR AND ISSUED TO THE OWNER OR DESIGNEE BEFORE THE SPACE MAY BE OCCUPIED.**

**PERMIT ISSUED**

**JUL 28 2010**

**City of Portland**



# General Building Permit Application

If you or the property owner owes real estate or personal property taxes or user charges on any property within the City, payment arrangements must be made before permits of any kind are accepted.

Location/Address of Construction: <u>10 Cumberland Ave</u>			
Total Square Footage of Proposed Structure/Area <u>54 Sq. Ft</u>		Square Footage of Lot <u>Applicant</u>	Number of Stories <u>3</u>
Tax Assessor's Chart, Block & Lot Chart#      Block#      Lot#  <u>014      10      001</u>	Applicant * <u>must</u> be owner, Lessee or Buyer* Name <u>R.L. Sauborn Masonry</u> Address <u>1124 Brighton Ave</u> City, State & Zip <u>Portland Me 04102</u>		Telephone:  <u>207-479-7567</u>
Lessee/DBA (If Applicable)	Owner (if different from Applicant) Name <u>Harris Properties</u> Address <u>48 Deering Ave</u> City, State & Zip <u>Portland Me 04102</u>	Cost Of Work: \$ <u>5000</u> C of O Fee: \$ _____ Total Fee: \$ <u>70.00</u>	
Current legal use (i.e. single family) _____		Number of Residential Units <u>3</u>	
If vacant, what was the previous use? _____			
Proposed Specific use: _____			
Is property part of a subdivision? _____		If yes, please name _____	
Project description: <u>Frost wall for Building extension</u>			
Contractor's name: <u>R.L. Sauborn Masonry</u>			
Address: <u>1124 Brighton Ave</u>			
City, State & Zip: <u>Portland Me 04102</u>		Telephone: <u>207-479-7567</u>	
Who should we contact when the permit is ready: <u>Rick Sauborn</u>		Telephone: <u>479-7567</u>	
Mailing address: <u>1124 Brighton Ave Portland Me</u>			

Please submit all of the information outlined on the applicable Checklist. Failure to do so will result in the automatic denial of your permit.

In order to be sure the City fully understands the full scope of the project, the Planning and Development Department may request additional information prior to the issuance of a permit. For further information or to download copies of this form and other applications visit the Inspections Division on-line at [www.portlandmaine.gov](http://www.portlandmaine.gov), or stop by the Inspections Division office, room 315 City Hall or call 874-8703.

I hereby certify that I am the Owner of record of the named property, or that the owner of record authorizes the proposed work and that I have been authorized by the owner to make this application as his/her authorized agent. I agree to conform to all applicable laws of this jurisdiction. In addition, if a permit for work described in this application is issued, I certify that the Code Official's authorized representative shall have the authority to enter all areas covered by this permit at any reasonable hour to enforce the provisions of the codes applicable to this permit.

Signature: [Signature] Date: 7/26/10

This is not a permit; you may not commence ANY work until the permit is issued

Key

mm - Area of Project

Existing

31'

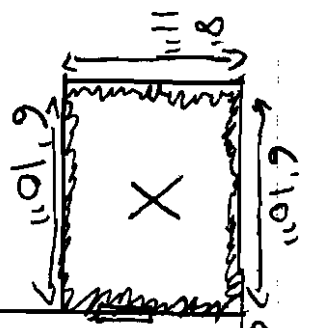

Access/Vent  
 opening  
 min. 16" x 24"

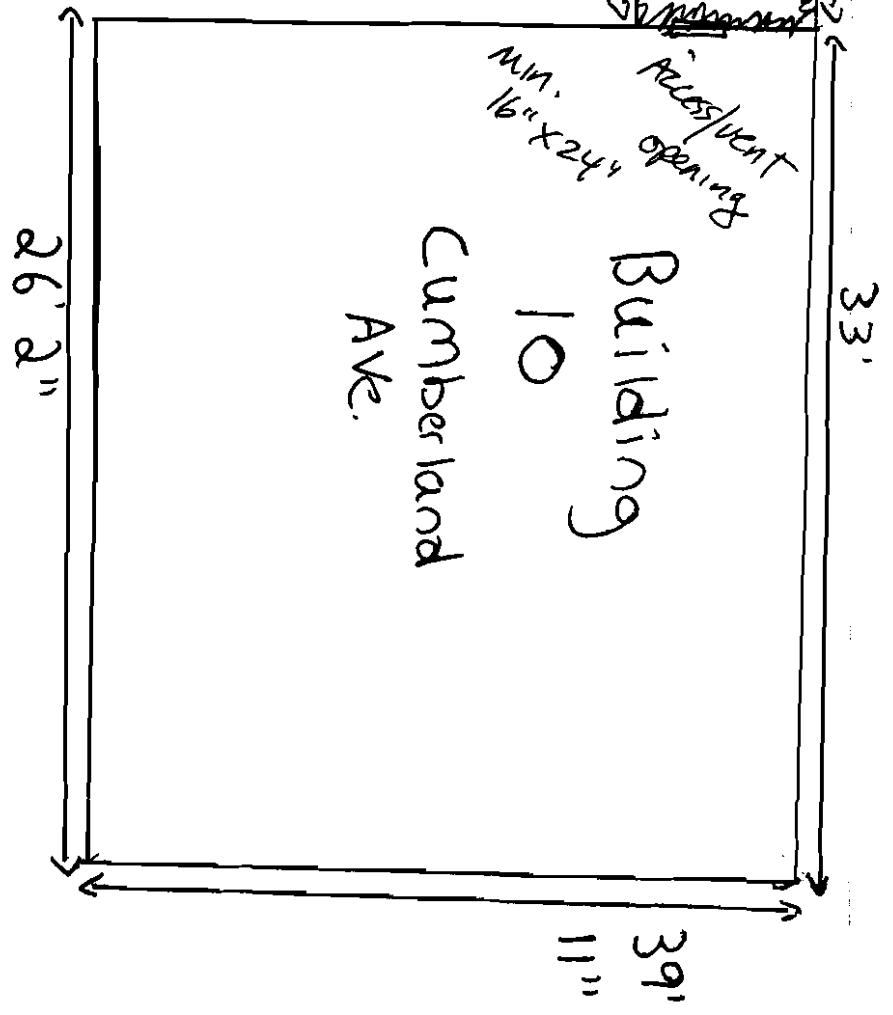

Cumberland Ave

10

