

CONCRETE SIZE & REINFORCEMENT SCHEDULE			
MARK	TYPE	SIZE	REINFORCING
TYPICAL	TYPICAL FND WALL UNO	8" WIDE x CONT.	(2) #5 CONT. TOP AND BOT - TYP - #4 HORIZ @ 18"   #4 VERT @ 16" - SEE SECTION A/S2.1
	TYPICAL CONT FOOTING UNO	24" WIDE x 10" THICK x CONT.	(3) #4 CONT.
* PW1 *	PLANTER WALL FOUNDATION ARCHITECTURALLY EXPOSED	8" WIDE x CONT.	(2) #5 CONT. TOP AND BOT - TYP - #4 HORIZ @ 24"   #4 VERT @ 32" - HOOK DOWELS @ 64" O.C.
	PLANTER CONT FOOTING	16" WIDE x 8" THICK x CONT.	(2) #4 CONT.
* CF24 *	CONT STRIP FOOTING	24" WIDE x 10" THICK x CONT.	(3) #4 CONT.
* CF36 *	CONT STRIP FOOTING	36" WIDE x 10" THICK x CONT.	#4 @ 12" O.C. E.W. @ MID DEPTH

1. ADDITIONAL REINFORCING IS ALSO INDICATED IN PLANS AND SECTION

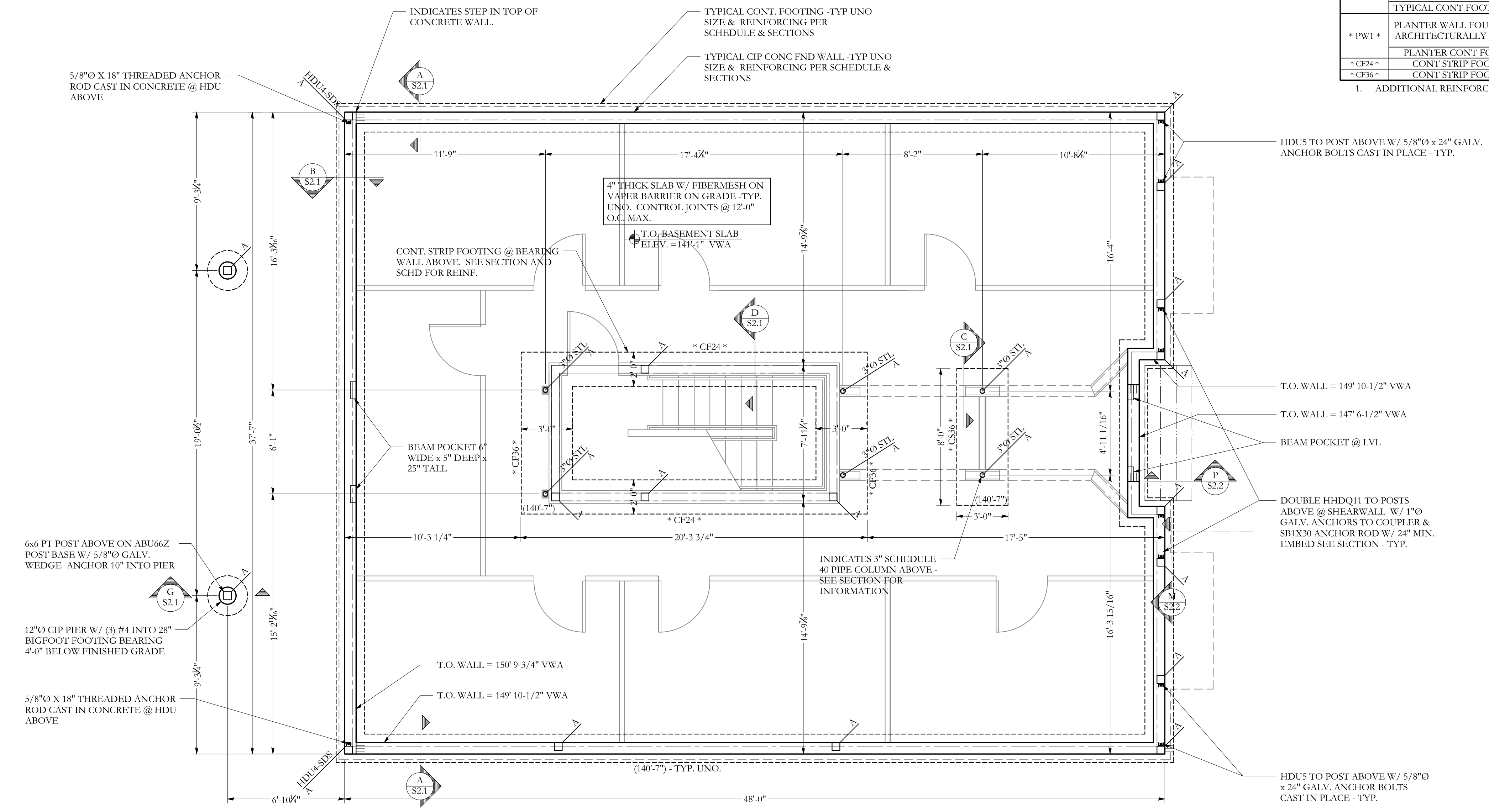

**FOUNDATION/GROUND FLOOR PLAN** SCALE 1/4"=1'-0"

- NOTES:
1. ALL CONCRETE REINFORCING STEEL PER PLANS, SCHEDULE AND SECTIONS.
  3. SEE S-1.0 FOR STRUCTURAL GENERAL NOTES
  4. STEP IN TOP OF FOUNDATION WALL IS INDICATED THUS: , AND SHOWS LOWER SIDE OF WALL.
  5. BOTTOM OF FOOTING TO BEAR 4'-0" MIN BELOW GRADE.
  6. TOP OF FOOTINGS ARE INDICATED THUS: (XX'-XX").
  7. STEP IN TOP OF FOOTING IS INDICATED THUS: , AND SHOWS LOWER FOOTING.
  8. COORDINATE ELEVATION W/ SITE & CIVIL - TYP.

PROJECT NO. **16035**  
PROJECT NAME **7 CUMBERLAND PORTLAND, ME**

REVISIONS

1	
2	
3	
4	
5	

DRAWN BY **MKL**  
SHEET TITLE **FOUNDATION PLAN**

ISSUE DATE **2/23/17**  
SHEET SCALE **AS NOTED**