

BRICK DRIVEWAY APRON WITH BITUMINOUS BASE
NOT TO SCALE

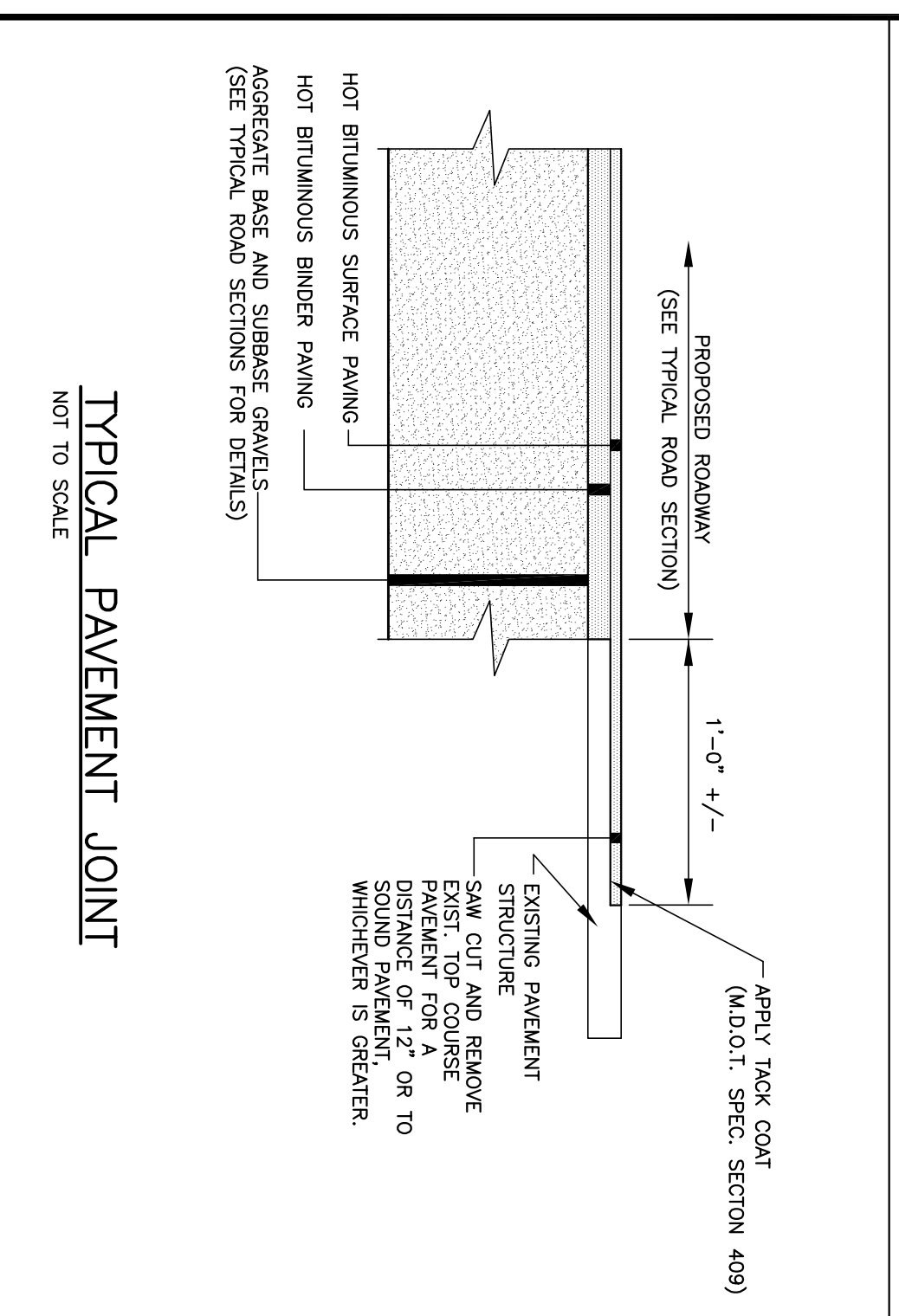

TYPICAL PAVEMENT JOINT
NOT TO SCALE

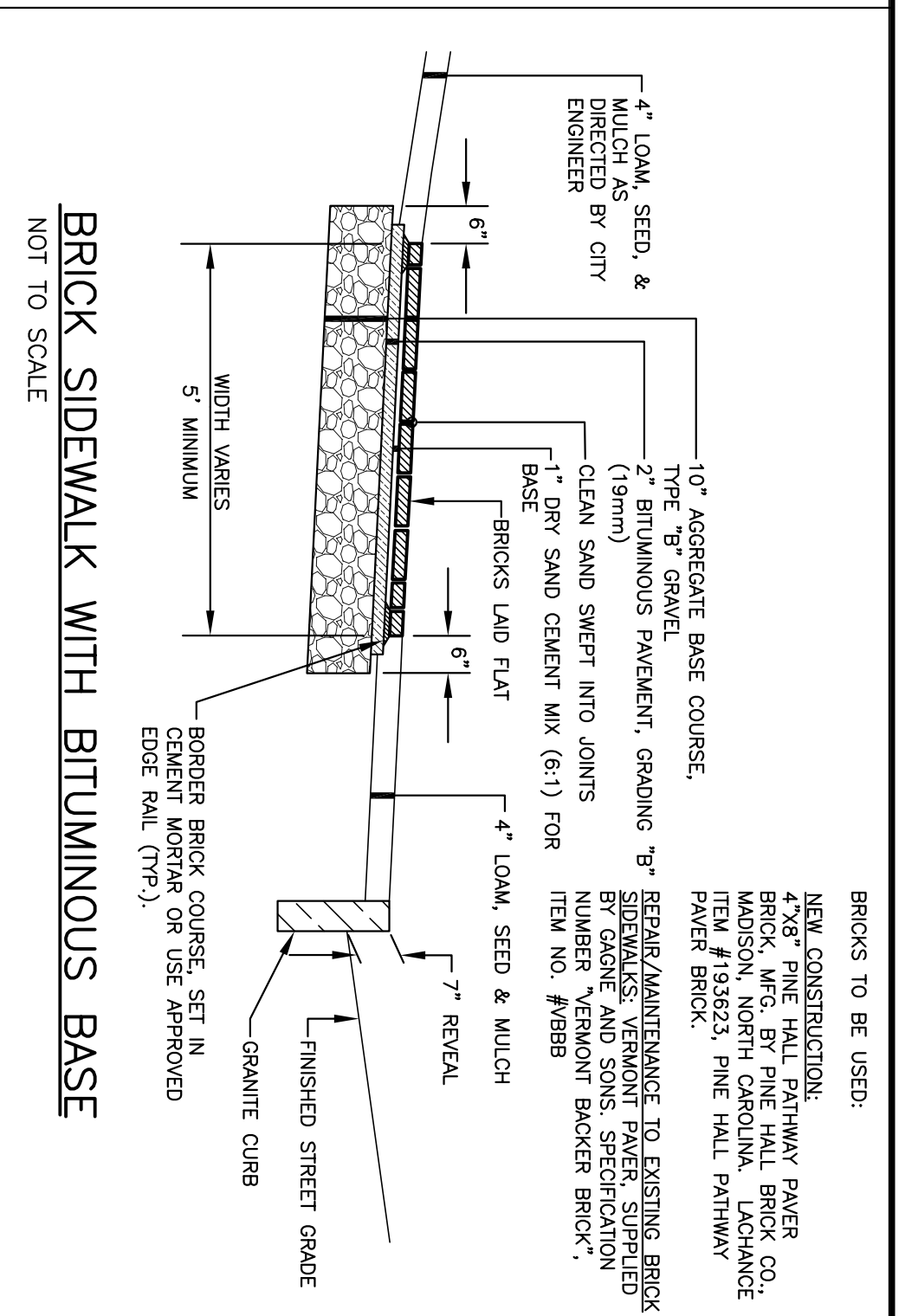

BRICK SIDEWALK WITH BITUMINOUS BASE
NOT TO SCALE

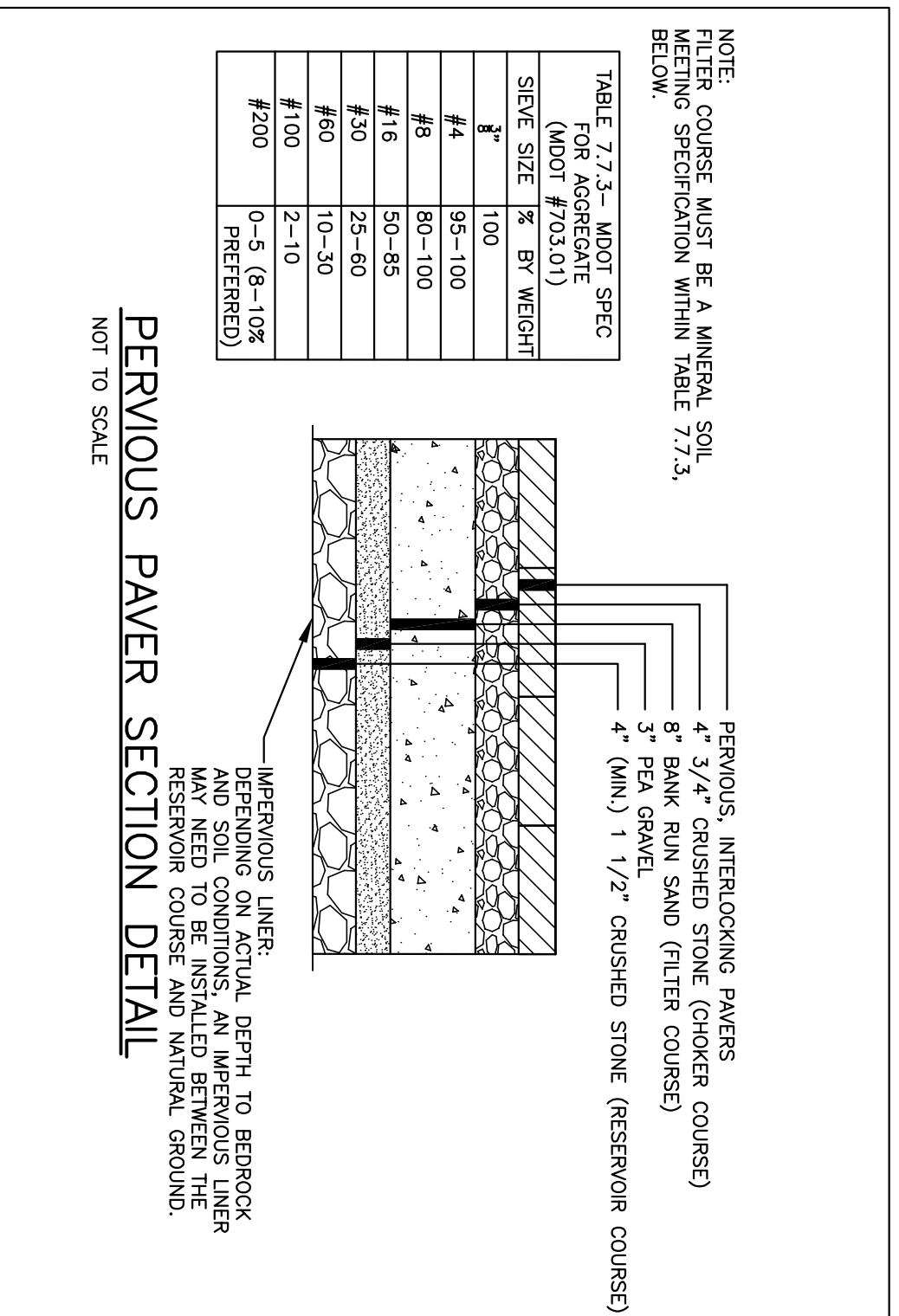

PERVIOUS PAVEMENT SECTION DETAIL
NOT TO SCALE

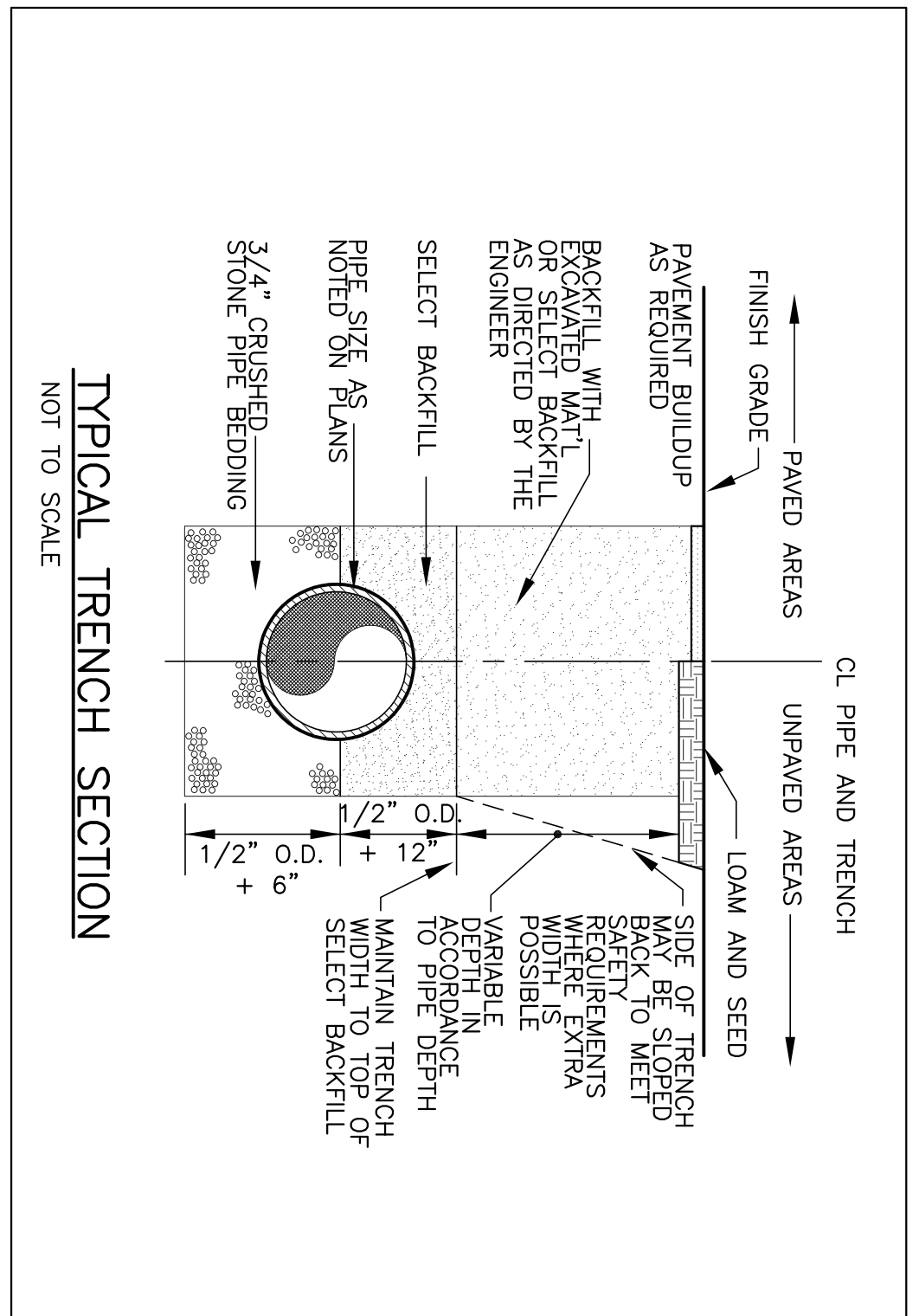

TYPICAL TRENCH SECTION
NOT TO SCALE

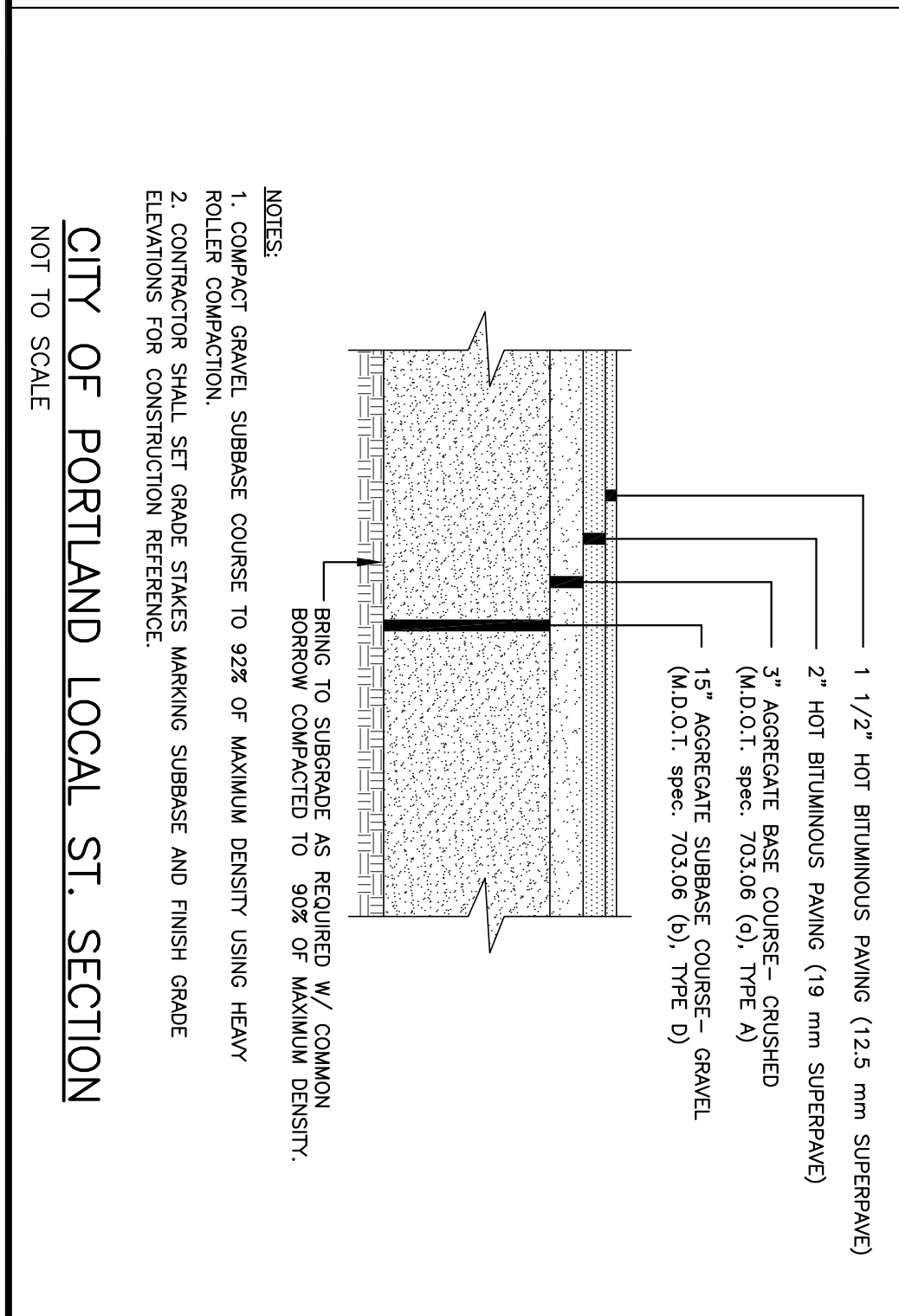

CITY OF PORTLAND LOCAL ST. SECTION
NOT TO SCALE

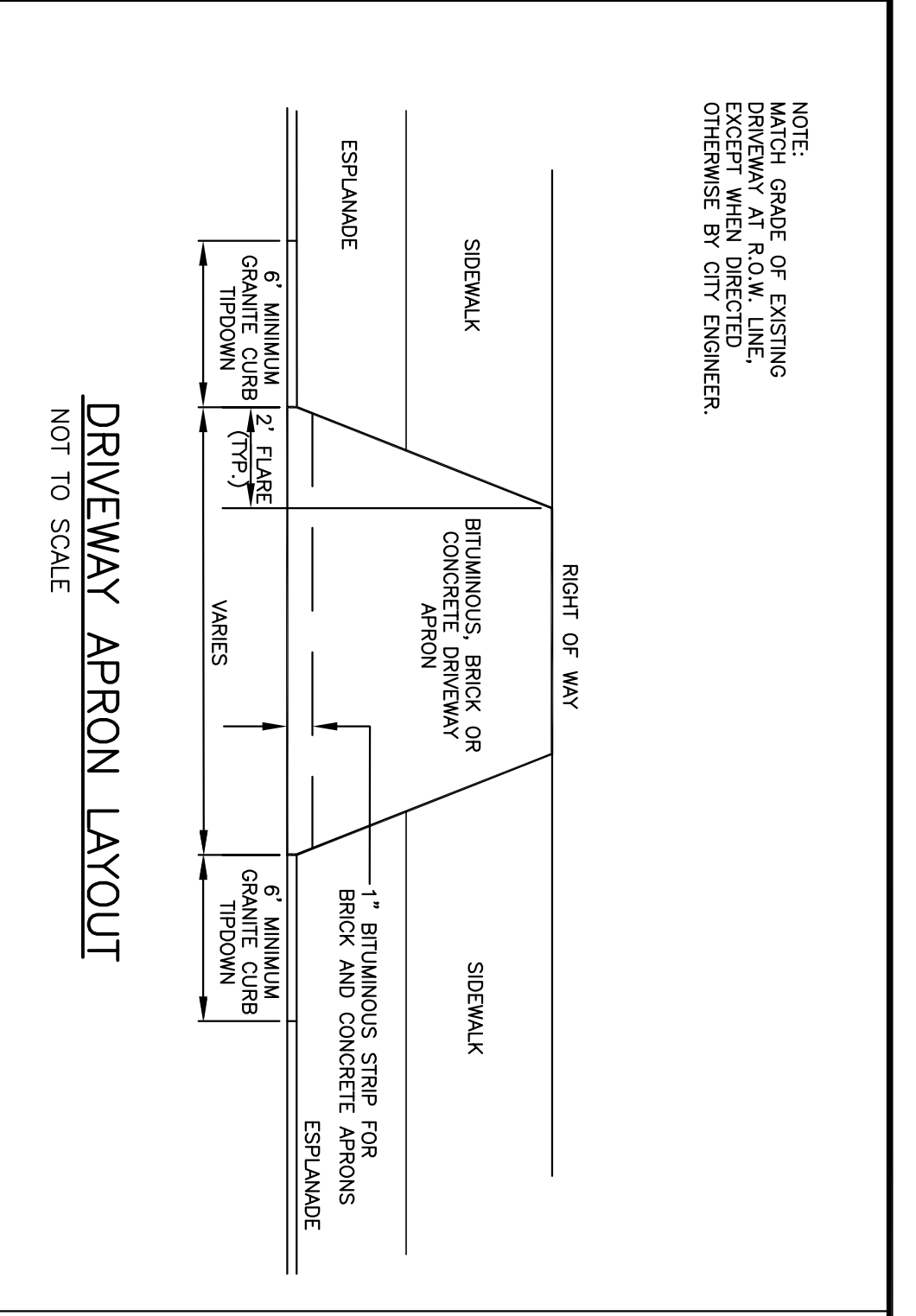

DRIVEWAY APRON LAYOUT
NOT TO SCALE

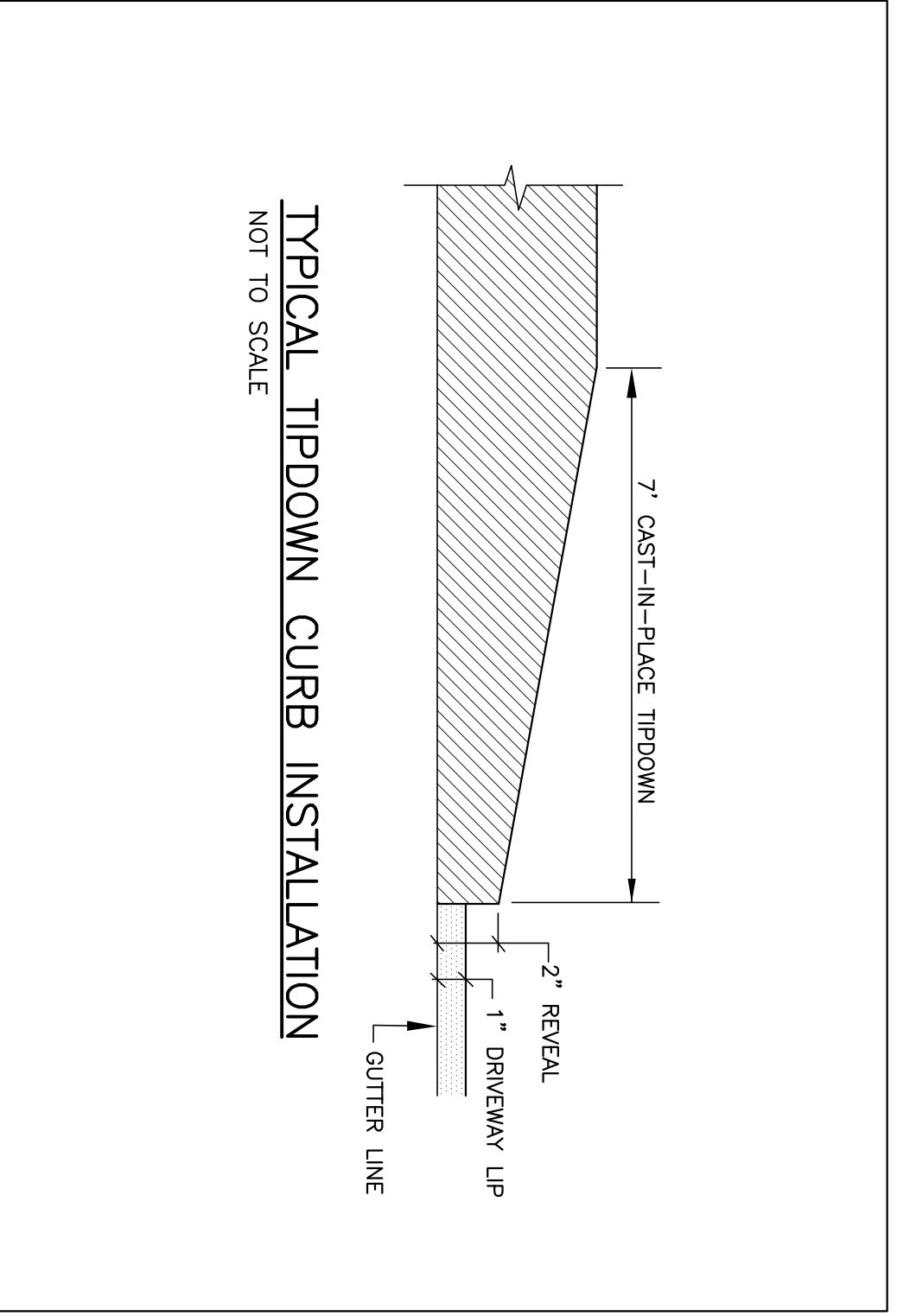

TYPICAL TIPDOWN CURB INSTALLATION
NOT TO SCALE

City of Portland Technical Manual
Section 1 - Transportation Systems and Street Design
Adopted 7-19-10 Rev. 6-17-11-11

BIKE HITCH

Specifications and Space Use

Product: (See Bicyclist) 2 Bikes

Quantity: 2 Bikes

Material: Cast Aluminum

Dimensions: 27" x 15" x 11" (H x W x D)

Notes: An alternative design is required when the standard 200mm wide curb is used. The curb must be 200mm wide and 150mm high. The curb must be 200mm wide and 150mm high. The curb must be 200mm wide and 150mm high.

Installation: In ground, the hitch is installed in the concrete base. The hitch is installed in the concrete base. The hitch is installed in the concrete base.

Space Use and Maintenance: The hitch is installed in the concrete base. The hitch is installed in the concrete base. The hitch is installed in the concrete base.

DATE: AUGUST 2009
REVISIONS:

DATE:	AUGUST 2009	FIGURE:	I-33a
REVISIONS:		FIGURE:	68

CITY OF PORTLAND, MAINE
TECHNICAL STANDARDS MANUAL
SECTION 1

TRANSPORTATION SYSTEMS AND STREET DESIGN

BICYCLE RACK SPECIFICATION - BIKE HITCH

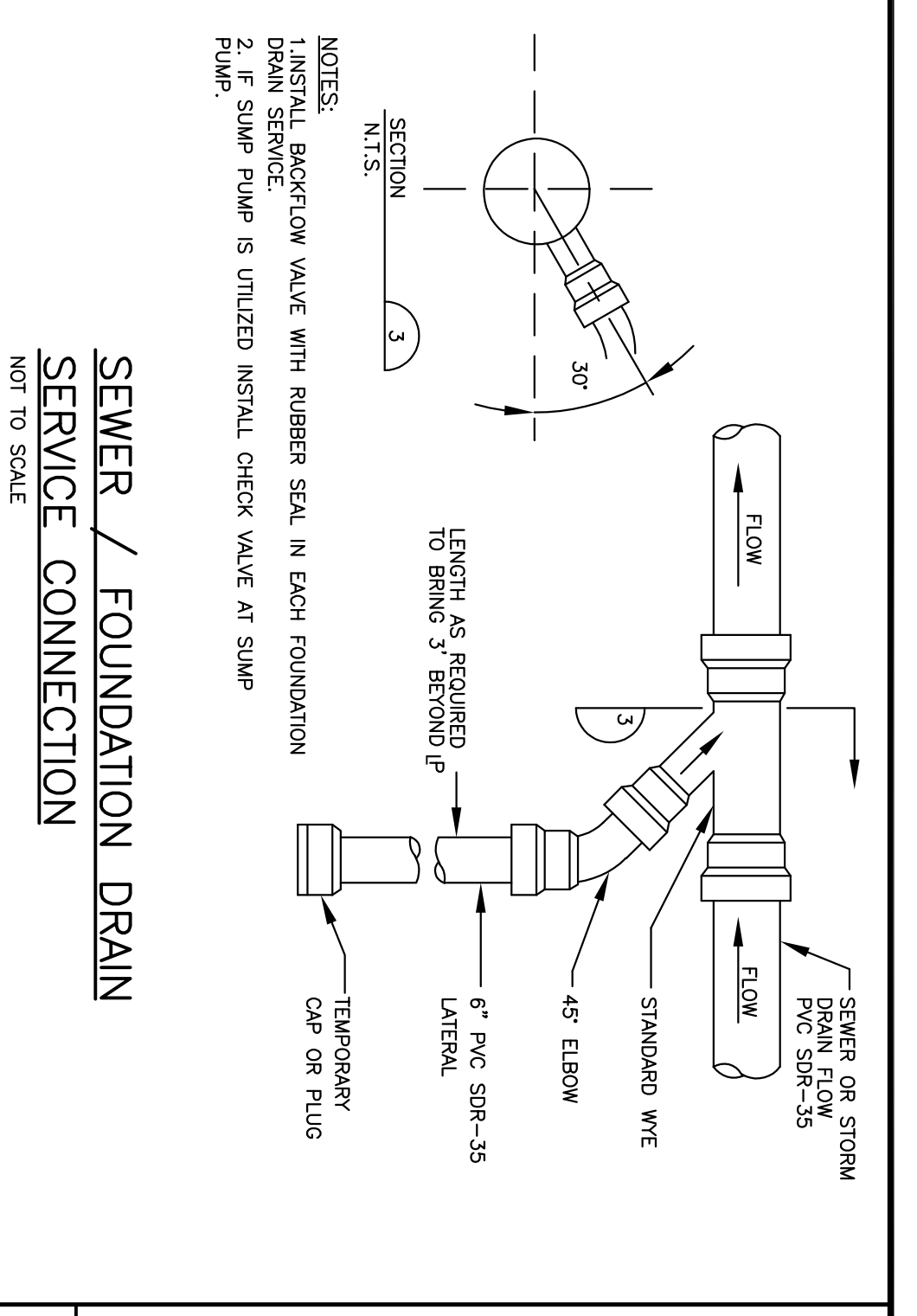

SEWER / FOUNDATION DRAIN SERVICE CONNECTION
NOT TO SCALE

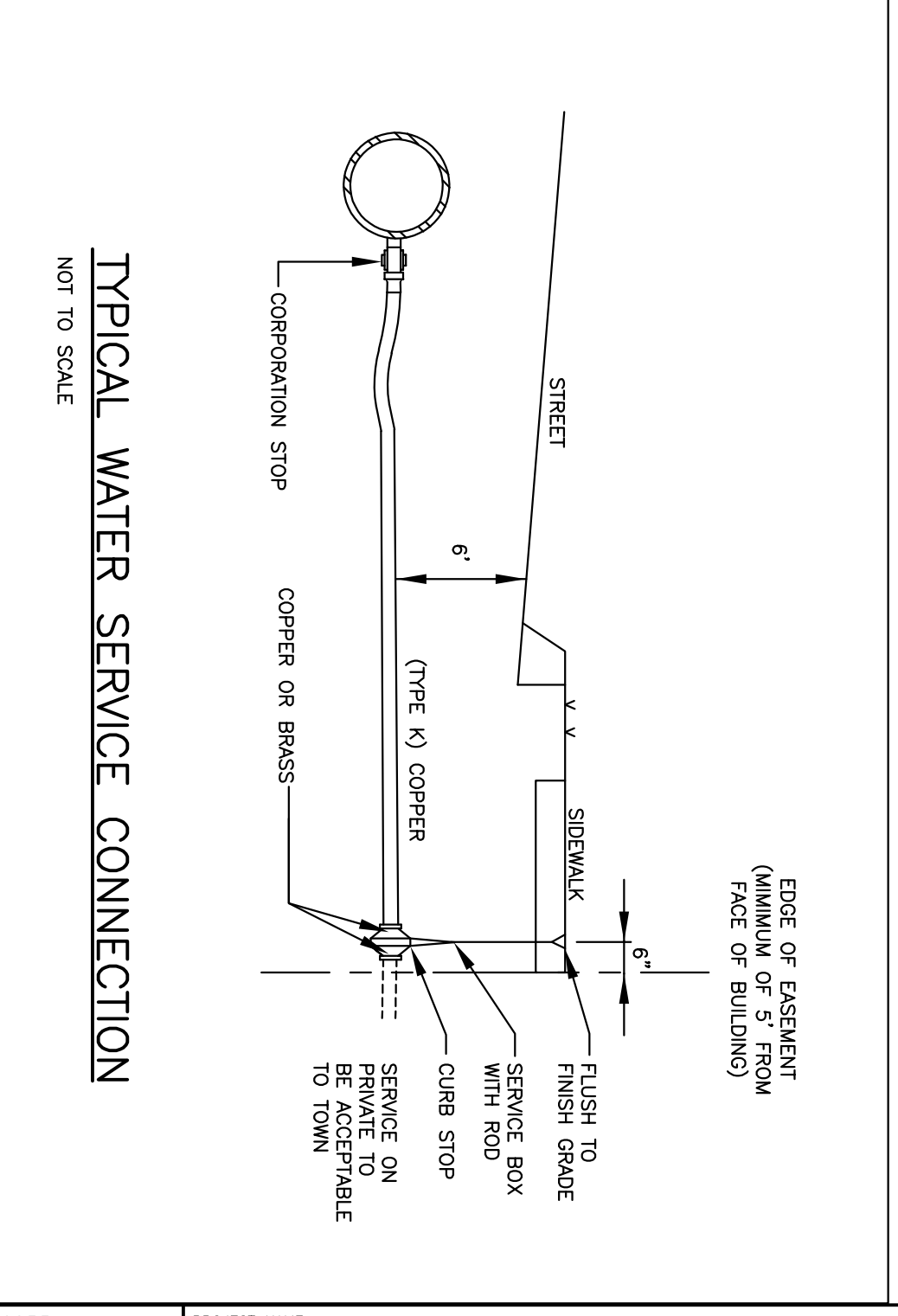

TYPICAL WATER SERVICE CONNECTION
NOT TO SCALE

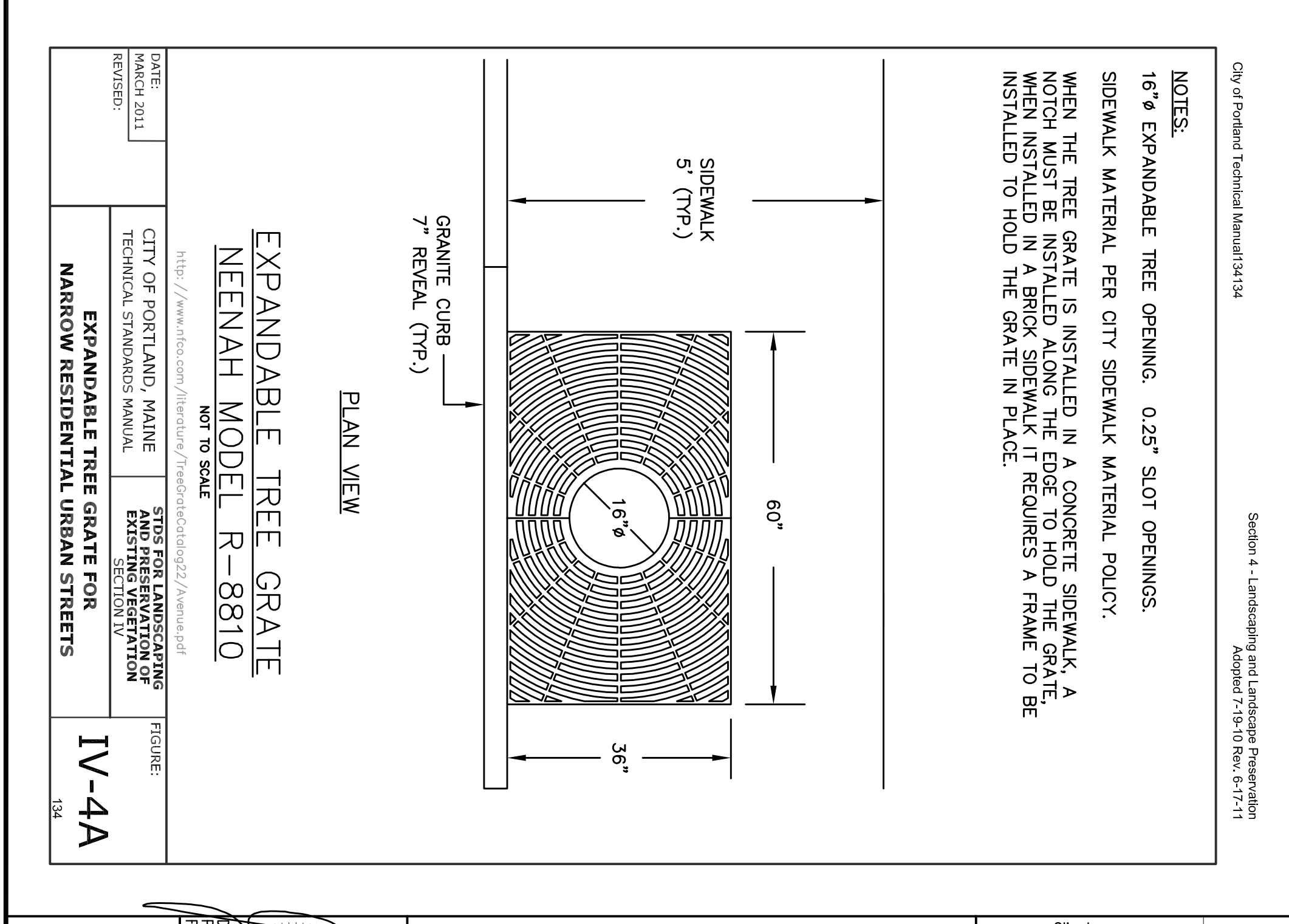

REVISIONS				
NO.	DATE	DESCRIPTION	DRAWN	APPD.
1	9/23	REVISED PER CITY REVIEW COMMENTS	JHW	JHW
2	10/3	REVISED PER CITY REVIEW COMMENTS	JHW	JHW

PROJECT NAME: SEVEN-UNIT BUILDING 30 MERRILL STREET
PORTLAND, MAINE
SHEET NAME: DETAILS

DESIGNED: Client
DRAWN: RGM
CHECKED: JHW
APPROVED: JHW
PLAN DATE: FEB. 23, 2016
CLIENT/RECORD OWNER: BANNER PROPERTIES, LLC 126 UNDERWOOD ROAD FALMOUTH, ME 04105

PROJECT NO. 16055
DRAWING NO. 15215-1PP
FIELDBOOK:
SCALE:
DATE ISSUED: 3-15-16

Plymouth Engineering, Inc.
P.O. Box 46 30 Lower Detroit Road
Plymouth, Maine 04969
Tel: (207) 257-2071 Fax: (207) 257-2130
info@plymouthengineering.com
www.plymouthengineering.com

STATE OF MAINE
PLANNING AND ZONING DEPARTMENT
RECEIVED
MARCH 14 2016
PROJECT NO. 16055
DRAWING NO. 15215-1PP
SHEET 4 OF 4

C4

ERROR: syntaxerror
OFFENDING COMMAND: --nostringval--

STACK:

/Title
()
/Subject
(D:20161003111349-04'00')
/ModDate
()
/Keywords
(PDFCreator Version 0.9.5)
/Creator
(D:20161003111349-04'00')
/CreationDate
(Jon Whitten)
/Author
-mark-