

**PLANTING NOTES**

1. CONTRACTOR SHALL SUPPLY PLANTS IN QUANTITIES SUFFICIENT TO COMPLETE WORK SHOWN ON THE PLAN. ANY DISCREPANCY BETWEEN THE QUANTITIES SHOWN IN THE PLANT SCHEDULE AND THOSE REQUIRED ON THE PLAN SHALL NOT ENTITLE THE CONTRACTOR TO ADDITIONAL RENUNERATION. ANY DISCREPANCIES SHALL BE CLARIFIED WITH THE LANDSCAPE ARCHITECT PRIOR TO ORDERING PLANT MATERIAL.
2. PLANT LAYOUT SHALL BE CONFIRMED BY LANDSCAPE ARCHITECT PRIOR TO INSTALLATION.
3. ALL MATERIALS SHALL CONFORM TO SPECIFICATIONS OF THE AMERICAN STANDARDS FOR NURSERY STOCK (LATEST EDITION) AS SET FORTH BY THE AMERICAN ASSOCIATION OF NURSERYMEN.
4. ALL PLANTS SHALL BEAR THE SAME RELATIONSHIP TO FINISH GRADE AS THE ORIGINAL GRADES BEFORE DIGGING.
5. THE LANDSCAPE CONTRACTOR SHALL CONTACT DIG-SAFE PRIOR TO PLANT INSTALLATION TO CONFIRM UNDERGROUND UTILITY LOCATIONS.
6. NO PLANT MATERIAL SHALL BE INSTALLED UNTIL BED PREPARATION, AND FINISH GRADING HAS BEEN COMPLETED IN THE IMMEDIATE AREA.
7. ALL PLANTS BEDS AND TREE WELLS SHALL HAVE A MINIMUM OF 3" OF UNIFORMLY DISTRIBUTED, DARK, SHREDDED BARK MULCH.
8. ALL PLANTS SHALL BE BALLED AND WRAPPED OR CONTAINER GROWN AS SPECIFIED. ALL ROOT WRAPPING AND CONTAINER MATERIAL MADE OF SYNTHETICS OR PLASTICS SHALL BE REMOVED AT THE TIME OF PLANTING.
9. ALL PLANTS SHALL BE INSTALLED AS PER DETAILS AND THE CONTRACT SPECIFICATIONS. THE LANDSCAPE CONTRACTOR SHALL REFER TO THE CONTRACT SPECIFICATIONS FOR ADDITIONAL REQUIREMENTS.
10. CONTRACTOR SHALL STAKE TREES SHALL IF DEEMED NECESSARY BY L.A.
11. ALL PLANTS SHALL BE WARRANTED FOR ONE FULL YEAR FROM DATE OF INSTALLATION OR UNTIL FINAL ACCEPTANCE.
12. **ALL PAVED ROADWAYS AND SIDEWALKS SHALL BE KEPT CLEAN AND FREE OF DEBRIS FOR THE DURATION OF THE PROJECT.**

**PLANT SCHEDULE**

QTY.	SYM.	BOTANICAL NAME	COMMON NAME	SIZE	REMARKS
TREES					
1	AR	ACER RUBRUM 'KARPICK'	KARPICK MAPLE	2-2.5" CAL.	CONT.
3	AC	AMELANCHIER CANADENSIS	SHADBLOW/SERVICEBERRY	6-7"/CLUMP	B&B
19	AU	ARCTOSTAPHYLOS UVA-URSI	BEARBERRY	1 GAL.	CONT.
6	CB	CARPINUS BETULUS 'FASTIGIATA'	EUROPEAN HORNBEAM	2.5-3" CAL.	
12	DF	DRYOPTERIS FILIX-MAS	WOOD FERN	1 GAL./CONT.	PREP. SOIL
3	FG	FOTHERGILLA GARDENII	DWARF FOTHERGILLA	30-36"	B&B
1	GT	GLEDITSIA TRACANTHOS 'INERMIS'	THORNLESS HONELOCUST	2-2.5" CAL.	CONT.
5	HM	HYDRANGEA MAC. 'TWIST-N-SHOUT'	TWIST-N-SHOUT HYDRANGEA	5 GAL.	B&B
3	IG	ILEX GLABRA 'SHAMROCK'	INKBERRY	24-30"	B&B
1	IVI	ILEX VERTICILLATA 'JIM DANDY'	WINTERBERRY	24-30"	B&B
2	IV2	ILEX VERTICILLATA 'RED SPRITE'	WINTERBERRY	24-30"	B&B
3	MSG	MISCANTHUS SINENSIS 'GRACILLIMUS'	MAIDEN GRASS	3 GAL.	CONT.
3	MS	MISCANTHUS SINENSIS 'MORNING LIGHT'	SILVER GRASS	3 GAL.	CONT.
5	RA	RHUS AROMATICA 'GRO-LOW'	FRAGRANT SUMAC	2 GAL.	CONT.
3	SV	SYRINGA X PRESTONIAE 'DONALD WYMAN'	DONALD WYMAN LILAC	5-6"	B&B
42	VN	VACCINIUM 'NORTHSKY' (HYBRID)	NORTHSKY BLUEBERRY	1.5 GAL./CONT.	PREP. SOIL

NOTE: ALL SUBSTITUTIONS SHALL BE APPROVED BY LANDSCAPE ARCHITECT PRIOR TO ORDERING OF PLANTS

**KING-CLEMENTS RESIDENCE**

46 MERRILL STREET  
PORTLAND, ME

**csia**  
cowles studio | landscape architecture  
189 Main Street  
Yarmouth, Maine 04096  
207.415.4332  
www.cowles-studio.com

Consultants:  
SURVEYOR:  
Nadeau Land Surveys, Inc.  
918 Brighton Ave.  
Portland, ME 04102  
207-878-7870  
ARCHITECT:  
Kevin Browne Architecture  
202 US Route One  
Falmouth, ME 04105  
207-847-3499  
CONTRACTOR:  
Benjamin & Co. Inc.  
136 Maine Street #5  
Brunswick, ME 04111  
207-729-7171

**Drawing Set:**

Date	Revision
7.19.17	STAFF REVIEW
9.19.17	ISSUED FOR PERMIT
1.18.18	RE-ISSUED/PERMIT
3.05.18	REVISED LAYOUT

Drawing Set:  
REISSUED FOR BLDG. PERMIT

Drawn:  
TC

Checked:

Approved:

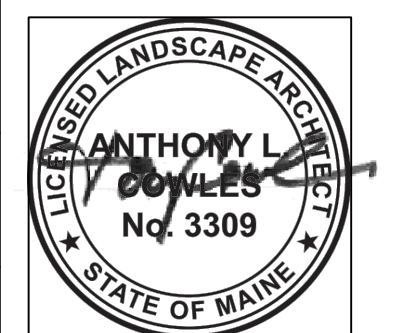

Drawing Title:

LANDSCAPE PLAN

Job Number:

File:

Date: 1-18-2018 Scale: AS SHOWN

Drawing Number:

**L-4.0**

© 2018 COWLES STUDIO

**REVISED LAYOUT**

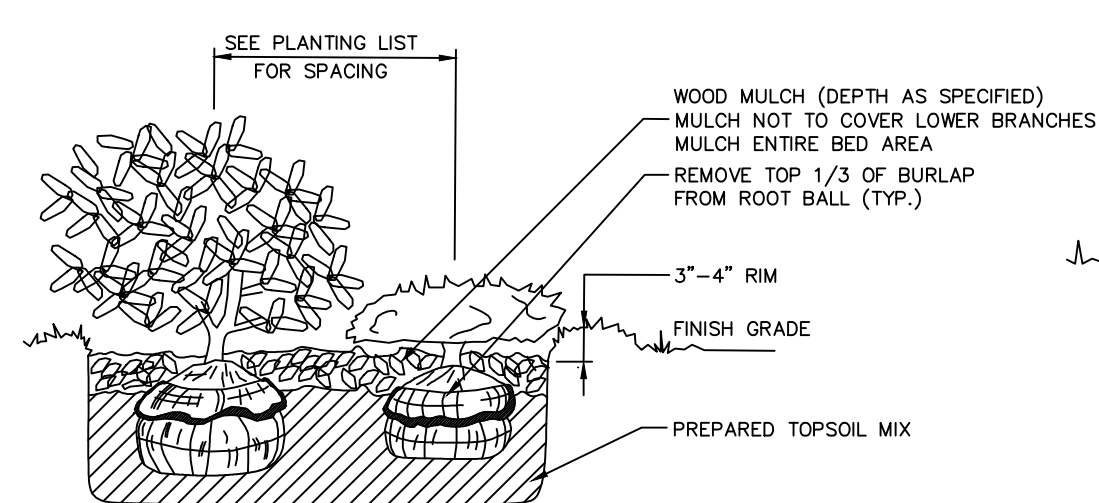
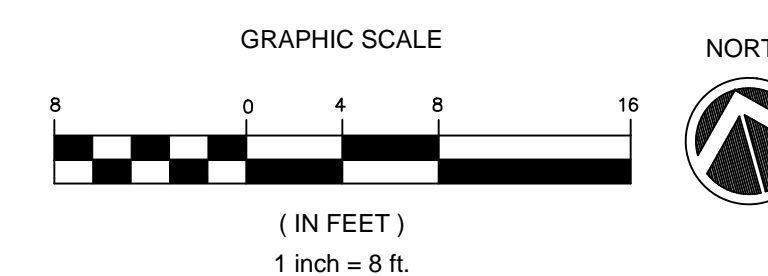

**SHRUB PLANTING DETAIL**

NOT TO SCALE

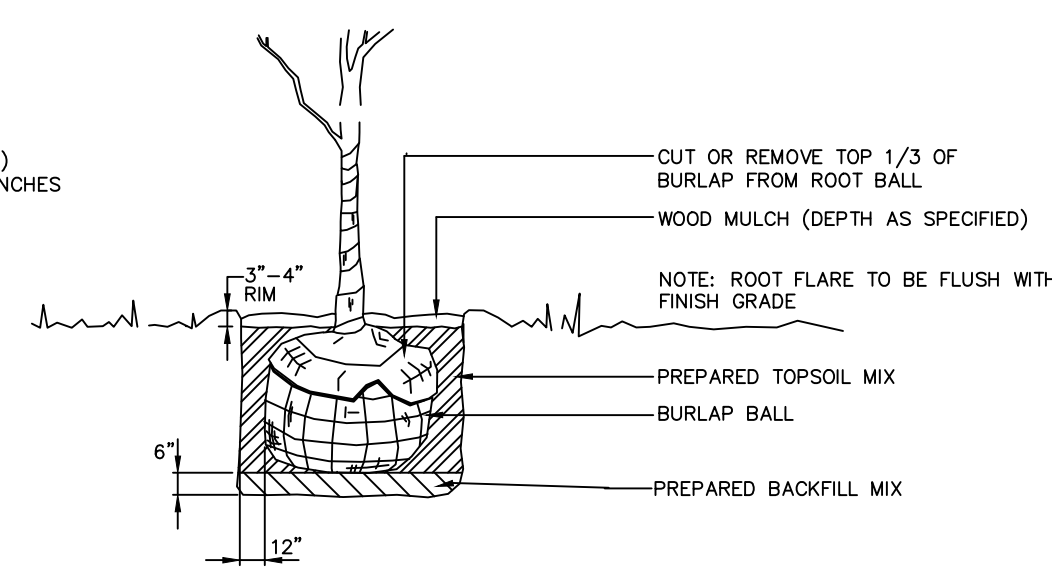

**TREE PLANTING DETAIL**

NOT TO SCALE