

# 1 First Floor Plan

SCALE: 1/4" = 1'-0"

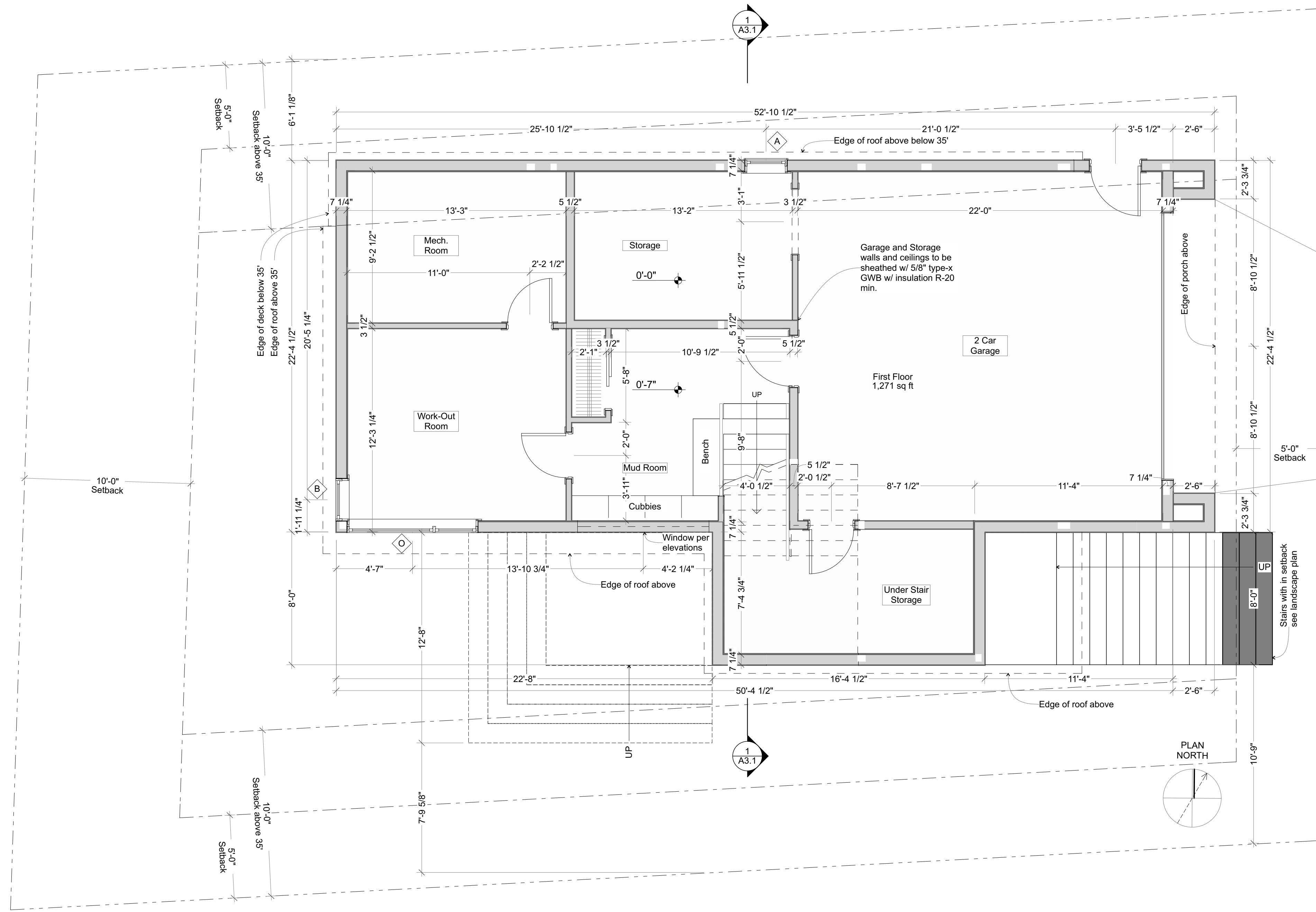

Contractor shall measure and verify all dimensions at the work.  
This drawing is a part of a full set of drawings comprising the contract documents for the work of this project. The architect/owner accepts no responsibility for the contractors' errors or omissions if each trade does not have the full set of drawings and specifications

Copyright 2017 ©  
The material contained in these drawings and the design they are intended to convey are the exclusive property of Kevin Browne Architecture confidentially in connection with construction of the building depicted herein as authorized by Kevin Browne Architecture recipient agrees to abide by these restrictions. Any use, reproduction or disclosure of any information, in whole or in part, contained herein, without written permission of Kevin Browne Architecture, is expressly prohibited.

## First Floor Plan

DATE: 9/19/17  
PROJECT NO.: 2017-10  
DRAWN: KBA  
SCALE: As Noted

## Clements - King Residence

Tyler & Lily  
46 Merrill Street Portland, Maine

CONSULTANTS:

REVISIONS:  
9-19-2017: Issue for permit

