

GENERAL SHEET NOTES

1. CONTRACTOR COORDINATE MEP
2. DOORS TO STAIR-01 TO BE SELF-CLOSING, POSITIVE LATCHING RATED DOORS FOR 1HR FIRE PARTITION FURNITURE BY OWNER
3. REPLACEMENT EGRESS WINDOWS AT BEDROOMS AS REQUIRED (TYP)

STAIR NOTES

1. RADIUS ON TREAD NOSING TO BE 3/4" MAXIMUM IN THE HORIZONTAL DIRECTION
2. TREAD OVERHANG TO BE 1/2" MAXIMUM
3. TREAD AND LANDING SLOPE SHALL NOT EXCEED 1:48
4. TREAD DEPTH TO BE 11" MIN, RISER HEIGHT TO BE 7" MAX.
5. TREAD DEPTH SHALL BE MEASURED HORIZONTALLY BETWEEN VERTICAL PLANES OF THE FOREMOST PROJECTION (STAIR NOSING TO STAIR NOSING)
6. VARIATION IN THE DEPTH OF ADJACENT TREADS TO BE 3/16" MAXIMUM
7. TOLERANCE BETWEEN LARGEST AND SMALLEST RISERS NOT TO EXCEED 3/8" IN ANY SINGLE FLIGHT
8. IF NOT VERTICAL, RISERS SHALL BE PERMITTED TO SLOPE UNDER TREAD AT ANGLE NOT TO EXCEED 30 DEGREES FROM VERTICAL, PROVIDED THE PROJECTION OF THE NOSING DOES NOT EXCEED 1/2"

First Floor Plan
Scale: 3/16" = 1'-0"

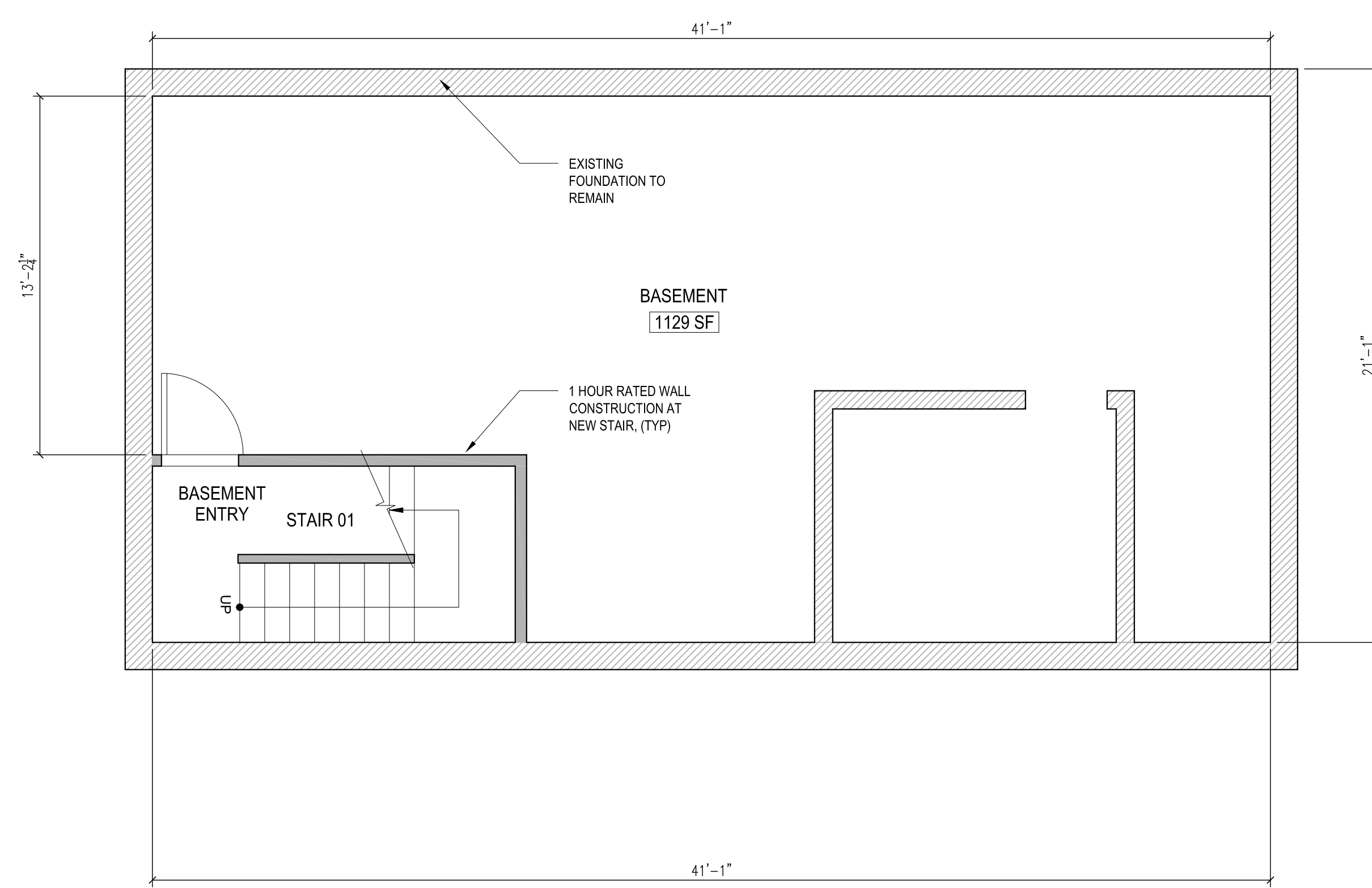

Basement Plan
Scale: 1/4" = 1'-0"
 - Existing Wall
 - New Wall

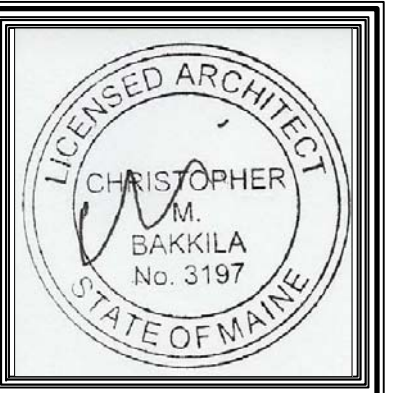

NO.	DATE	DESCRIPTION
REVISIONS		

CUSTOM CONCEPTS, INC.
 ARCHITECTURE
 383 U.S. ROUTE 1, SUITE 1A, SCARBOROUGH, MAINE 04074
 Phone: (207) 883-0083
 WWW.CUSTOMCONCEPTSINC.COM
 PROJECT: PENSICO APARTMENT FIT-OUT
 DRAWING TITLE: FLOOR PLANS
 JOB NUMBER: 9283-17
 DRAWN BY: CMB
 SCALE: AS NOTED
 CLIENT REVIEW FOR PERMITS: ESTIMATING CONSTRUCTION
 CONTACT DOCUMENTS FOR PERMITS: CONSTRUCTION

