



Reviewed for Code Compliance
Inspections Division
Approved with Conditions
Date: 10/27/14

General Building Permit Application

If you or the property owner owes real estate or personal property taxes or user charges on any property within the City, payment arrangements must be made before permits of any kind are accepted.

Address/Location of Construction: <u>MATTHEW SUKEFORTH 48 LAFAYETTE ST PORTLAND</u>		
Total Square Footage of Proposed Structure:		<u>MAINE 04101</u>
Tax Assessor's Chart, Block & Lot Chart# Block# Lot#	Applicant Name: <u>JOHN TORPIE</u> Address: <u>3 BOCHIE WAY</u> City, State & Zip: <u>SCAR, ME 04074</u>	Telephone: <u>939-7192</u> Email: <u>LEGACYCO @ GMAIL.COM</u>
Lessee/Owner Name : (if different than applicant) Address: <u>MATTHEW SUKEFORTH</u> City, State & Zip: <u>48 LAFAYETTE ST</u> Telephone & E-mail: <u>776-8406</u>	Contractor Name: (if different from Applicant) Address: <u>SAME</u> City, State & Zip: Telephone & E-mail:	Cost Of Work: \$ <u>3,000.00</u> C of O Fee: \$ _____ Historic Rev \$ _____ Total Fees : \$ _____
Current use (i.e. single family) <u>MULTI FAMILY</u>		
If vacant, what was the previous use? _____		
Proposed Specific use: _____		
Is property part of a subdivision? ___ If yes, please name _____		
Project description: <u>WINDOW REPLACEMENT - INSTALLING POCKET WINDOWS</u> <u>DOOR REPLACEMENT - INSTALLING FIRE DOORS</u>		
Who should we contact when the permit is ready: <u>JOHN TORPIE</u>		
Address: _____		
City, State & Zip: <u>SEE ABOVE</u>		
E-mail Address: _____		
Telephone: _____		

Please submit all of the information outlined on the applicable checklist. Failure to do so causes an automatic permit denial.

In order to be sure the City fully understands the full scope of the project, the Planning and Development Department may request additional information prior to the issuance of a permit. For further information or to download copies of this form and other applications visit the Inspections Division on-line at www.portlandmaine.gov, or stop by the Inspections Division office, room 315 City Hall or call 874-8703.

I hereby certify that I am the Owner of record of the named property, or that the owner of record authorizes the proposed work and that I have been authorized by the owner to make this application as his/her authorized agent. I agree to conform to all applicable laws of this jurisdiction. In addition, if a permit for work described in this application is issued, I certify that the Code Official's authorized representative shall have the authority to enter all areas covered by this permit at any reasonable hour to enforce the provisions of the codes applicable to this permit.

Signature: [Signature] Date: 10/3/14

This is not a permit; you may not commence ANY work until the permit is issued.

BUILDING INSPECTIONS @ PORTLANDMAINE.GOV



Reviewed for Code Compliance
Inspections Division
Approved with Conditions
Date: 10/27/14

Enter ZIP code to see _____

ReliaBilt Fire Resistant 6-Panel Prehung Inswing Steel Entry Door (Common: 32-in x 80-in; Actual: 31.75-in x 79-in)

Item # 16593 | Model # 16593

Be the first to

Tweet 0

Description

Fire Resistant 6-Panel Prehung Inswing Steel Entry Door (Common: 32-in x 80-in; Actual: 31.75-in x 79-in)

- 90 minute fire rated door with fire rated steel frame
- Rust and corrosion resistant galvanized steel
- Energy-saving insulated core
- Ready to paint with smooth primed surface
- Limited Lifetime Warranty

Specifications

Glass Style	None	Look and feel of real woodgrain	No
Glass Caming	N/A	Fire Resistant	Yes
Glass Insert Shape/Style	N/A	Lowe's Exclusive	Yes
Brickmould	No	Blinds Between the Glass	N/A
Door Swing	Inswing	Prefinish Color	None
Rough Opening Height (Inches)	82	Optional Additions Available	None
Masonry Opening Height (Inches)	83.75	Sidelite Width (Inches)	0
Masonry Opening Width (Inches)	37.25	Door Style	6 panel
Sill Type	Fixed	ENERGY STAR Qualified Northern Zone	Yes
Sill Finish	Mill	ENERGY STAR Qualified North Central Zone	Yes
Lockset Bore	Yes	ENERGY STAR Qualified Southern Zone	Yes
Collection Name	Fire-Rated	Ins Technology	No
Type	6 panel	Door Handing	Left
Prefinished	No	Rot-Resistant Frame	No
Primed	Yes	Slab or Prehung	Prehung
Paintable	Yes	Hinge Finish	Polished brass
Caming Option	N/A	Common Height (Inches)	80
Vented Glass with Screen	N/A	Common Jamb Width (Inches)	4.5625
Construction	Insulating core	Common Width (Inches)	32
Glass Insulation	N/A	Height (Actual) (Inches)	79
Lockset Option	Ready for lockset and deadbolt	Jamb Width (Actual) (Inches)	4.5625
Tempered Glass	N/A	Width (Actual) (Inches)	31.75

Customers Also Viewed



1ST FLOOR

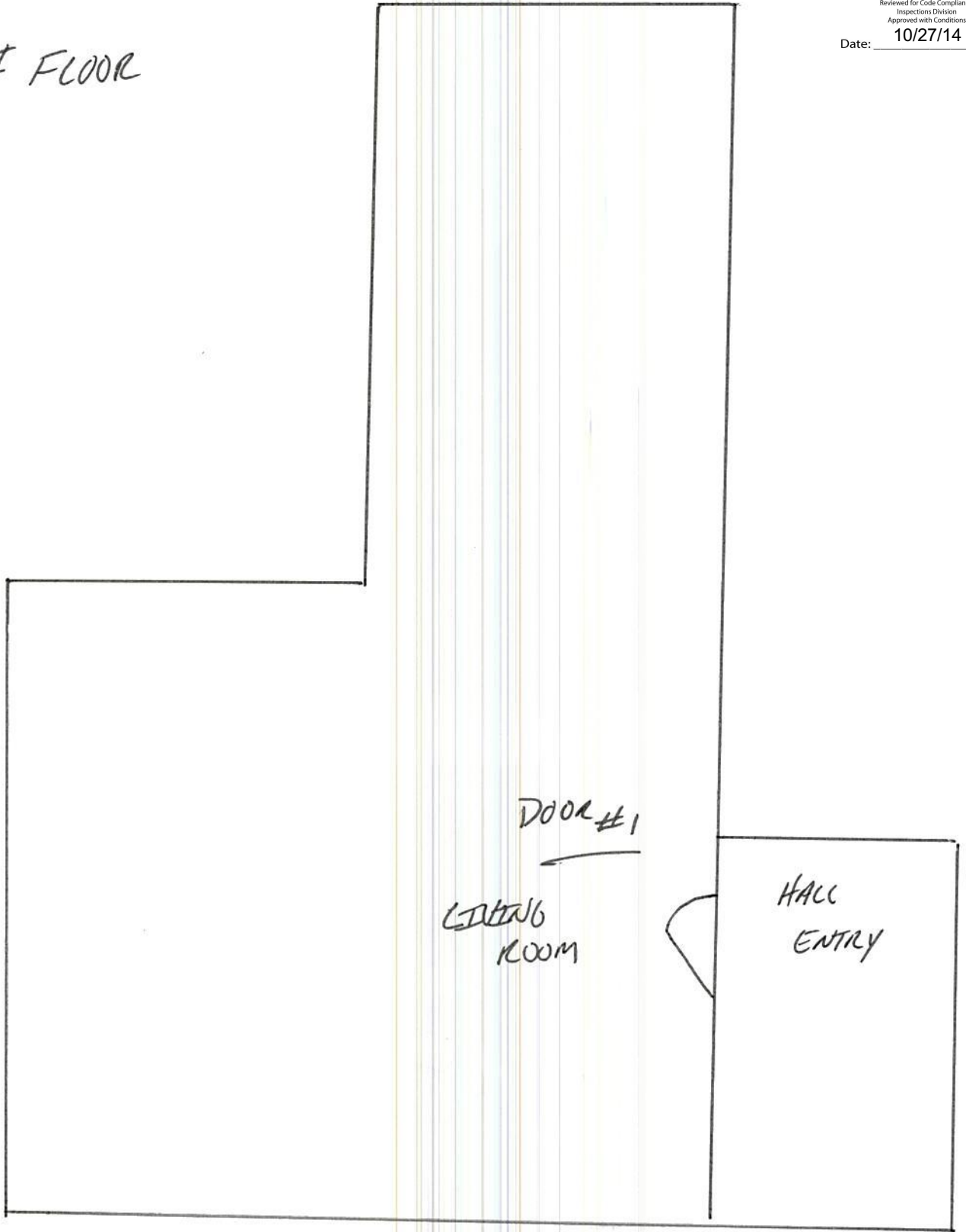



2ND FLOOR

- ALL WINDOWS ARE:

DIRECT REPLACEMENT/
POCKET WINDOWS

NO ADJUSTMENT MADE
TO STRUCTURE

- ALL DOORS TO BE REPLACED

ARE
FINE
DOORS

WINDOW #1

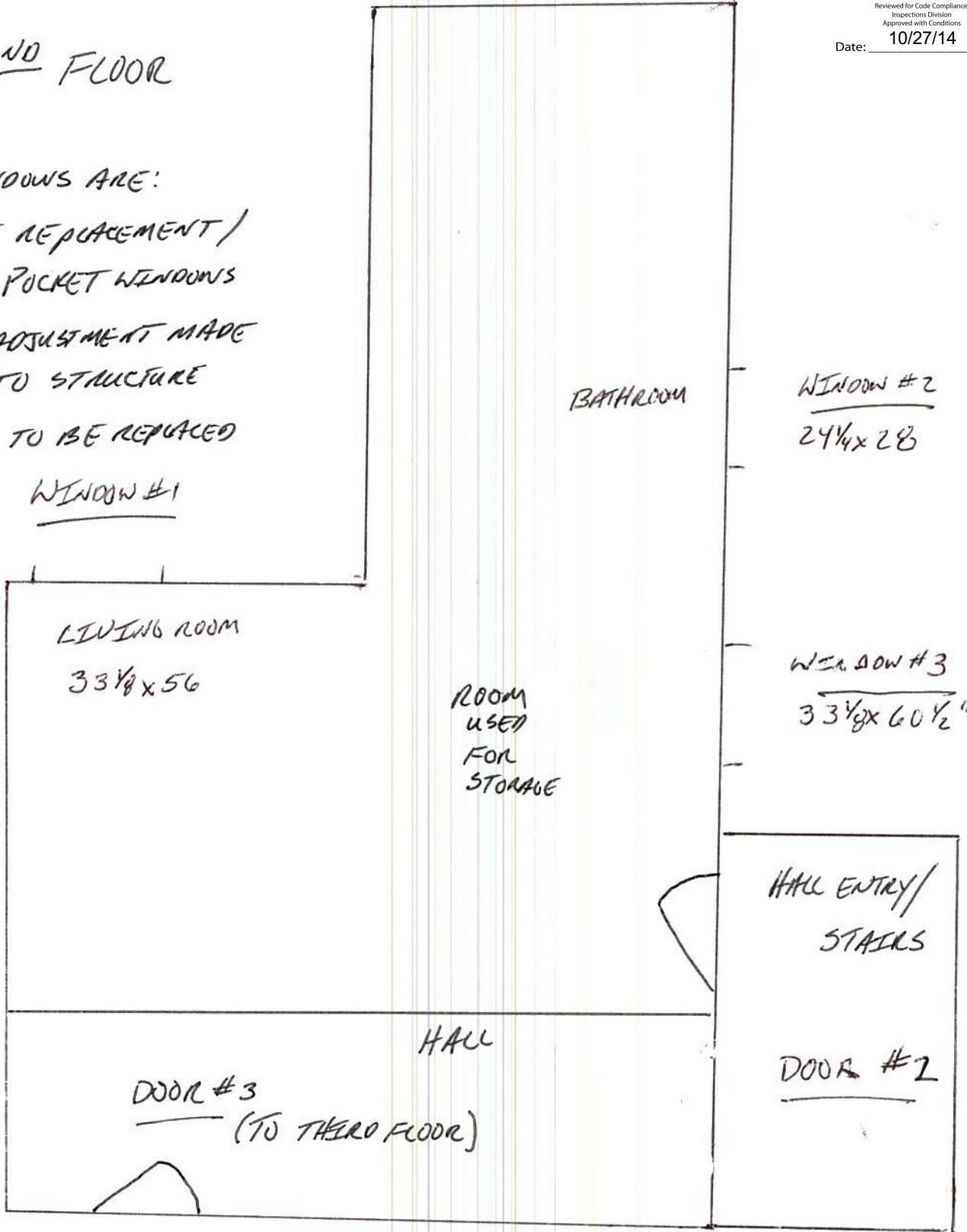

BATHROOM

WINDOW #2

24 1/4 x 28

LIVING ROOM

33 1/8 x 56

ROOM
USED
FOR
STORAGE

WINDOW #3

33 1/8 x 60 1/2"

HALL ENTRY/
STAIRS

HALL

DOOR #3

(TO THIRD FLOOR)



DOOR #2



Reviewed for Code Compliance
Inspections Division
Approved with Conditions

Date: 10/27/14

Remove this label after final inspection; SAVE for future reference

 National Fenestration Rating Council, Inc.	Pella Corporation 20 Replacement Double Hung Annealed One Wide Advanced Low - E Argon Gas	
	CERTIFIED PEL - N - 108 - 00043 - 00001	

ENERGY PERFORMANCE RATINGS		
U-Factor	Solar Heat Gain Coefficient	
0.30 <small>(U.S./I-P)</small>	1.70 <small>(Metric/SI)</small>	0.28
ADDITIONAL PERFORMANCE RATINGS		
Visible Transmittance		
0.53		--

Manufacturer stipulates that these ratings conform to applicable NFRC procedures for determining whole product performance. NFRC ratings are determined for a fixed set of environmental conditions and a specific product size. NFRC does not recommend any products and does not warrant the suitability of any product for any specific use. For more information, call (641)621-3114 or visit the Pella web site at www.pella.com or visit the NFRC web site at www.nfrc.org

Wind Load Design Pressure (DP) +35/-35psf +1680/-1680pa Per ASTM E330	ENERGY STAR Qualified in Highlighted Regions
Air In/Ex: A2 Water Inlet Pressure 6.06psf 290pa	 <small>Qualified</small>

 WDMA Hallmark Certified www.wdma.com	Licensee: 411-H-862 ThermaStar by Pella - Double Hung Manufacturer Stipulates Hallmark Certification as indicated below
AAMA/WDMA/CSA 101/S.2/A440-08	R-PG35: Size Tested 914x1575mm(36x62in) - Type H

WDMA HALLMARK CERTIFICATION requires the performance of at least one product of the product line to be tested in accordance with the applicable performance standards and verified by an independent party. The certification indicates that the product(s) of the product line passed the applicable tests. The certification does not apply to mulled and/or product combinations unless noted. Actual product results will vary and change over the product's life. For details, go to www.wdma.com.

Complies with HUD 111 (Gettyburg PA)



Florida Product Approval System (FPAS) Number: FL11152
 Texas Dept. of Insurance (TDI) Evaluation Report Number: WIN-816
 Glazing type and thickness: Annealed, 2.5MM both panes, designed per ASTM E1300
 Window or Door Actual Size: 33.25" wide by 66.000" tall





Reviewed for Code Compliance
Inspections Division
Approved with Conditions

Date: 10/27/14

Remove this label after final inspection; SAVE for future reference

 National Fenestration Rating Council®	Pella Corporation 20 Replacement Double Hung Annealed One Wide Advanced Low - E Argon Gas		
	CERTIFIED EL - N - 108 - 00043 - 00001		
ENERGY PERFORMANCE RATINGS			
U - Factor 0.30 <small>(U.S./I - P)</small>		Solar Heat Gain Coefficient 1.70 <small>(Metric/SI)</small>	0.28
ADDITIONAL PERFORMANCE RATINGS			
Visible Transmittance 0.53		---	
Manufacturer stipulates that these ratings conform to applicable NFRC procedures for determining whole product performance. NFRC ratings are determined for a fixed set of environmental conditions and a specific product size. NFRC does not recommend any products and does not warrant the suitability of any product for any specific use. For more information, call (641)621-3114 or visit the Pella web site at www.pella.com or visit the NFRC web site at www.nfrc.org			

Wind Load Design Pressure (DP) +35/-35psf +1680/-1680pa Per ASTM E330	ENERGY STAR® Qualified in Highlighted Regions	
Air In/Ex A2 Water Test Pressure 6.06psf 290pa		

 WDMA Hallmark Certified www.wdma.com	Licensee: 411 - H - 862 ThermaStar by Pella - Double Hung Manufacturer Stipulates Hallmark Certification as indicated below
AAMA/WDMA/CSA 1011/S 2/A440-08	R - PG35: Size Tested 914x1575mm(36x62in) - Type H
WDMA HALLMARK CERTIFICATION requires the performance of at least one product of the product line to be tested in accordance with the applicable performance standards and verified by an independent party. The certification indicates that the product(s) of the product line passed the applicable tests. The certification does not apply to mulled and/or product combinations unless noted. Actual product results will vary and change over the product's life. For details, go to www.wdma.com .	

Complies with HUD 111 (Gettysburg PA)



Florida Product Approval System (FPAS) Number: FL11152
Texas Dept. of Insurance (TDI) Evaluation Report Number: WIN-816
Glazing type and thickness: Annealed, 2.51" (both panes), designed per ASTM E1300
Window or Door Actual Size: 24.250" wide by 28.000" tall



Reviewed for Code Compliance
Inspections Division
Approved with Conditions

Date: 10/27/14

Remove this label after final inspection; SAVE for future reference

 National Fenestration Rating Council®	Pella Corporation 20 Replacement Double Hung Annealed One Wide Advanced Low-E Argon Gas PEL-N-108-00043-00001	
	CERTIFIED	
ENERGY PERFORMANCE RATINGS		
U-Factor 0.30 <small>(U.S./I-°)</small>	1.70 <small>(Metric/SI)</small>	Solar Heat Gain Coefficient 0.28
ADDITIONAL PERFORMANCE RATINGS		
Visible Transmittance 0.53	---	
<p>Manufacturer stipulates that these ratings conform to applicable NFRC procedures for determining whole product performance. NFRC ratings are determined for a fixed set of environmental conditions and a specific product size. NFRC does not recommend any products and does not warrant the suitability of any product for any specific use. For more information, call (641)621-3114 or visit the Pella web site at www.pella.com or visit the NFRC web site at www.nfrc.org</p>		

Wind Load Design Pressure (DP) +35/-35psf +1680/-1680pa Per ASTM E330	ENERGY STAR® Qualified in Highlighted Regions
Air In/Ex A2 Water Test Pressure 6.06psf 290pa	 

 WDMA Hallmark Certified www.wdma.com	Licensee: 411-H-862 ThermaStar by Pella - Double Hung Manufacturer Stipulates Hallmark Certification as indicated below
AAMA/WDMA/CSA 101/ISO 2/A440-08	R-PG35, Size Tested 914x1575mm(36x62in) - Type H
<p>WDMA HALLMARK CERTIFICATION requires the performance of at least one product of the product line to be tested in accordance with the applicable performance standards and verified by an independent party. The certification indicates that the product(s) of the product line passed the applicable tests. The certification does not apply to mulled and/or product combinations unless noted. Actual product results will vary and change over the product's life. For details, go to www.wdma.com.</p>	

Complies with HUD 111 (Gettysburg, PA)

Florida Product Approval System (FPAS) Number: FL11152
 Texas Dept. of Insurance (TDI) Evaluation Report Number: WIN-816
 Glazing type and thickness: Annealed, 2.5MM both panes, designed per ASTM E1300
 Window or Door Actual Size: 33.125" wide by 60.500" tall