

FILE NUMBER: 16015
 ATTORNEY: THOMAS F. JEWELL, ESQ.
 TITLE COMPANY: NOT APPLICABLE
 LENDER: NOT APPLICABLE OR NOT AVAILABLE
 OWNER: RALPH & DONNA LAMB
 APPLICANT: RALPH & DONNA LAMB
 DATE: 01/02/98

FLOOD HAZARD INFORMATION
 FLOOD MAP COMMUNITY NO.: 230051 ZONE: C
 PANEL: 0014 B DATED: 07/15/92
TITLE REFERENCE
 DEED BOOK: P/O 10572 PAGE: 25
 PLAN BOOK: N/A PAGE: N/A LOT(S): N/A
 PLAN NUMBER: N/A OF N/A
ASSESSORS MAP
 MAP: 13 BLOCK: M PARCEL: 002

MORTGAGE INSPECTION PLAN
 106 CUMBERLAND AVENUE, PORTLAND, ME

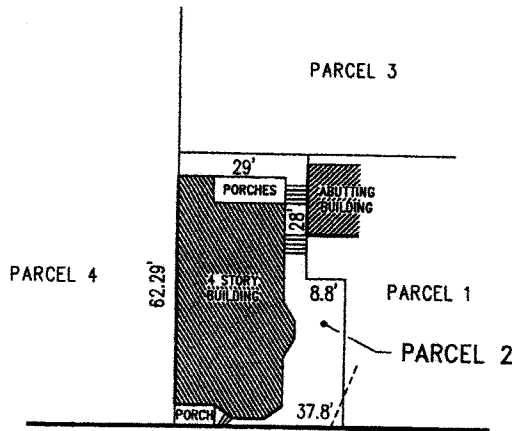

NOTE:
 IT APPEARS PARCEL 1 AND PARCEL 2
 SHARE A SET OF STAIRS.

CUMBERLAND AVENUE

TO WASHINGTON AVENUE →

**MORTGAGE LENDER
 USE ONLY**

THIS IS NOT A BOUNDARY SURVEY.
 THIS IS THE RESULT OF TAPE MEASUREMENT, NOT THE RESULT OF AN INSTRUMENT SURVEY AND IS CERTIFIED TO THE TITLE INSURANCE COMPANY AND ABOVE LISTED ATTORNEY AND LENDER.
 THERE ARE NO DEEDED EASEMENTS IN THE ABOVE REFERENCED DEED OR ENCROACHMENTS WITH RESPECT TO BUILDINGS SITUATED ON THIS LOT EXCEPT AS SHOWN.
 THE LOCATION OF THE DWELLING SHOWN DOES NOT FALL WITHIN A SPECIAL FLOOD HAZARD ZONE.
 THE LOCATION OF THE DWELLING AS SHOWN HEREON WAS IN COMPLIANCE WITH THE LOCAL ZONING LAWS IN EFFECT WHEN CONSTRUCTED (WITH RESPECT TO STRUCTURAL SETBACK REQUIREMENTS ONLY).
 PARCEL NUMBERS FROM ASSESSOR'S MAP.

DES LAURIERS & ASSOCIATES, INC.
 PROFESSIONAL LAND SURVEYORS / GIS CONSULTANTS
 30' 0 30' 60'
 153 US ROUTE 1, SCARBOROUGH, ME 04074-9054
 (800) 882-2227 PHONE (207) 883-1001 FAX

[Handwritten signature]

GENERAL NOTES: (1) The declaration made above are on the basis of my knowledge, information, and belief as the result of a mortgage inspection tape survey made to the normal standard of care of professional land surveyors practicing in Maine. (2) Declarations are made to the above named client only as of this date. (3) This plan was not made for recording purposes, for use in preparing deed descriptions or for constructions. (4) Verifications of property line dimensions, building offsets, fences, or lot configuration may be accomplished only by an accurate instrument survey.