

GLAZING SCHEDULE	
KEY	GLAZING TYPE
GL-1	INSULATED CLEAR GLAZING
GL-2	FIRE RATED INSULATED GLAZING
GL-3	CLEAR TEMPERED GLASS
GL-4	CLEAR INSULATED TEMPERED GLASS
GL-5	FIRE RATED GLAZING

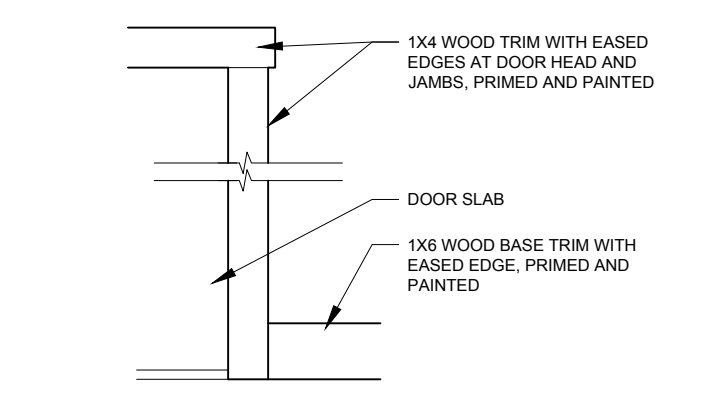

2 TYPICAL DOOR TRIM WITHIN DWELLING UNIT
NOT TO SCALE

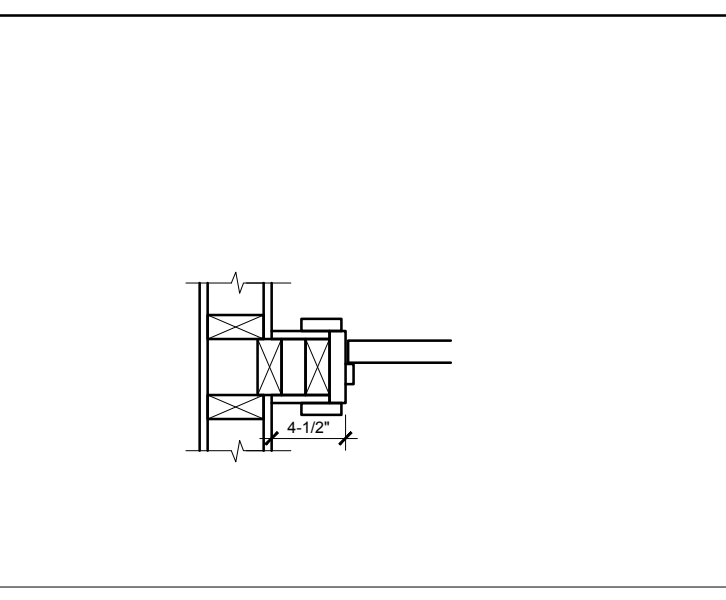

3 TYPICAL DOOR WITHIN DWELLING UNIT AT INTERSECTING WALL
NOT TO SCALE (UNLESS OTHERWISE NOTED)

1 DOOR TYPES
1/4" = 1'-0"

DOOR SCHEDULE																		
DOOR NO.	DOOR					FRAME					GENERAL							
	TYPE	SIZE			INSULATED	TYPE	DETAILS			CLOSER	FIRE RATING (MINUTES)	REMARKS	HARDWARE KEY	REMARKS				
		WIDTH	HEIGHT	THICKNESS			MATERIAL	THRESHOLD	HEAD						JAMB	SILL		
100.1	A	3'-0"	7'-0"	1-3/4"	AL	PTD	Y	-	AL	-	-	-	Y	-	EXISTING ENTRY DOOR, ADD PANIC HARDWARE			
101.1	A	3'-0"	7'-0"	1-3/4"	AL	PTD	Y	-	AL	-	-	-	Y	-	INTERIOR MOUNTED CLOSER ON INSWING DOOR, LOCK TIED TO INTERCOM SYSTEM			
102.1	EX	-	-	-	-	-	-	-	-	-	-	-	-	-	EXISTING COOLER DOOR			
102.2	EX	-	-	-	-	-	-	-	-	-	-	-	-	-	EXISTING COOLER DOOR			
102.3	EX	-	-	-	-	-	-	-	-	-	-	-	-	-	EXISTING COOLER DOOR			
102.4	EX	-	-	-	-	-	-	-	-	-	-	-	-	-	EXISTING COOLER DOOR CUT, MODIFY AND REINSTALL			
103.1	EX	-	-	-	-	-	-	-	-	-	-	-	-	-	EXISTING FREEZER DOOR			
104.1	B	3'-0"	7'-0"	1-3/8"	WD	PTD	-	1	WD	-	-	-	-	-				
105.1	B	3'-0"	7'-0"	1-3/8"	WD	PTD	-	1	WD	-	-	-	-	-				
105.2	B	3'-0"	7'-0"	1-3/8"	WD	PTD	-	1	WD	-	-	-	Y	-				
106.1	B	3'-0"	7'-0"	1-3/8"	WD	PTD	-	1	WD	-	-	-	-	-				
106.2	C	3'-0"	7'-0"	1-3/4"	STL	PTD	Y	2	STL	AL	-	-	Y	-				
106.3	EX	-	-	-	-	-	-	-	-	-	-	-	-	-	PAIN EXISTING DOOR, NEW HARDWARE			
107.1	C	3'-0"	7'-0"	1-3/4"	STL	PTD	Y	2	STL	AL	-	-	-	60				
108.1	C	3'-0"	7'-0"	1-3/4"	STL	PTD	Y	2	STL	AL	-	-	-	60				
109.1	C	3'-0"	7'-0"	1-3/4"	STL	PTD	Y	2	STL	AL	-	-	-	60				
110.1	B	3'-0"	7'-0"	1-3/8"	WD	PTD	-	1	WD	-	-	-	-	-				
111.1	J	3'-0"	7'-0"	1-3/4"	STL	PTD	Y	2	STL	AL	-	-	Y	60	PANIC HARDWARE			
200.1	E	6'-0"	6'-8"	1-3/4"	FG	-	Y	1	FG	FG	-	-	-	-	DOUBLE FRENCH INSWING EXTERIOR DOOR			
200.2	D	3'-0"	7'-0"	1-3/4"	STL	PTD	Y	2	STL	AL	-	-	Y	60	APERTMENT ENTRY DOOR WITH SPRING HINGES, PEEPHOLE			
200.3	B	2'-6"	6'-8"	1-3/8"	WD	PTD	-	1	WD	-	-	-	-	-				
200.4	B	5'-0"	6'-8"	1-3/8"	WD	PTD	-	1	WD	-	-	-	-	-	DOUBLE DOOR			
201.1	B	2'-8"	6'-8"	1-3/8"	WD	PTD	-	1	WD	-	-	-	-	-				
202.1	B	2'-8"	6'-8"	1-3/8"	WD	PTD	-	1	WD	-	-	-	-	-				
202.2	B	2'-8"	6'-8"	1-3/8"	WD	PTD	-	1	WD	-	-	-	-	-				
203.1	B	2'-8"	6'-8"	1-3/8"	WD	PTD	-	1	WD	-	-	-	-	-				
204.1	B	2'-8"	6'-8"	1-3/8"	WD	PTD	-	1	WD	-	-	-	-	-				
204.2	B	2'-8"	6'-8"	1-3/8"	WD	PTD	-	1	WD	-	-	-	-	-				
204.3	B	2'-8"	6'-8"	1-3/8"	WD	PTD	-	1	WD	-	-	-	-	-				
205.1	D	3'-0"	7'-0"	1-3/4"	STL	PTD	Y	2	STL	AL	-	-	Y	60	APERTMENT ENTRY DOOR WITH SPRING HINGES, PEEPHOLE			
205.2	B	2'-0"	5'-10"	1-3/8"	WD	PTD	-	1	WD	-	-	-	-	-	CUSTOM DOOR WITH CHAMFERED EDGE			
205.3	E	6'-0"	6'-8"	1-3/4"	FG	-	Y	1	FG	FG	-	-	-	-	DOUBLE FRENCH INSWING EXTERIOR DOOR			
205.4	H	1'-6"	6'-8"	1-3/8"	WD	PTD	-	1	WD	-	-	-	-	-				
206.1	B	2'-8"	6'-8"	1-3/8"	WD	PTD	-	1	WD	-	-	-	-	-				
207.1	C	2'-8"	6'-8"	1-3/4"	STL	PTD	Y	2	STL	AL	-	-	-	-				
208.1	B	2'-8"	6'-8"	1-3/8"	WD	PTD	-	1	WD	-	-	-	-	-				
208.2	B	2'-8"	6'-8"	1-3/8"	WD	PTD	-	1	WD	-	-	-	-	-				
208.3	B	2'-8"	6'-8"	1-3/8"	WD	PTD	-	1	WD	-	-	-	-	-				
209.1	B	2'-8"	6'-8"	1-3/8"	WD	PTD	-	1	WD	-	-	-	-	-				
210.1	B	2'-8"	6'-8"	1-3/8"	WD	PTD	-	1	WD	-	-	-	-	-				
210.2	B	2'-8"	6'-8"	1-3/8"	WD	PTD	-	1	WD	-	-	-	-	-				
211.1	B	3'-0"	6'-8"	1-3/8"	WD	PTD	-	1	WD	-	-	-	-	-				

DOOR SCHEDULE																		
DOOR NO.	DOOR					FRAME					GENERAL							
	TYPE	SIZE			INSULATED	TYPE	DETAILS			CLOSER	FIRE RATING (MINUTES)	REMARKS	HARDWARE KEY	REMARKS				
		WIDTH	HEIGHT	THICKNESS			MATERIAL	THRESHOLD	HEAD						JAMB	SILL		
300.1	A	2'-10"	6'-8"	1-3/4"	FG	-	Y	1	FG	FG	-	-	-	60	CUSTOM EXTERIOR DOOR IN MODIFIED EXISTING DORMER OPENING			
301.1	B	2'-0"	6'-8"	1-3/8"	WD	PTD	-	1	WD	-	-	-	-	-				
301.2	B	2'-8"	6'-8"	1-3/8"	WD	PTD	-	1	WD	-	-	-	-	-				
302.1	B	2'-8"	6'-8"	1-3/8"	WD	PTD	-	1	WD	-	-	-	-	-				
303.1	B	2'-8"	6'-8"	1-3/8"	WD	PTD	-	1	WD	-	-	-	-	-				
304.1	B	2'-8"	6'-8"	1-3/8"	WD	PTD	-	1	WD	-	-	-	-	-				
304.2	B	2'-8"	6'-8"	1-3/8"	WD	PTD	-	1	WD	-	-	-	-	-				
305.1	B	2'-8"	6'-8"	1-3/8"	WD	PTD	-	1	WD	-	-	-	-	-				
305.2	B	2'-8"	6'-8"	1-3/8"	WD	PTD	-	1	WD	-	-	-	-	-				
306.1	B	2'-8"	6'-8"	1-3/8"	WD	PTD	-	1	WD	-	-	-	-	-				
306.2	B	2'-8"	6'-8"	1-3/8"	WD	PTD	-	1	WD	-	-	-	-	-				
401.1	J	3'-0"	6'-8"	1-3/4"	STL	PTD	Y	2	STL	AL	-	-	Y	60				

DOOR NOTES:

- 1.) ALL EXTERIOR GLAZING TO BE LOW-E ARGON FILLED INSULATED GLAZING UNITS
- 2.) FRAME ALL OPENINGS WITH ELEVATIONS
- 3.) SEAL EXTERIOR DOORS TO ROUGH OPENING WITH LOW EXPANDING FOAM INSULATION - SEE DETAILS
- 4.) ALL DOOR HARDWARE TO BE 'LEVER' TYPE
- 5.) ALL EXTERIOR DOORS TO BE WEATHERSTRIPPED

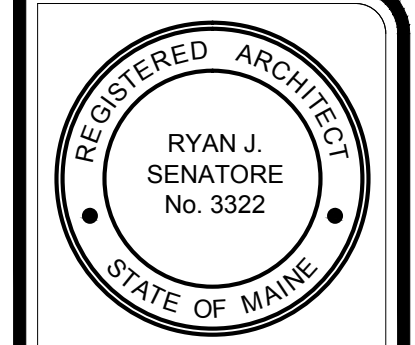

© 2013 RYAN SENATORE ARCHITECTURE

RENOVATIONS TO
135 CONGRESS STREET
PORTLAND, MAINE



CONSULTANTS:
STRUCTURAL: Structural Integrity, 77 Oak Street, Portland, ME 04101, 207.774.4614

REVISIONS:

DATE: AUGUST 23, 2013

PROJECT No. 1317

DRAWN BY: RJS / RRT

CHECKED BY: RJS

SCALE: AS NOTED

SHEET TITLE:
DOOR SCHEDULE

A7-1