

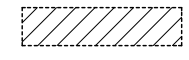

NOTES:

1. LOCATION & SIZE OF STRUCTURAL POSTS ARE APPROXIMATE ONLY. REFER TO STRUCTURAL DRAWINGS.

**FIRE & ACOUSTIC RATED ASSEMBLIES:**  
REFER TO DRAWING A5.1 FOR COMPONENT DESCRIPTION

-  1 HOUR MIN. - RATED FOR EXPOSURE FROM INSIDE ONLY (PER IBC 704.5)
-  1 HOUR MIN. / STC 50 MIN.
-  2 HOUR MIN. / STC 50 MIN.

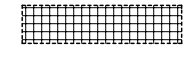
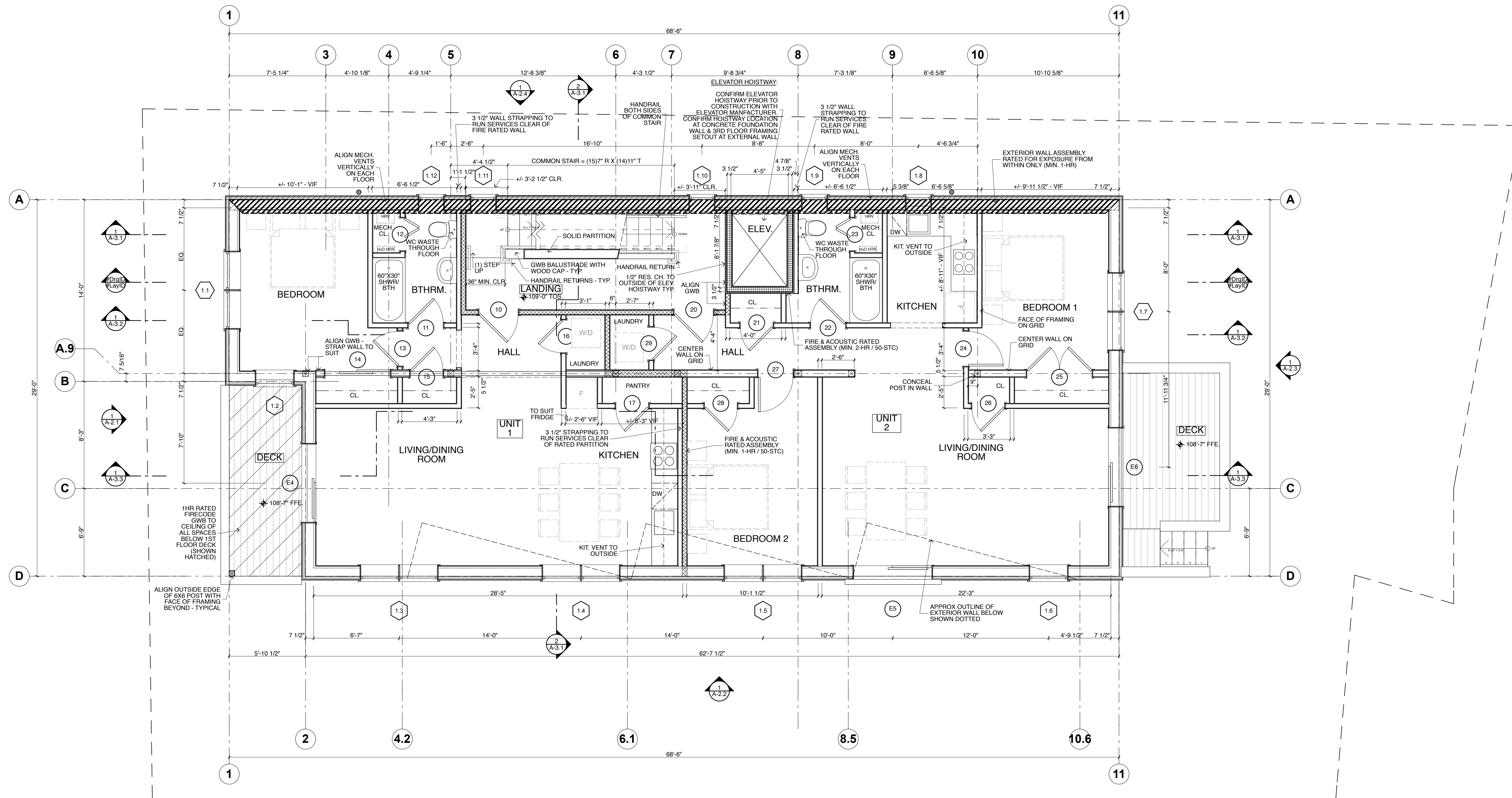

**1** 1st. Floor  
SCALE: 1/4" = 1'-0"

