

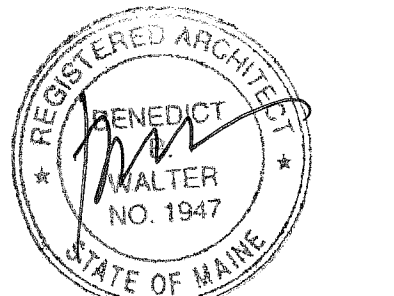

CWS Architects

Architecture
Space Planning
Value Design

434 Cumberland Avenue
Portland, ME 04101
Phone: (207) 774-4441
Fax: (207) 774-4016
www.CWSarch.com



Owner:
Avesta Munjoy Commons, LP.
307 Cumberland Ave.
Portland, Maine 04101
TEL: 207-553-7780

Client:

Munjoy Commons Apartments

Portland, Maine

Project No: 07429

Drawing Title:
SHAILER ANNEX BASEMENT PLAN

Scale: 1/4" = 1'-0"
Date: August 28, 2009

Revisions:
▲
▲
▲
▲
▲
▲

Drawing Number:
SHAILER A1.2

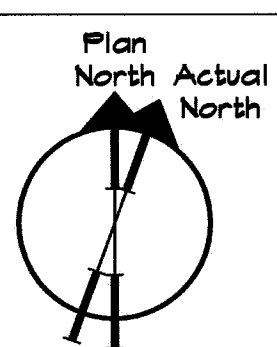
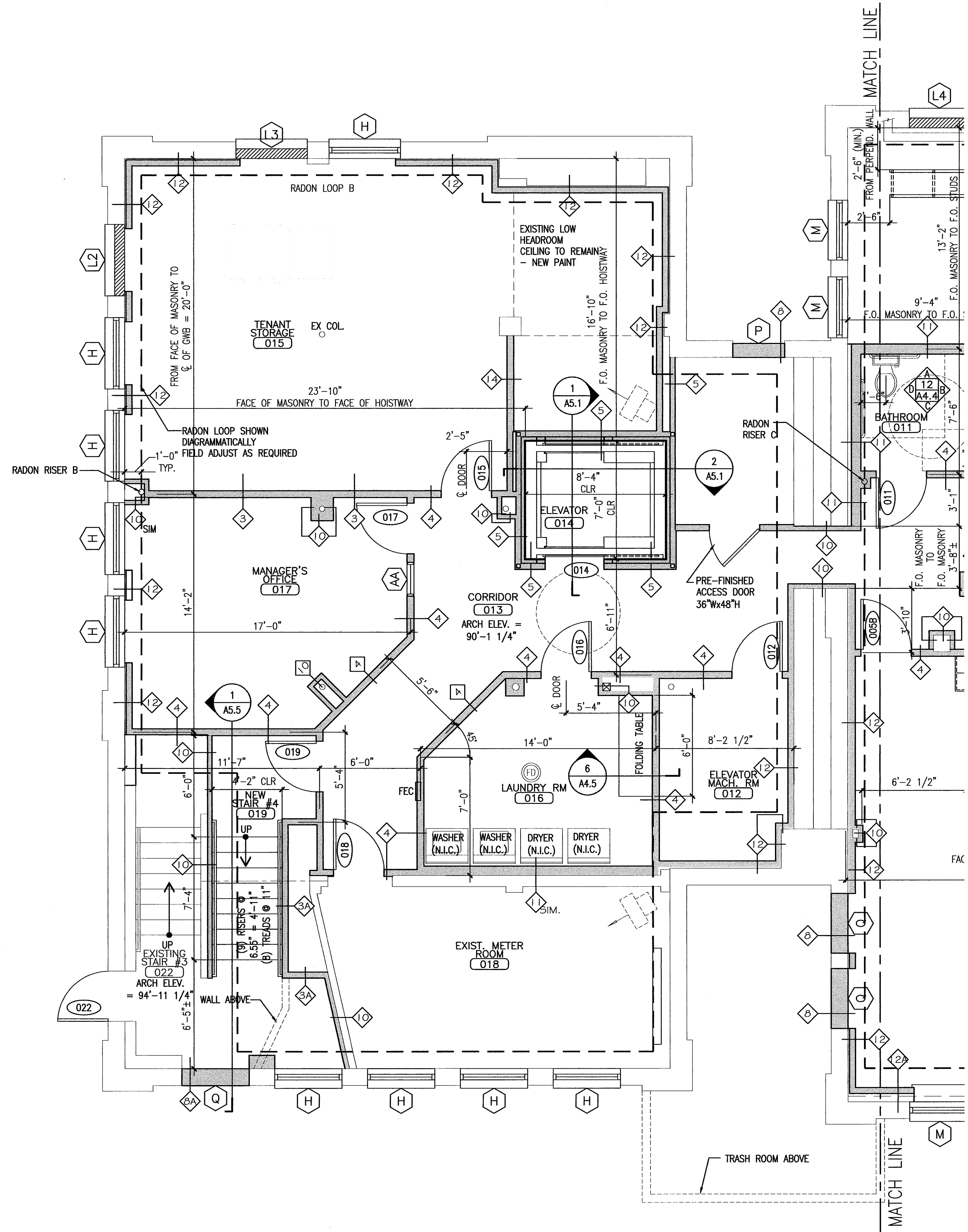

1

REFERENCED FROM:

SCALE: N/A

2

ANNEX BASEMENT PLAN - PART "B"

REFERENCED FROM:

SCALE: 1/4" = 1'-0"