

WALL TYPE LEGEND

- W1 EXTERIOR WALL
2 x 6 wood stud (see structural for spacing) with 1/2 sheathing applied to exterior face and 5/8" gypsum wall board applied to interior face.
- W2 INTERIOR PLUMBING WALL
2 x 6 wood stud (see structural for spacing) with 1/2" gypsum wall board applied to each face.
- W3 INTERIOR PARTITION
2 x 4 wood stud (see structural for spacing) with 1/2" gypsum wall board applied to each face.
- W5 INTERIOR BEARING WALL
2 x 6 wood stud (see structural for spacing) with 1/2" gypsum wall board applied to each face.

NOTE: RAILING REQUIRED AT ELEVATIONS MORE THAN 30" ABOVE GRADE NOT LESS THAN 3'-6" IN HEIGHT NOT LESS THAN 4" BETWEEN RAILS

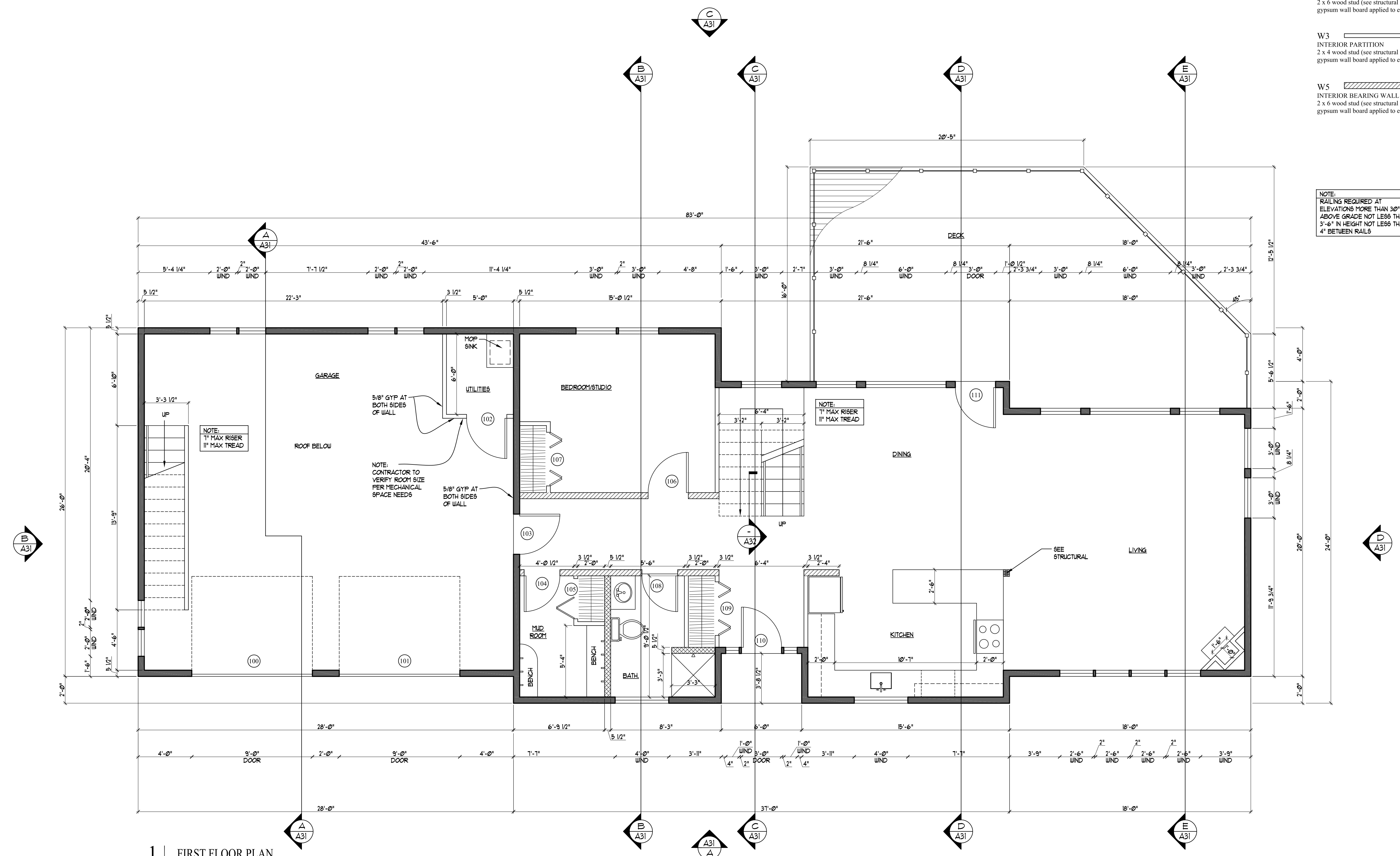

1 FIRST FLOOR PLAN
SCALE: 1/4"=1'-0"

Prepared For:

Consulting Engineer:

ARCHETYPE architects
48 Union Wharf Portland, Maine 04101
(207) 772-6022 Fax (207) 772-4056

Project: **Sheridan Street Residence**
SHERIDAN STREET
PORTLAND, MAINE

Revisions:
Issued for Building Permit: 1/28/2011

Date: 28 January 2011
Scale: 1/4" = 1'-0"

FIRST FLOOR PLAN

A1.01

