

**HASAN LLC**  
134 Sheridan Street  
Portland, Maine

**ISSUED FOR PERMIT ONLY**  
**NOT FOR CONSTRUCTION**

**BEDROOM ADDITION & DECK REVISIONS**  
PSE Project No. 121-08

Sketches SK-7 thru SK-17

Reference: 12/10/08 Structural Drawings  
4/3/09 Architectural Drawings

Prepared for:

Rick Renner Architects  
c/o Tom Delaney  
35 Pleasant Street  
Portland, ME 04101  
Tel: (207) 773-9699  
Fax: (207) 773-9599

Prepared by:

David A. Price, P.E.  
Price Structural Engineers, Inc.  
75 Farms Edge Road  
North Yarmouth, ME 04097  
Tel: (207) 846-0099  
Fax: (207) 846-1633

April 6, 2009

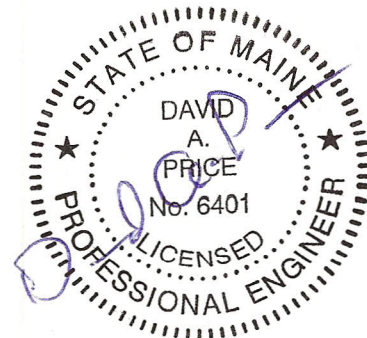

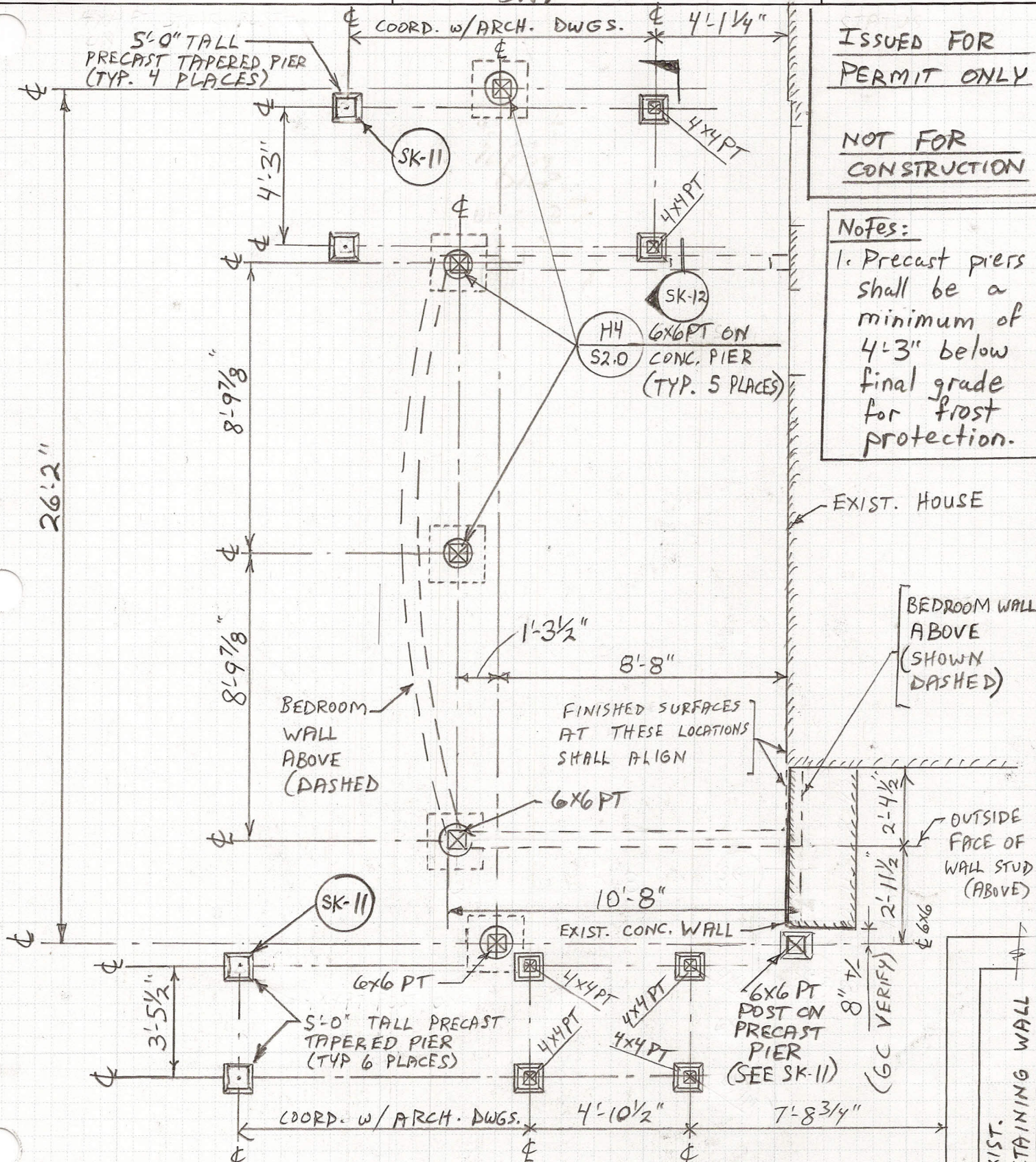

**ISSUED FOR PERMIT ONLY**

**NOT FOR CONSTRUCTION**

**Notes:**

1. Precast piers shall be a minimum of 4'-3" below final grade for frost protection.

**HASAN DECK FOUNDATION PLAN**  
1/4" = 1'-0"

- Reference:**
- 1. 12/10/08 structural Drawings
  - 2. 4/3/09 Architectural Drawings

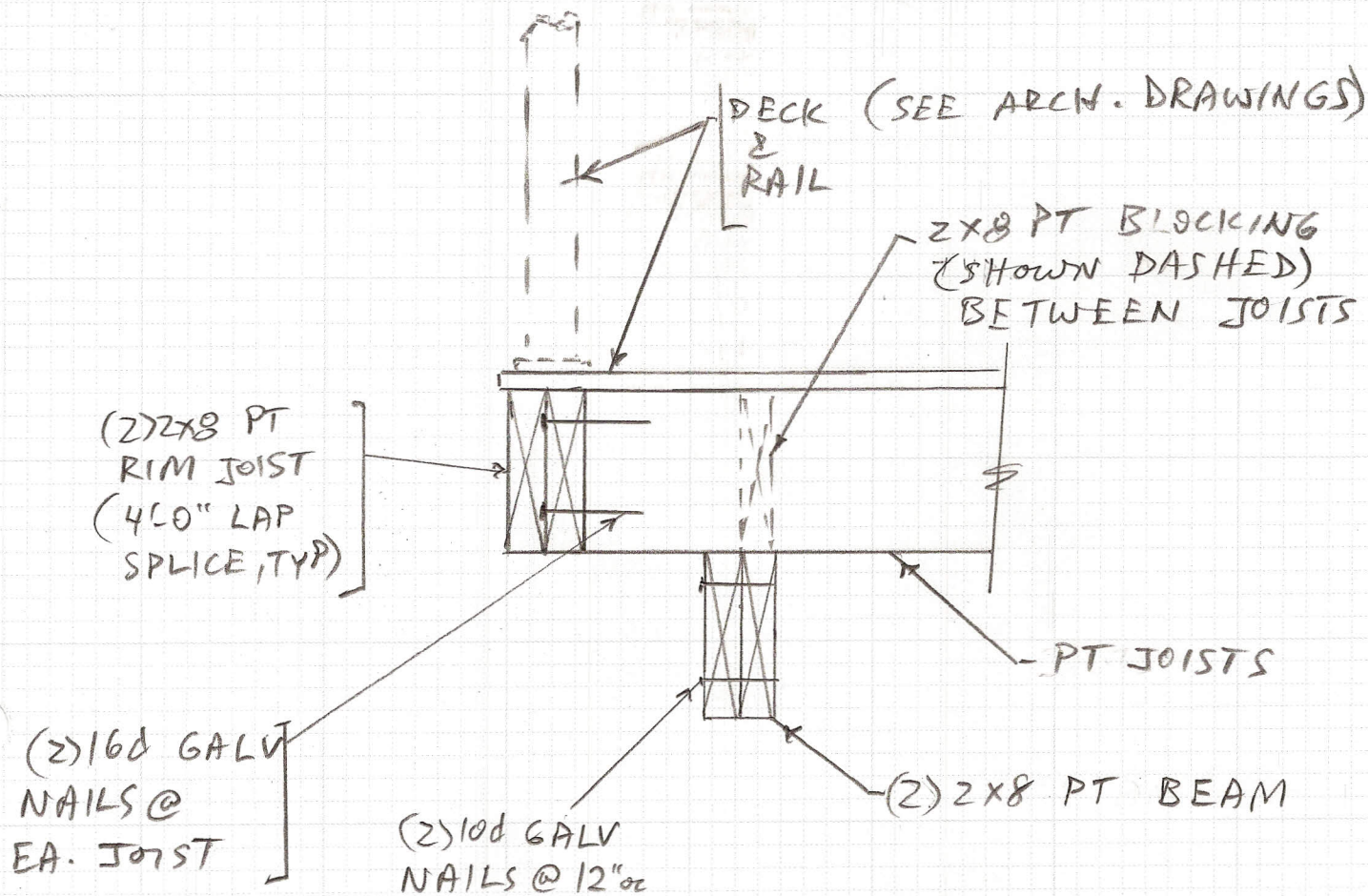

SK-16 SECTION @ MAIN LEVEL DECK  
NTS

Issued For Permit Only  
(Not For Construction)

Project: <i>Hasan LLC</i>	Sheet: <i>12</i> of <i>12</i>	SK-17
Subject: <i>Deck Renvisions</i>	Date: <i>4/6/09</i>	Job #: <i>121-08</i>
Designed by: <i>DAP</i>	Checked by:	

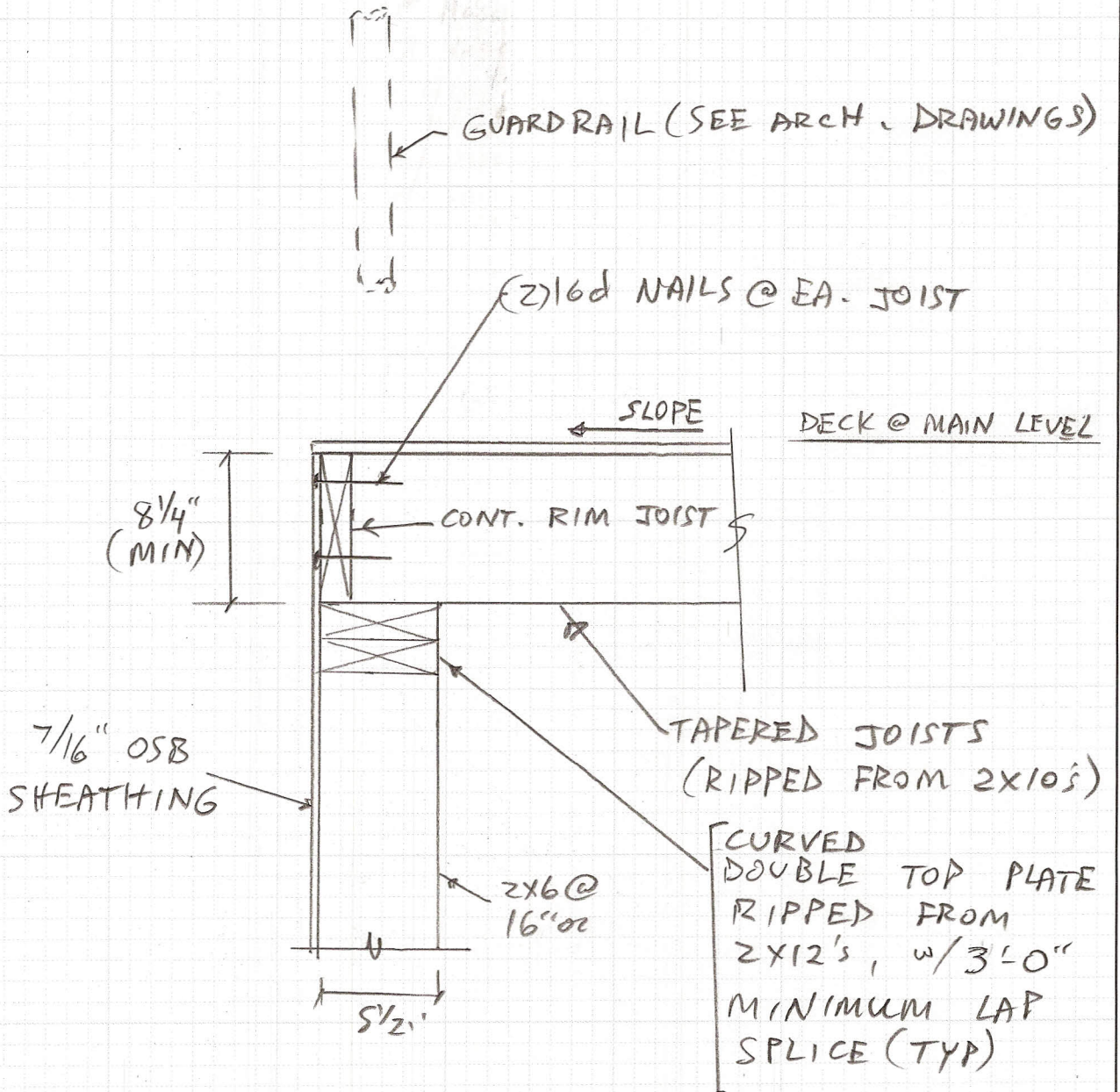

SECTION @ MAIN LEVEL DECK  
NTS

SK-17

Issued For Permit Only  
(Not For Construction)

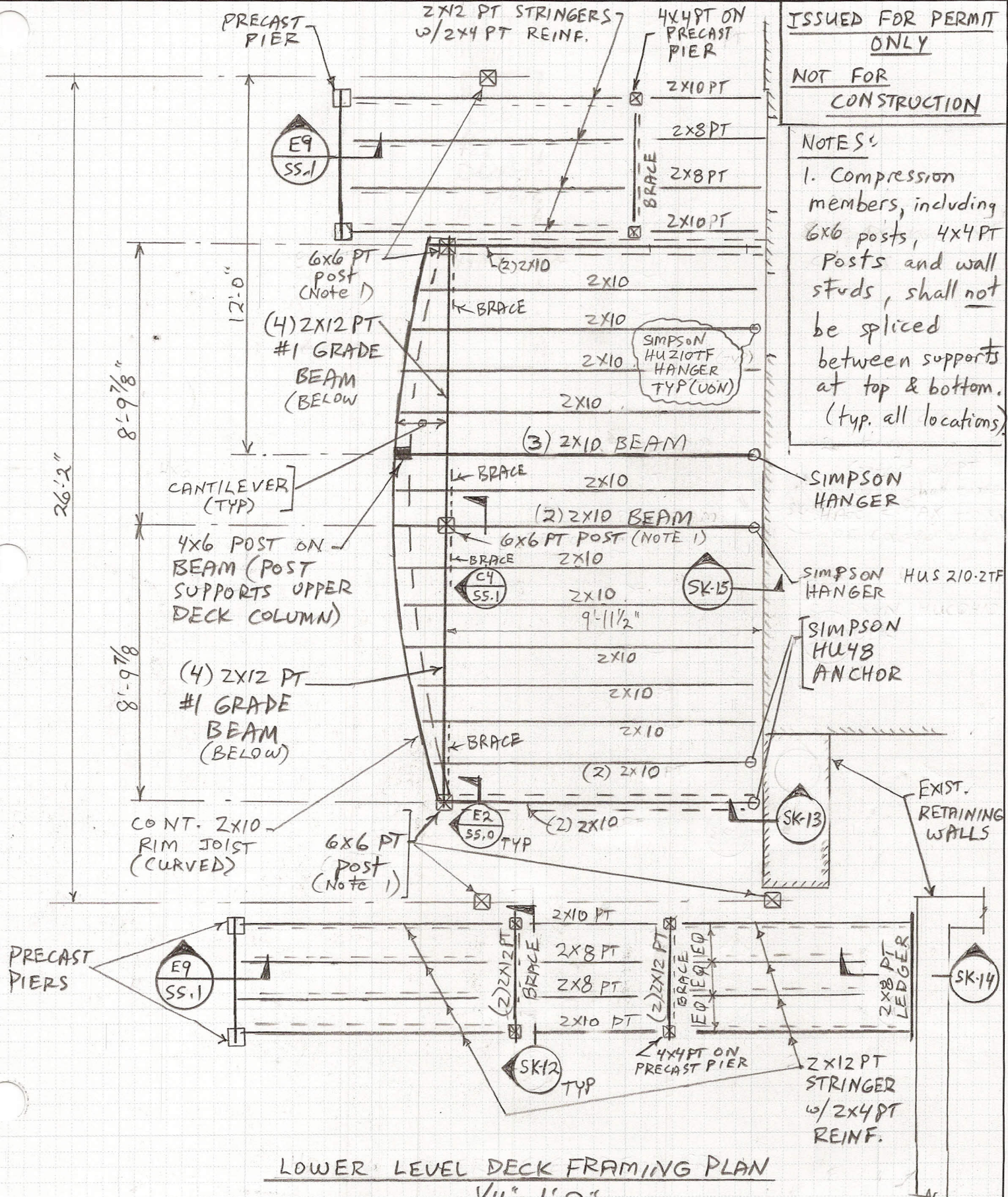

**ISSUED FOR PERMIT ONLY**  
**NOT FOR CONSTRUCTION**

**NOTES:**  
1. Compression members, including 6x6 posts, 4x4 PT posts and wall studs, shall not be spliced between supports at top & bottom. (typ. all locations)

**LOWER LEVEL DECK FRAMING PLAN**  
**1/4" = 1'-0"**

HASAN LLC	SK-9
134 Sheridan St. ; Portland	
Mar. 31, 2009	
Price Structural Engrs, Inc.	
Reference: 12/10/08 Structural Drawings	

ISSUED FOR PERMIT ONLY  
NOT FOR CONSTRUCTION

4/12

NOTES:

1. See 12/10/09 structural drawings for additional requirements.
2. Rip tapered joists from 2x10's. Minimum joist depth shall not be less than 8 1/4".
3. Contractor shall field verify skew angle of connector. Fasten hanger directly to 3" thick lumber support (min) w/(14) 16d galv. nails. Hanger shall have Z-Max finish.

5/8" CDX ROOF SHEATHING @ HATCHED AREA

MAIN LEVEL DECK - PLAN

3/8" @ 1'-0"

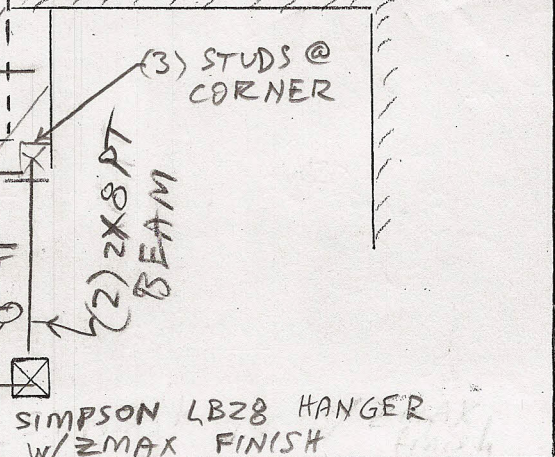
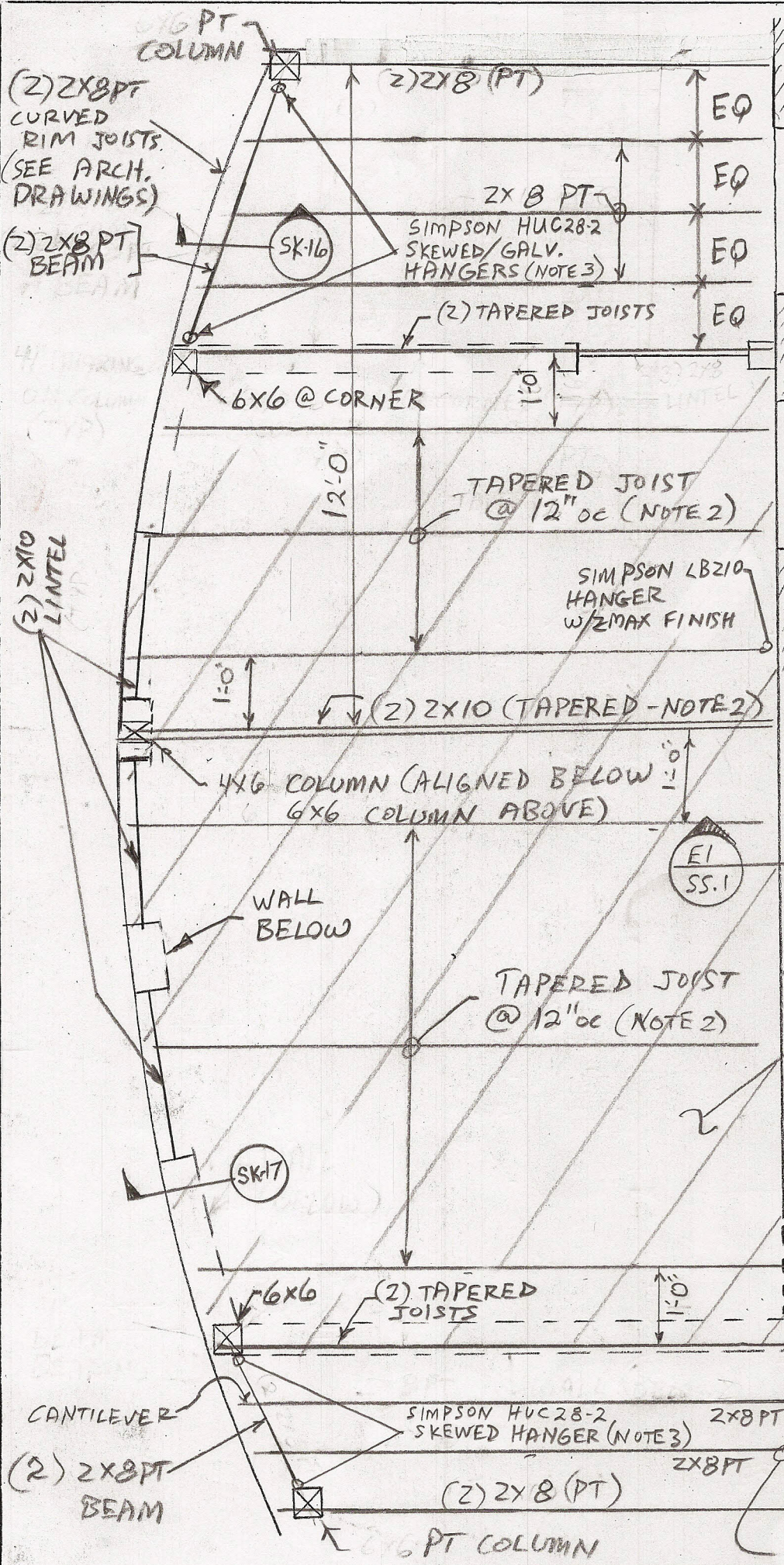

Notes:

1. All pressure-treated (PT) materials shall be #1 Grade Southern Yellow Pine (typ).
2. See 12/10/08 structural drawings for additional requirements
3. All Simpson hangers in contact with PT lumber shall have "ZMAX" finish, typ.

HASAN LLC	SK-10
134 Sheridan St.   Portland	
Mar. 31, 2009	
Price Structural Engrs, Inc.	
Reference: 12/10/08 Structural Drawings	

ISSUED FOR PERMIT ONLY

NOT FOR CONSTRUCTION

5/12

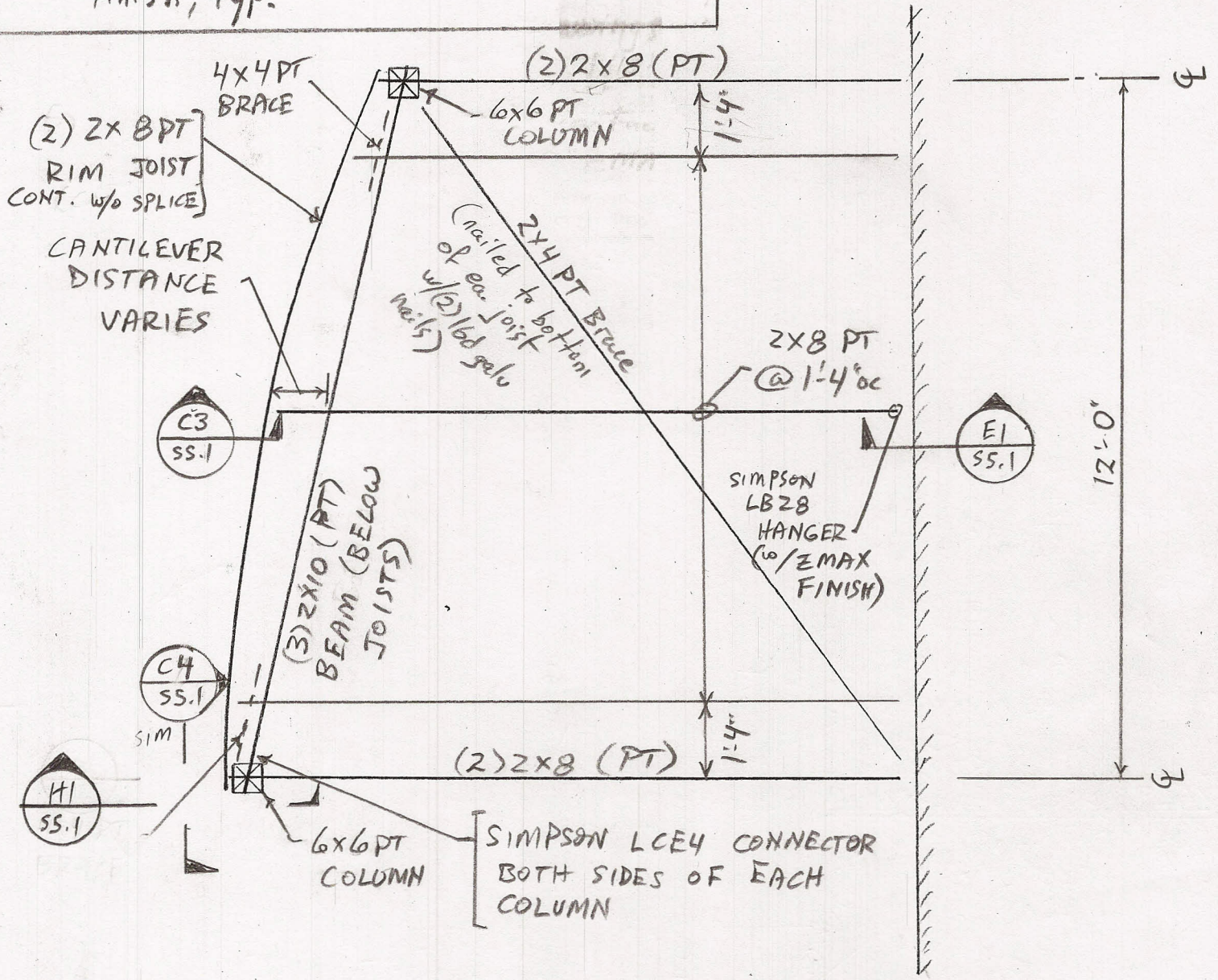

HIGH LEVEL DECK PLAN

3/8 = 1'-0"

Project: Hasan LLC	SK-11
Subject: Deck revisions	Sheet: 6 of 12
Date: 4/09	Job #: 121-08
Designed by: DAP	Checked by:

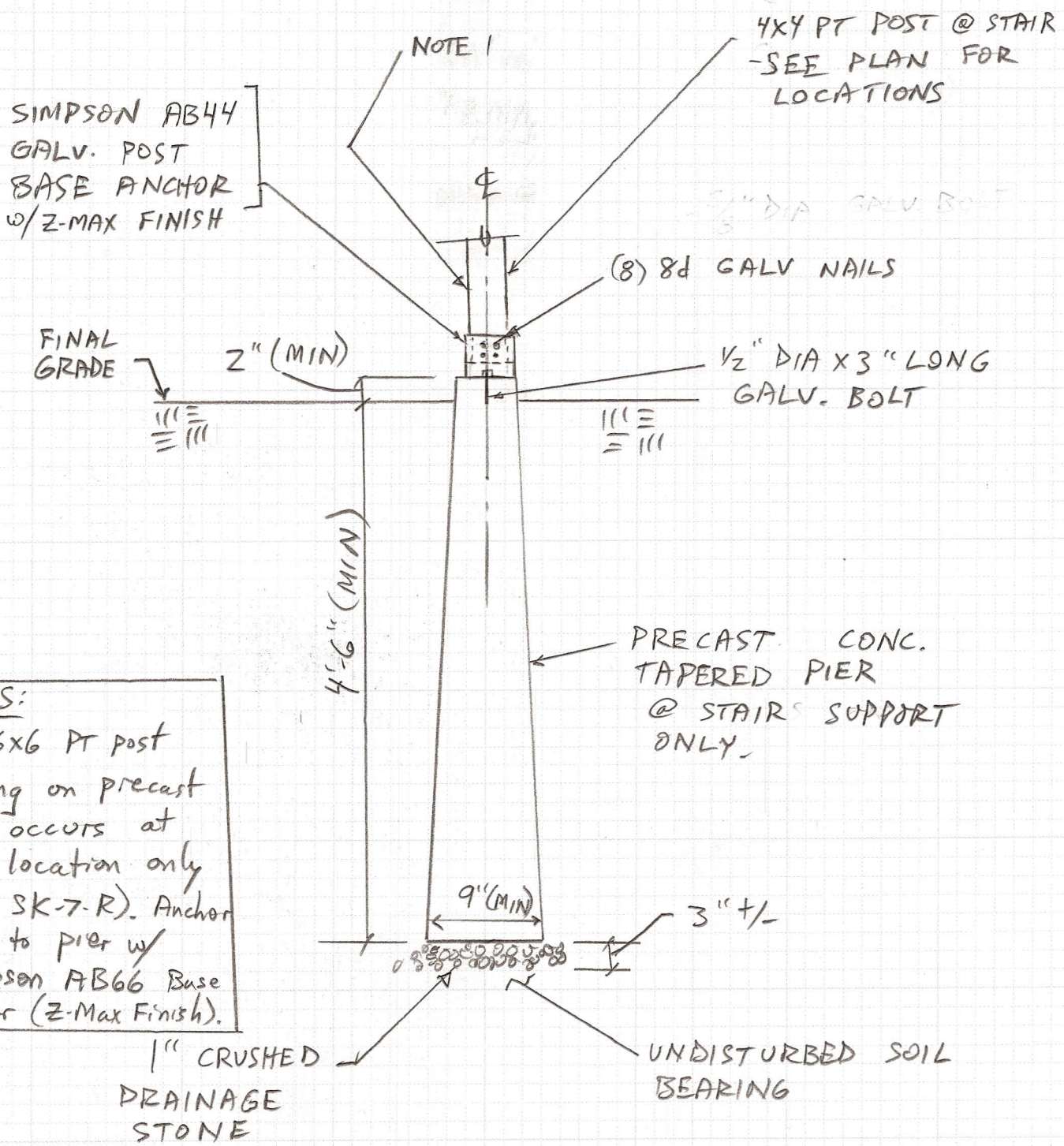

**NOTES:**  
1. A 6x6 PT post bearing on precast pier occurs at one location only (per SK-7-R). Anchor post to pier w/ Simpson AB66 Base Anchor (Z-Max Finish).

SK-11 TYP. PRECAST CONC. PIER  
3/4" = 1'-0"

Issued For Permit Only  
(Not For Construction)



Project: Hasan LLC	SK-12
Subject: Deck Revisions	Sheet: 7 of 12
Date: 4/6/09	Job #: 121-08
Designed by: DAF	Checked by:

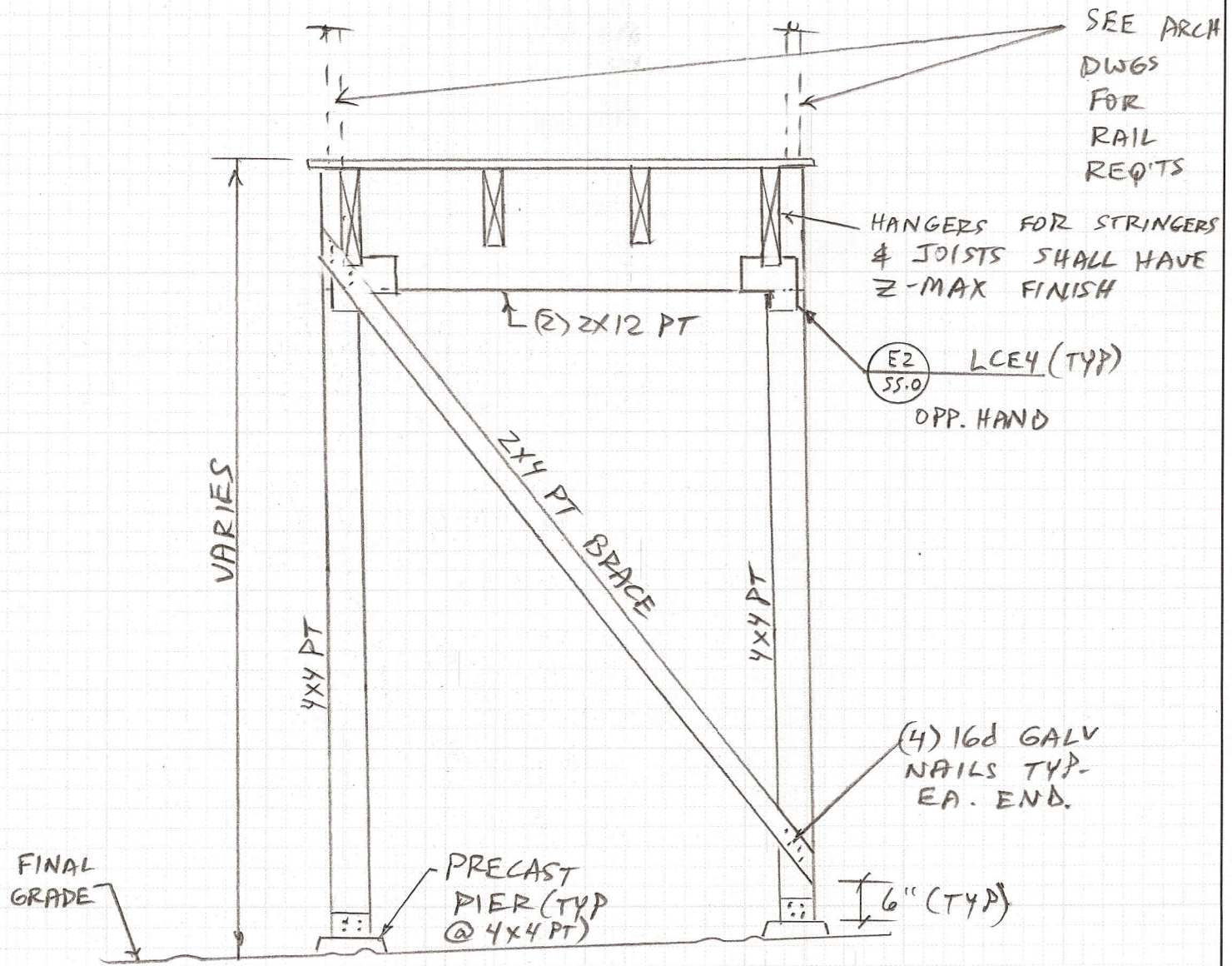

SK-12 TYP. 4x4 PT STAIR-POST DETAIL  
NTS

Issued For Permit Only  
(Not For Construction)

Project:	Hasan LLC	SK-13
Subject:	Deck Revisions	Sheet: 8 of 12
Date:	4/6/09	Job #: 121-08
Designed by:	DAP	Checked by:

NOTES:  
1. wall studs not shown for clarity

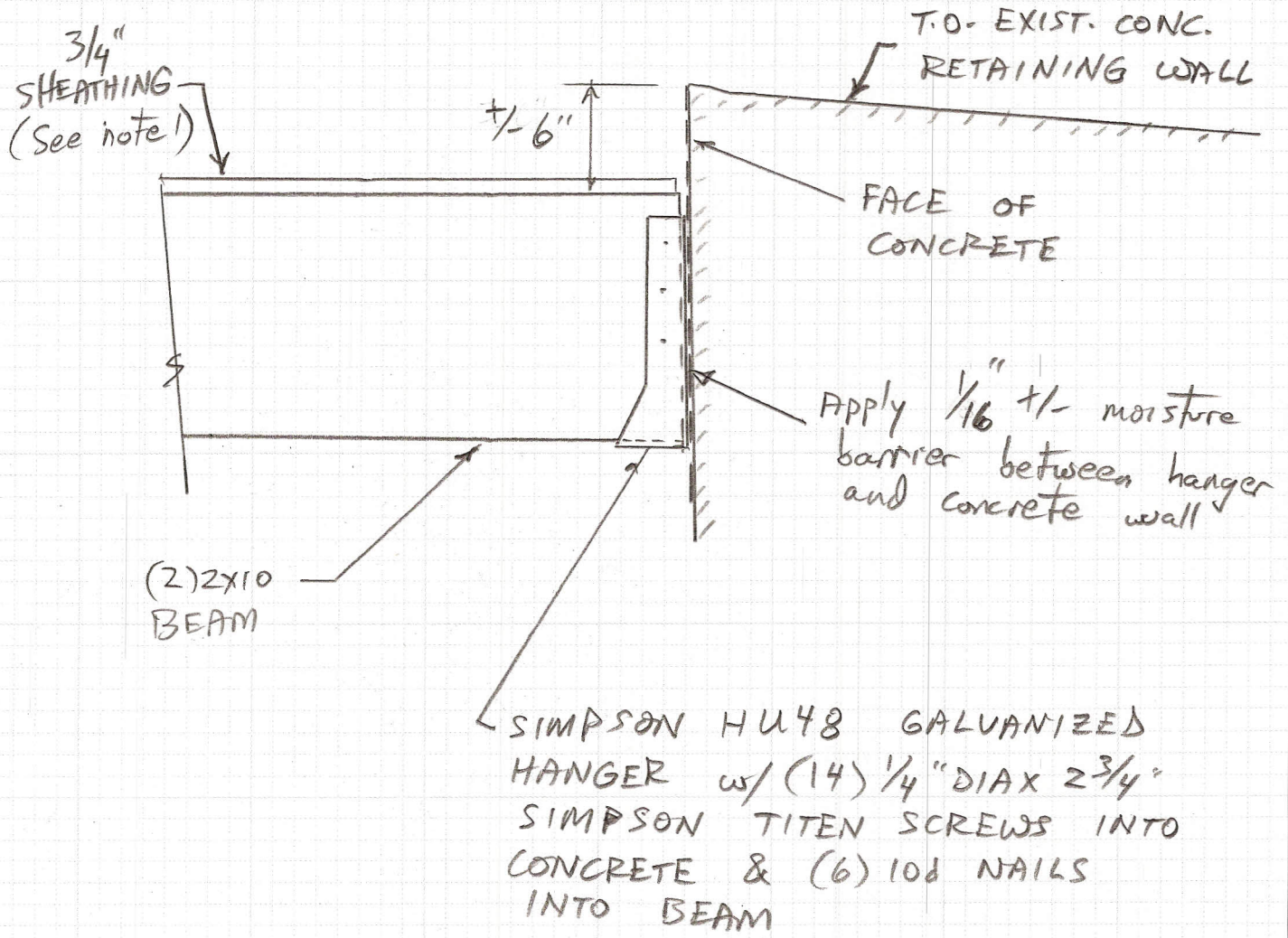

SK-13 SECTION  
NTS

Issued For Permit Only  
(Not For Construction)

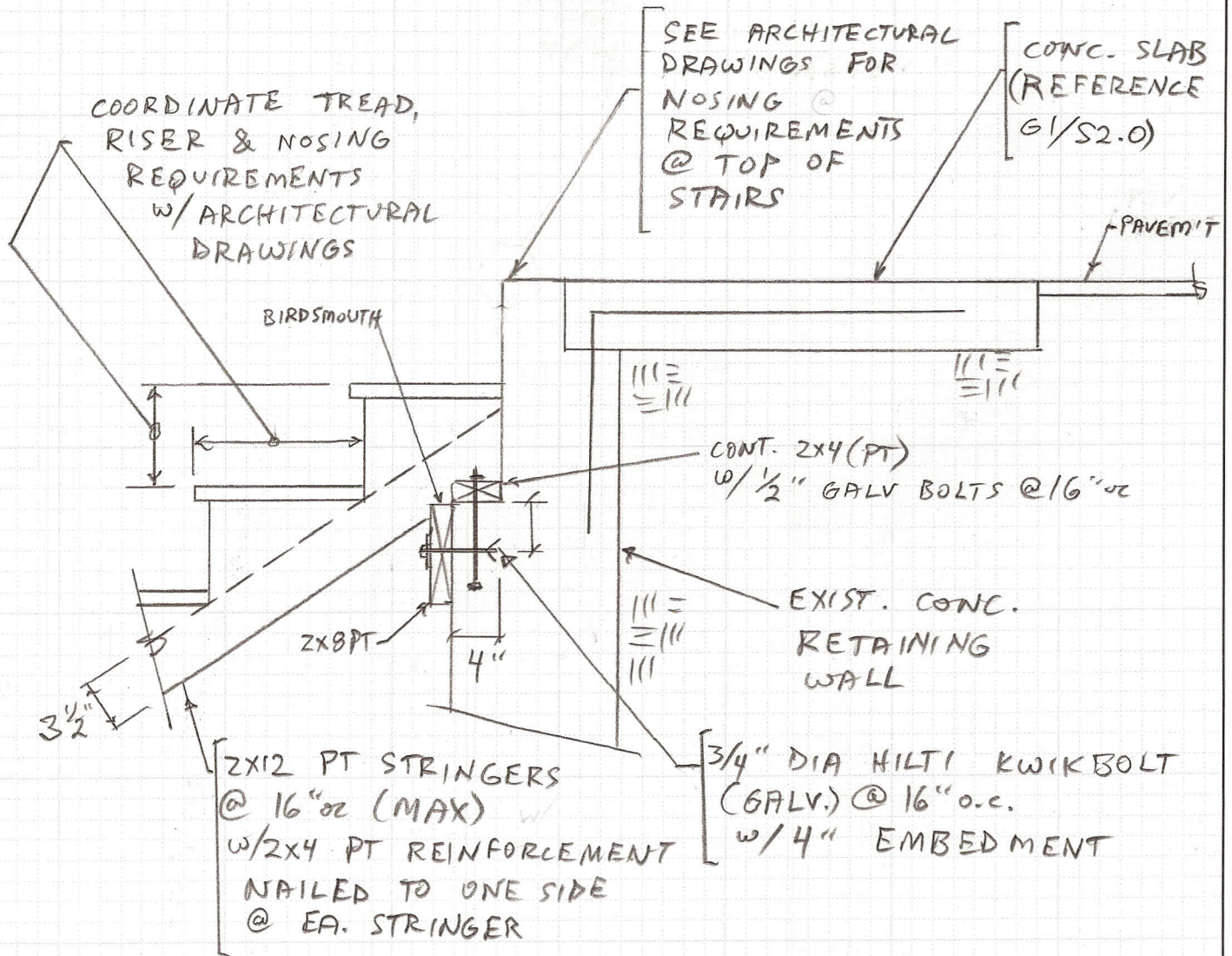

SK-14 SECTION  
1" = 1'-0"

Issued For Permit Only  
(Not For Construction)

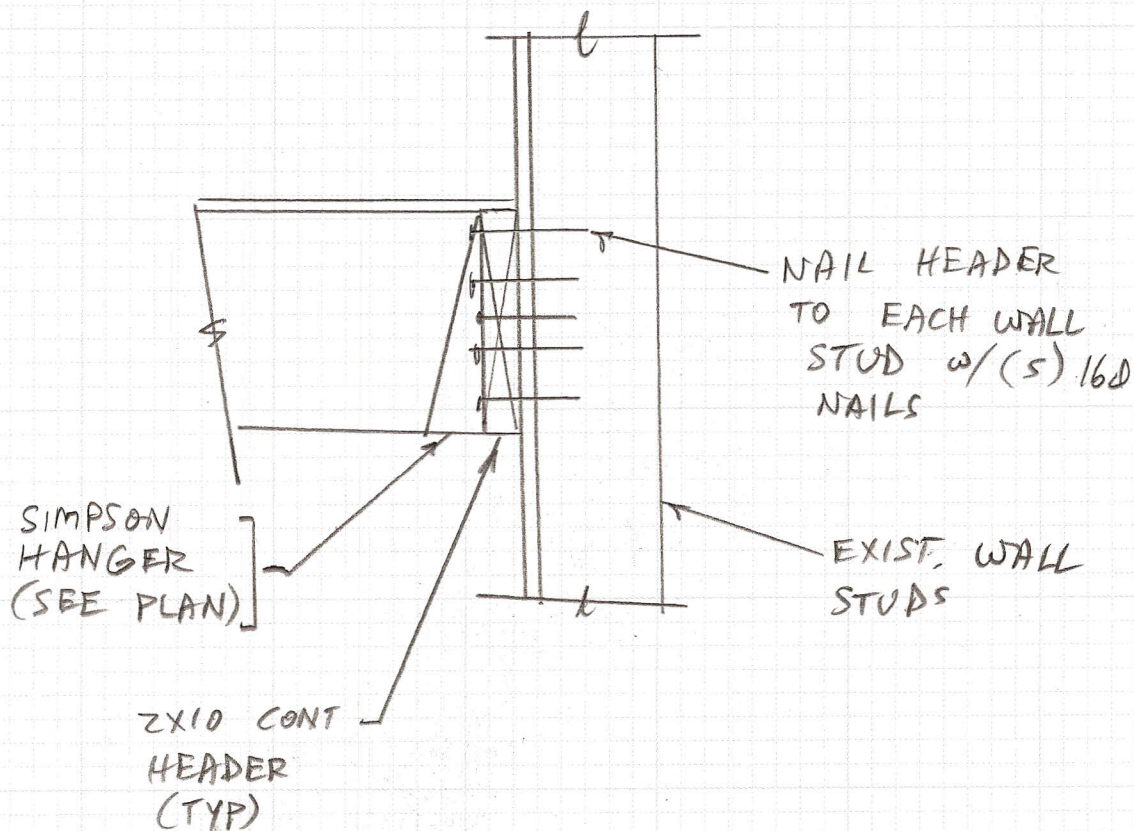

SK-15 SECTION  
NTS

Issued For Permit Only  
(Not For Construction)