

1 First Floor Plan
SCALE: 1/4" = 1'-0"

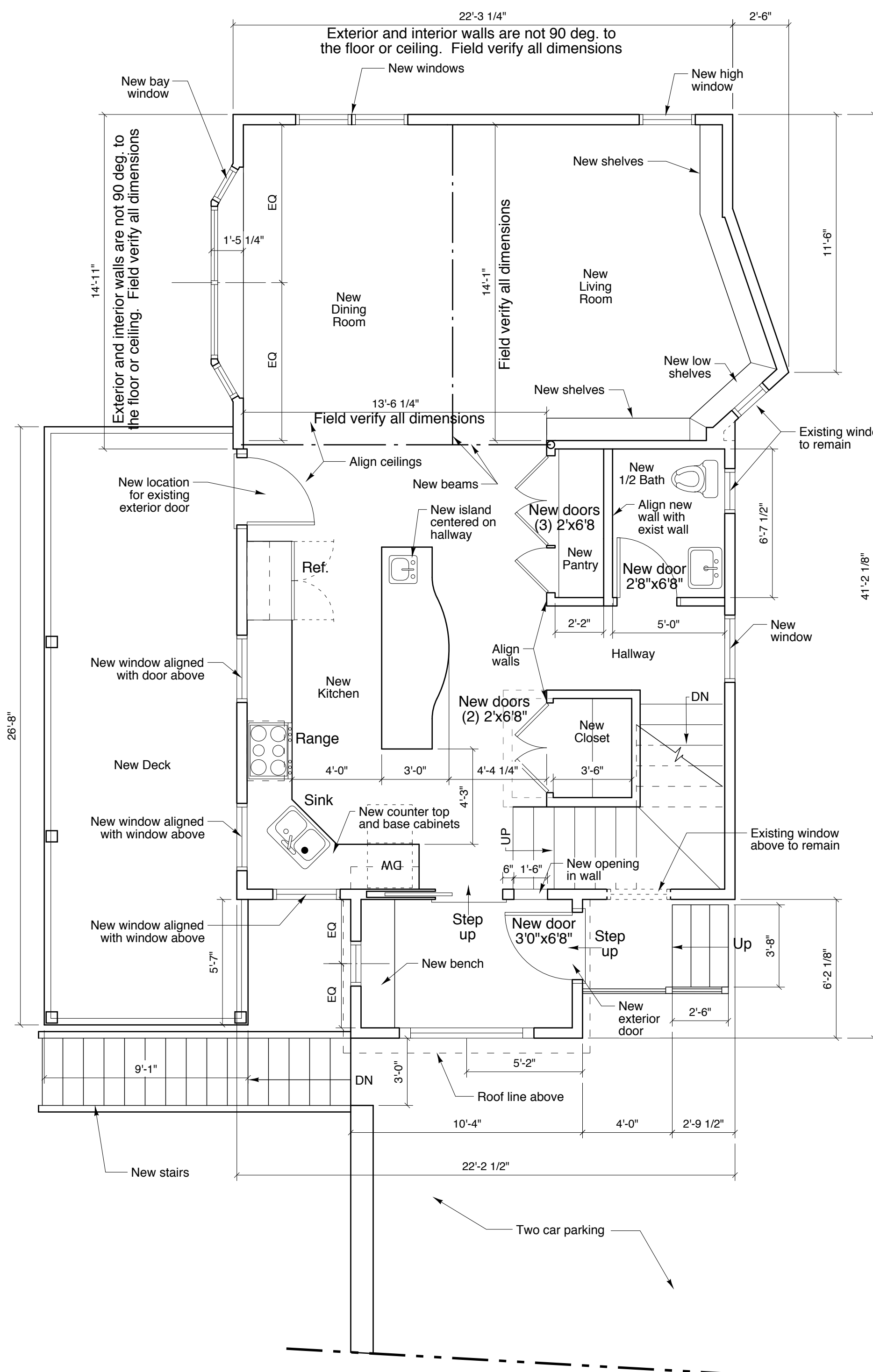

2 Second Floor Plan
SCALE: 1/4" = 1'-0"

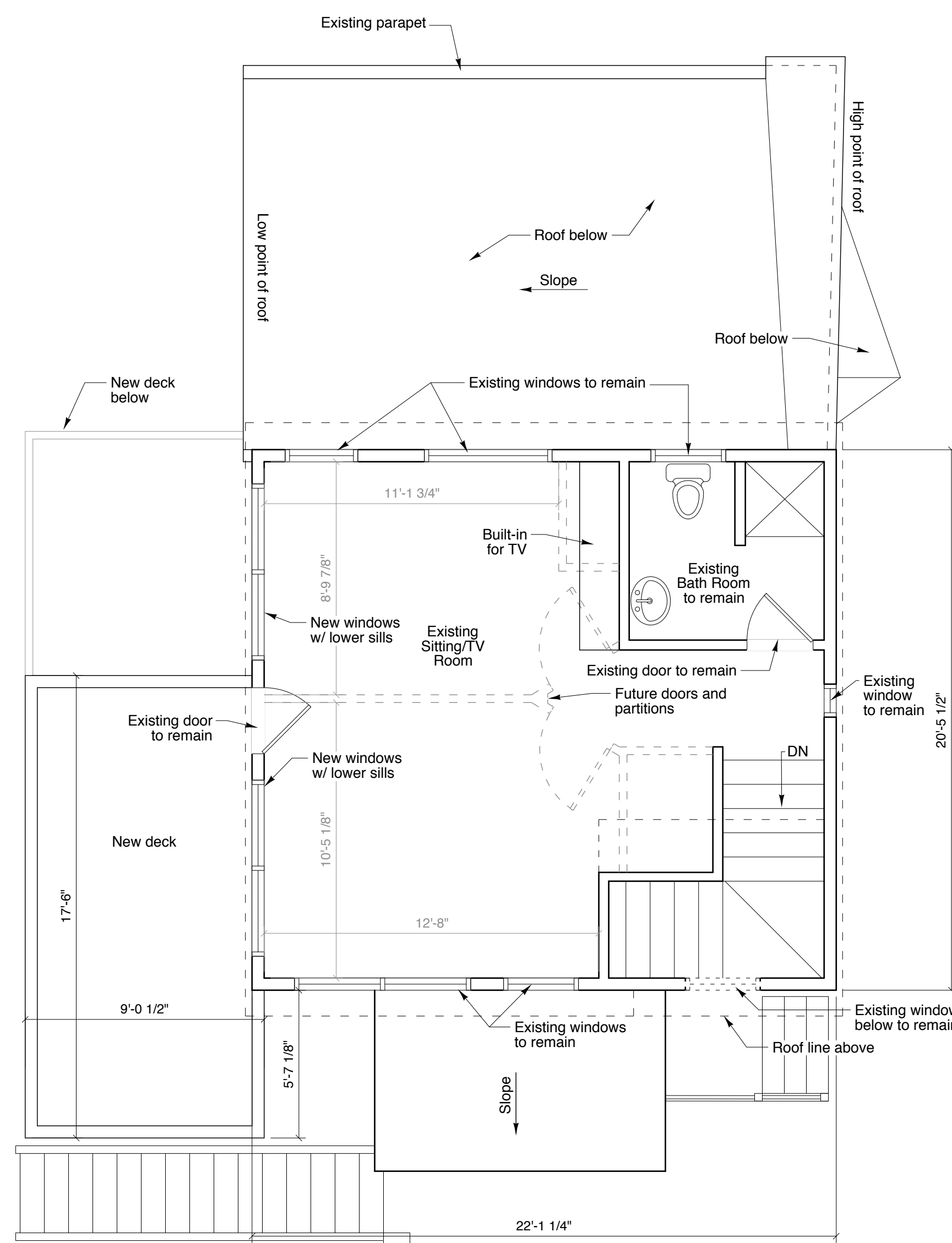

3 Third Floor Plan
SCALE: 1/4" = 1'-0"

General Notes:
Exterior and interior walls may not be 90 deg. to the floor or ceiling in all rooms, so dimensions may vary based on where the dimension was taken at time of field visit. Field verify all dimensions

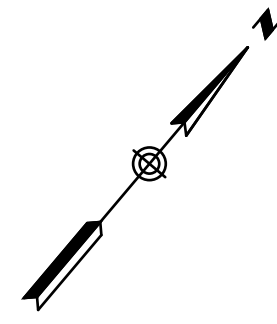

FOUNDATION PERMIT ONLY 10/28/2008

RR|A
Richard Remeri Architects
133 South Main Street
Portland, ME 04101
508.651.2800
508.651.0911 fax

Consultants:

Hasan L.L.C.
134 Sheridan Street
Portland, Maine

Floor Plans
Drawn by: TJD
Scale: 1/4" = 1'-0"
Date: 10/28/08
File Name: A1.1 Proposed New...
Project No.
Revised:

A1.1