

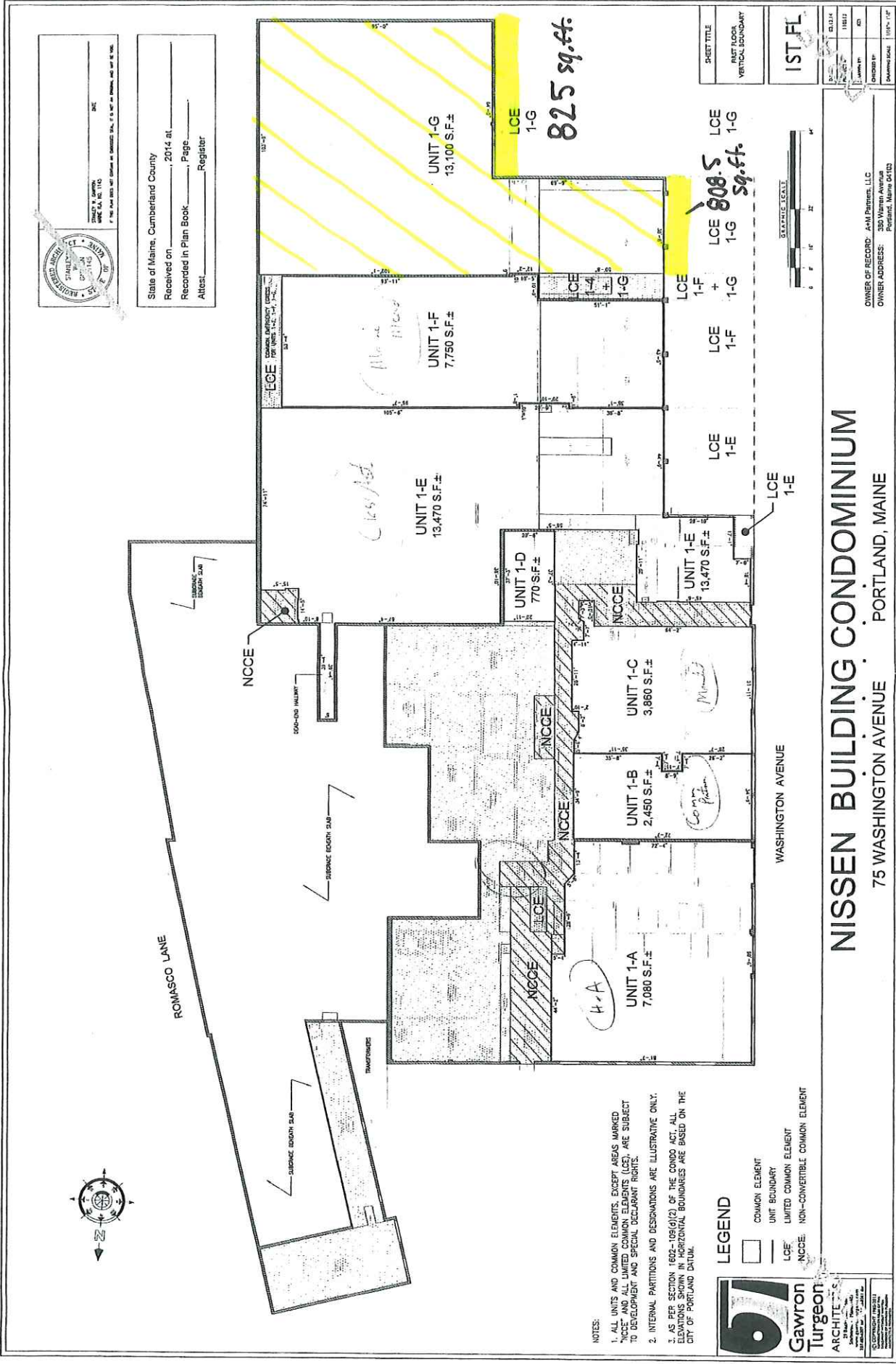

State of Maine, Cumberland County
 Received on _____, 2014 at _____
 Recorded in Plan Book _____, Page _____
 Attest: _____ Register



NOTES:
 1. ALL UNITS AND COMMON ELEMENTS, EXCEPT AREAS MARKED "NCCE" AND ALL LIMITED COMMON ELEMENTS (LCE), ARE SUBJECT TO DEVELOPMENT AND SPECIAL DECLARANT RIGHTS.
 2. INTERNAL PARTITIONS AND DESIGNATIONS ARE ILLUSTRATIVE ONLY.
 3. AS PER SECTION 602-106(2) OF THE CONDO ACT, ALL ELEVATIONS SHOWN IN HORIZONTAL BOUNDARIES ARE BASED ON THE CITY OF PORTLAND DATUM.

- LEGEND**
- COMMON ELEMENT
 - ▭ UNIT BOUNDARY
 - LCE
 - ▨ LIMITED COMMON ELEMENT
 - ▩ NCCE
 - ▧ NON-CONVERTIBLE COMMON ELEMENT

Gawron Turgeon ARCHITECTS
 300 WASHINGTON AVENUE
 PORTLAND, MAINE 04103
 PHONE: 603.761.1111
 FAX: 603.761.1112
 WWW: GAWRONTURGEON.COM

NISSEN BUILDING CONDOMINIUM
 75 WASHINGTON AVENUE PORTLAND, MAINE

OWNER OF RECORD: A-M Partners, LLC
 OWNER ADDRESS: 300 WASHINGTON AVENUE
 PORTLAND, MAINE 04103

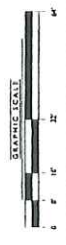

3/13/14
 OVP SIGNAGE

total facade sqft. = 1289.4
 5% OF WHICH IS 64.47 > 27.855