



- NOTES:
1. ALL UNITS AND COMMON ELEMENTS, EXCEPT AREAS MARKED "NCCCE" AND "LCE" ARE SUBJECT TO DEVELOPMENT AND SPECIAL DECLARATORY RIGHTS.
 2. INTERNAL PARTITIONS AND DESIGNATIONS ARE ILLUSTRATIVE ONLY.
 3. AS PER SECTION 1802-109(d)(2) OF THE CONDO ACT, ALL EXPANSION AREAS IN COMMON ZONAL BOUNDARIES ARE BASED ON THE CITY OF PORTLAND DATUM.

LEGEND

- COMMON ELEMENT
- UNIT BOUNDARY
- LCE LIMITED COMMON ELEMENT
- NCCCE NON-CONVERTIBLE COMMON ELEMENT

3RD FL

Gawton Turgeon ARCHITECTS

147 Middle Street, Portland, ME 04101
 Phone: 603.761.1111
 Fax: 603.761.1112
 www.gawton-turgeon.com

GEOMETRIC DESIGN
 1000 Commercial Street, Portland, ME 04101
 Phone: 603.761.1111
 Fax: 603.761.1112
 www.geometricdesign.com

NISSEN BUILDING CONDOMINIUM
 75 WASHINGTON AVENUE PORTLAND, MAINE

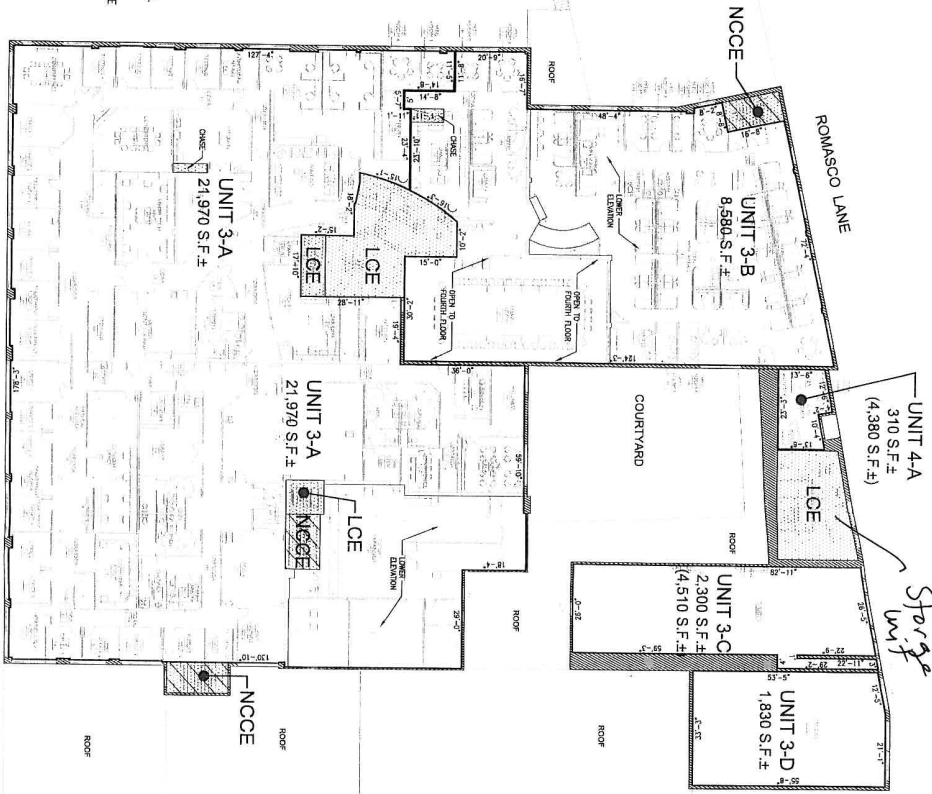

Storage
25
65054
W

"Expansion Area" (Subject to Development and Special Declaratory Rights) (see Declaratory)

State of Maine, Cumberland County
 Received on _____, 2014 at _____
 Recorded in Plan Book _____ Page _____
 Attest: _____ Register

THOMAS G. GARDNER
 REGISTERED PROFESSIONAL SURVEYOR
 No. 1145
 STATE OF MAINE
 71 NEW MAINE DRIVE, PORTLAND, ME 04106
 PHONE: 603.761.1111

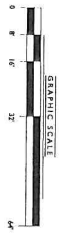

OWNER OF RECORD: 4441 Partners, LLC
 OWNER ADDRESS: 4441 Partners Avenue, Portland, ME 04103

SHEET TITLE	3RD FL
THIRD FLOOR VERTICAL DIMENSIONS	
DATE	03.14.14
SCALE	1/8" = 1'-0"
OWNER	4441 PARTNERS, LLC
NO.	118113
RECORD IN	
BOOK	
PAGE	
DATE	