

State of Maine, Cumberland County  
 Received on \_\_\_\_\_, 2014 at \_\_\_\_\_  
 Recorded in Plan Book \_\_\_\_\_, Page \_\_\_\_\_  
 Attest \_\_\_\_\_ Register

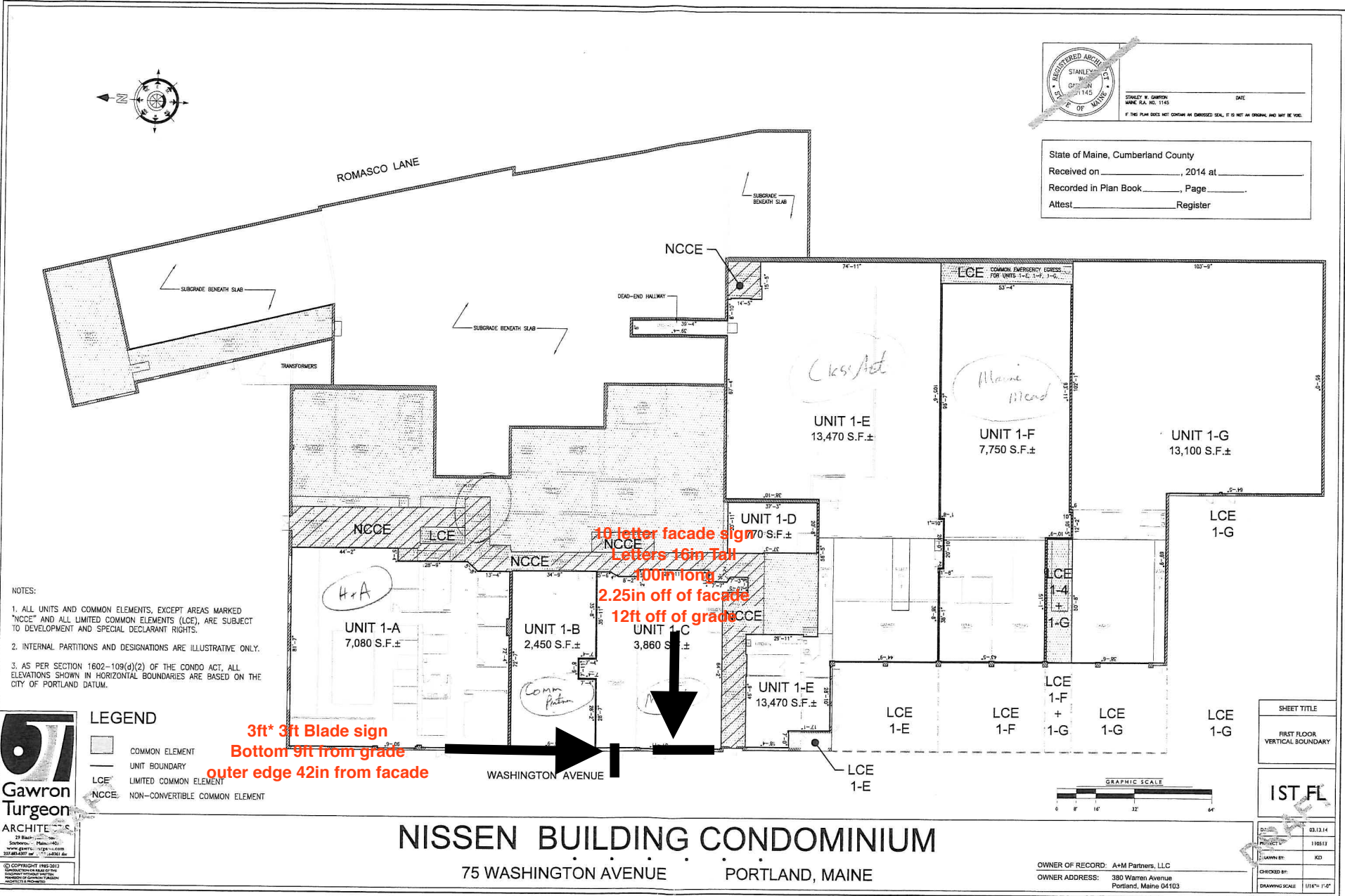

NOTES:  
 1. ALL UNITS AND COMMON ELEMENTS, EXCEPT AREAS MARKED "NCCE" AND ALL LIMITED COMMON ELEMENTS (LCE), ARE SUBJECT TO DEVELOPMENT AND SPECIAL DECLARANT RIGHTS.  
 2. INTERNAL PARTITIONS AND DESIGNATIONS ARE ILLUSTRATIVE ONLY.  
 3. AS PER SECTION 1602-109(d)(2) OF THE CONDO ACT, ALL ELEVATIONS SHOWN IN HORIZONTAL BOUNDARIES ARE BASED ON THE CITY OF PORTLAND DATUM.

**LEGEND**  
 [Symbol] COMMON ELEMENT  
 [Symbol] UNIT BOUNDARY  
 [Symbol] LIMITED COMMON ELEMENT  
 [Symbol] NCCE NON-CONVERTIBLE COMMON ELEMENT

**67**  
**Gawron**  
**Turgeon**  
 ARCHITECTS  
 27 Beach Street  
 Portland, Maine 04103  
 www.67arch.com  
 207.661.4307 or 207.661.4308

**NISSEN BUILDING CONDOMINIUM**  
 75 WASHINGTON AVENUE PORTLAND, MAINE

OWNER OF RECORD: A+M Partners, LLC  
 OWNER ADDRESS: 380 Warren Avenue  
 Portland, Maine 04103

SHEET TITLE	
FIRST FLOOR VERTICAL BOUNDARY	
1ST FL	
NO.	DATE
03.13.14	
PROJECT NO.	110513
DRAWN BY	KD
CHECKED BY	KD
DRAWING SCALE	1/16" = 1'-0"

3/13/14