

REGISTERED ARCHITECT
STANLEY W. GAWRON
MAINE S.A. NO. 1145
DATE _____
IF THIS PLAN DOES NOT CONTAIN AN ENGRAVED SEAL, IT IS NOT AN ORIGINAL AND MAY BE VOID.

State of Maine, Cumberland County
Received on _____, 2014 at _____
Recorded in Plan Book _____, Page _____
Attest _____ Register

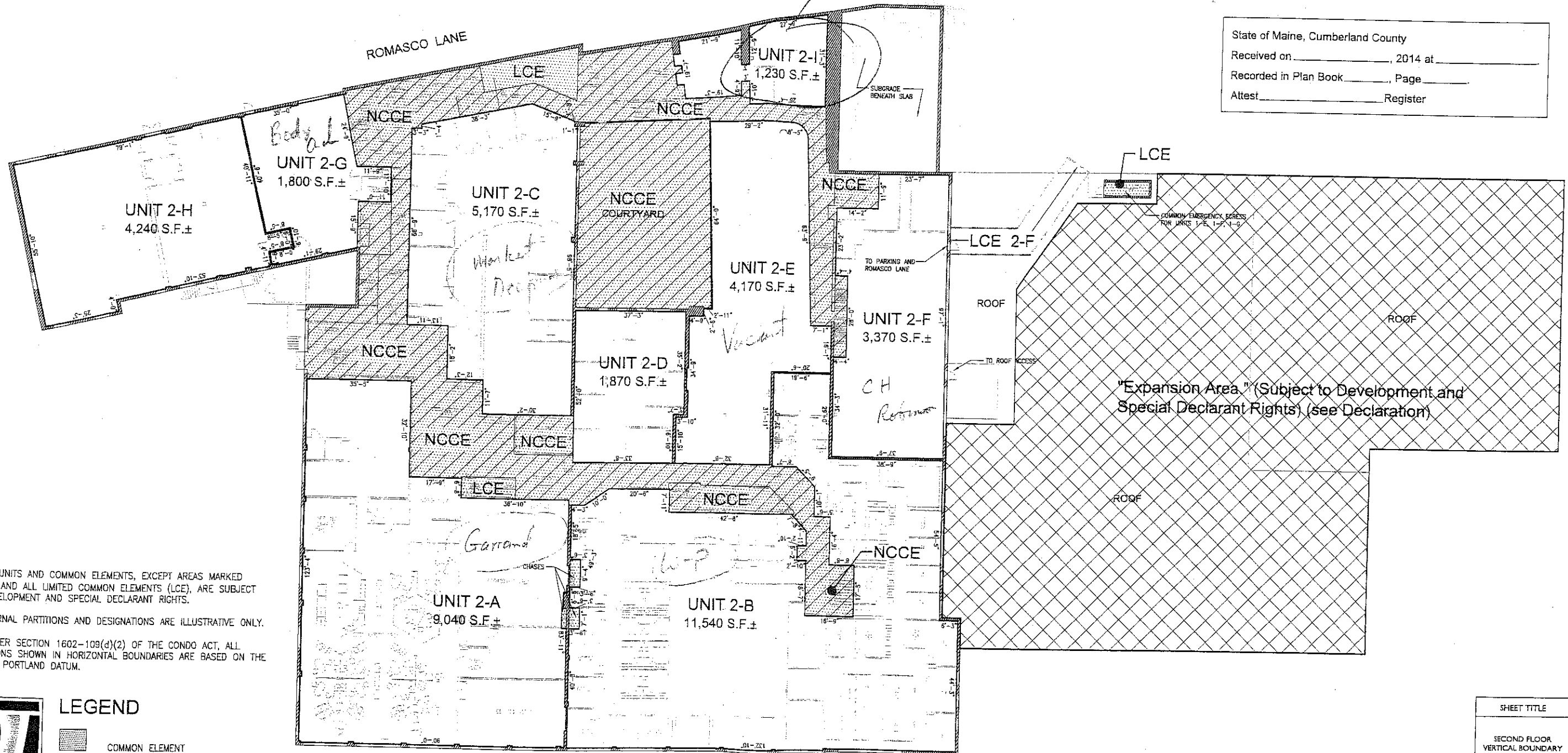

- NOTES:
1. ALL UNITS AND COMMON ELEMENTS, EXCEPT AREAS MARKED "NCCE" AND ALL LIMITED COMMON ELEMENTS (LCE), ARE SUBJECT TO DEVELOPMENT AND SPECIAL DECLARANT RIGHTS.
 2. INTERNAL PARTITIONS AND DESIGNATIONS ARE ILLUSTRATIVE ONLY.
 3. AS PER SECTION 1602-109(d)(2) OF THE CONDO ACT, ALL ELEVATIONS SHOWN IN HORIZONTAL BOUNDARIES ARE BASED ON THE CITY OF PORTLAND DATUM.

LEGEND

- COMMON ELEMENT
- UNIT BOUNDARY
- LCE LIMITED COMMON ELEMENT
- NCCE NON-CONVERTIBLE COMMON ELEMENT

Gawron Turgeon ARCHITECTS
27 Black Horse Lane
Scarborough, Maine 04107
www.gawronturgeon.com
207.883.4307 or 207.524.2361

© COPYRIGHT 1985-2013
REPRODUCTION OR SALE OF THIS DOCUMENT WITHOUT WRITTEN PERMISSION OF GAWRON TURGEON ARCHITECTS IS PROHIBITED.

WASHINGTON AVENUE

NISSEN BUILDING CONDOMINIUM

75 WASHINGTON AVENUE PORTLAND, MAINE

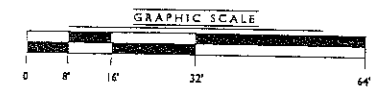

SHEET TITLE	
SECOND FLOOR VERTICAL BOUNDARY	
2ND FL	
DATE	03.13.14
PROJECT	110513
DRAWN BY	KD
CHECKED BY	
DRAWING SCALE	1/16" = 1'-0"

OWNER OF RECORD: A+M Partners, LLC
OWNER ADDRESS: 380 Warren Avenue
Portland, Maine 04103

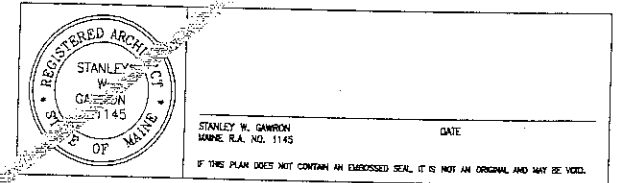
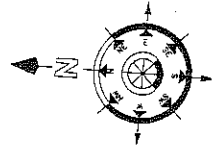

State of Maine, Cumberland County
 Received on _____, 2014 at _____
 Recorded in Plan Book _____, Page _____
 Attest _____ Register

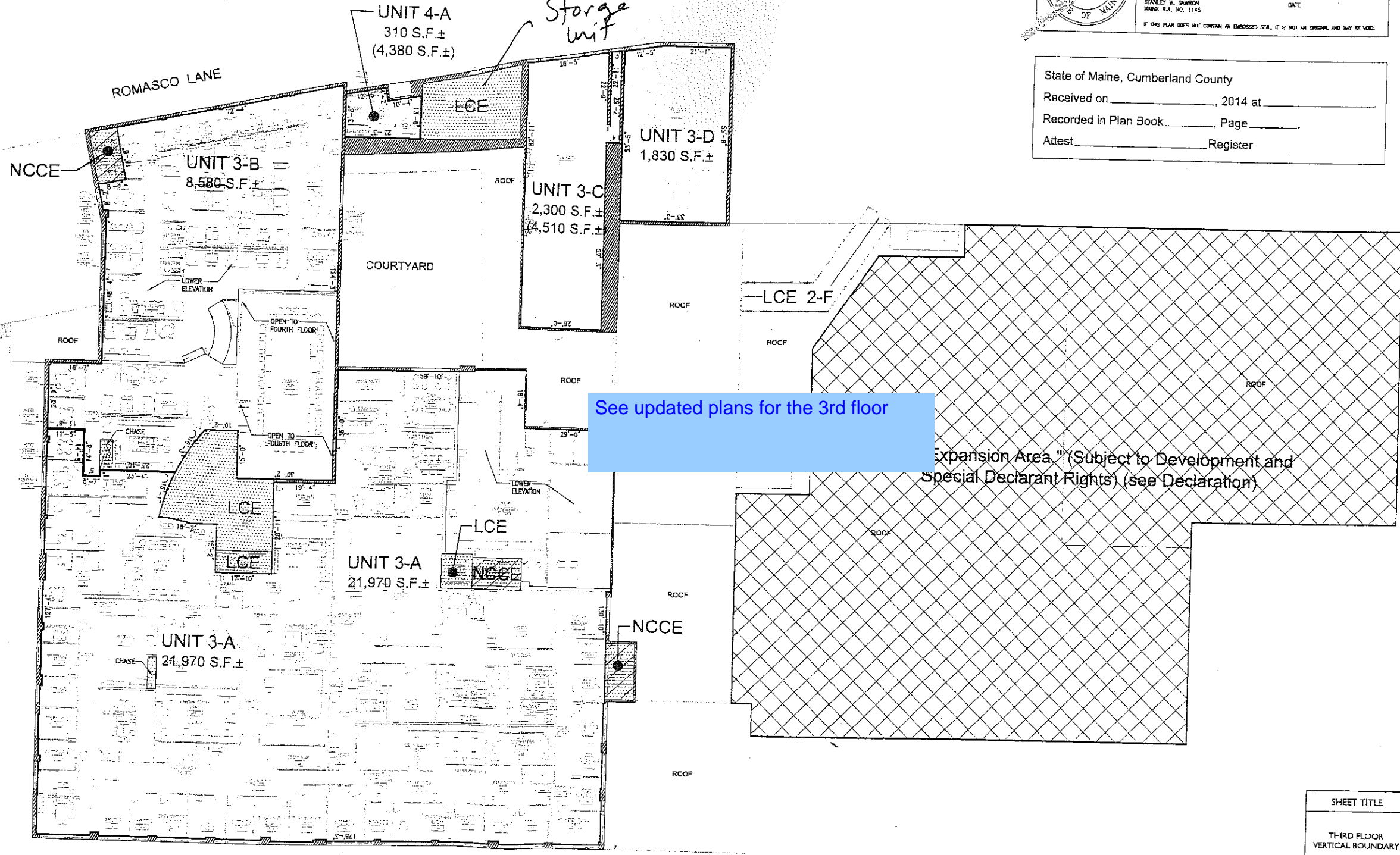

See updated plans for the 3rd floor

- NOTES:
1. ALL UNITS AND COMMON ELEMENTS, EXCEPT AREAS MARKED "NCCE" AND ALL LIMITED COMMON ELEMENTS (LCE), ARE SUBJECT TO DEVELOPMENT AND SPECIAL DECLARANT RIGHTS.
 2. INTERNAL PARTITIONS AND DESIGNATIONS ARE ILLUSTRATIVE ONLY.
 3. AS PER SECTION 1602-109(d)(2) OF THE CONDO ACT, ALL ELEVATIONS SHOWN IN HORIZONTAL BOUNDARIES ARE BASED ON THE CITY OF PORTLAND DATUM.



LEGEND

- COMMON ELEMENT
- UNIT BOUNDARY
- LCE LIMITED COMMON ELEMENT
- NCCE NON-CONVERTIBLE COMMON ELEMENT

NISSEN BUILDING CONDOMINIUM
 75 WASHINGTON AVENUE PORTLAND, MAINE



OWNER OF RECORD: A+M Partners, LLC
 OWNER ADDRESS: 380 Warren Avenue
 Portland, Maine 04103

SHEET TITLE	
THIRD FLOOR VERTICAL BOUNDARY	
3RD FL	
DATE	03.13.14
PROJECT	110513
DRAWN BY	KD
CHECKED BY	
DRAWING SCALE	1/16" = 1'-0"

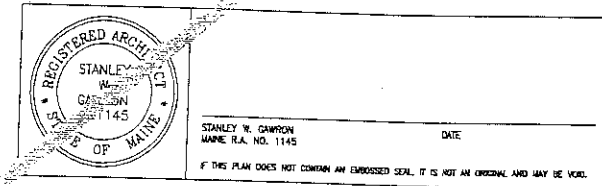
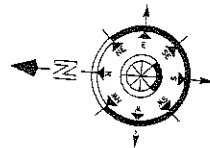

State of Maine, Cumberland County
 Received on _____, 2014 at _____
 Recorded in Plan Book _____, Page _____
 Attest _____ Register

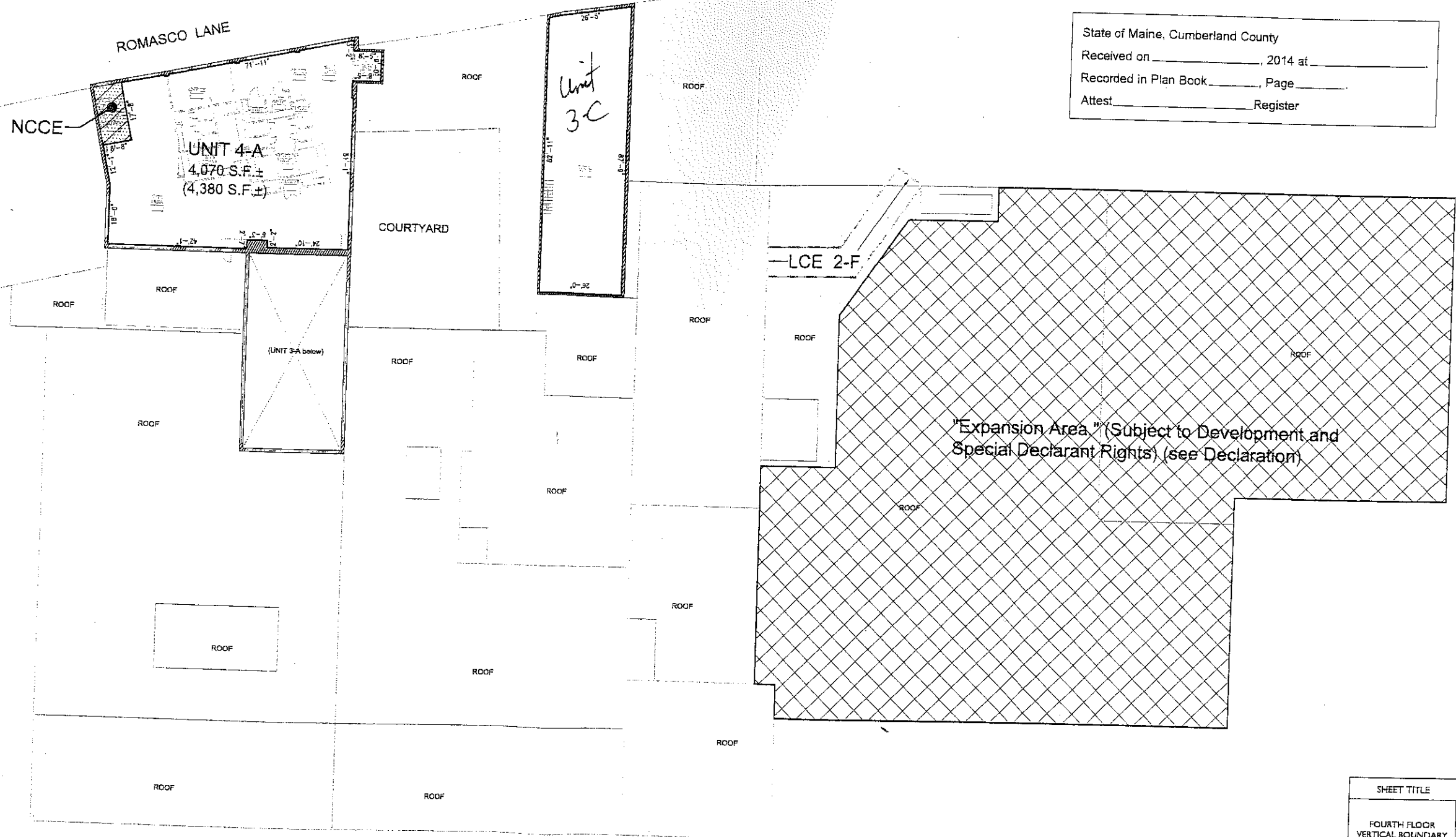

- NOTES:
1. ALL UNITS AND COMMON ELEMENTS, EXCEPT AREAS MARKED "NCCE" AND ALL LIMITED COMMON ELEMENTS (LCE), ARE SUBJECT TO DEVELOPMENT AND SPECIAL DECLARANT RIGHTS.
 2. INTERNAL PARTITIONS AND DESIGNATIONS ARE ILLUSTRATIVE ONLY.
 3. AS PER SECTION 1602-109(d)(2) OF THE CONDO ACT, ALL ELEVATIONS SHOWN IN HORIZONTAL BOUNDARIES ARE BASED ON THE CITY OF PORTLAND DATUM.

LEGEND

- COMMON ELEMENT
- UNIT BOUNDARY
- LCE LIMITED COMMON ELEMENT
- NCCE NON-CONVERTIBLE COMMON ELEMENT

Gawron Turgeon ARCHITECTS
 29 Black Horse Lane
 Scarborough, Maine 04107
 www.gawronturgeon.com
 207.883.4307 or 207.883.4381 fax

NISSEN BUILDING CONDOMINIUM
 75 WASHINGTON AVENUE PORTLAND, MAINE

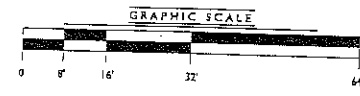

SHEET TITLE
FOURTH FLOOR VERTICAL BOUNDARY
4TH FL

OWNER OF RECORD: A+M Partners, LLC
 OWNER ADDRESS: 380 Warren Avenue
 Portland, Maine 04103

DATE	03.12.14
PROJECT	110513
DRAWN BY	KD
CHECKED BY	
DRAWING SCALE	1/16" = 1'-0"