

**4 PROPOSED FLOORPLAN**  
SCALE: 1/4" = 1'-0"

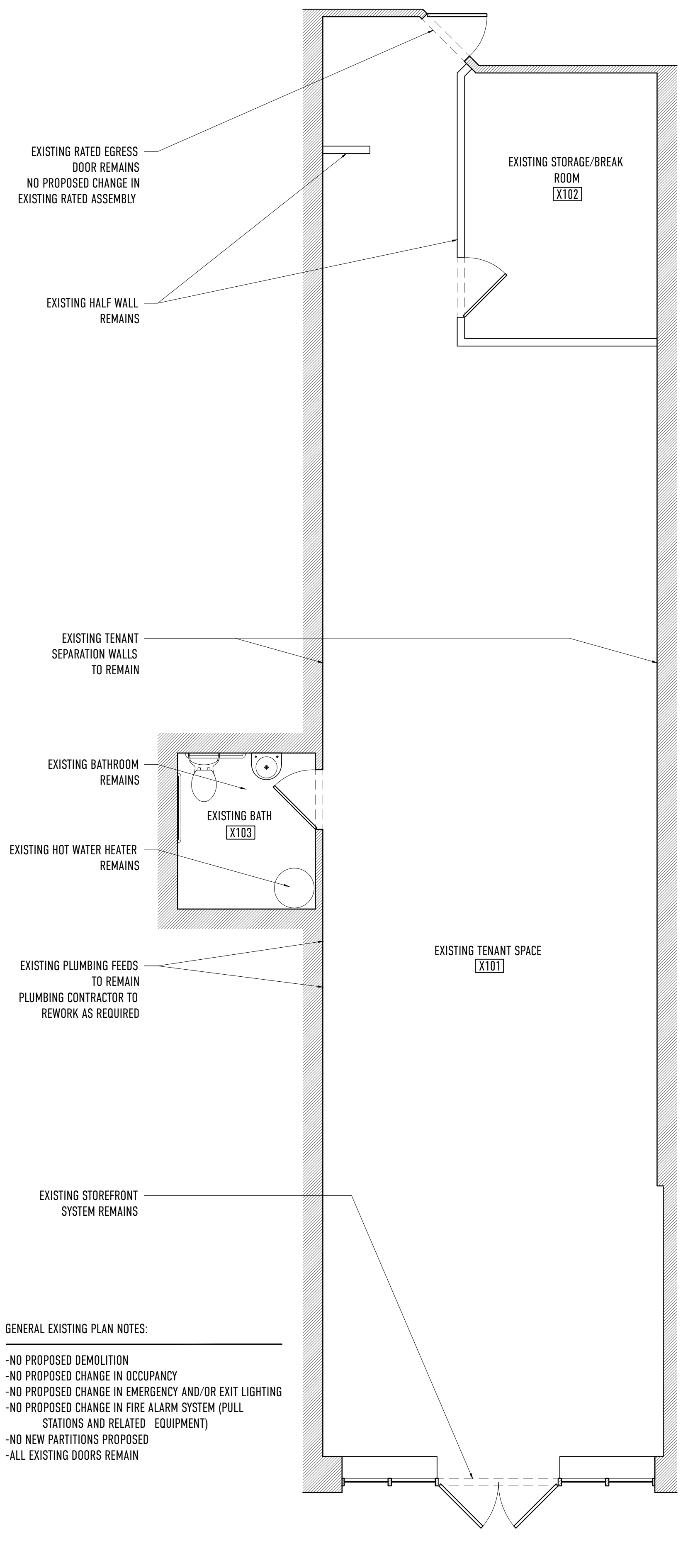

**3 EXISTING FLOORPLAN**  
SCALE: 1/4" = 1'-0"

- GENERAL EXISTING PLAN NOTES:
- NO PROPOSED DEMOLITION
  - NO PROPOSED CHANGE IN OCCUPANCY
  - NO PROPOSED CHANGE IN EMERGENCY AND/OR EXIT LIGHTING
  - NO PROPOSED CHANGE IN FIRE ALARM SYSTEM (PULL STATIONS AND RELATED EQUIPMENT)
  - NO NEW PARTITIONS PROPOSED
  - ALL EXISTING DOORS REMAIN

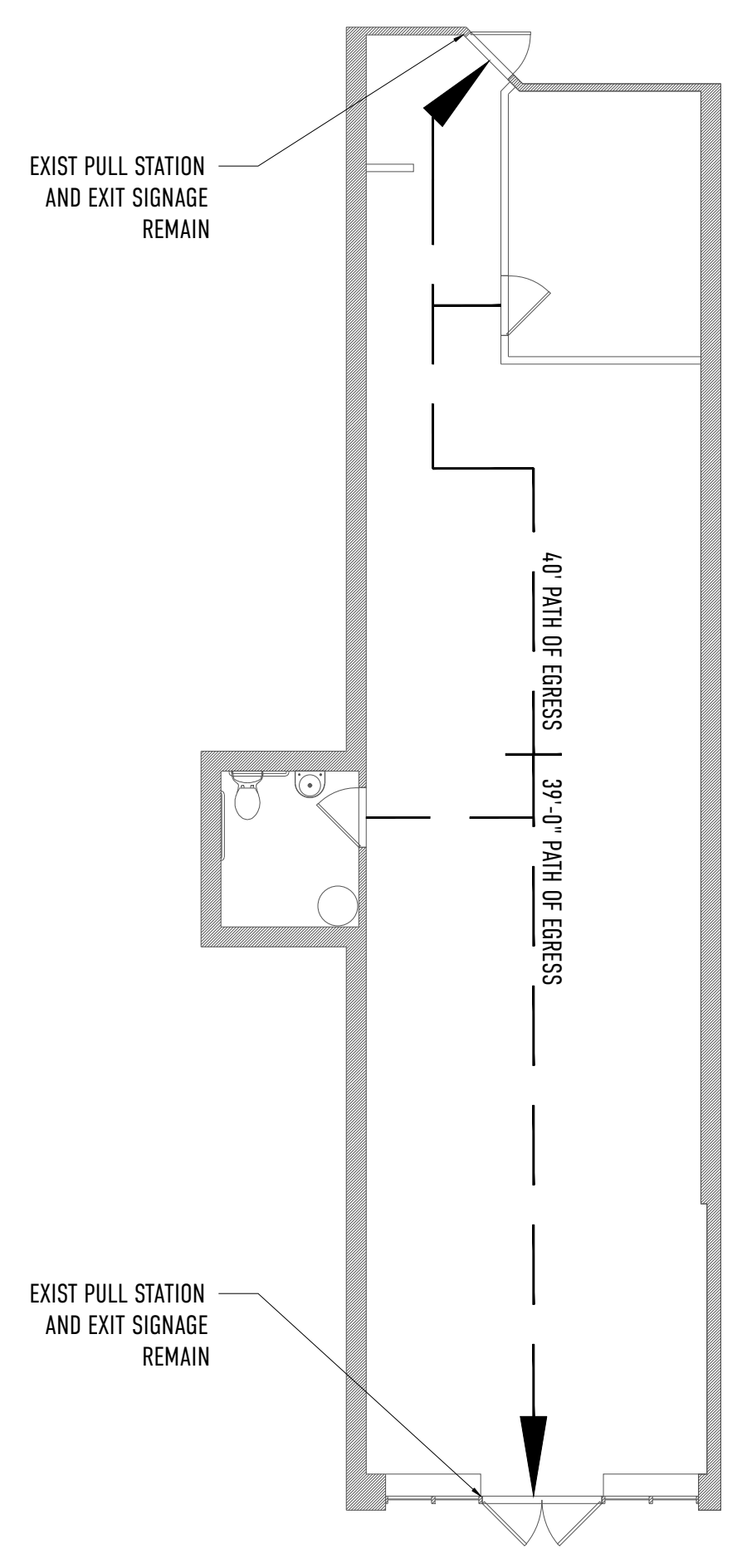

**1 LIFE SAFETY PLAN**  
SCALE: 1/8" = 1'-0"



**2 KEY PLAN**  
SCALE: NTS

CODE SUMMARY:

APPLICABLE CODES  
INTERNATIONAL BUILDING CODE 2009 EDITION  
NFPA 101 2009 EDITION

TOTAL EXISTING TENANT AREA = 1,253 SF

OCCUPANCY CLASSIFICATION  
(IBC SEC 304, 306)  
SECTION 304, BUSINESS GROUP B:  
PROFESSIONAL SERVICES/OFFICE: OCCUPANCY LOAD 100 GROSS (TABLE 1004.1.1)

OCCUPANCY LOAD  
(IBC TABLE 1004.1.1, NFPA)  
OCCUPANCY = 12

AUTOMATIC SPRINKLER SYSTEM  
EXISTING TO REMAIN - PROTECTED THROUGHOUT

REQUIRED OCCUPANCY SEPARATIONS  
(IBC TABLE 508.4)  
EXISTING B TO B TO REMAIN

REVISIONS:

**LIFE SAFETY PLAN, KEY PLAN, CODE SUMMARY, EXIST + PROPOSED PLAN**

**A.101**

DRAWING TITLE:

DATE OF ISSUE:  
NOVEMBER 30, 2017

ISSUED FOR:  
PERMITTING

SCALE:  
AS NOTED

PROJECT NAME:  
LAVENDER SALON  
63 WASHINGTON AVENUE  
PORTLAND, MAINE, 04101

**BARRETT  
MADE**

HOUSES - SPACES - DETAILS

THIS DRAWING IS THE PROPERTY OF BARRETT MADE AND IS NOT TO BE COPIED OR REPRODUCED IN ANY MANNER WITHOUT THE WRITTEN CONSENT OF BARRETT MADE.