

GENERAL NOTES

1: DRAWING NOTES:
CONTRACTOR TO FURNISH AND INSTALL ALL NOTED LABOR AND MATERIALS UNLESS OTHERWISE NOTED.

2: CODE COMPLIANCE:
ALL WORK SHALL CONFORM TO THE LATEST EDITION OF STATE, LOCAL AND OTHER CODES WHICH APPLY TO THIS PROJECT OR HAVE JURISDICTION.

3: COORDINATION:
IT IS THE RESPONSIBILITY OF THE CONTRACTOR TO COORDINATE ALL DISCIPLINES AND TRADES SO THAT ALL BUILDING SYSTEMS AND COMPONENTS CAN BE ASSEMBLED WITHOUT CONFLICTS. IN THE EVENT THAT THE CONSTRUCTION DOCUMENTS DEFINE CONDITIONS WHICH PROHIBIT, OR MAY PROHIBIT, SUCH ASSEMBLY, THE CONTRACTOR SHALL BRING TO THE ARCHITECTS ATTENTION, IN WRITING AND IN A TIMELY FASHION, SUCH CONDITION. THE CONTRACTOR SHALL NOT PROCEED WITH RELATED WORK WITHOUT A WRITTEN RESOLUTION OR CLARIFICATION FROM THE ARCHITECT.

4: DISCREPANCIES & CLARIFICATIONS:
THIS PROJECT INVOLVES THE FIT-UP OF AN EXISTING BUILDING. EXISTING DIMENSIONS SHOWN ON THE DRAWINGS ARE BELIEVED TO BE ACCURATE, BUT CANNOT BE GUARANTEED. MEASURE AND VERIFY DIMENSIONS IN FIELD PRIOR TO FABRICATION AND CONSTRUCTION. IT IS THE RESPONSIBILITY OF THE CONTRACTOR TO BRING TO THE ARCHITECTS ATTENTION, IN WRITING, ANY DISCREPANCIES OR AMBIGUITIES IN THE DRAWINGS AND/OR SPECIFICATIONS. THE CONTRACTOR SHALL NOT PROCEED WITH RELATED WORK WITHOUT A WRITTEN RESOLUTION OR CLARIFICATION FROM THE ARCHITECT.

5: LAYOUT:
UNLESS INDICATED OTHERWISE, CENTER WALL FRAMING AND PARTITION FRAMING ON COLUMN LINES. FLOOR PLAN DIMENSIONS ARE TO CENTER OF FRAMING, FACE OF CONCRETE, FACE OF CMU, OR FROM COLUMN CENTERLINES, UNLESS INDICATED OTHERWISE. DOORS AND WINDOWS ARE DIMENSIONED TO CENTERLINES UNLESS INDICATED OTHERWISE.

6: CENTERING:
UNLESS INDICATED OTHERWISE, CENTER BUILDING ELEMENTS WITHIN OR BETWEEN OTHER BUILDING ELEMENTS WHEN CONDITIONS OR THE DRAWINGS INDICATE OR IMPLY THAT SUCH IS THE INTENT, WHETHER OR NOT DIMENSIONS ARE INCLUDED.

7: SYMMETRY:
WHERE CONDITIONS OR THE DRAWINGS INDICATE OR IMPLY THAT SYMMETRY IS INTENDED, INFORMATION PROVIDED AT ONE SIDE APPLIES EQUALLY TO BOTH SIDES, UNLESS CONDITIONS CLEARLY PRECLUDE SUCH APPLICATION.

8: ACCESSIBILITY:
ALL HANDICAPPED ACCESSIBLE BATHROOMS, GRAB BARS, AND DOOR OPENINGS SHALL MEET THE REQUIREMENTS OF TITLE 94-34B, CHAPTER 5 OF THE MAINE HUMAN RIGHTS COMMISSION TITLE LATEST EDITION & THE DEPARTMENT OF JUSTICE ADA STANDARDS FOR ACCESSIBLE DESIGN.

9: DRAWING SCALES:
WORK FROM THE GIVEN DIMENSIONS ONLY. SCALE IS INDICATED ON THE DRAWINGS FOR CONVENIENCE ONLY. IT IS NOT INTENDED THAT INFORMATION BE DETERMINED BY SCALING THE DRAWINGS SINCE SOME ITEMS MAY NOT BE TO SCALE.

10: WATER-RESISTANT GWB:
INSTALL WATER-RESISTANT GYPSUM WALL BOARD IN ALL REST ROOMS & TOILET ROOMS OR AT ANY WALL WITH PLUMBING FIXTURES.

10A: HIGH IMPACT GWB:
INSTALL HIGH IMPACT GYPSUM WALL BOARD IN ALL STAIRWELLS

11: INTERIOR ELEVATIONS:
INTERIOR ELEVATIONS MAY BE REVERSED FROM AND/OR SIMILAR TO ACTUAL CONDITIONS. SEE FLOOR PLANS FOR WINDOW AND DOOR QUANTITIES AND LOCATIONS, FOR CASEWORK LAYOUTS, AND FOR MONITOR LOCATIONS.

12: BUILDING INSULATION:
PROVIDE AS INDICATED IN WALL SECTIONS AND IN ACCORDANCE WITH PARTITION TYPES, WHETHER OR NOT SHOWN IN DETAILS AND OTHER DRAWINGS. FOR CLARITY, INSULATION MAY NOT BE SHOWN IN SOME CASES, EVEN IF IT IS TO BE PROVIDED.

13: BLOCKING:
INSTALL BLOCKING BEHIND ALL SURFACE-APPLIED FIXTURES TRIM, CASEWORK, SINKS, BRACKETS, TOILET ACCESSORIES, CHAIR RAILS, PICTURE RAILS, GRAB BARS, BASE MOLDINGS, AND AS OTHERWISE REQUIRED, WHEN SUCH ITEMS ARE APPLIED ON STUD WALLS.

14: PENETRATIONS AT STRUCTURAL MEMBERS:
BEFORE PENETRATING JOISTS, BEAMS OR OTHER STRUCTURAL MEMBERS, CONSULT WITH THE ARCHITECT.

15: DAMAGED WORK:
BUILDING OR SITE COMPONENTS WHICH ARE AFFECTED BY NEW WORK, DEMOLITION, OR WHICH MAY BE DAMAGED BY THE GENERAL CONTRACTOR OR ANY SUB-CONTRACTOR SHALL BE REPLACED OR RESTORED TO ORIGINAL CONDITION AND COLOR TO MEET THE APPROVAL OF THE ARCHITECT.

16: UTILITIES:
VERIFY THE SIZE AND LOCATION OF ALL UNDERGROUND UTILITIES AND REPORT ANY DISCREPANCIES TO THE ARCHITECT IN WRITING. DO NOT PROCEED WITH WORK UNTIL THE DISCREPANCY HAS BEEN RESOLVED TO THE SATISFACTION OF THE ARCHITECT.

17: RATED CONSTRUCTION:
PROVIDE RATED CONSTRUCTION AS REQUIRED BY CODE, AS SPECIFIED, AND AS INDICATED ON DRAWINGS. IT IS THE RESPONSIBILITY OF THE CONTRACTOR TO PROVIDE AND INSTALL ALL COMPONENTS REQUIRED TO CREATE SUCH RATED CONSTRUCTION, REGARDLESS OF WHETHER OR NOT SUCH COMPONENTS ARE INDICATED. PROVIDE CONTINUITY OF SUCH RATED CONSTRUCTION AROUND AND BETWEEN SPACES, INCLUDING AT CHASES AND AT FLOORS, TO MAINTAIN COMPLETE SEPARATIONS, EVEN IF NOT SPECIFICALLY INDICATED.

18: SHOP DRAWINGS:
SUBMIT SHOP DRAWINGS TO THE ARCHITECT FOR REVIEW PRIOR TO FABRICATIONS. SUBMITTALS REQUIRED INCLUDE, BUT ARE NOT LIMITED TO, SHOP DRAWINGS FOR ALL PREFABRICATED CONCRETE, STEEL, MILLWORK & SIGNAGE, SAMPLES OF ALL PROPOSED PAINTS, METALS, WALL COVERINGS, LAMINATES, SOLID SURFACE MATERIALS, CERAMIC TILE, AND HARDWARE. SUBMIT MANUFACTURERS' DATA FOR ALL LIGHTING SYSTEMS, AND HARDWARE.

19: PERMITS:
THE GENERAL CONTRACTOR SHALL OBTAIN AND PAY FOR ANY BUILDING PERMITS REQUIRED AND CARRY ANY INSURANCE COVERAGES REQUIRED.

20: INTERIOR FINISHES:
ALL INTERIOR FINISHES AND FURNISHINGS ARE TO BE CLASS 'A' FIRE-RATED AND ARE TO COMPLY WITH IBC CHAPTER-8 (INTERIOR FLAME SPREAD).

21: ELECTRICAL DESIGN:
REFER TO ELECTRICAL DRAWINGS AND SPECIFICATIONS

22: WASTE REMOVAL:
THE GENERAL CONTRACTOR SHALL DISPOSE OF ALL WASTE AND DEBRIS OFF THE PREMISES.

23: LANDLORD COORDINATION:
THE GENERAL CONTRACTOR MUST COORDINATE WITH THE BUILDING OWNER ALL ACTIVITIES INCLUDING BUT NOT LIMITED TO WORK WHICH WILL GENERATE EXCESSIVE NOISE AND MODIFICATION TO UTILITIES. WORK MUST NOT INTERFERE WITH EXISTING SMOKE DETECTORS, ALARMS OR BUILDING SYSTEM MANAGEMENT.

24: TEMPORARY FACILITIES:
PROVIDE ALL TEMPORARY FACILITIES AND SERVICES, CONSTRUCTION AND SUPPORT FACILITIES, AND SECURITY AND PROTECTION AS NEEDED TO PROTECT NEW AND EXISTING CONSTRUCTION FOR THE DURATION OF A COMPLETE INSTALLATION.

25: FINAL CLEANING:
EMPLOY EXPERIENCED WORKERS FOR FINAL CLEANING. CLEAN EACH SURFACE TO THE CONDITION EXPECTED IN A COMMERCIAL BUILDING CLEANING PROGRAM.

26: MANUFACTURERS INSTRUCTIONS:
ALL MATERIALS & EQUIPMENT SHALL BE INSTALLED ACCORDING TO MANUFACTURER'S SPECIFICATIONS.

27: GUARANTEE:
GUARANTEE: ALL MATERIALS AND WORKMANSHIP SHALL BE GUARANTEED FOR A PERIOD OF ONE YEAR FROM THE DATE OF FINAL ACCEPTANCE UNLESS OTHERWISE SPECIFIED FOR A LONGER PERIOD OF TIME ON A CERTAIN ITEM.

28: ASBESTOS:
ALL MATERIAL USED FOR THE CONSTRUCTION OF THIS PROJECT, WHETHER BUILDING MATERIALS OR APPURTENANCES, SHALL BE NON-ASBESTOS CONTAINING MATERIAL.

29: HAZARDOUS FUMES:
THE GENERAL CONTRACTOR SHALL CONFIRM THAT ALL MATERIAL AND FINISHES SPECIFIED AND THEIR FABRICATION OR INSTALLATION WILL NOT RELEASE FUMES OR AROMAS DURING CONSTRUCTION WHICH MAY BE A HAZARD OR NUISANCE TO PERSONNEL.

30: PEST CONTROL:
SEAL AND CAULK AROUND ALL PENETRATIONS, CRACKS AND CREVICES AND ANY OPENINGS CAPABLE OF HARBORING INSECTS/RODENTS.

31: EXPOSED UTILITIES:
ALL EXPOSED UTILITY WIRES AND PIPES (ELECTRICAL, PLUMBING, ETC.) SHALL BE INSTALLED IN A WAY THAT DOES NOT OBSTRUCT OR PREVENT THE CLEANING OF FLOORS, WALLS, AND CEILING AREAS. THEY SHALL BE INSTALLED A MINIMUM OF 6" OFF FLOORS AND 1" OFF WALLS, CEILINGS AND ADJACENT PIPES.

32: OWNER SUPPLIED EQUIPMENT:
EQUIPMENT SUPPLIED BY THE OWNER AND INSTALLED BY THE GENERAL CONTRACTOR. EQUIPMENT INFORMATION AND SPECIFICATIONS ARE TO BE THE MOST CURRENT AVAILABLE AT THE TIME OF DOCUMENTATION PREPARATION. THE GENERAL CONTRACTOR SHALL BE RESPONSIBLE FOR VERIFYING WITH THE OWNER THE EXACT DIMENSIONS AND EQUIPMENT CONNECTION REQUIREMENTS (INCLUDING ELECTRICAL CIRCUIT REQUIREMENTS) OF EQUIPMENT TO BE SUPPLIED. THE GENERAL CONTRACTOR SHALL MAKE ALL FINAL CONNECTIONS AS NOTED ON THE DRAWINGS, INSTALL THE SET UP IN WORKING ORDER, CHECK WARRANTIES, TEST AND NOT VOID WARRANTIES. THE GENERAL CONTRACTOR SHALL COORDINATE WITH THE OWNER DELIVERY, STORAGE AND INSTALLATION OF ALL OWNER SUPPLIED EQUIPMENT. THE GENERAL CONTRACTOR SHALL STORE EQUIPMENT IF REQUESTED BY THE OWNER UNTIL INSTALLATION. SEE DRAWINGS FOR OTHER OWNER SUPPLIED/GENERAL CONTRACTOR INSTALLED ITEMS.

33: FIRE PROTECTION NOTE:
EXISTING SPRINKLER HEADS, ALARM SYSTEM AND DETECTORS ARE TO BE MODIFIED TO CONFORM WITH THE PROPOSED PLAN. COORDINATE WITH THE ARCHITECT, ANY MODIFICATION OR LOCATIONS WHERE EXISTING SYSTEMS ARE AFFECTED BY THE NEW DESIGN.

34: SOILS AT FOOTINGS:
REPORT THE LOCATION OF ALL UNSUITABLE SOILS AND MATERIALS BELOW ANTICIPATED LEVEL OF FOOTING TO THE ARCHITECT PRIOR TO THE SETTING OF FORMS.

35: ACCESS PANELS:
CONTRACTOR IS RESPONSIBLE FOR COORDINATING QUANTITY AND LOCATION OF ALL REQUIRED ACCESS PANELS FOR ALL MEP CONTROLS, CLEANOUTS, DAMPERS, PULL BOXES, ETC.

36: EXISTING HAZARDOUS MATERIALS
ALL HAZARDOUS MATERIALS INCLUDING BUT NOT LIMITED TO ASBESTOS AND LEAD PAINT ARE TO BE HANDLED, ENCAPSULATED, ABATED AND DISPOSED OF IN ACCORDANCE WITH ANY AND ALL FEDERAL, STATE AND LOCAL REQUIREMENTS AND REGULATIONS.

37: INDUSTRY STANDARDS:
ALL WORK SHALL BE PERFORMED IN ACCORDANCE WITH INDUSTRY STANDARDS. STANDARDS INCLUDE BUT ARE NOT LIMITED TO THE FOLLOWING:

- AAMA AMERICAN ARCHITECTURAL MANUFACTURERS ASSOCIATION
- ACT AMERICAN CONCRETE INSTITUTE
- ANSI AMERICAN NATIONAL STANDARDS INSTITUTE
- ASTM AMERICAN SOCIETY FOR TESTS AND MATERIALS
- AWI ARCHITECTURAL WOODWORK INSTITUTE
- AWS "CUSTOM GRADE" AMERICAN WELDING SOCIETY
- IGMA INSULATING GLASS MANUFACTURERS ALLIANCE
- NAAMM NATIONAL ASSOCIATION OF ARCHITECTURAL METAL MANUFACTURERS
- NRCA NATIONAL ROOFING CONTRACTORS ASSOCIATION
- NTCA NATIONAL TILE CONTRACTORS ASSOCIATION
- SMACNA SHEET METAL AND AIR CONDITIONING NATIONAL ASSOCIATION
- WDMA WINDOW AND DOOR MANUFACTURERS ASSOCIATION

ABBREVIATIONS

| | |
|--|---|
| A AC AIR CONDITIONING | L LAB LABORATORY |
| AD ACT ACoustical CEILING TILE | LAM LAMINATED |
| ADA AD AREA DRAIN | LB LEAD |
| ADAAG AMERICANS WITH DISABILITIES ACT ACCESSIBILITY'S GUIDELINES | LH LEFT-HAND |
| ADD ADDENDUM | LCC LEAD COATED COPPER |
| AFF AFF ABOVE FINISHED FLOOR | M MACH MACHINE |
| AHU AHU AIR-HANDLING UNIT | MAS MASONRY |
| AL ALUMINUM | MATL MATERIAL |
| ARCH ARCHITECT/ARCHITECTURAL | MAX MAXIMUM |
| AWP AWP ACCESSIBILITY'S GUIDELINES | MDO MEDIUM-DENSITY OVERLAY |
| B B TO BLS BACK-TO-BACK ANGLES | MECH MECHANICAL |
| B.B.G.C. BASE BUILDING GENERAL CONTRACTOR | MEMB MEMBRANE |
| BLDG BUILDING | MET METAL |
| BLK BLOCKING | MEZZ MEZZANINE |
| BSMT BASEMENT | MFR MANUFACTURER |
| BTWN BETWEEN | MIN MINIMUM |
| BO BY OTHERS | MISC MISCELLANEOUS |
| C COURSE (MASONRY) | MO MASONRY OPENING |
| CER CERAMIC | MTD MOUNTED |
| CG CORNER GUARD | MTL METAL |
| CH COAT HOOK | MRB MARKER BOARD |
| CJ CONTROL JOINT | N N |
| CL CENTER LINE | N NORTH |
| CMU CONCRETE MASONRY UNIT | # NUMBER |
| COL COLUMN | NIC NOT IN CONTACT |
| CONC CONCRETE | NOM NOMINAL DIMENSION |
| COND COND | NTS NOT TO SCALE |
| CONN CONNECT/CONNECTION | O ON/OVER |
| CONSTR CONSTRUCTION | OC ON CENTER |
| CONT CONTINUOUS | OD OUTSIDE DIAMETER/OUTSIDE DIMENSION |
| CORR CORRIDOR | OFF OFFICE |
| CT CERAMIC TILE | OPNG OPENING |
| CUH CABINET UNIT HEATER | OPR OPPOSITE |
| D DBL DOUBLE | OPPH OPPOSITE HAND |
| DF DRINKING FOUNTAIN | OSB ORIENTED STRAND BOARD |
| DIA DIAMETER | P P |
| DIM DIMENSION | PBOIBC PURCHASED BY OWNER INSTALLED BY CONTRACTOR |
| DN DOWN | PC PRECAST |
| DR DOOR | PLAM PLASTIC LAMINATE |
| DSP DRY STAND PIPE DRAWING | PR PAIR |
| E EAST | PREFAB PREFABRICATE |
| EACH EACH | PRIV PRIVACY |
| ELEV ELEVATION | PRIM PRIMED |
| ELEV FOR ELEVATOR | PSF POUNDS PER SQUARE FOOT |
| ELEV FOR ELEVATOR | PSI POUNDS PER SQUARE INCH |
| ENTR ENTRANCE | PTN PARTITION |
| EQU EQUIPMENT | PVC POLYVINYL CHLORIDE |
| EXP EXPANSION | PWD PLYWOOD |
| EXPB EXPANSION BOLT | PT PRESSURE TREATED |
| EXPJ EXPANSION JOINT | PERF PERFORATED |
| EXT EXTERIOR | Q QUARRY TILE |
| EPDM ETHYLENE PROPYLENE DIENE MONOMER | QTR QUARTER |
| EWG ELECTRIC WATER COOLER | R R |
| F FAHRENHEIT | RAD RISER/RADIUS |
| FB FLAT BAR | RB RUBBER BASE |
| FC FIRE EXTINGUISHER AND CABINET | REF REFLECTED GELING PLAN |
| FD FLOOR DRAIN | REBAR REINFORCING BAR |
| FE FIRE EXTINGUISHER | REFR REFRIGERATOR |
| FEC FIRE EXTINGUISHER CABINET | REINF REINFORCED |
| FTWD FIRE TREATED WOOD FINISH | REQ REQUIRED |
| FB FACE OF BRICK | RES RESILIENT |
| FOC FACE OF CONCRETE | REV REVERSE |
| FOF FACE OF FINISH | RM ROOM |
| FOF FACE OF STUDS | ROW ROUGH OPENING |
| FOF FACE OF WALL | ROW RIGHT OF WAY |
| FS FIRE SUPPRESSION SYSTEM | S SOUTH |
| FT FOOT | SCHED SCHEDULE |
| FTG FOOTING | SE SQUARE FEET |
| FTR FIBER REINFORCED GYPSUM | SIM SIMILAR |
| FTS FIN TUBE RADIATION | SPEC SPECIFICATION |
| GH FUME HOOD | SQ SQUARE |
| GA GAUGE | SST STAINLESS STEEL |
| GALV GALVANIZED | STD STANDARD |
| GB GRAB BAR | STR STEEL |
| GC GENERAL CONTRACTOR | STRUC STRUCTURE/STRUCTURAL |
| GFI GROUND-Fault INTERRUPTER | SUSP SUSPENSION |
| GL GLASS | T TAG |
| GLAM GLUE-LAMINATED WOOD | TEL TELEPHONE |
| GWB GYPSUM WALL BOARD | THK THICK |
| H HOSE BIB | THD TOP OF DECK |
| HC HANDICAP | TOD TOP OF STEEL |
| HM HOLLOW METAL | TPY TYPICAL |
| HORIZ HORIZONTAL | TV TELEVISION |
| HP HORSE POWER/HIGH POINT HEAT PUMP | TB TACK BOARD |
| HR HORIZONTAL | TOC TOP OF CONCRETE |
| HW HOT WATER | U UNDERWRITERS LABORATORIES, INC. |
| HVAC HEATING VENTILATION AIR CONDITIONING | UV UNIT VENTILATOR |
| ID INSIDE DIMENSION/INSIDE DIAMETER | V VCT VINYL COMPOSITION TILE |
| IN INCHES | VERT VERTICAL |
| INFO INFORMATION | VIF VERIFY IN FIELD |
| INSUL INSULATION | VOL VOLUME |
| J JOIST | W WEST |
| JT JOINT | WO WITHOUT |
| K KILN-DRIED | W WITH |
| KIP 1000 POUNDS | WO WOOD |
| | WF WIDE FLANGE |
| | WP WORK POINT |
| | WT WEIGHT |

FIRESTOPPING DETAILS

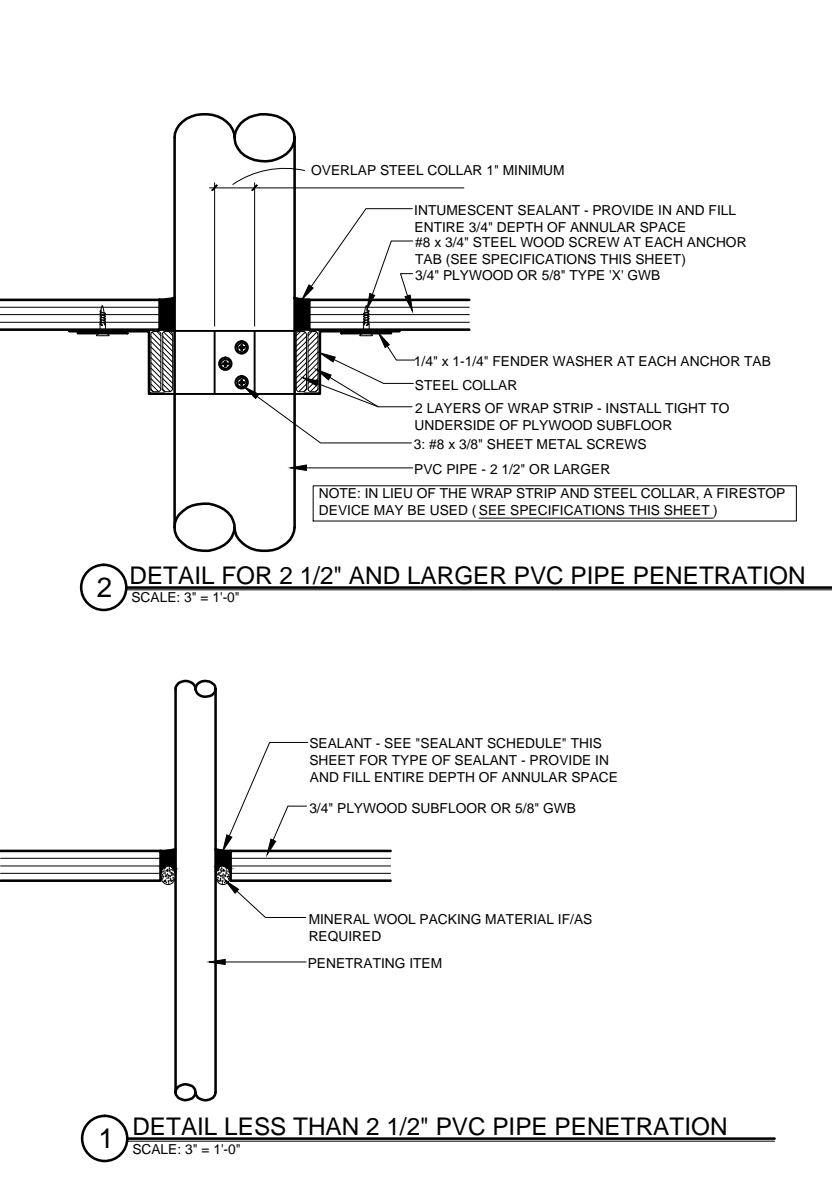

SPECIFICATIONS

WRAP STRIP: 1/4" THICK x 1 1/2" MINIMUM WIDTH INTUMESCENT MATERIAL WITH PLASTIC FILM FACING BOTH SIDES. TEMPORARILY SECURE WITH MAKING TAPE. SPECIFIED TECHNOLOGIES INC. (STI) *SpecSeal RED Wrap Strip* OR *SpecSeal BLU Wrap Strip* OR EQUAL.

STEEL COLLAR: WRAP STRIP MANUFACTURER'S STEEL COLLAR, FABRICATED FROM .016 INCH THICK GALVANIZED SHEET STEEL, REFLECTED GELING PLAN, R/OF DRAIN ANCHOR TABS AND RETAINER TABS. ANCHOR TABS TO BE SYMMETRICALLY OPPOSED AROUND COLLAR; PROVIDE 3 TABS FOR 2 1/2" AND 3" PIPE; PROVIDE 4 TABS FOR 4" PIPE.

INTUMESCENT SEALANT: ONE-PART, INTUMESCENT, LATEX ELASTOMER TESTED TO ASTM E 814. MINIMUM EXPANSION OF 3x AT 1000°F. 3M *FIRE BARRIER SEALANT CP 25WB* OR EQUAL.

FIRESTOP SEALANT: SINGLE COMPONENT NONCOMBUSTIBLE FIRE RATED SEALANT TESTED TO ASTM E 814. TESTED TO 3000°F. *BOSS 158 FIRESTOP DRAFT SEALANT* MANUFACTURED BY ACCUMETRIC, LLC., OR EQUAL.

SEALANT SCHEDULE:
INTUMESCENT SEALANT: PROVIDE AT ALL PENETRATIONS THROUGH RATED CONSTRUCTION FOR PENETRATING ITEMS INCLUDING BUT NOT LIMITED TO: PVC PIPE; ROOF LEADER PIPES, GAS PIPES & LINES; SPRINKLER PIPES; ELECTRICAL & COMMUNICATIONS CABLES & WIRES; AND ALARM SYSTEM WIRES. DO NOT USE INTUMESCENT SEALANT AT DOMESTIC HOT WATER OR HYDRONIC HEATING SYSTEM PIPES.
FIRESTOP SEALANT: PROVIDE AT ALL PENETRATIONS THROUGH RATED CONSTRUCTION FOR PENETRATING ITEMS INCLUDING DOMESTIC HOT AND COLD WATER PIPES AND HYDRONIC HEATING SYSTEM PIPES.

NOTE:
FOR LOCATIONS OF RATED CONSTRUCTION, SEE ARCHITECTURAL FLOOR PLANS AND SECTIONS

DRAWING LEGEND

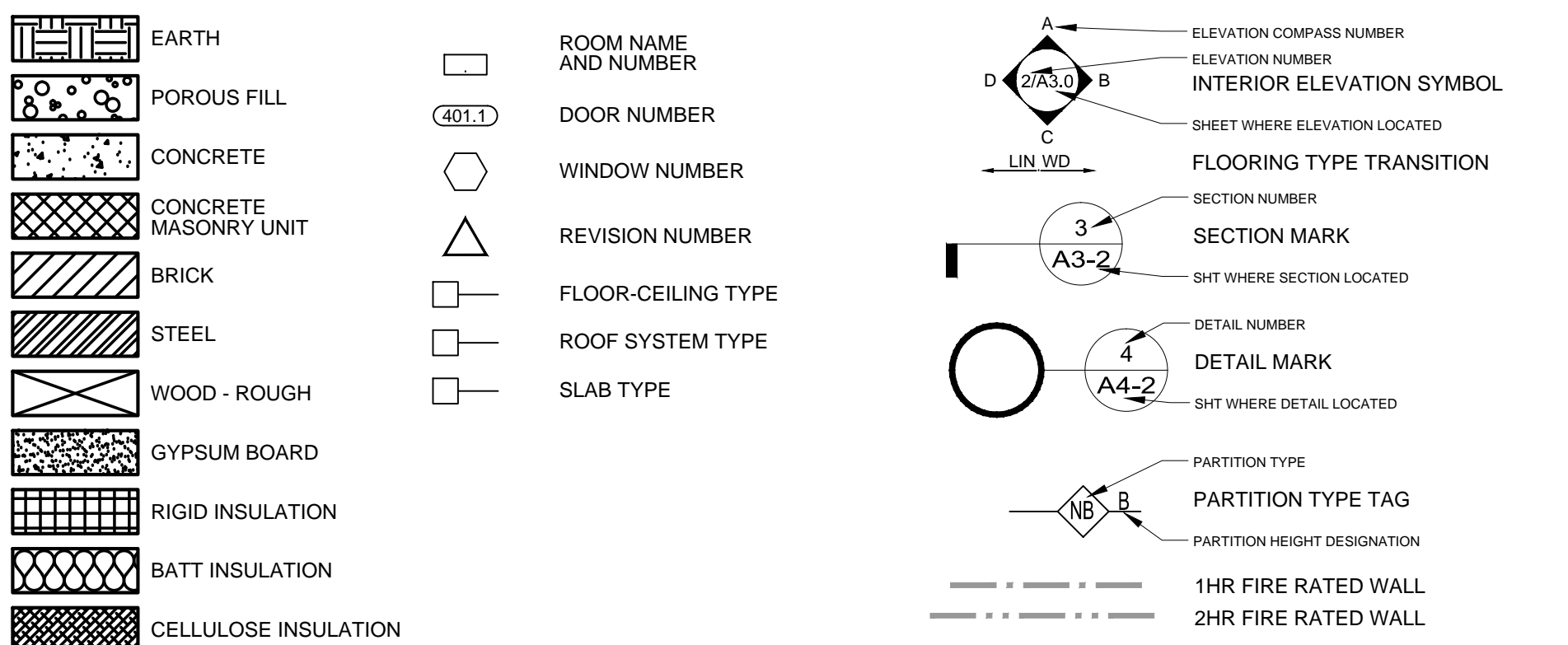

REGISTERED ARCHITECT
RYAN J. SENATORE
No. 3322
STATE OF MAINE
© 2017 RYAN SENATORE ARCHITECTURE

MAINE AND LOIRE
75 WASHINGTON AVENUE
PORTLAND, MAINE

RSA
RYAN SENATORE ARCHITECTURE
565 CONGRESS STREET
PORTLAND, MAINE 04101
207-650-6414
senatorearchitect.com

CONSULTANTS:

REVISIONS:

| | |
|-------------|--------------------|
| DATE: | SEPTEMBER 29, 2017 |
| PROJECT No. | 1762 |
| DRAWN BY: | RJS |
| CHECKED BY: | RJS |
| SCALE: | AS NOTED |

SHEET TITLE:
GENERAL NOTES
ABBREVIATIONS
LEGEND

G1-0