

- ### DEMOLITION NOTES
- 1 REMOVE EXISTING WALL & DOOR / FRAME. SALVAGE DOOR / FRAME FOR REUSE IN NEW WORK.
 - 2 REMOVE EXISTING CEILING. PATCH EXISTING FINISHES TO MATCH ADJACENT AREAS.
 - 3 REMOVE EXISTING PARTITION FOR NEW HALL OPENING.
 - 4 REMOVE EXISTING SINK AND TOILET ACCESSORIES. SALVAGE FOR RELOCATION IN NEW WORK.
 - 5 REMOVE EXISTING TOILET PARTITIONS. PATCH TO MATCH ADJACENT FINISHES.
 - 6 REMOVE EXISTING URINAL. SALVAGE FOR REUSE IN THE NEW WORK.

- ### DOOR NOTES
1. DOOR 102 (RELOCATED) WITH SELF-CLOSING HINGES / CLOSER & LEVER HANDLE PRIVACY LOCKSET.
 2. DOORS 103, 104, & 105 (NEW 2468) SHALL HAVE 3 BUTTS, 1 LEVER LOCKSET-PRIVACY FUNCTION WITH OCCUPANCY INDICATOR.
 3. DOOR 106 SHALL HAVE LEVER LOCKSET-STORE ROOM FUNCTION.

- ### PARTITION TYPES
- 2x6 STUDS @ 16" O.C. w/ 3/4" PTD MR GWB, EACH FACE OF STUDS & ACOUSTICAL INSULATION.
 - 2x4 STUDS @ 16" O.C. w/ 3/4" PTD MR GWB, EACH FACE OF STUDS & ACOUSTICAL INSULATION.

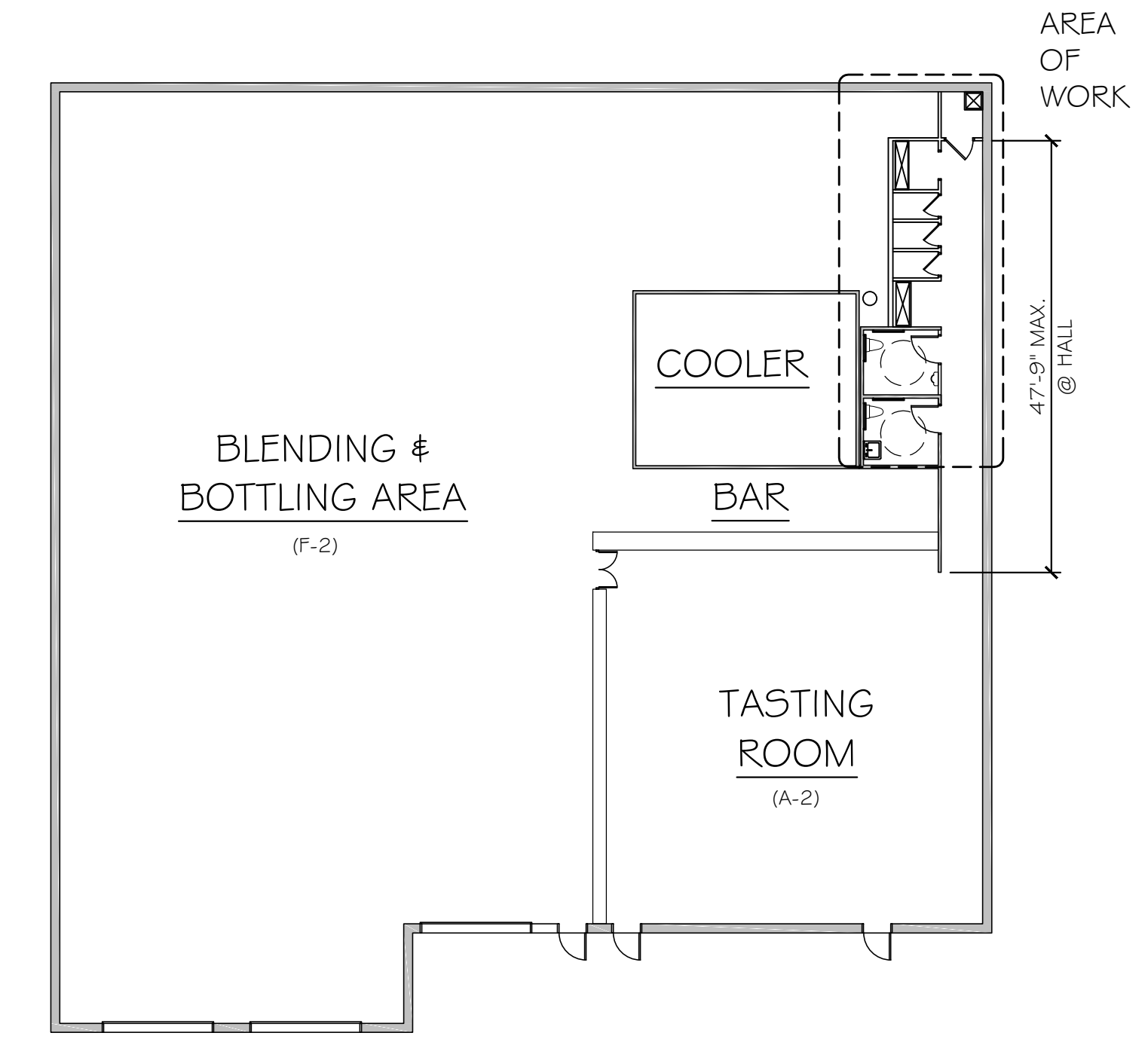

WALL TYPES

	EXISTING WALL
	DEMOLITION
	NEW PARTITION