

CONG TU BOT - RESTAURANT FIT-UP

59 WASHINGTON AVENUE
PORTLAND, MAINE

PERMIT DRAWINGS

OCTOBER 17, 2016

| DRAWING LIST | |
|----------------------|---|
| SHEET NUMBER | |
| G0-0 | TITLE SHEET |
| G1-0 | GENERAL NOTES, ABBREVIATIONS, AND LEGENDS |
| G1-1 | CODE REVIEW PLAN |
| <u>DEMOLITION</u> | |
| AD1-0 | FIRST FLOOR DEMOLITION PLAN |
| <u>ARCHITECTURAL</u> | |
| A0-1 | WALL ASSEMBLIES |
| A1-0 | FIRST FLOOR PLAN |
| A1-1 | FIRST FLOOR - RCP |
| A1-2 | FIRST FLOOR EQUIPMENT PLAN |
| A4-0 | INTERIOR ELEVATIONS |
| A5-0 | DETAILS |
| A7-0 | DOOR SCHEDULE |

ARCHITECT

RYAN SENATORE **ARCHITECTURE**

565 CONGRESS STREET, SUITE 304, PORTLAND, MAINE 04101
207-650-6414

GENERAL NOTES

- 1. DRAWING NOTES: CONTRACTOR TO FURNISH AND INSTALL ALL NOTED LABOR AND MATERIALS UNLESS OTHERWISE NOTED.
- 2. CODE COMPLIANCE: ALL WORK SHALL CONFORM TO THE LATEST EDITION OF STATE, LOCAL AND OTHER CODES WHICH APPLY TO THIS PROJECT OR HAVE JURISDICTION.
- 3. COORDINATION: IT IS THE RESPONSIBILITY OF THE CONTRACTOR TO COORDINATE ALL DISCIPLINES AND TRADES SO THAT ALL BUILDING SYSTEMS AND COMPONENTS CAN BE ASSEMBLED WITHOUT CONFLICTS. IN THE EVENT THAT THE CONSTRUCTION DOCUMENTS DEFINE CONDITIONS WHICH PROHIBIT, OR MAY PROHIBIT, SUCH ASSEMBLY, THE CONTRACTOR SHALL BRING TO THE ARCHITECT'S ATTENTION, IN WRITING AND IN A TIMELY FASHION, SUCH CONDITION. THE CONTRACTOR SHALL NOT PROCEED WITH RELATED WORK WITHOUT A WRITTEN RESOLUTION CLARIFICATION FROM THE ARCHITECT. THE CONTRACTOR AND HIS/HER SUBCONTRACTORS SHALL BE RESPONSIBLE FOR PROVIDING MATERIALS AND SYSTEMS SHOWN IN THE CONSTRUCTION DOCUMENTS REGARDLESS OF WHERE THE INFORMATION IS LOCATED. WHERE COMPONENTS OF A SYSTEM ARE INDICATED THE CONTRACTOR SHALL BE RESPONSIBLE FOR PROVIDING ALL LABOR AND MATERIALS NECESSARY TO COMPLETE THE SYSTEM.
- 4. DISCREPANCIES & CLARIFICATIONS: THIS PROJECT INVOLVES THE FIT-UP OF AN EXISTING BUILDING. EXISTING DIMENSIONS SHOWN ON THE DRAWINGS ARE BELIEVED TO BE ACCURATE, BUT CANNOT BE GUARANTEED, MEASURE AND VERIFY DIMENSIONS IN FIELD PRIOR TO FABRICATION AND CONSTRUCTION. IT IS THE RESPONSIBILITY OF THE CONTRACTOR TO BRING TO THE ARCHITECT'S ATTENTION, IN WRITING, ANY DISCREPANCIES OR AMBIGUITIES IN THE DRAWINGS AND/OR SPECIFICATIONS. THE CONTRACTOR SHALL NOT PROCEED WITH RELATED WORK WITHOUT A WRITTEN RESOLUTION OR CLARIFICATION FROM THE ARCHITECT.
- 6. LAYOUT: UNLESS INDICATED OTHERWISE, CENTER WALL FRAMING AND PARTITION FRAMING ON COLUMN LINES. FLOOR PLAN DIMENSIONS ARE TO CENTER OF FRAMING, FACE OF CONCRETE, FACE OF CMU, OR FROM COLUMN CENTERLINES, UNLESS INDICATED OTHERWISE. DOORS AND WINDOWS ARE DIMENSIONED TO CENTERLINES UNLESS INDICATED OTHERWISE.
- 6. CENTERING: UNLESS INDICATED OTHERWISE, CENTER BUILDING ELEMENTS WITHIN OR BETWEEN OTHER BUILDING ELEMENTS WHEN CONDITIONS OR THE DRAWINGS INDICATE OR IMPLY THAT SUCH IS THE INTENT, WHETHER OR NOT DIMENSIONS ARE INCLUDED.
- 7. SYMMETRY: WHERE CONDITIONS OR THE DRAWINGS INDICATE OR IMPLY THAT SYMMETRY IS INTENDED, INFORMATION PROVIDED AT ONE SIDE APPLIES EQUALLY TO BOTH SIDES, UNLESS CONDITIONS CLEARLY PRECLUDE SUCH APPLICATION.
- 8. ACCESSIBILITY: ALL HANDICAPPED ACCESSIBLE BATHROOMS, GRAB BARS, AND DOOR OPENINGS SHALL MEET THE REQUIREMENTS OF TITLE 94-348, CHAPTER 5 OF THE MAINE HUMAN RIGHTS COMMISSION TITLE LATEST EDITION & THE DEPARTMENT OF JUSTICE ADA STANDARDS FOR ACCESSIBLE DESIGN.
- 9. DRAWING SCALES: WORK FROM THE GIVEN DIMENSIONS ONLY. SCALE IS INDICATED ON THE DRAWINGS FOR CONVENIENCE ONLY. IT IS NOT INTENDED THAT INFORMATION BE DETERMINED BY SCALES ON DRAWINGS SINCE SOME ITEMS MAY NOT BE TO SCALE.
- 10. WATER-RESISTANT GWB: INSTALL WATER-RESISTANT GYPSUM WALL BOARD IN ALL REST ROOMS & TOILET ROOMS OR AT ANY WALL WITH PLUMBING FIXTURES.
- 10A: HIGH IMPACT GWB: INSTALL HIGH IMPACT GYPSUM WALL BOARD IN ALL STAIRWELLS
- 11. INTERIOR ELEVATIONS: INTERIOR ELEVATIONS MAY BE REVERSED FROM AND/OR SIMILAR TO ACTUAL CONDITIONS. SEE FLOOR PLANS FOR WINDOW AND DOOR QUANTITIES AND LOCATIONS, FOR CASEWORK LAYOUTS, AND FOR MONITOR LOCATIONS.
- 12. BUILDING INSULATION: PROVIDE AS INDICATED IN WALL SECTIONS AND IN ACCORDANCE WITH PARTITION TYPES, WHETHER OR NOT SHOWN IN DETAILS AND OTHER DRAWINGS. FOR CLARITY, INSULATION MAY NOT BE SHOWN IN SOME CASES, EVEN IF IT IS TO BE PROVIDED.
- 13. BLOCKING: INSTALL BLOCKING BEHIND ALL SURFACE-APPLIED FIXTURES, TRIM, CASEWORK, SHELVES, BRACKETS, TOILET ACCESSORIES, CHAIR RAILS, PICTURE RAILS, GRAB BARS, BASE MOLDINGS, AND AS OTHERWISE REQUIRED, WHEN SUCH ITEMS ARE APPLIED ON STUD WALLS.
- 14. PENETRATIONS AT STRUCTURAL MEMBERS: BEFORE PENETRATING JOISTS, BEAMS OR OTHER STRUCTURAL MEMBERS, CONSULT WITH THE ARCHITECT.
- 15. DAMAGED WORK: BUILDING OR SITE COMPONENTS WHICH ARE AFFECTED BY NEW WORK, DEMOLITION, OR WHICH MAY BE DAMAGED BY THE GENERAL CONTRACTOR OR ANY SUB-CONTRACTOR SHALL BE REPLACED OR RESTORED TO ORIGINAL CONDITION AND COLOR TO MEET THE APPROVAL OF THE ARCHITECT.
- 16. UTILITIES: VERIFY THE SIZE AND LOCATION OF ALL UNDERGROUND UTILITIES AND REPORT ANY DISCREPANCIES TO THE ARCHITECT IN WRITING. DO NOT PROCEED WITH WORK UNTIL THE DISCREPANCY HAS BEEN RESOLVED TO THE SATISFACTION OF THE ARCHITECT.
- 17. RATED CONSTRUCTION: PROVIDE RATED CONSTRUCTION AS REQUIRED BY CODE, AS SPECIFIED, AND AS INDICATED ON DRAWINGS. IT IS THE RESPONSIBILITY OF THE CONTRACTOR TO PROVIDE AND INSTALL ALL COMPONENTS REQUIRED TO CREATE SUCH RATED CONSTRUCTION, REGARDLESS OF WHETHER OR NOT SUCH COMPONENTS ARE INDICATED. PROVIDE CONTINUITY OF SUCH RATED CONSTRUCTION AROUND AND BETWEEN SPACES, INCLUDING AT CHASES AND AT FLOORS, TO MAINTAIN COMPLETE SEPARATIONS, EVEN IF NOT SPECIFICALLY INDICATED.
- 18. SHOP DRAWINGS: SUBMIT SHOP DRAWINGS TO THE ARCHITECT FOR REVIEW PRIOR TO FABRICATION. SUBMITTALS REQUIRED INCLUDE, BUT ARE NOT LIMITED TO, SHOP DRAWINGS FOR ALL PREFABRICATED CONCRETE, STEEL, MILLWORK & SIGNAGE, SAMPLES OF ALL PROPOSED PAINTS, METALS, WALL COVERINGS, LAMINATES, S&D SURFACE MATERIALS, CERAMIC TILE, AND HARDWARE. SUBMIT MANUFACTURER'S DATA FOR ALL LIGHTING SYSTEMS, AND HARDWARE.
- 19. PERMITS: THE GENERAL CONTRACTOR SHALL OBTAIN AND PAY FOR ANY BUILDING PERMITS REQUIRED AND CARRY ANY INSURANCE COVERAGES REQUIRED.
- 20. INTERIOR FINISHES: ALL INTERIOR FINISHES AND FURNISHINGS ARE TO BE CLASS 'A' FIRE-RATED AND ARE TO COMPLY WITH SECTION 902.0 BOCA (INTERIOR FLAME SPREAD).
- 21. ELECTRICAL DESIGN: REFER TO ELECTRICAL DRAWINGS AND SPECIFICATIONS
- 22. WASTE REMOVAL: THE GENERAL CONTRACTOR SHALL DISPOSE OF ALL WASTE AND DEBRIS OFF THE PREMISES.
- 23. LANDLORD COORDINATION: THE GENERAL CONTRACTOR MUST COORDINATE WITH THE BUILDING OWNER ALL ACTIVITIES INCLUDING BUT NOT LIMITED TO WORK WHICH WILL GENERATE EXCESSIVE NOISE AND MODIFICATION TO UTILITIES. WORK MUST NOT INTERFERE WITH EXISTING SMOKE DETECTORS, ALARMS OR BUILDING SYSTEM MANAGEMENT.
- 24. TEMPORARY FACILITIES: PROVIDE ALL TEMPORARY FACILITIES AND SERVICES, CONSTRUCTION AND SUPPORT FACILITIES, AND SECURITY AND PROTECTION AS NEEDED TO PROTECT NEW AND EXISTING CONSTRUCTION FOR THE DURATION OF A COMPLETE INSTALLATION.
- 25. FINAL CLEANING: EMPLOY EXPERIENCED WORKERS FOR FINAL CLEANING. CLEAN EACH SURFACE TO THE CONDITION EXPECTED IN A COMMERCIAL BUILDING CLEANING PROGRAM.
- 26. MANUFACTURER'S INSTRUCTIONS: ALL MATERIALS & EQUIPMENT SHALL BE INSTALLED ACCORDING TO MANUFACTURER'S SPECIFICATIONS.
- 27. GUARANTEE: ALL MATERIALS AND WORKMANSHIP SHALL BE GUARANTEED FOR A PERIOD OF ONE YEAR FROM THE DATE OF FINAL ACCEPTANCE UNLESS OTHERWISE SPECIFIED FOR A LONGER PERIOD OF TIME ON A CERTAIN ITEM.
- 28. ASBESTOS: ALL MATERIAL USED FOR THE CONSTRUCTION OF THIS PROJECT, WHETHER BUILDING MATERIALS OR APPURTENANCES, SHALL BE NON-ASBESTOS CONTAINING MATERIAL.
- 29. HAZARDOUS FUMES: THE GENERAL CONTRACTOR SHALL CONFIRM THAT ALL MATERIAL AND FINISHES SPECIFIED AND THEIR FABRICATION OR INSTALLATION WILL NOT RELEASE FUMES OR AROMAS DURING CONSTRUCTION WHICH MAY BE A HAZARD OR NUISANCE TO PERSONNEL.
- 30. PEST CONTROL: SEAL AND CAULK AROUND ALL PENETRATIONS, CRACKS AND CREVICES AND ANY OPENINGS CAPABLE OF HARBORING INSECTS/RODENTS.
- 31. EXPOSED UTILITIES: ALL EXPOSED UTILITY WIRES AND PIPES (ELECTRICAL, PLUMBING, ETC.) SHALL BE INSTALLED IN A WAY THAT DOES NOT OBSTRUCT OR PREVENT THE CLEANING OF FLOORS, WALLS, AND CEILING AREAS. THEY SHALL BE INSTALLED A MINIMUM OF 6" FROM FLOORS AND 1' OFF WALLS, CEILINGS AND ADJACENT PIPES.
- 32. OWNER SUPPLIED EQUIPMENT: EQUIPMENT SUPPLIED BY THE OWNER AND INSTALLED BY THE GENERAL CONTRACTOR: EQUIPMENT INFORMATION AND SPECIFICATIONS ARE TO BE THE MOST CURRENT AVAILABLE AT THE TIME OF DOCUMENTATION PREPARATION. THE GENERAL CONTRACTOR SHALL BE RESPONSIBLE FOR VERIFYING WITH THE OWNER THE EXACT DIMENSIONS AND EQUIPMENT CONNECTION REQUIREMENTS (INCLUDING ELECTRICAL CIRCUIT REQUIREMENTS) OF EQUIPMENT TO BE SUPPLIED. THE GENERAL CONTRACTOR SHALL MAKE ALL FINAL CONNECTIONS AS NOTED ON THE DRAWINGS, INSTALL THE SET UP IN WORKING ORDER, CHECK WARRANTIES, TEST AND NOT VOID WARRANTIES. THE GENERAL CONTRACTOR SHALL COORDINATE WITH THE OWNER DELIVERY, STORAGE AND INSTALLATION OF ALL OWNER SUPPLIED EQUIPMENT. THE GENERAL CONTRACTOR SHALL STORE EQUIPMENT IF REQUESTED BY THE OWNER UNTIL INSTALLATION. SEE DRAWINGS FOR OTHER OWNER SUPPLIED GENERAL CONTRACTOR INSTALLED ITEMS.
- 33. FIRE PROTECTION NOTE: EXISTING SPRINKLERHEADS, ALARM SYSTEM AND DETECTORS ARE TO BE MODIFIED TO CONFORM WITH THE PROPOSED PLAN. COORDINATE WITH THE ARCHITECT, ANY MODIFICATION OR LOCATIONS WHERE EXISTING SYSTEMS ARE AFFECTED BY THE NEW DESIGN.
- 34. SOILS AT FOOTINGS: REPORT THE LOCATION OF ALL UNSUITABLE SOILS AND MATERIALS BELOW ANTICIPATED LEVEL OF FOOTING TO THE ARCHITECT PRIOR TO THE SETTING OF FORMS.
- 35. ACCESS PANELS: CONTRACTOR IS RESPONSIBLE FOR COORDINATING QUANTITY AND LOCATION OF ALL REQUIRED ACCESS PANELS FOR ALL MEP CONTROLS, CLEANOUTS, DAMPERS, PULL BOXES, ETC.
- 36. EXISTING HAZARDOUS MATERIALS: ALL HAZARDOUS MATERIALS INCLUDING BUT NOT LIMITED TO ASBESTOS AND LEAD PAINT ARE TO BE HANDLED, ENCAPSULATED, ABATED AND DISPOSED OF IN ACCORDANCE WITH ANY AND ALL FEDERAL, STATE AND LOCAL REQUIREMENTS AND REGULATIONS.
- 37. INDUSTRY STANDARDS: ALL WORK SHALL BE PERFORMED IN ACCORDANCE WITH INDUSTRY STANDARDS. STANDARDS INCLUDE BUT ARE NOT LIMITED TO THE FOLLOWING:
A.A.M.A. AMERICAN ARCHITECTURAL MANUFACTURERS ASSOCIATION
ACI AMERICAN CONCRETE INSTITUTE
ANSI AMERICAN NATIONAL STANDARDS INSTITUTE
ASTM AMERICAN SOCIETY FOR TESTING AND MATERIALS
AWI ARCHITECTURAL WOODWORK INSTITUTE
"CUSTOM GRADE"
AWS AMERICAN WELDING SOCIETY
IGCA INSULATING GLASS MANUFACTURERS ALLIANCE
NAAMM NATIONAL ASSOCIATION OF ARCHITECTURAL METAL MANUFACTURERS
NRC NATIONAL ROOFING CONTRACTORS ASSOCIATION
NTCA NATIONAL TILE CONTRACTORS ASSOCIATION
SMACNA SHEET METAL AND AIR CONDITIONING NATIONAL ASSOCIATION
WDMA WINDOW AND DOOR MANUFACTURERS ASSOCIATION

ABBREVIATIONS

| | | | | |
|----------|--------------------------------------|-------|--|------------|
| AC | AIR CONDITIONING | L | LAB | LABORATORY |
| ACT | ACTUAL | LA | LAMINATED | |
| AD | AREA DRAIN | LB | LEAD | |
| ADAA | ACCESSIBILITY WITH DISABILITIES ACT | LC | LEFT HAND | |
| ADAA | ACCESSIBILITY WITH DISABILITIES ACT | LCC | LEAD COATED COPPER | |
| ADD | ADDENDUM | M | MACHINERY | |
| AF | ABOVE FINISHED FLOOR | MACH | MASONRY | |
| AHU | AIR HANDLING UNIT | MATL | MATERIAL | |
| AL | ALUMINUM | MEXH | MEDIUM DENSITY OVERLAY | |
| ARCH | ARCHITECT/ARCHITECTURAL | MESH | MESH | |
| AWP | ACOUSTIC WALL PANEL | MEHB | METAL | |
| B | BACK-TO-BACK ANGLES | MEZ | MEZZANINE | |
| B TO BLS | BASE BUILDING GENERAL CONTRACTOR | MFG | MANUFACTURER | |
| B.G.C. | BUILDING LINE | MIN | MINIMUM | |
| BL | BLOCKING | MIS | MISCELLANEOUS | |
| BLS | BUILDING LINE | MO | MASSIVE OPENING | |
| BSMT | BASEMENT | MTD | MAINTAINED | |
| BTWN | BETWEEN | MTL | METAL | |
| BO | BY OTHERS | MB | MARKER BOARD | |
| C | COURSE (MASONRY) | N | NORTH | |
| CER | CERAMIC | N# | NUMBER | |
| CG | CORNER GUARD | NC | NOT IN CONTACT | |
| CHK | CHECK | NOM | NOMINAL DIMENSION | |
| CJ | CONTROL JOINT | NST | NOT TO SCALE | |
| CL | CEILING LINE | O | ON CENTER | |
| CLG | CONCRETE MASONRY UNIT | OC | OUTSIDE DIAMETER/OUTSIDE DIMENSION | |
| CMU | CONCRETE MASONRY UNIT | OFF | OFFICE | |
| CO | COLUMN | OPB | OPPOSITE | |
| COL | COLUMN | OPPH | OPPOSITE HAND | |
| COND | CONDITION | OZ | OUNCE | |
| CONN | CONNECT/CONNECTION | P | PURCHASED BY OWNER INSTALLED BY CONTRACTOR | |
| CONST | CONSTRUCTION | PC | PRE-CAST | |
| CONT | CONTINUOUS | PLAM | PLASTIC LAMINATE | |
| CORR | CERAMIC TILE | PBR | PREFABRICATE | |
| CUH | CABINET UNIT HEATER | PRIV | PRIVACY | |
| D | DOUBLE | PRIM | PRIMED | |
| DBL | DOUBLE | PSF | POUNDS PER SQUARE FOOT | |
| DF | DRINKING FOUNTAIN | PSI | POUNDS PER SQUARE INCH | |
| DI | DIAMETER | PTD | PAINTED | |
| DIFF | DIFFUSER | PIN | PARTITION | |
| DIR | DIRECTION | PVC | POLYVINYL CHLORIDE | |
| DN | DOWN | PWD | PLYWOOD | |
| DRS | DRY | PT | PRESURE TREATED | |
| DSP | DRY STAND PIPE | PERF | PERFORATED | |
| DWG | DRAWING | Q | QUARRY TILE | |
| E | EAST | QTR | QUARTER | |
| EA | EACH | R | RISER/RADIUS | |
| ELEV | ELEVATION | RD | RUBBER | |
| ELEC | ELECTRICAL | RCP | REFLECTED CEILING PLAN | |
| ELEV | ELEVATION | RD | RUBBER | |
| ENTR | ENTRANCE | REBAR | REINFORCING BAR | |
| EQ | EQUAL | REIN | REINFORCED | |
| EQUIP | EQUIPMENT | REQ | REQUIRED | |
| EXP | EXPANSION | REV | REVERSE | |
| EXPJ | EXPANSION JOINT | RGA | ROUGH OPENING | |
| EXPJ | EXPANSION JOINT | RO | ROUGH OPENING | |
| EXTN | EXTENSION | ROW | RIGHT OF WAY | |
| EW | ETHYLENE PROPYLENE DIENE MONOMER | S | SOUTH | |
| EWC | ELECTRIC WATER COOLER | SCHED | SCHEDULE | |
| F | FAHRENHEIT | SFT | SQUARE FEET | |
| FB | FLAT BAR | SIM | SIMILAR | |
| FD | FLOOR DRAIN | SPEC | SPECIFICATION | |
| FE | FIRE EXTINGUISHER | SQU | SQUARE | |
| FG | FIRE EXTINGUISHER CABINET | SST | STAINLESS STEEL | |
| FTWD | FIRE TREATED WOOD | STD | STANDARD | |
| FL | FLOOR | STL | STEEL | |
| FOB | FACE OF BRICK | STR | STRUCTURE | |
| FSC | FACE OF CONCRETE | SUSP | SUSPENSION | |
| FOS | FACE OF FINISH | T&G | TONGUE/GROOVE | |
| FS | FACE OF STUDS | TEL | TELEPHONE | |
| FSS | FACE OF WALL | THK | THICK | |
| FT | FIRE SUPPRESSION SYSTEM | TOD | TOP OF DECK | |
| FTG | FOOTING | TOS | TOP OF STEEL | |
| FRG | FIBER REINFORCED GYPSUM | TYP | TYPICAL | |
| FTR | FINE TUBE RADIATION | TB | TACK BOARD | |
| FH | FUME HOOD | TOC | TOP OF CONCRETE | |
| G | GAUGE | U | UNDERWRITERS LABORATORIES, INC. | |
| GALV | GALVANIZED | UL | UNIT VENTILATOR | |
| GC | GENERAL CONTRACTOR | V | VINYL COMPOSITION TILE | |
| GH | GROUND-FALL INTERRUPTER | VERT | VERTICAL | |
| GLAM | GLUE-LAMINATED WOOD | VHF | VERTICAL FIELD | |
| GND | GROUND | VOL | VOLUME | |
| GWB | GYPSUM WALL BOARD | W | WEST | |
| H | HOSE BIB | WO | WITHOUT | |
| HC | HANDICAP | W | WOOD | |
| HU | HOLLOW METAL | WF | WOOD FLANGE | |
| HORIZ | HORIZONTAL | WF | WOOD FLANGE | |
| HP | HORSE POWER/HIGH POINT HEAT PUMP | WP | WORK POINT | |
| HV | HOT WATER | WT | WEIGHT | |
| HVAC | HEATING VENTILATION AIR CONDITIONING | | | |
| I | INSIDE DIMENSION/INSIDE DIAMETER | | | |
| IN | INCHES | | | |
| INFO | INFORMATION | | | |
| INSUL | INSULATION | | | |
| J | JOIST | | | |
| JT | JOINT | | | |
| K | KILN-DRIED | | | |
| KD | 1000 POUNDS | | | |

DRAWING LEGEND

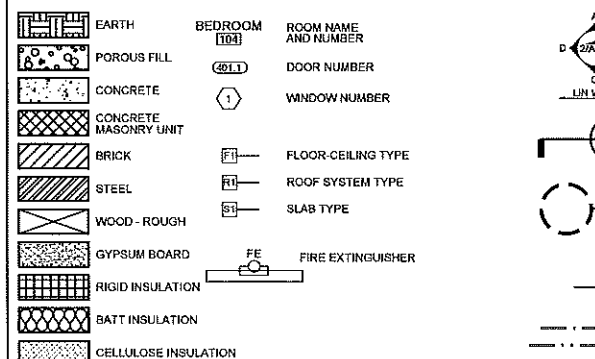

FIRESTOPPING DETAILS

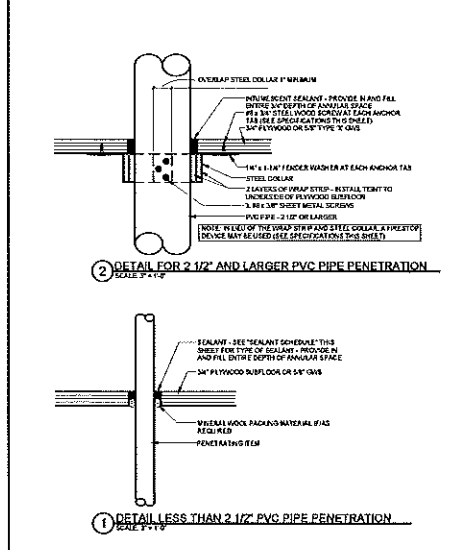

SPECIFICATIONS

WRAP STRIP: 1/4" THICK x 1 1/2" MINIMUM WIDTH INTUMESCENT MATERIAL WITH PLASTIC FILM FACING BOTH SIDES. TEMPORARILY SECURE WITH MAXIMUM TAPE. SPECIFIED TECHNOLOGIES INC. (STI) "SpecSeal RED Wrap Strip" OR "SpecSeal BLU Wrap Strip" OR EQUAL.

STEEL COLLAR: WRAP STRIP MANUFACTURER'S STEEL COLLAR, FABRICATED FROM 016 INCH THICK GALVANIZED SHEET STEEL, WIDTH TO MATCH WRAP STRIP (1 1/2" MINIMUM), WITH 1 INCH x 2 INCH ANCHOR TABS AND RETAINER TABS. ANCHOR TABS TO BE SYMMETRICALLY OPPOSED AROUND COLLAR, PROVIDE 3 TABS FOR 2 1/2" AND 3" PIPE; PROVIDE 4 TABS FOR 4" PIPE.

INTUMESCENT SEALANT: ONE-PART, INTUMESCENT, LATEX ELASTOMER TESTED TO ASTM E 814, MINIMUM EXPANSION OF 3x AT 1000°F. 3/4" FIRE BARRIER SEALANT CP 25WB" OR EQUAL.

FIRESTOP SEALANT: SINGLE COMPONENT NONCOMBUSTIBLE FIRE RATED SEALANT TESTED TO ASTM E 814, TESTED TO 3000°F. "BOSS 136 FIRESTOP/DRAFT SEALANT" MANUFACTURED BY ACCUMETRIC, LLC, OR EQUAL.

SEALANT SCHEDULE:

INTUMESCENT SEALANT: PROVIDE AT ALL PENETRATIONS THROUGH RATED CONSTRUCTION FOR PENETRATING ITEMS INCLUDING BUT NOT LIMITED TO: PVC PIPE; ROOF LEADER PIPES; GAS PIPES & LINES; SPRINKLER PIPES; ELECTRICAL & COMMUNICATIONS CABLES & WIRES; AND ALARM SYSTEM WIRES. DO NOT USE INTUMESCENT SEALANT AT DOMESTIC HOT WATER OR HYDRONIC HEATING SYSTEM PIPES.

FIRESTOP SEALANT: PROVIDE AT ALL PENETRATIONS THROUGH RATED CONSTRUCTION FOR PENETRATING ITEMS INCLUDING DOMESTIC HOT AND COLD WATER PIPES AND HYDRONIC HEATING SYSTEM PIPES.

NOTE: FOR LOCATIONS OF RATED CONSTRUCTION, SEE ARCHITECTURAL FLOOR PLANS AND SECTIONS

WALL AND PARTITION NOTES

- GENERAL PARTITION NOTES:
- 1) INSTALL WATER-RESISTANT GYPSUM WALL BOARD IN ALL RESTROOMS AND TOILET ROOMS WALLS AND CEILINGS, AND AT ANY WALL WITH PLUMBING FIXTURES.
- 2) ALL PARTITION TYPES WITH AN INSULATION COMPONENT TO BE ACOUSTICALLY SEALED.
- 3) PENETRATIONS THROUGH RATED WALLS AND CEILING ASSEMBLIES SHALL HAVE SEALANTS CONFORMING TO RATING REQUIREMENTS.
- 4) HOLD BOTTOM EDGE OF GWB 1/2" UP FROM CONCRETE TYPICAL.
- 5) PATCH EXISTING WALLS AS REQUIRED IF POSSIBLE (IF DAMAGE IS EXTENSIVE SEE NOTE 10)
- 6) RUN NEW 5/8" GWB OVER DAMAGED EXISTING WALL COVERING IF NECESSARY



© 2016 RYAN SENATORE ARCHITECTURE

CONG TU BOT - RESTAURANT FIT-UP
59 WASHINGTON AVENUE
PORTLAND, MAINE



CONSULTANTS:

REVISIONS:

| | |
|-------------|------------------|
| DATE: | 17, OCTOBER 2016 |
| PROJECT No. | 1643 |
| DRAWN BY: | JPF, RJS |
| CHECKED BY: | RJS |
| SCALE: | AS NOTED |

SHEET TITLE:
GENERAL NOTES, ABBREVIATIONS, AND LEGENDS

G1-0

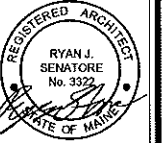

© 2016 RYAN SENATORE ARCHITECTURE

CONG TU BOT - RESTAURANT FIT-UP
59 WASHINGTON AVENUE
PORTLAND, MAINE



RYAN SENATORE ARCHITECTURE
665 CONGRESS STREET
PORTLAND, MAINE 04101
207.650.6414
senatorearchitecture.com

CONSULTANTS:

REVISIONS:

DATE: 17, OCTOBER 2016

PROJECT No. 1643

DRAWN BY: JPF, RJS

CHECKED BY: RJS

SCALE: AS NOTED

SHEET TITLE:
CODE REVIEW PLAN

G1-1

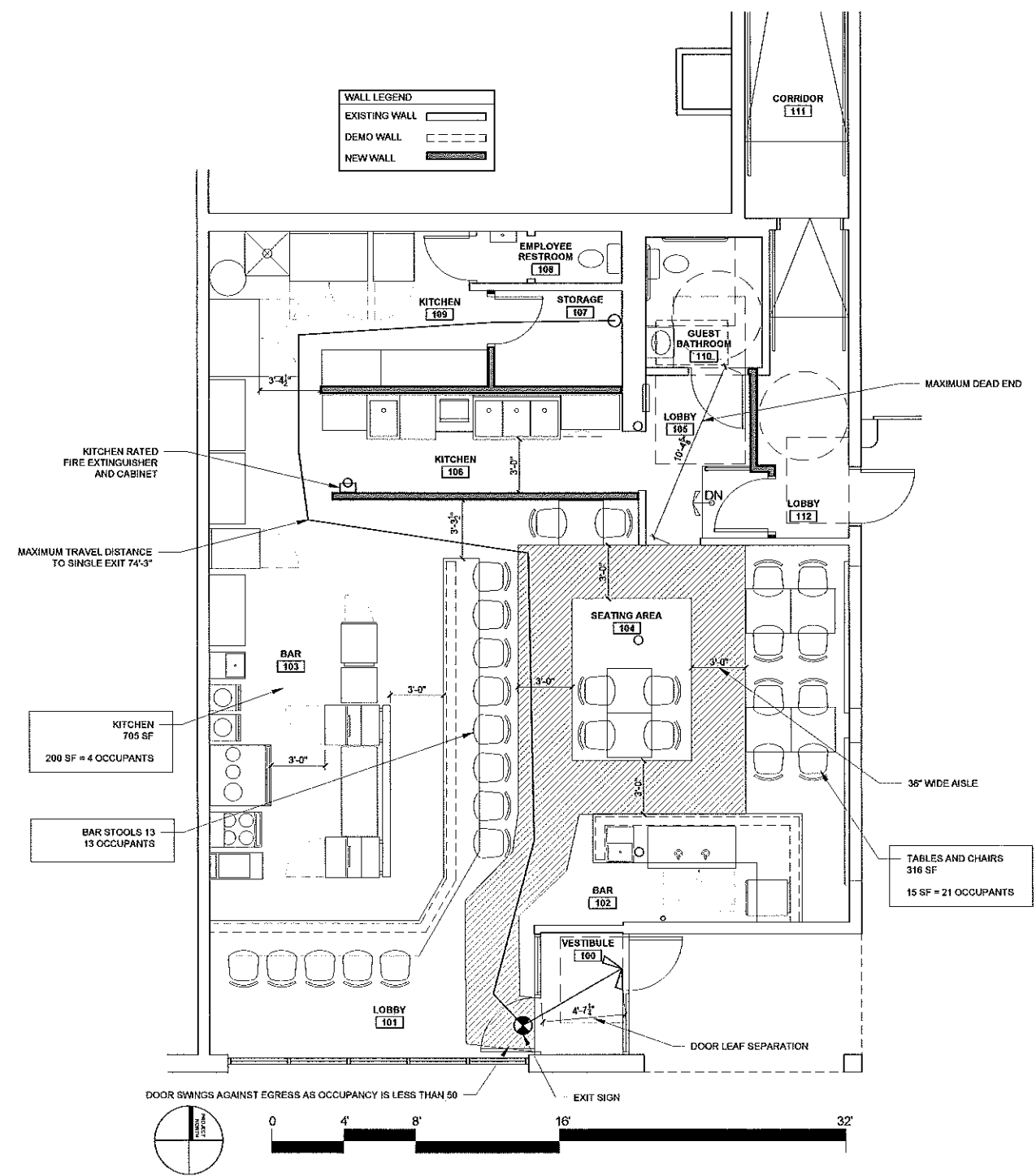

1 CODE REVIEW PLAN
1/8" = 1'-0"

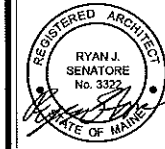

© 2016 RYAN SENATORE ARCHITECTURE

CONG TU BOT - RESTAURANT FIT-UP
59 WASHINGTON AVENUE
PORTLAND, MAINE



RYAN SENATORE
ARCHITECTURE
595 CONGRESS STREET
PORTLAND, MAINE 04101
207-650-6414
senatore@blocklab.com

CONSULTANTS:

REVISIONS:

DATE: 17, OCTOBER 2016

PROJECT No. 1943

DRAWN BY: JPF, RJS

CHECKED BY: RJS

SCALE: AS NOTED

SHEET TITLE:
FIRS FLOOR
DEMOLITION
PLAN

AD1-0

DEMO LEGEND

- R-F REMOVE FLOORING
- R-C REMOVE CEILING

DEMOLITION NOTES

- 1.) ALL HAZARDOUS MATERIALS TO BE REMOVED AND DISPOSED OF IN ACCORDANCE WITH ALL FEDERAL, STATE AND LOCAL REGULATIONS.
- 2.) IF ANY ELEMENTS TO BE REMOVED ARE FOUND TO BE STRUCTURAL, THE G.C. SHALL NOTIFY THE ARCHITECT IN WRITING PRIOR TO REMOVING SUCH ELEMENTS
- 3.) REMOVE ALL UNUSED PLUMBING, ELECTRICAL, AND MECHANICAL ELEMENTS THAT ARE NOT PROPOSED TO BE REUSED
- 4.) AT LOCATIONS OF FLOORING INDICATED TO BE REMOVED REMOVE ALL LAYERS OF FINISHED FLOORING UNDERLAYMENT AND ADHESIVES DOWN TO SLAB OR SHEATHING
- 5.) AT LOCATIONS OF CEILINGS INDICATED TO BE REMOVED REMOVE ALL CEILINGS, TILES, GRIDS, AND STRAPPING TO JOISTS OR FRAMING AS WELL AS ANY IN CEILING ELEMENTS NOT SCHEDULE TO BE REUSED
- 6.) RELOCATE AND REINSTALL ANY AND ALL FUNCTIONING MECHANICAL, ELECTRICAL AND PLUMBING ELEMENTS LOCATED IN WALLS, FLOORS AND CEILINGS INDICATED TO BE REMOVED
- 7.) REMOVE ALL WALL COVERINGS ON WALLS INDICATED TO BE REMOVED, REPAINTED OR RE COVERED
- 8.) PATCH AND REPAIR ALL WALLS CEILINGS AND FLOORS AT LOCATIONS OF REMOVED INTERSECTING WALLS, REMOVED BUILT-INS, ETC.
- 9.) G.C. TO CONFIRM WITH STRUCTURAL ENGINEER BEFORE CUTTING SLAB.
- 10.) G.G. TO VERIFY EXISTING PLUMBING PIPE DEPTHS TO ENSURE NEW DRAIN LINE FROM BAR HAS ADEQUATE PITCH, PRIOR TO WORK.

WALL LEGEND

EXISTING WALL

DEMO WALL

NEW WALL

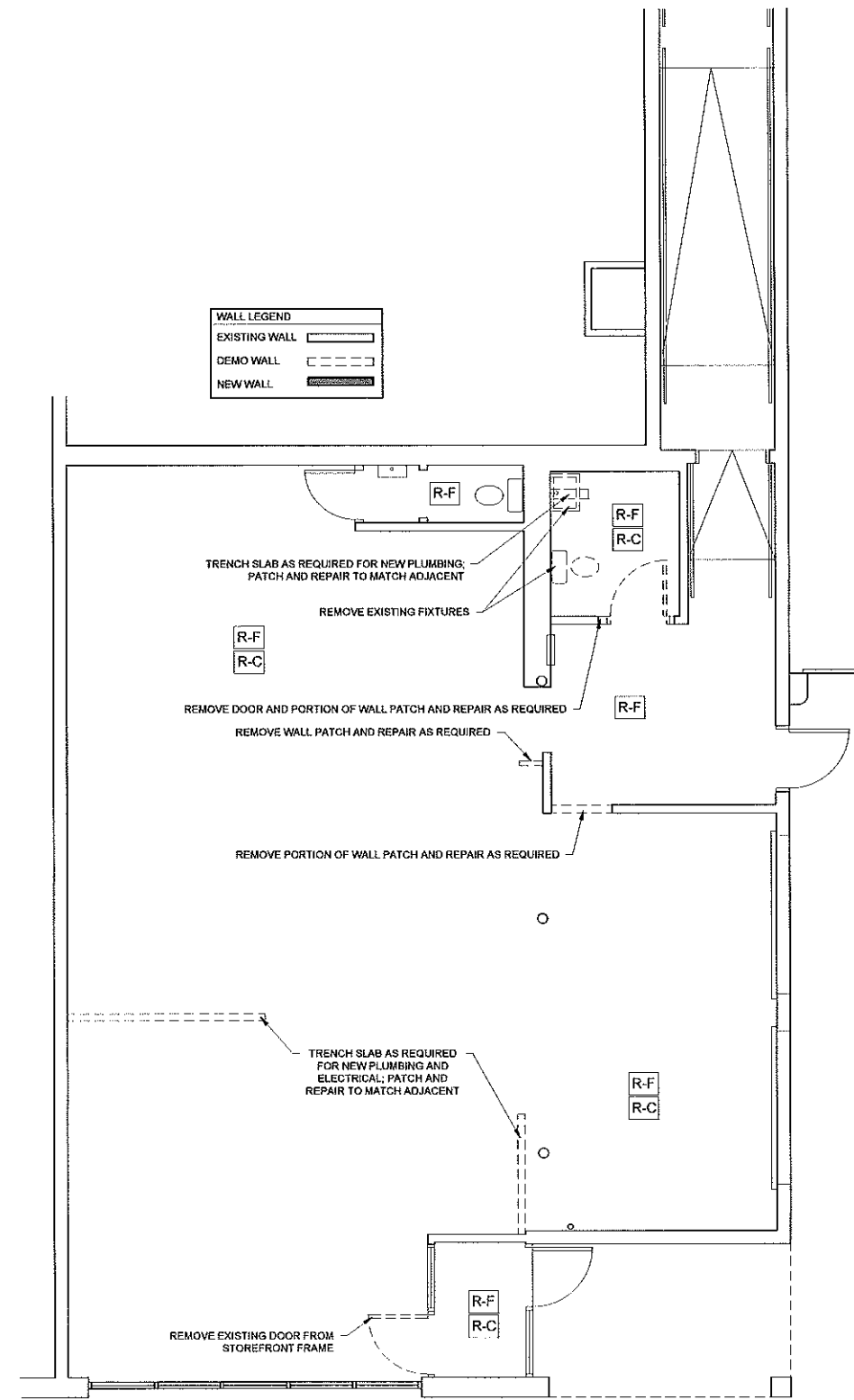

1 FIRST FLOOR DEMOLITION PLAN
1/4" = 1'-0"



© 2016 RYAN SENATORE ARCHITECTURE

CONG TU BOT - RESTAURANT FIT-UP
 59 WASHINGTON AVENUE
 PORTLAND, MAINE



RYAN SENATORE
ARCHITECTURE
 565 CONGRESS STREET
 PORTLAND, MAINE 04101
 207.659.6414
 senatore@rsaarchitecture.com

CONSULTANTS:

REVISIONS:

DATE: 17, OCTOBER 2016

PROJECT No. 1843

DRAWN BY: JPF, RJS

CHECKED BY: RJS

SCALE: AS NOTED

SHEET TITLE:
WALL ASSEMBLIES

A0-1

| GRAPHIC DEPICTION | | DESCRIPTION | | | |
|-------------------|-------------|--|------------|------------|--|
| | | - LAYER OF 5/8" GWB - 3 5/8" LIGHT GAUGE METAL STUDS AT 16" O.C. - LAYER OF 5/8" GWB | | | |
| TYPE | FIRE RATING | UL NUMBER | STC RATING | IIC RATING | |
| NB | N/A | N/A | | N/A | |

| GRAPHIC DEPICTION | | DESCRIPTION | | | |
|-------------------|-------------|--|------------|------------|--|
| | | - LAYER OF TYPE 'X' 5/8" GWB - 3 5/8" LIGHT GAUGE METAL STUDS AT 24" O.C. - 3 1/2" SOUND BATT INSULATION - LAYER OF TYPE 'X' 5/8" GWB | | | |
| TYPE | FIRE RATING | UL NUMBER | STC RATING | IIC RATING | |
| 1A | 1 HR | V450 | 50-54 | N/A | |

| GRAPHIC DEPICTION | | DESCRIPTION | | | |
|-------------------|-------------|--|------------|------------|--|
| | | - LAYER OF 5/8" GWB - 3 5/8" LIGHT GAUGE METAL STUDS AT 16" O.C. - 3 1/2" SOUND BATT INSULATION - LAYER OF 5/8" GWB | | | |
| TYPE | FIRE RATING | UL NUMBER | STC RATING | IIC RATING | |
| NA | N/A | N/A | | N/A | |

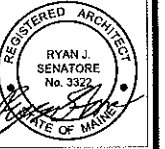

© 2016 RYAN SENATORE ARCHITECTURE

CONG TU BOT - RESTAURANT FIT-UP
59 WASHINGTON AVENUE
PORTLAND, MAINE



RYAN SENATORE
ARCHITECTURE
565 CONGRESS STREET
PORTLAND, MAINE 04101
207-850-8414
senatore@rsa-architecture.com

CONSULTANTS:

REVISIONS:

DATE: 17, OCTOBER 2016

PROJECT No. 1643

DRAWN BY: JPF, RJS

CHECKED BY: RJS

SCALE: AS NOTED

SHEET TITLE:
FIRST FLOOR PLAN

A1-0

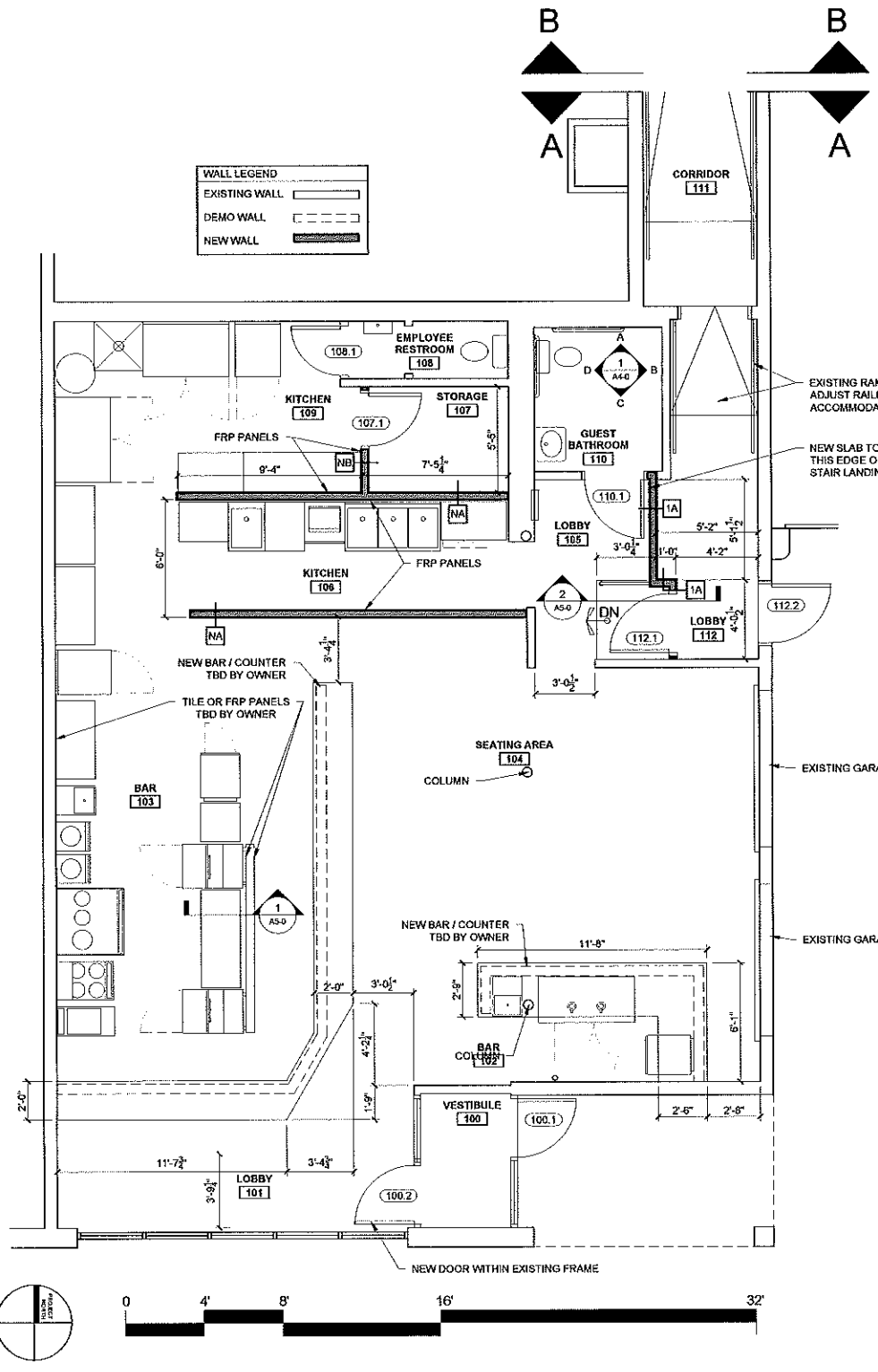
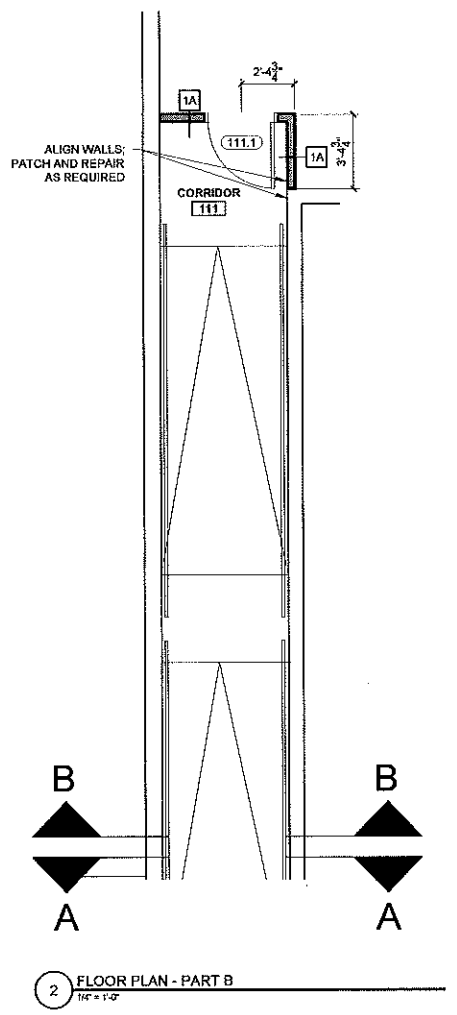

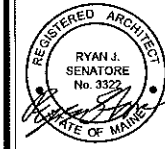

© 2016 RYAN SENATORE ARCHITECTURE

CONG TU BOT - RESTAURANT FIT-UP
 59 WASHINGTON AVENUE
 PORTLAND, MAINE



RYAN SENATORE
 ARCHITECTURE
 555 CONGRESS STREET
 PORTLAND, MAINE 04101
 207-650-6414
 senatore@rsaarch.com

CONSULTANTS:

REVISIONS:

DATE: 17, OCTOBER 2018

PROJECT No. 1643

DRAWN BY: JPF, RJS

CHECKED BY: RJS

SCALE: AS NOTED

SHEET TITLE:
FIRST FLOOR REFLECTED CEILING PLAN

A1-1

- RCP NOTES**
- 1) LIGHTS NOT SHOWN - TBD BY OWNER
 - 2) O.C. TO COORDINATE LOCATIONS OF PLUMBING CLEAN OUTS AND PROVIDE FIRE RATED ACCESS PANELS AT CEILING
 - 3) O.C. TO PROVIDE ACCESS PANELS AS REQUIRED FOR ALL ELEMENTS (SPRINKLER, VALVES, ETC) NOT SHOWN ON THIS REFLECTED CEILING PLAN
 - 4) O.C. TO PROVIDE METAL FRAMING AND BLOCKING REQUIRED FOR ALL ACCESS PANELS AND CONTROL JOINTS

WALL LEGEND

| | |
|---------------|--|
| EXISTING WALL | |
| DEMO WALL | |
| NEW WALL | |

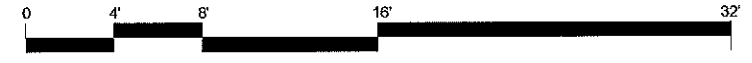
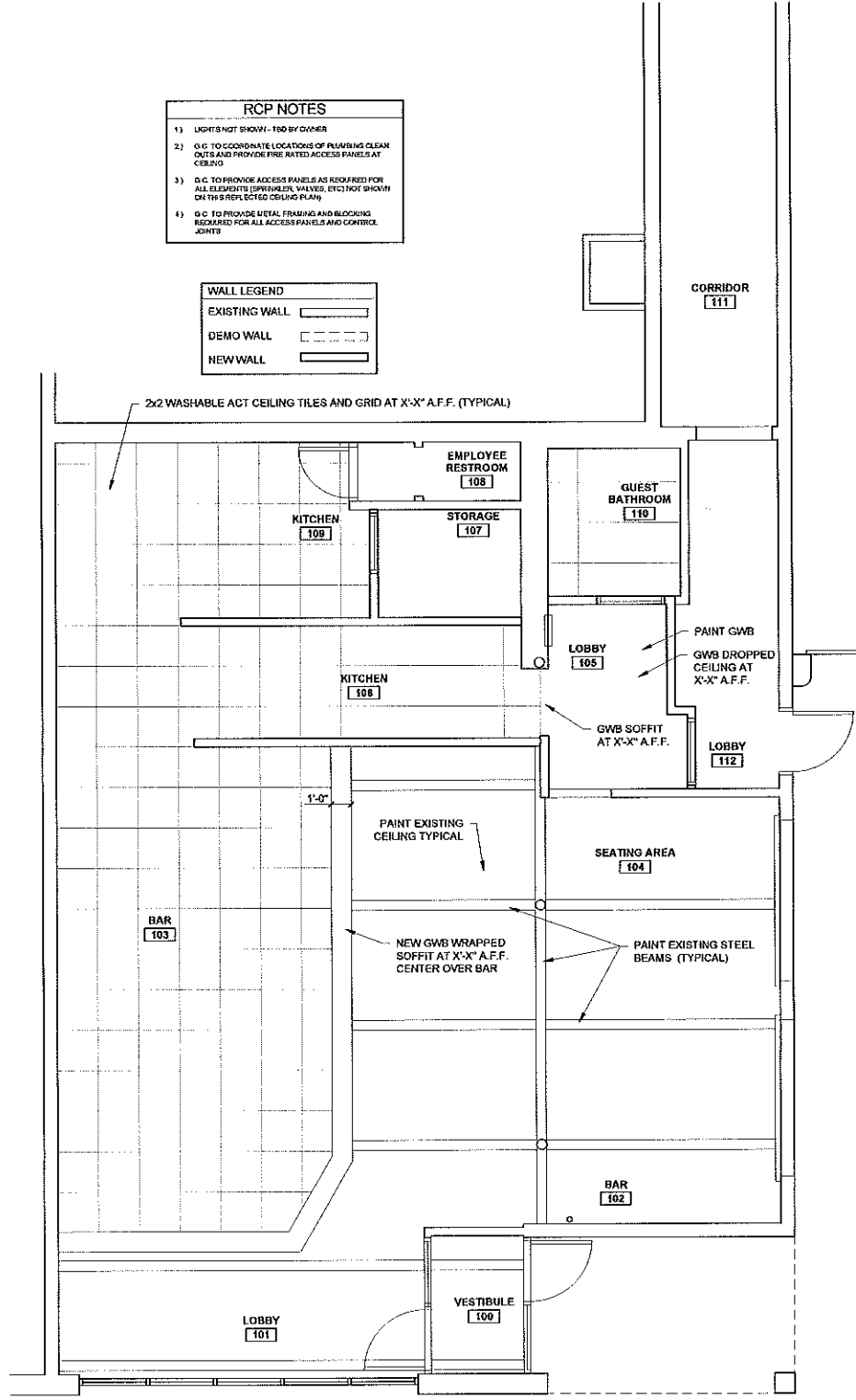

1 FIRST FLOOR REFLECTED CEILING PLAN
 1/4" = 1'-0"

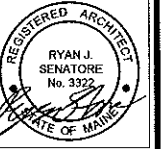

© 2016 RYAN SENATORE ARCHITECTURE

CONG TU BOT - RESTAURANT FIT-UP
 59 WASHINGTON AVENUE
 PORTLAND, MAINE



RYAN SENATORE ARCHITECTURE
 565 CONGRESS STREET
 PORTLAND, MAINE 04101
 207-660-8414
 rsasearchitecture.com

CONSULTANTS:

REVISIONS:

DATE: 17, OCTOBER 2016

PROJECT No. 1643

DRAWN BY: JPF, RJS

CHECKED BY: RJS

SCALE: AS NOTED

SHEET TITLE:
FIRST FLOOR EQUIPMENT PLAN

A1-2

RESTAURANT APPLIANCE SCHEDULE:

| # | EQUIPMENT | DIMENSIONS (W x D x H) |
|-----|-----------------------|--------------------------|
| #1 | NOODLE BOILER | 17.75' x 35.5' x 40.5' |
| #2 | 4 BURNER RANGE | 23.625' x 34.5' x 57" |
| #3 | DOUBLE WOK RANGE | 41' x 48' x 36" |
| #4 | SINGLE STOCK RANGE | 17.75' x 20.75' x 24.5' |
| #5 | PREP LOWBOY 1DR 1 | 27' x 38.375' x 45.5' |
| #6 | PREP LOWBOY 1DR 2 | 27' x 38.375' x 45.5' |
| #7 | HAND SINK | TBD |
| #8 | METRO RACK SHELF | 24' x 48" |
| #9 | METRO RACK SHELF | 24' x 48" |
| #10 | METRO RACK SHELF | 24' x 48" |
| #11 | SINGLE DOOR REACH-IN | 27.25' x 33.75' x 78" |
| #12 | DOUBLE DOOR REACH-IN | 52' x 33.75' x 78" |
| #13 | PREP SINK | TBD |
| #14 | DISHWASHER | 25.25' x 25.25' x 76.75" |
| #15 | 3 COMPARTMENT SINK | TBD |
| #16 | ICE MACHINE | 38.5' x 23.625' x 33.5" |
| #17 | DOUBLE DOOR REACH-IN | 52' x 33.75' x 78" |
| #18 | SINGLE DOOR FREEZER | 27.25' x 33.75' x 78" |
| #19 | METRO RACK SHELF | 24' x 30" |
| #20 | BACK BAR REFRIGERATOR | 24' x 29.5' x 37.75" |
| #21 | HAND SINK | TBD |
| #22 | BACK BAR REFRIGERATOR | 24' x 29.5' x 37.75" |
| #23 | BEER DIPENSER | 59' x 28.25' x 37.25" |
| #24 | PREP TABLE | VARIOUS SIZES |
| #25 | PREP TABLE | 24" WIDE |

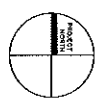
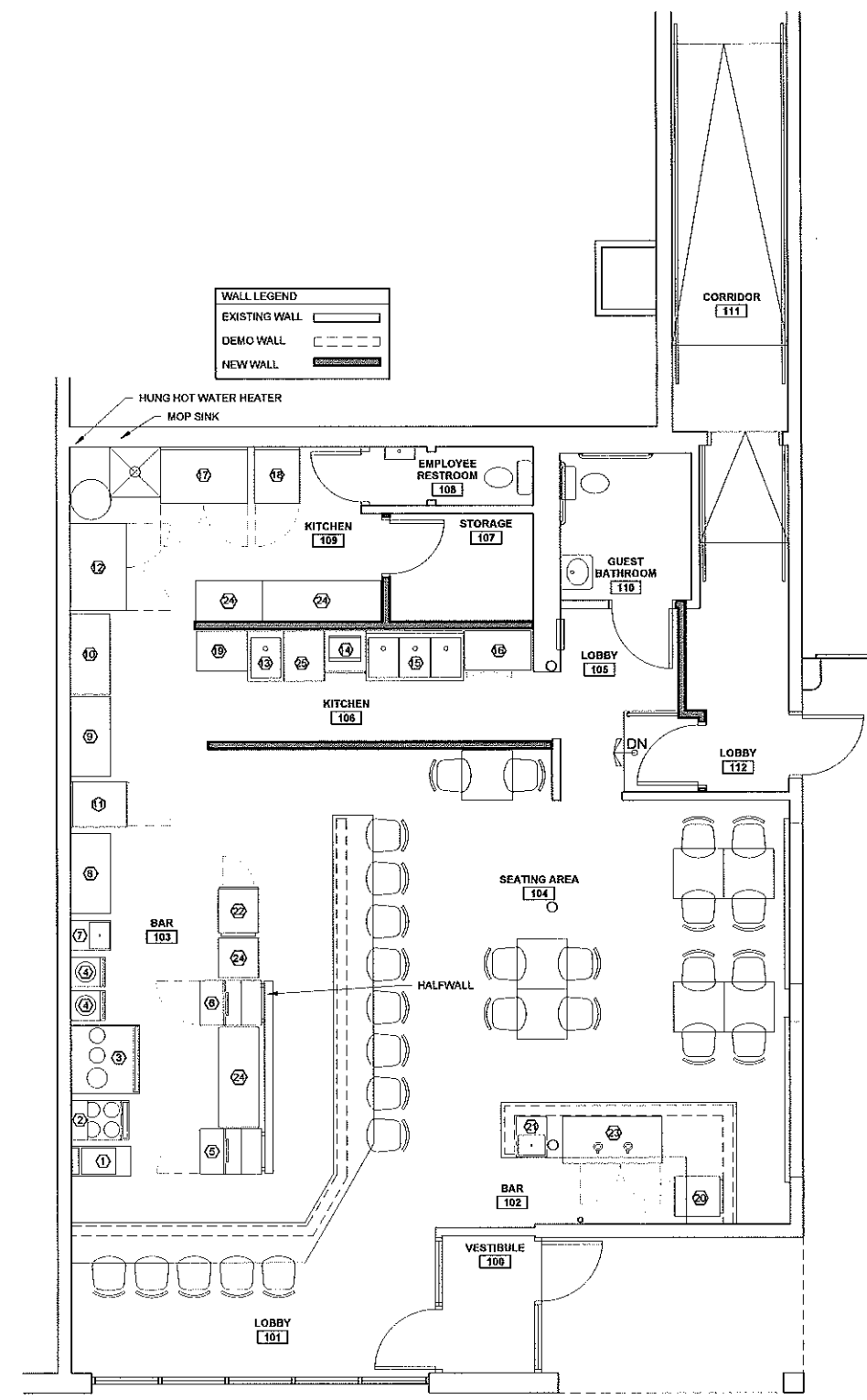

1 FIRST FLOOR EQUIPMENT PLAN
 1/4" = 1'-0"



© 2016 RYAN SENATORE ARCHITECTURE

CONG TU BOT - RESTAURANT FIT-UP
59 WASHINGTON AVENUE
PORTLAND, MAINE



RYAN SENATORE
ARCHITECTURE
66 CONGRESS STREET
PORTLAND, MAINE 04101
207-650-6414
rsen@senatorearchitecture.com

CONSULTANTS:

REVISIONS:

DATE: 17, OCTOBER 2016

PROJECT No. 1643

DRAWN BY: JPF, RJS

CHECKED BY: RJS

SCALE: AS NOTED

SHEET TITLE:

INTERIOR ELEVATIONS

A4-0

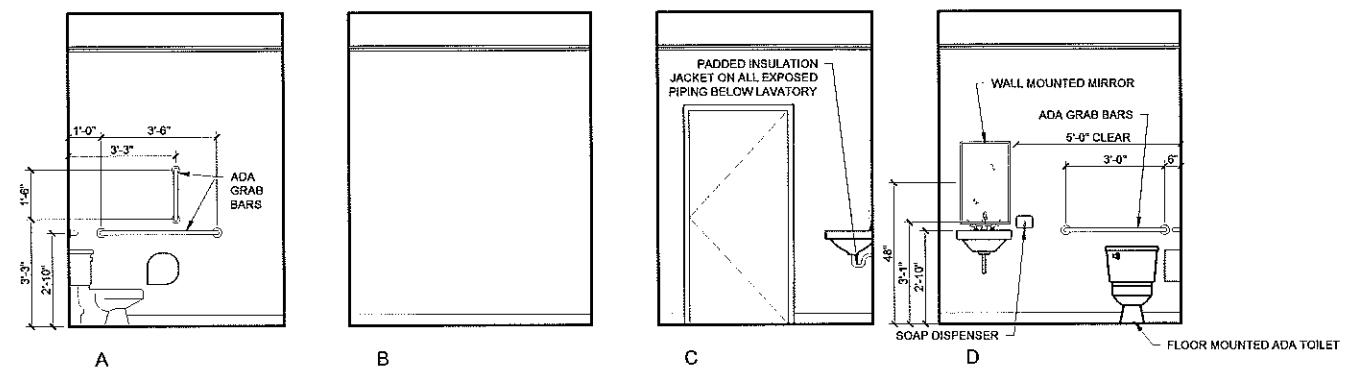

1 RESTROOM INTERIOR ELEVATIONS
3/8" = 1'-0"



© 2016 RYAN SENATORE ARCHITECTURE

CONG TU BOT - RESTAURANT FIT-UP
 59 WASHINGTON AVENUE
 PORTLAND, MAINE



RYAN SENATORE
 ARCHITECTURE
 555 CONGRESS STREET
 PORTLAND, MAINE 04101
 207-650-6414
 senatore@rsaarch.com

CONSULTANTS:

REVISIONS:

DATE: 17, OCTOBER 2016

PROJECT No. 1643

DRAWN BY: JPF, RJS

CHECKED BY: RJS

SCALE: AS NOTED

SHEET TITLE:
 DETAILS

A5-0

