

59 Washington Ave
Unit 1-EA key plan

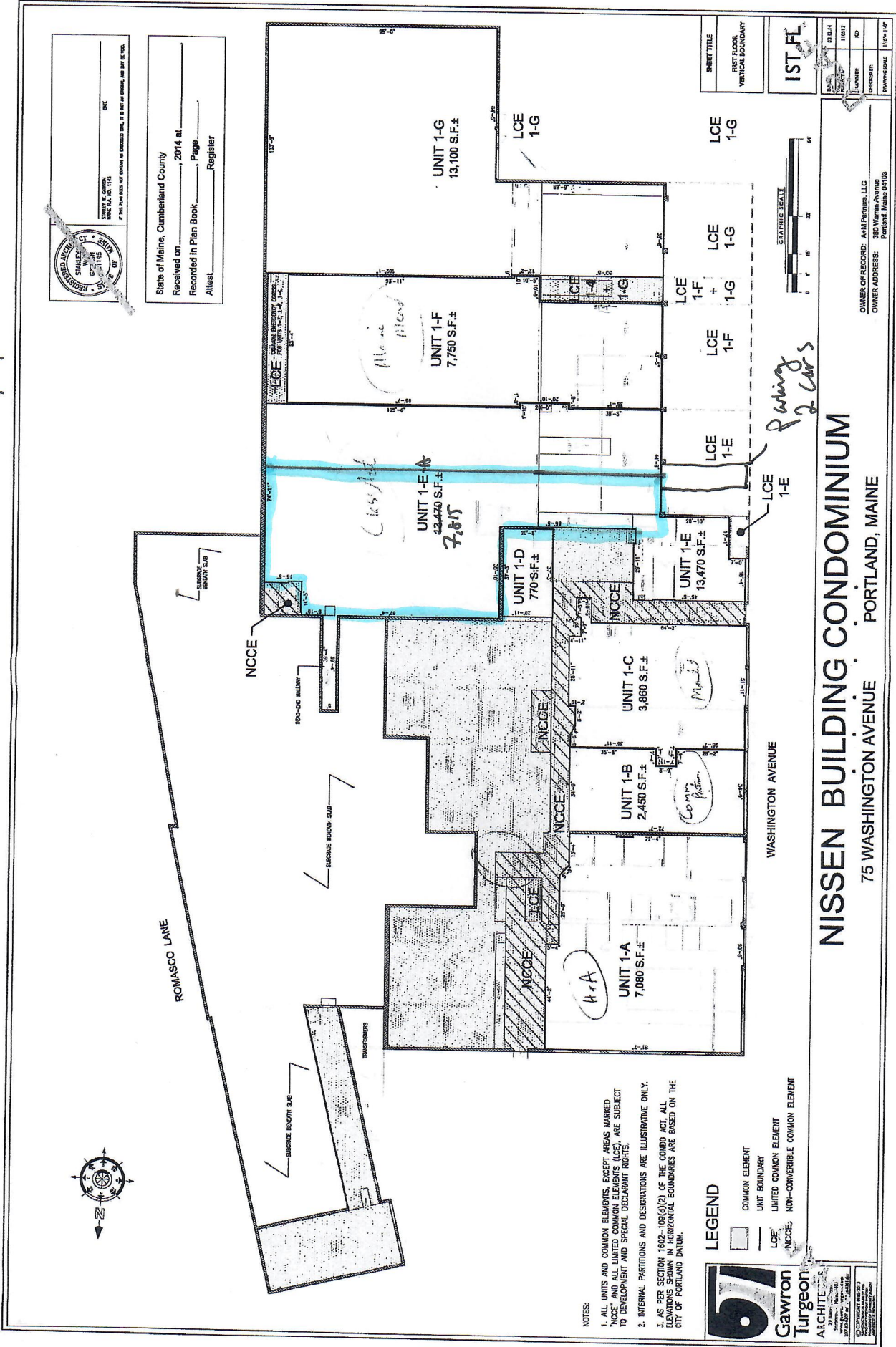

State of Maine, Cumberland County
Received on _____, 2014 at _____
Recorded in Plan Book _____, Page _____
Attest: _____ Registrar



- NOTES:
1. ALL UNITS AND COMMON ELEMENTS, EXCEPT AREAS MARKED "NCCE" AND ALL LIMITED COMMON ELEMENTS (LCE), ARE SUBJECT TO DEVELOPMENT AND SPECIAL DECARRANT RIGHTS.
 2. INTERNAL PARTITIONS AND DESIGNATIONS ARE ILLUSTRATIVE ONLY.
 3. AS PER SECTION 1602-103(2) OF THE CONDO ACT, ALL HORIZONTAL BOUNDARIES ARE BASED ON THE CITY OF PORTLAND DATUM.

LEGEND

- COMMON ELEMENT
- UNIT BOUNDARY
- LIMITED COMMON ELEMENT
- LCE
- NCCE, NON-CONVERTIBLE COMMON ELEMENT

Gawtron Turgeon ARCHITECTS
 1000 BROADWAY, SUITE 200
 PORTLAND, ME 04101
 TEL: 603.761.1111
 FAX: 603.761.1112
 WWW.GAWTRONTURGEON.COM

NISSSEN BUILDING CONDOMINIUM
 75 WASHINGTON AVENUE PORTLAND, MAINE

COWNER OF RECORD: AAM Partners, LLC
 OTHER ADDRESS: 285 W. Washington
 Portland, Maine 04103



SHEET TITLE
 FIRST FLOOR
 VERTICAL BOUNDARY

DATE	11/14
BY	STANLEY A. GAGNON
NO.	1142
EXCISE NO.	
ISSUE NO.	

3/13/14