

© 2016 RYAN SENATORE ARCHITECTURE

**NISSEN BUILDING - COURTYARD**  
75 WASHINGTON STREET  
PORTLAND MAINE



**RYAN SENATORE ARCHITECTURE**  
366 CONGRESS STREET  
PORTLAND, MAINE 04101  
207-650-6414  
senatorearchitecture.com

CONSULTANTS:  
STRUCTURAL: Structural Integrity  
77 Oak Street  
Portland, ME 04101  
207-774-4614

REVISIONS:

DATE: AUGUST 31, 2016

PROJECT No. 1523.C

DRAWN BY: JPF

CHECKED BY: RJS

SCALE: AS NOTED

SHEET TITLE:  
DEMOLITION FLOOR PLAN

AD1-0

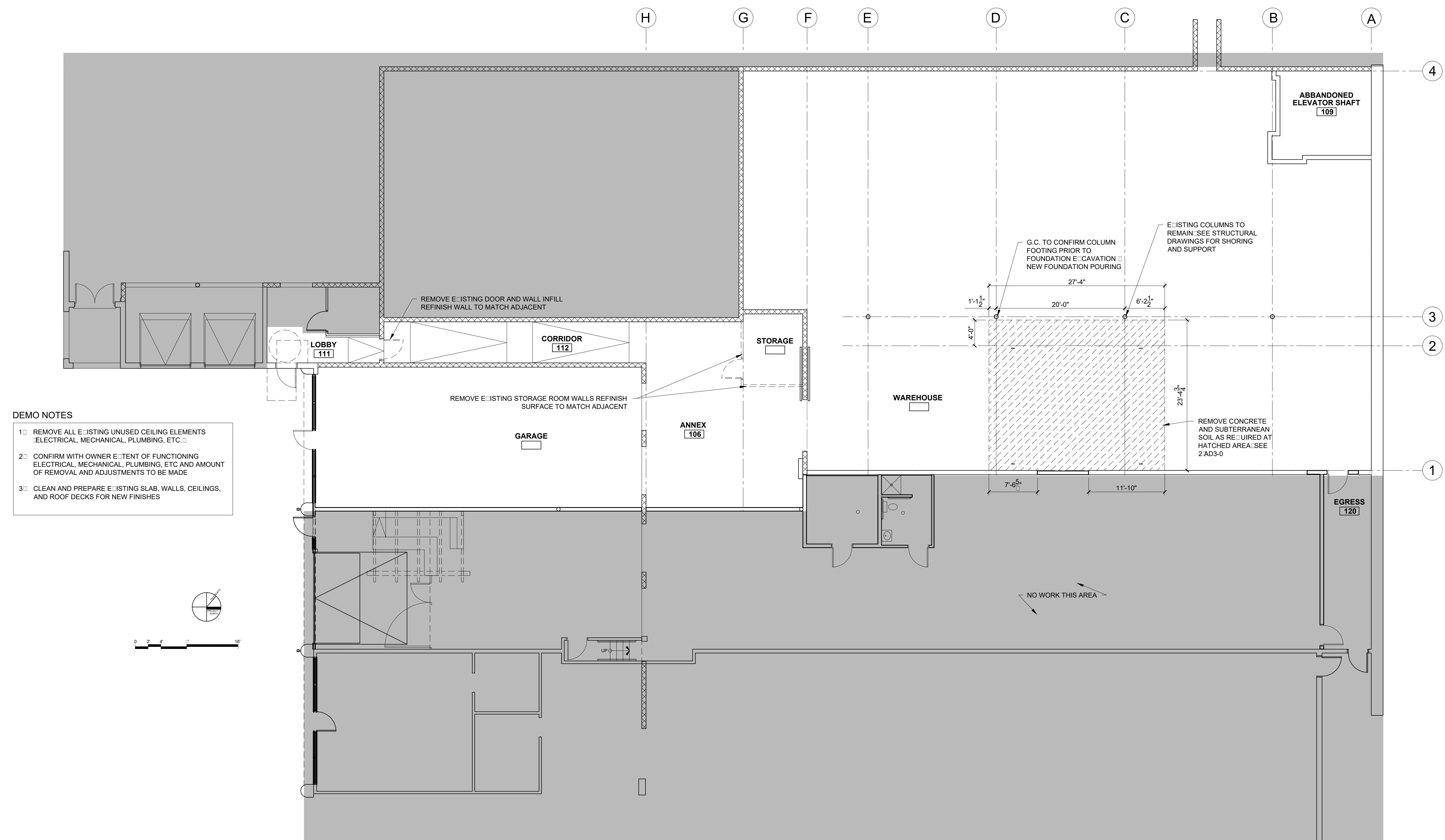

- DEMO NOTES**
- 1 REMOVE ALL EXISTING UNUSED CEILING ELEMENTS (ELECTRICAL, MECHANICAL, PLUMBING, ETC.)
  - 2 CONFIRM WITH OWNER EXTENT OF FUNCTIONING ELECTRICAL, MECHANICAL, PLUMBING, ETC AND AMOUNT OF REMOVAL AND ADJUSTMENTS TO BE MADE
  - 3 CLEAN AND PREPARE EXISTING SLAB, WALLS, CEILINGS, AND ROOF DECKS FOR NEW FINISHES

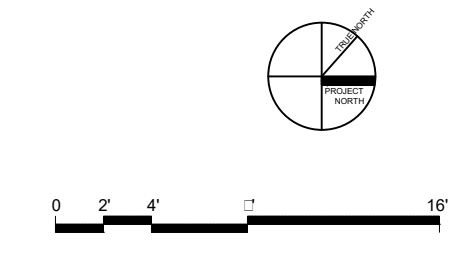

1 DEMOLITION FLOOR PLAN  
1/4" = 1'-0"