

© 2016 RYAN SENATORE ARCHITECTURE

NISSEN BUILDING - COURTYARD
75 WASHINGTON STREET
PORTLAND MAINE



RYAN SENATORE ARCHITECTURE
565 CONGRESS STREET
PORTLAND, MAINE 04101
207-650-6414
senatorearchitecture.com

CONSULTANTS:
STRUCTURAL:
Structural Integrity
77 Oak Street
Portland, ME 04101
207-774-4614

REVISIONS:

DATE: AUGUST 31, 2016

PROJECT No. 1523.C

DRAWN BY: JPF

CHECKED BY: RJS

SCALE: AS NOTED

SHEET TITLE:
ROOF PLAN

A1-1

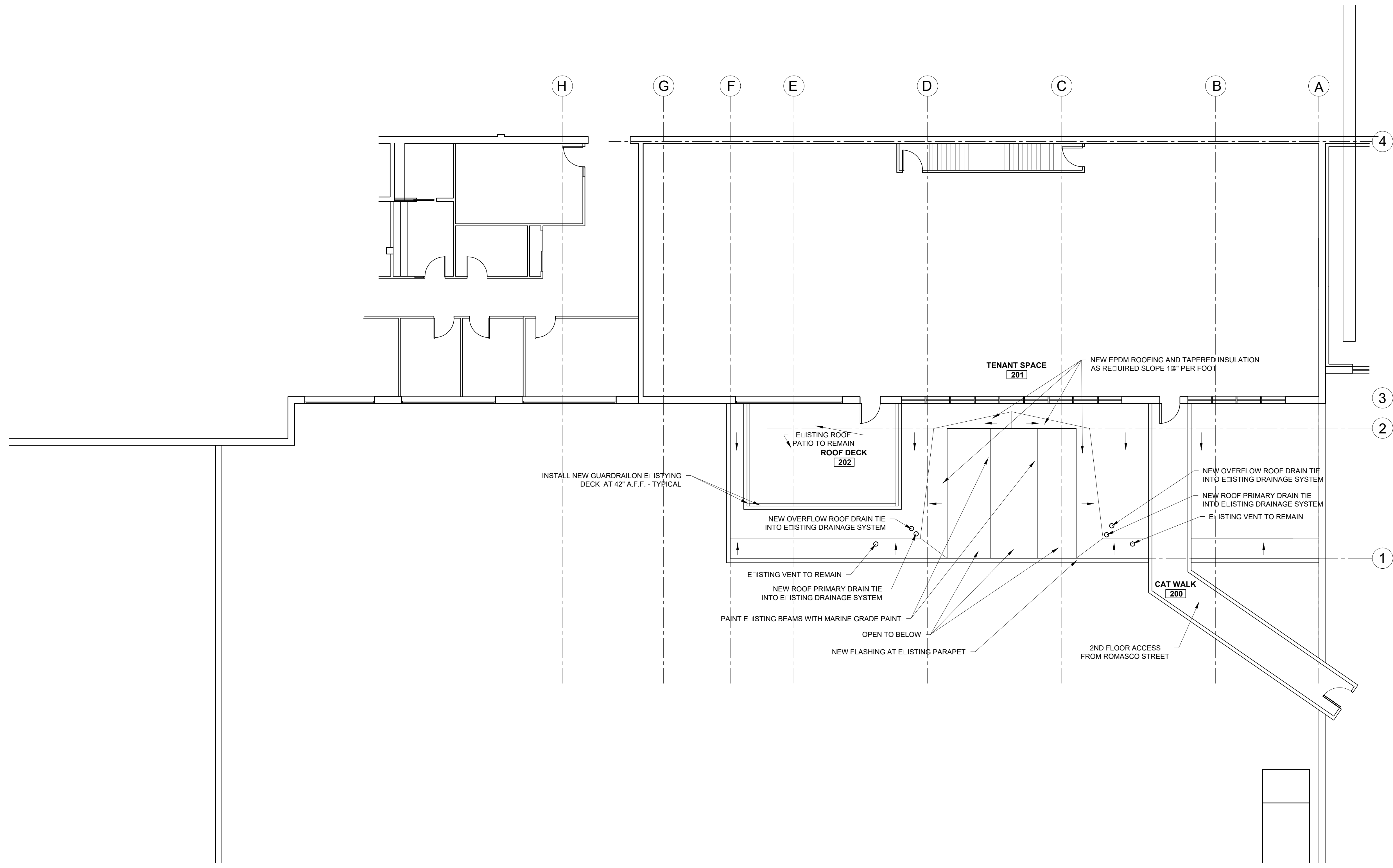

1 **ROOF PLAN**
1/4" = 1'-0"