

© 2015 RYAN SENATORE ARCHITECTURE

**NISSSEN BUILDING
RENOVATIONS
PORTLAND, MAINE**



**RYAN SENATORE
ARCHITECTURE**
565 CONGRESS STREET
PORTLAND, MAINE
207-659-6414
senatorearchitecture.com

CONSULTANTS:
STRUCTURAL:
Structural Integrity
77 Oak Street
Portland, ME 04101
207-774-4614

REVISIONS:

DATE: NOVEMBER 9, 2015

PROJECT No.: 1523

DRAWN BY: JPF

CHECKED BY: RJS

SCALE: AS NOTED

SHEET TITLE:
FLOOR PLAN

A1-0

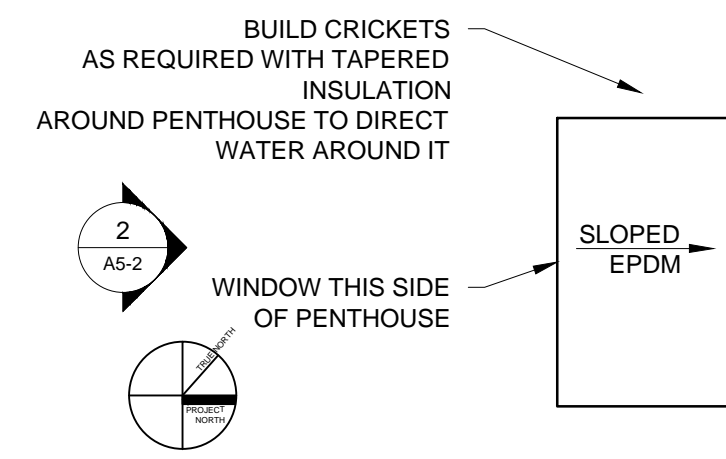
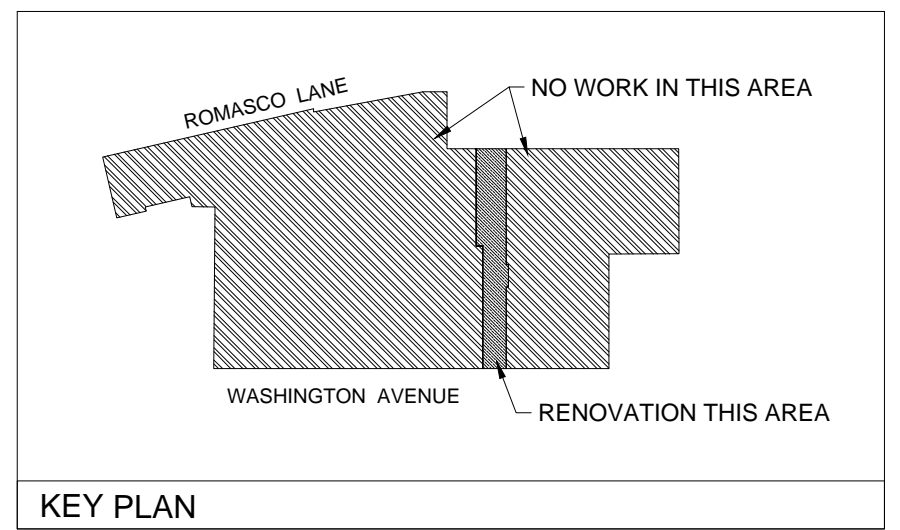

2 PENTHOUSE ROOF PLAN
1/8" = 1'-0"

CONSTRUCTION NOTES

- 1) FILL ALL EXISTING OPENINGS, GAPS, HOLES, ETC. IN EXISTING MASONRY WALL WITH MINERAL FIBER FIRE BLOCKING TYPICAL

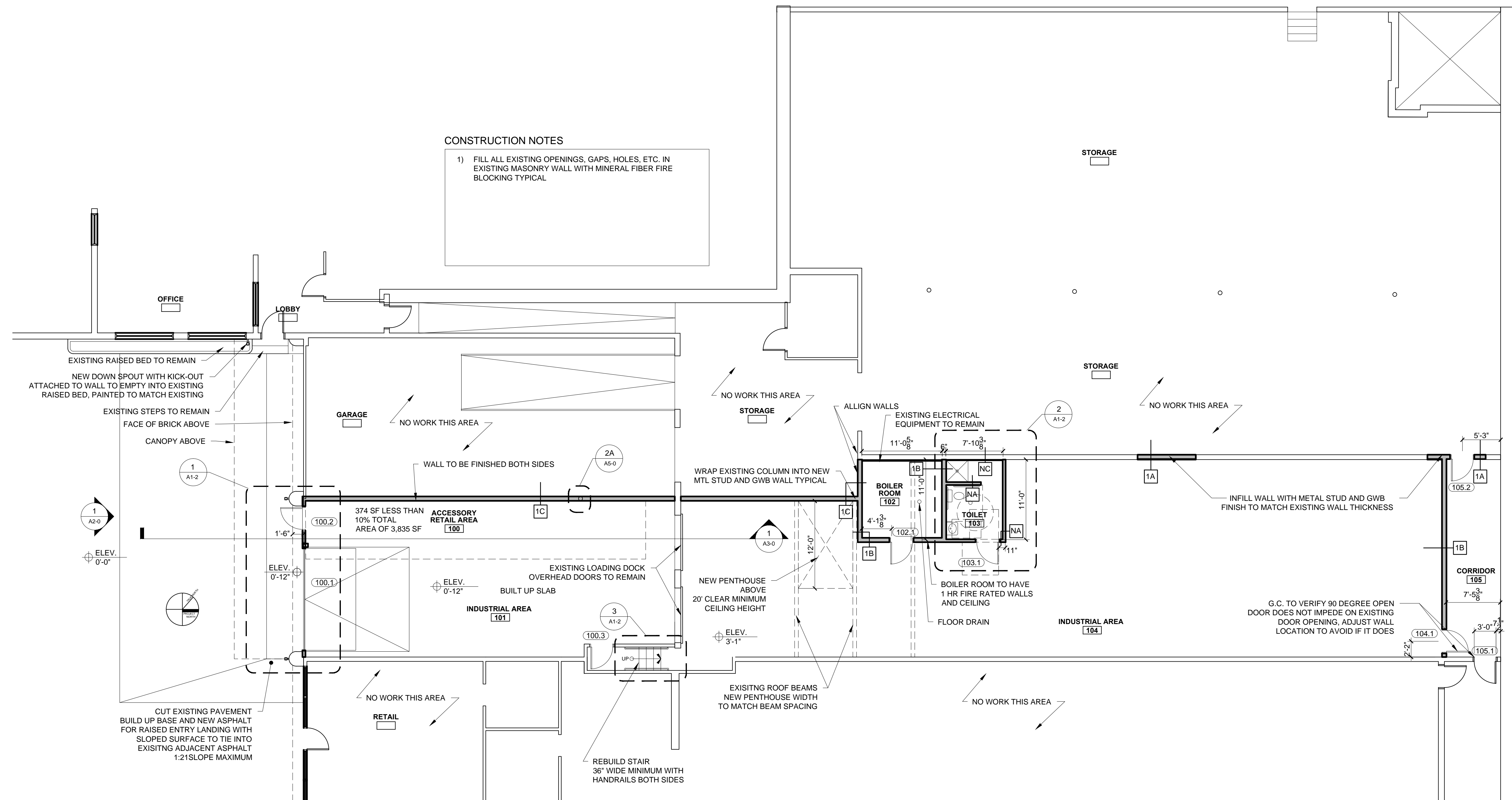

1 FLOOR PLAN
1/8" = 1'-0"