

5 SUITE 2-F / 3-D FLOOR PLANS
1/8" = 1'-0"

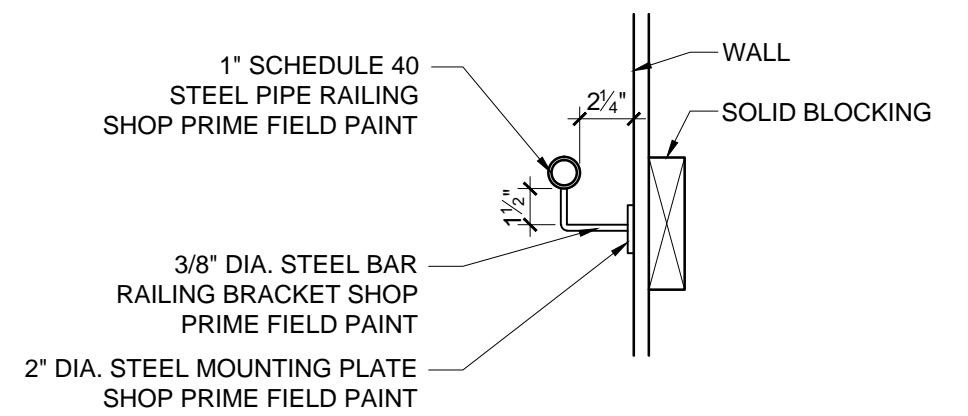

4 TYPICAL SECTION DETAIL OF HANDRAIL AT WALL
1-1/2" = 1'-0"

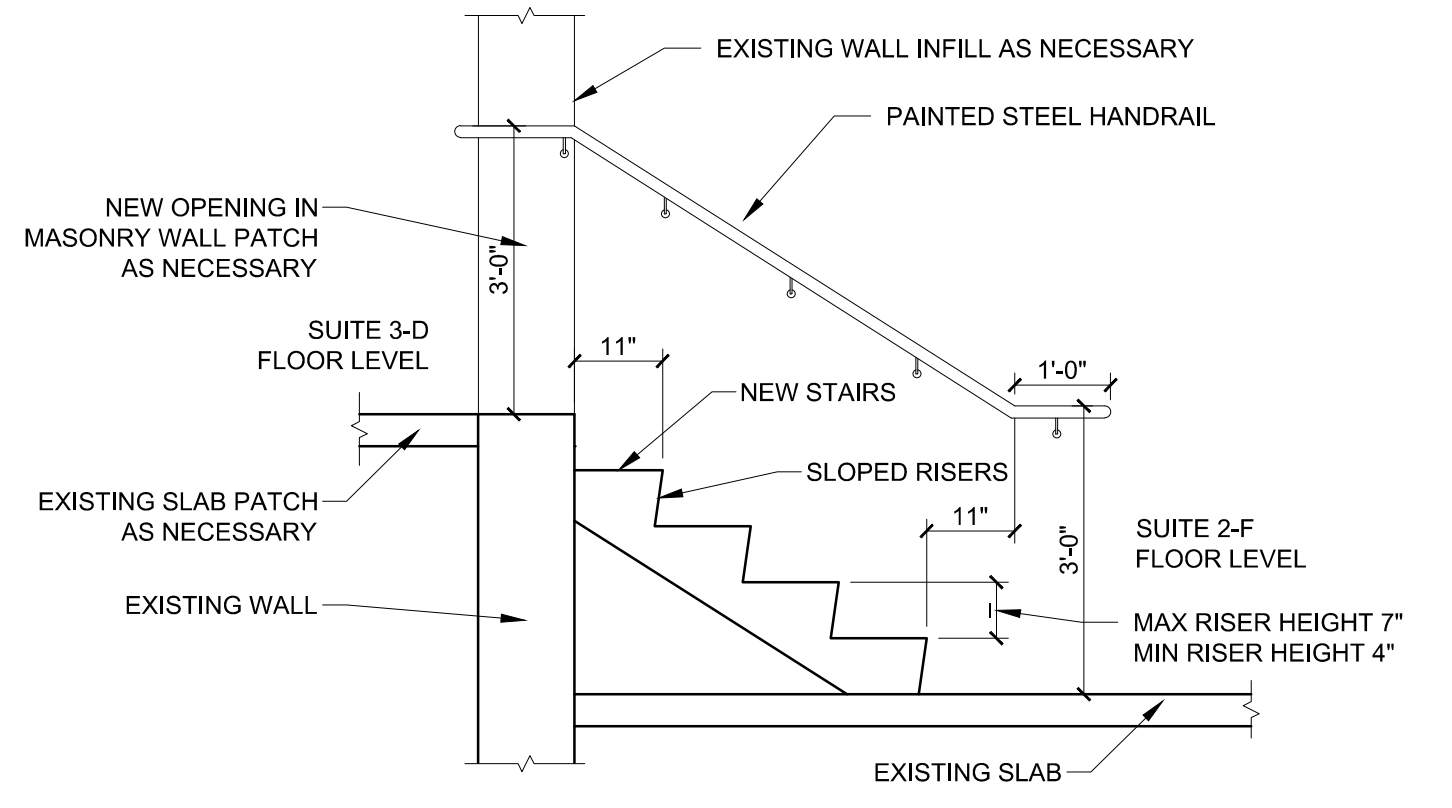

3 NEW STAIR SECTION VIEW
1/2" = 1'-0"

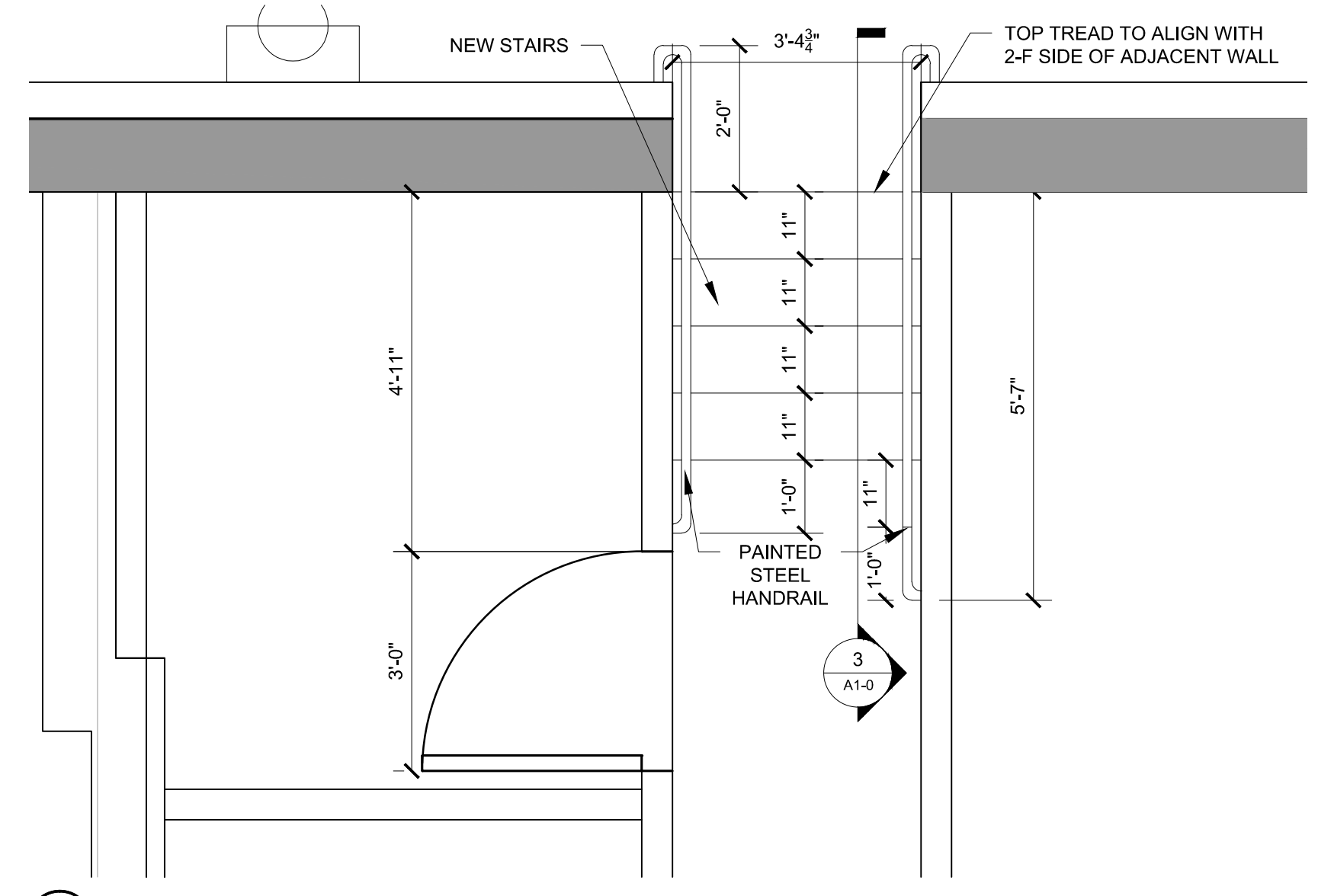

2 STAIR PLAN DETAIL
1/2" = 1'-0"

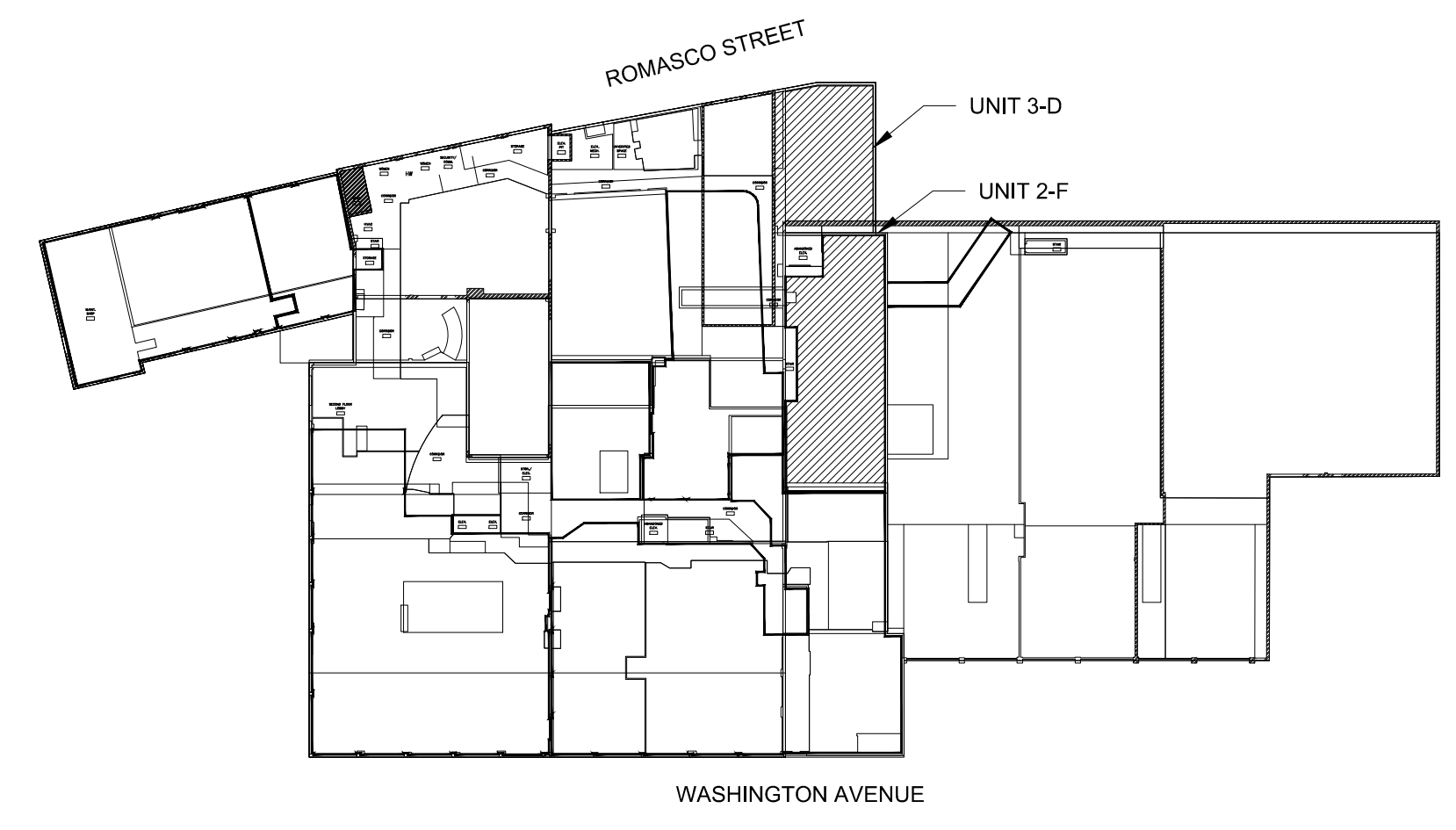

1 KEY PLAN
1/64" = 1'-0"

NOTES:

1.) R-VALUE OF NEW WALLS AT THE INTERIOR SIDE OF EXTERIOR WALLS TO BE R-23

2.) PARKING FOR FIVE CARS WILL BE PROVIDED IN COTTON STREET OWNED LOTS ON ROMASCO LANE AND 107 WASHINGTON AVENUE

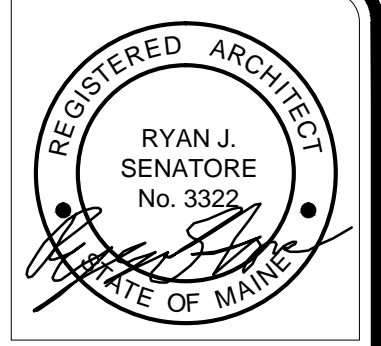

© 2015 RYAN SENATORE ARCHITECTURE

NISSEN BUILDING - SUITE 2-F / 3-D
ROMASCO STREET
PORTLAND, MAINE

RSA
RYAN SENATORE ARCHITECTURE
565 CONGRESS STREET
PORTLAND, MAINE 04101
207-650-6414
senatorearchitecture.com

CONSULTANTS:

REVISIONS:

DATE: AUGUST 6, 2015

PROJECT No.

DRAWN BY: JPF / RJS

CHECKED BY: RJS

SCALE: AS NOTED

SHEET TITLE:
NISSEN BUILDING RENOVATION PLANS

A1-0