



Gawron
Turgeon
ARCHITECTS

29 Black Point Road
 Scarborough, Maine 04074
 www.gawronturgeon.com
 207-885-2400 • Fax: 207-885-2401

HALEY & ALDRICH
OFFICE RENOVATIONS.
 75 WASHINGTON AVE
 PORTLAND, MAINE

REVISIONS		
#	DATE	DESCRIPTION
1	09/24/13	REVISED DRAWINGS

DATE	09/27/13
PROJECT #	080813
DRAWN BY:	LJP
CHECKED BY:	MEF
DRAWING SCALE	AS NOTED

SHEET TITLE	DETAILS
--------------------	---------

A900

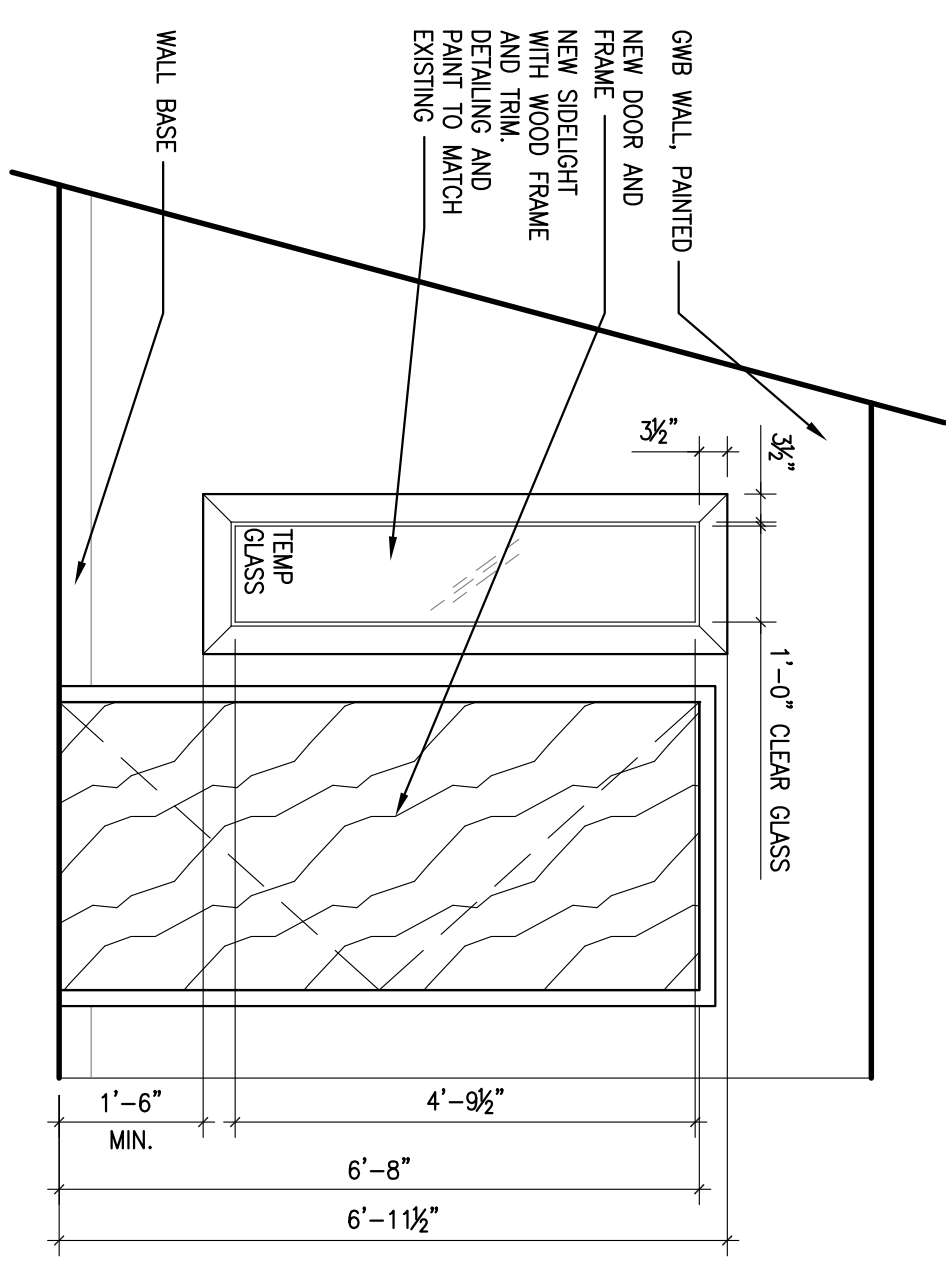

L16 INTERIOR ELEVATION

1/2"=1'-0" TYPICAL OFFICE DOOR AND SIDELIGHT ENTRANCE

- P1 SHERWIN WILLIAMS, ANTOUR WHITE SHEET 119, EGGSHELL SHEEN
LOCATION: GNB AND BRICK WALLS
- P2 SHERWIN WILLIAMS, BLACK, SEMI-GLOSS SHEEN
LOCATION: WOOD AND METAL TRIM
- P3 SHERWIN WILLIAMS, SHOWSTOPPER SW7598
LOCATION: ALL EXPOSED METAL COLUMNS
- C1 CARPET SHALL BE J&J COMMERCIAL, CORPORATE VALUES, STATE 2422, COLOR BRASS
LOCATION: COMMON AREAS, OFFICE, WAR ROOM AND LARGE CONFERENCE ROOM
- VC01 MANNINGTON COMMERCIAL, 901 NIGHT BLACK, TYPE T1-VINY, 4" VINYL CORE BASE
LOCATION: COMMON AREAS, OFFICE, WAR ROOM AND LARGE CONFERENCE ROOM

H16 INTERIOR FINISHES

NA

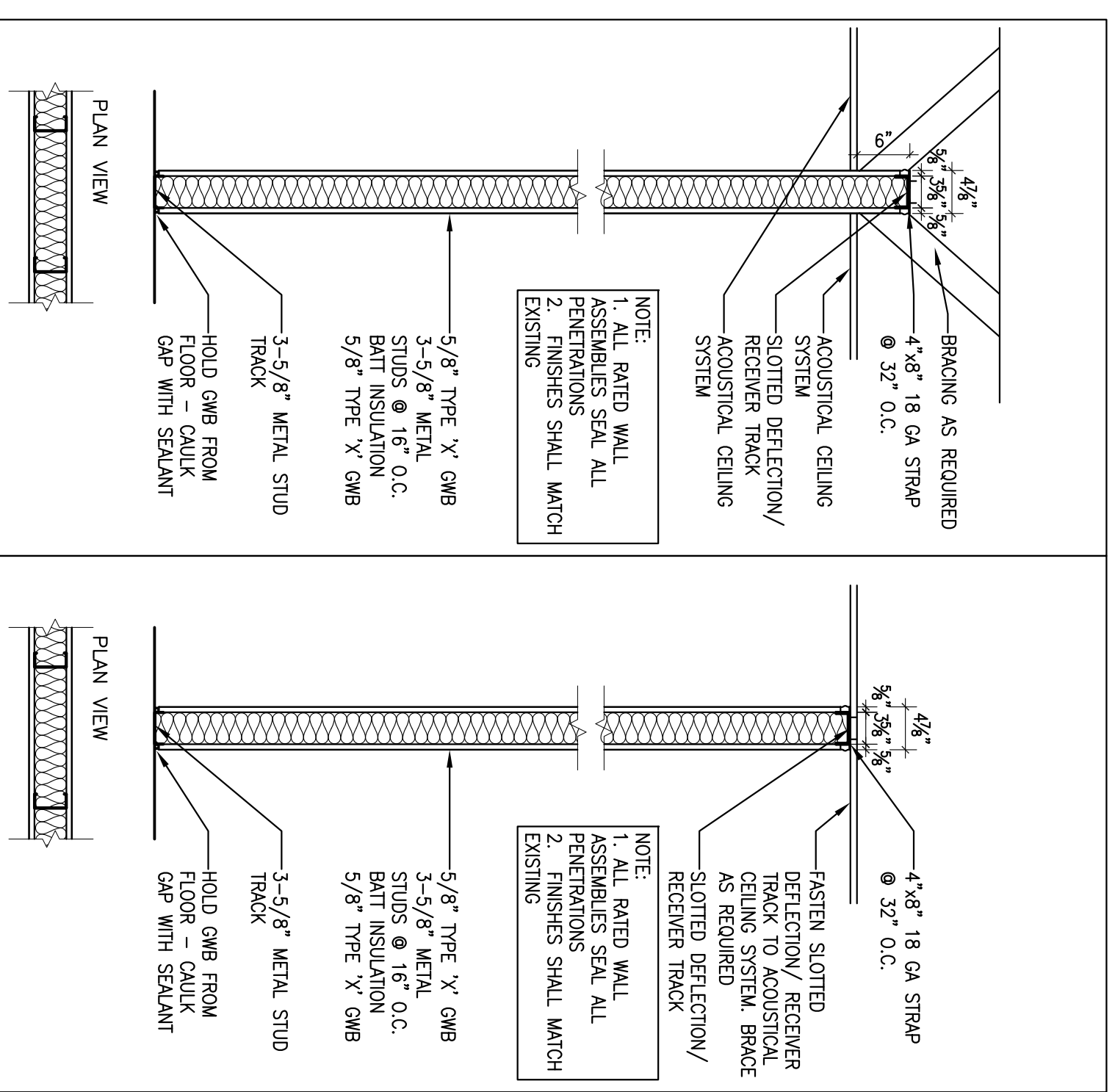

W1 WALL DETAIL (NON RATED)
SCALE 3/4"=1'-0"

W2 WALL DETAIL (NON RATED)
SCALE 3/4"=1'-0"

A16 WALL PARTITIONS

3/4"=1'-0" FLOOR PLAN

A1 NOT USED

NA