

GOODWILL INDUSTRIES
75 WASHINGTON AVENUE - THIRD FLOOR
PORTLAND, MAINE

REVISIONS	
NO.	DESCRIPTION
1	PRINT SET

DATE	09.23.12
PROJECT #	09013
DRAWN BY	DJP
CHECKED BY	NET
DRAWING SCALE	AS NOTED

SHEET TITLE
THIRD FLOOR
DEMOLITION PLAN
NOTES/LEGEND

D100

DATE PLOTTED: 09/23/12 11:45 AM
PLOTTER: HP DesignJet T1145
SCALE: 1/8" = 1'-0"

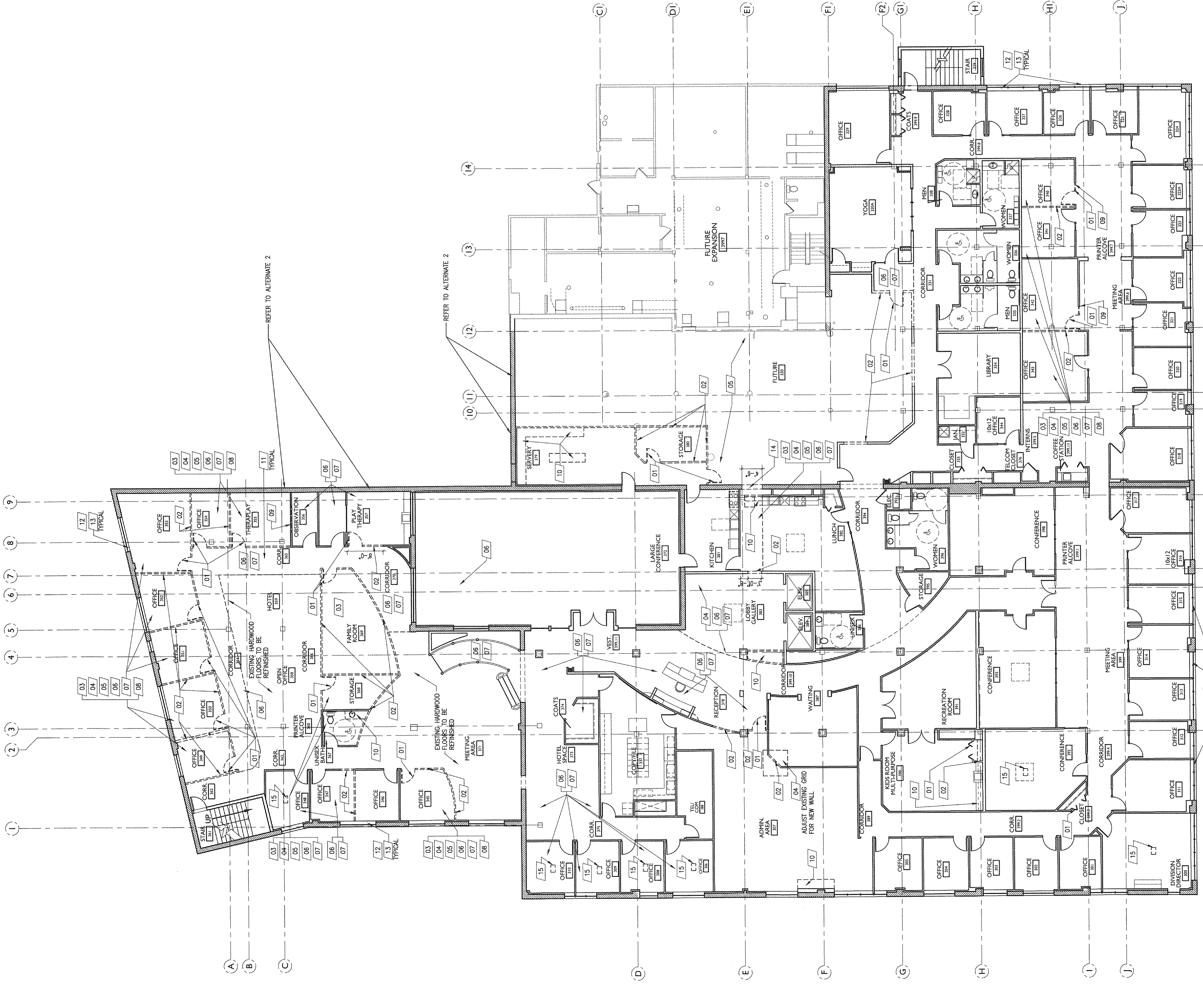

- 01 / REMOVE DOOR FRAME AND ALL ASSOCIATED FINISHES AS REQUIRED FOR NEW CONSTRUCTION. SWANKE REUSE.
- 02 / REMOVE WALL AS REQUIRED FOR NEW CONSTRUCTION. SWANKE FOR RE-USE.
- 03 / REMOVE ALL LATHING IN AFFECTED AREAS AND SWANKE FOR RE-USE.
- 04 / REMOVE ALL CEILING GRS, TILE AND ASSOCIATED FINISHES AS REQUIRED FOR NEW CONSTRUCTION.
- 05 / REMOVE ALL WALL FINISHES AND ASSOCIATED FINISHES AS REQUIRED FOR A SMOOTH AND LEVEL APPLICATION OF NEW FINISHES.
- 06 / REMOVE ALL FLOOR COVERING AND ASSOCIATED FINISHES AS REQUIRED FOR A SMOOTH AND LEVEL APPLICATION OF NEW FLOORING.
- 07 / REMOVE WALL BRSE AND ASSOCIATED FINISHES AS REQUIRED FOR SMOOTH APPLICATION OF NEW FINISHES. SWANKE ALL CEILING GRS AND TILE FOR RE-USE.
- 08 / REMOVE CEILING GRILLS AND RETAINS - SWANKE FOR RE-USE.
- 09 / REMOVE ALL INTERIOR WINDOW CURTAIN, SIDINGS AND FINISHES SWANKE FOR FINISH.
- 10 / REMOVE ALL MILLWORK (INCLUDING WALL & BRSE) OBJECTS AND ALL ASSOCIATED COMPONENTS SWANKE FOR RE-USE.
- 11 / REMOVE EXISTING LIFT SHUTT TRACKS - SWANKE FOR RE-USE.
- 12 / ALL EXISTING WINDOW TREATMENTS TO REMAIN - PREP DURING CONSTRUCTION.
- 13 / REPAIR ANY DAMAGED BRSE IN THEIR DIRECTION TO MATCH EXISTING.
- 14 / REMOVE EXISTING WOOD FLOOR FOR SMOOTH FINISH.
- 15 / PREP DOWNS, WANDERED ELEVATOR SHUTT FOR RE-USE. REMOVE SHUTT TRACK, NEW WALL FLOOR AND WALL FINISHES IN SHUTT.

A16 NOTES / LEGEND

A1 THIRD FLOOR DEMOLITION PLAN