

SYMBOL LEGEND

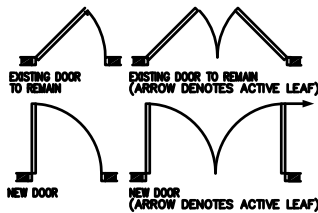

7-ELEVEN, INCORPORATED
 STORE NO: 32532
 INTERIOR ALTERATIONS
 27 WASHINGTON AVE.
 PORTLAND, ME 04101

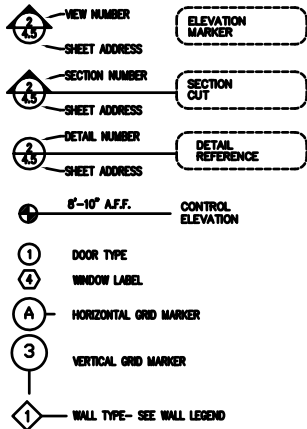

7-ELEVEN AQIP Reinvented

LIGHTING SYMBOLS

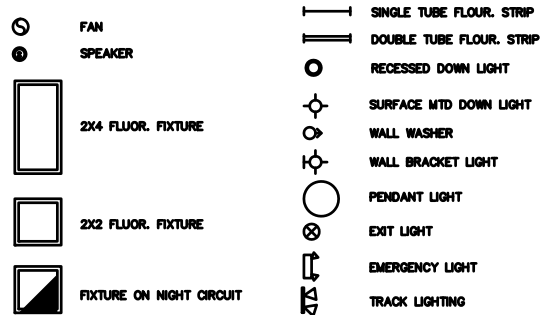

GENERAL NOTES / SPECIFICATIONS

GENERAL CONDITIONS

- CONTRACTOR SHALL VERIFY A COMPLETE CONSTRUCTION GENERAL TO THE OWNER, WHICH COORDINATES ALL WORK WITH SUPPLIERS, SUB-CONTRACTORS, AND SPECIALTY CONTRACTORS WITH THE FINAL BID.
- CONTRACTOR'S BID SHALL INCLUDE ALL WORK REQUIRED TO COMPLETE THE PROJECT WITH THE MOST ECONOMY OF THE HIGHEST QUALITY FROM THE FLORIDA BUILDING CODE BOOK, CURRENT EDITION OR AS AMENDED BY THE MUNICIPALITY AND THE 1994-1995 (CURRENT EDITION OR AS AMENDED) BY THE MUNICIPALITY.
- ALL CONTRACTORS SHALL PROTECT THE WORK OF OTHER TRADES. ANY AND ALL CONTRACTS BETWEEN TRADES ARE TO BE COMPLETED BY TRADES AND NOTIFICATION OF ALL CONTRACTS MADE TO ARCHITECT AND OWNER. ANY WORK DAMAGED SHALL BE REPLACED BY CONTRACTOR CHARGED AND DAMAGED AT HIS EXPENSE.
- CONTRACTOR SHALL REFER TO BUILDING STANDARDS BEFORE PROCEEDING WITH WORK AND SHALL COMPLY WITH ALL ASPECTS OF THE OWNER'S BUILDING STANDARDS.
- THE CONTRACTOR SHALL EXAMINE ALL AREAS IN WHICH WORK IS TO BE CONSTRUCTED AND SHALL REPORT ANY SUCH WORK WHICH IS NOT IN ACCORDANCE WITH THE BUILDING CODE TO THE ARCHITECT. THE CONTRACTOR SHALL BE RESPONSIBLE FOR THE CONDITION OF THE FINISHED WORK AFTER THE WORK UNDER THIS CONTRACT IS FINISHED.
- THE CONTRACTOR SHALL VISIT THE JOB SITE AND SHALL VERIFY THE ARCHITECT'S DIMENSIONS AND DETAILS PRIOR TO INITIAL BID SUBMITTAL. CONTRACTOR SHALL VERIFY DIMENSIONS AND DETAILS PRIOR TO ANY COMMENCEMENT OF WORK. CONTRACTOR SHALL VERIFY DIMENSIONS AND DETAILS PRIOR TO ANY COMMENCEMENT OF WORK. CONTRACTOR SHALL VERIFY DIMENSIONS AND DETAILS PRIOR TO ANY COMMENCEMENT OF WORK.
- ALL BUILDING RESTROOMS ARE NOT TO BE USED BY CONTRACTOR PERSONNEL. IT SHALL BE THE RESPONSIBILITY OF THE CONTRACTOR TO PROVIDE RESTROOMS FOR HIS PERSONNEL AND TO MAINTAIN THEM IN A CLEAN AND SAFE CONDITION AT ALL TIMES. CONTRACTOR SHALL PROVIDE RESTROOMS FOR HIS PERSONNEL AND TO MAINTAIN THEM IN A CLEAN AND SAFE CONDITION AT ALL TIMES.
- ALL CHANGING ROOMS SHALL BE IN WRITING AND SHALL BE SIGNED BY OWNER.
- ALL WORK SHALL BE DONE IN A NEAT AND WORKMANLIKE MANNER AND IN ACCORDANCE WITH ALL APPLICABLE CODES, ORDINANCES, REGULATIONS, AND ALL OTHER APPLICABLE LAWS, RULES AND REGULATIONS OF STATE, LOCAL, FEDERAL AND NATIONAL GOVERNMENTS.
- ALL MATERIALS SHALL BE OF THE HIGHEST QUALITY AND SHALL BE SUBMITTED TO THE ARCHITECT FOR APPROVAL PRIOR TO INSTALLATION.
- CONTRACTOR SHALL HAVE A SUPERVISOR ON SITE WHILE ANY WORK IS BEING DONE.
- PROTECT AND MAINTAIN AT ALL CONSTRUCTION LOCATIONS THE EXISTING UTILITIES AND ALL OTHER UTILITIES. THE CONTRACTOR SHALL BE RESPONSIBLE FOR THE PROTECTION AND MAINTENANCE OF ALL UTILITIES AND SHALL BE RESPONSIBLE FOR THE PROTECTION AND MAINTENANCE OF ALL UTILITIES AND SHALL BE RESPONSIBLE FOR THE PROTECTION AND MAINTENANCE OF ALL UTILITIES.

- NO STRUCTURAL MEMBER SHALL BE REMOVED, CUT, ALIENED OR MOVED IN ANY WAY WITHOUT PREVIOUS WRITTEN AUTHORIZATION FROM ARCHITECT OR STRUCTURAL ENGINEER. THERE SHALL BE NO PENETRATIONS IN PRE-CAST CONCRETE BEAMS OR JOISTS AND NO DRILLING OR BOREHOLE HANDING OR PILING IN PRE-CAST CONCRETE BEAMS OR JOISTS.
- WHERE TWO METALS ARE APPLIED TO EACH OTHER, THE GENERAL CONTRACTOR SHALL PROVIDE THE NECESSARY BUILDING MATERIAL, SO THAT NO CORROSION OR RUST IS TRANSMITTED BETWEEN THE METALS.
- THE CONTRACTOR SHALL AT ALL TIMES PROTECT THE WORK, MATERIALS AND FINISHED WORK FROM ELEMENTS OF WEATHER. SUCH WORK DAMAGED BY FAILURE OF THE CONTRACTOR TO PROVIDE PROTECTION SHALL BE REPAIRED AND REPLACED WITH NEW WORK AT CONTRACTOR'S EXPENSE.
- PROTECT THE COMPLETION OF THE WORK UNDER A CONTRACTOR'S CONTROL. FOR ALL CONTRACTS UNDER THIS CONTRACT, THE CONTRACTOR SHALL PROVIDE PROTECTION AND MAINTENANCE OF ALL UTILITIES AND SHALL BE RESPONSIBLE FOR THE PROTECTION AND MAINTENANCE OF ALL UTILITIES.
- PROTECT THE COMPLETION OF THE WORK UNDER A CONTRACTOR'S CONTROL. FOR ALL CONTRACTS UNDER THIS CONTRACT, THE CONTRACTOR SHALL PROVIDE PROTECTION AND MAINTENANCE OF ALL UTILITIES AND SHALL BE RESPONSIBLE FOR THE PROTECTION AND MAINTENANCE OF ALL UTILITIES.
- PROTECT THE COMPLETION OF THE WORK UNDER A CONTRACTOR'S CONTROL. FOR ALL CONTRACTS UNDER THIS CONTRACT, THE CONTRACTOR SHALL PROVIDE PROTECTION AND MAINTENANCE OF ALL UTILITIES AND SHALL BE RESPONSIBLE FOR THE PROTECTION AND MAINTENANCE OF ALL UTILITIES.
- PROTECT THE COMPLETION OF THE WORK UNDER A CONTRACTOR'S CONTROL. FOR ALL CONTRACTS UNDER THIS CONTRACT, THE CONTRACTOR SHALL PROVIDE PROTECTION AND MAINTENANCE OF ALL UTILITIES AND SHALL BE RESPONSIBLE FOR THE PROTECTION AND MAINTENANCE OF ALL UTILITIES.
- PROTECT THE COMPLETION OF THE WORK UNDER A CONTRACTOR'S CONTROL. FOR ALL CONTRACTS UNDER THIS CONTRACT, THE CONTRACTOR SHALL PROVIDE PROTECTION AND MAINTENANCE OF ALL UTILITIES AND SHALL BE RESPONSIBLE FOR THE PROTECTION AND MAINTENANCE OF ALL UTILITIES.
- PROTECT THE COMPLETION OF THE WORK UNDER A CONTRACTOR'S CONTROL. FOR ALL CONTRACTS UNDER THIS CONTRACT, THE CONTRACTOR SHALL PROVIDE PROTECTION AND MAINTENANCE OF ALL UTILITIES AND SHALL BE RESPONSIBLE FOR THE PROTECTION AND MAINTENANCE OF ALL UTILITIES.
- PROTECT THE COMPLETION OF THE WORK UNDER A CONTRACTOR'S CONTROL. FOR ALL CONTRACTS UNDER THIS CONTRACT, THE CONTRACTOR SHALL PROVIDE PROTECTION AND MAINTENANCE OF ALL UTILITIES AND SHALL BE RESPONSIBLE FOR THE PROTECTION AND MAINTENANCE OF ALL UTILITIES.

- FINISH NOTES
- FINISHES SHALL BE DONE IN A NEAT AND WORKMANLIKE MANNER AND IN ACCORDANCE WITH ALL APPLICABLE CODES, ORDINANCES, REGULATIONS, AND ALL OTHER APPLICABLE LAWS, RULES AND REGULATIONS OF STATE, LOCAL, FEDERAL AND NATIONAL GOVERNMENTS.
- ALL FINISHES SHALL BE DONE IN A NEAT AND WORKMANLIKE MANNER AND IN ACCORDANCE WITH ALL APPLICABLE CODES, ORDINANCES, REGULATIONS, AND ALL OTHER APPLICABLE LAWS, RULES AND REGULATIONS OF STATE, LOCAL, FEDERAL AND NATIONAL GOVERNMENTS.
- ALL FINISHES SHALL BE DONE IN A NEAT AND WORKMANLIKE MANNER AND IN ACCORDANCE WITH ALL APPLICABLE CODES, ORDINANCES, REGULATIONS, AND ALL OTHER APPLICABLE LAWS, RULES AND REGULATIONS OF STATE, LOCAL, FEDERAL AND NATIONAL GOVERNMENTS.
- ALL FINISHES SHALL BE DONE IN A NEAT AND WORKMANLIKE MANNER AND IN ACCORDANCE WITH ALL APPLICABLE CODES, ORDINANCES, REGULATIONS, AND ALL OTHER APPLICABLE LAWS, RULES AND REGULATIONS OF STATE, LOCAL, FEDERAL AND NATIONAL GOVERNMENTS.
- ALL FINISHES SHALL BE DONE IN A NEAT AND WORKMANLIKE MANNER AND IN ACCORDANCE WITH ALL APPLICABLE CODES, ORDINANCES, REGULATIONS, AND ALL OTHER APPLICABLE LAWS, RULES AND REGULATIONS OF STATE, LOCAL, FEDERAL AND NATIONAL GOVERNMENTS.
- ALL FINISHES SHALL BE DONE IN A NEAT AND WORKMANLIKE MANNER AND IN ACCORDANCE WITH ALL APPLICABLE CODES, ORDINANCES, REGULATIONS, AND ALL OTHER APPLICABLE LAWS, RULES AND REGULATIONS OF STATE, LOCAL, FEDERAL AND NATIONAL GOVERNMENTS.
- ALL FINISHES SHALL BE DONE IN A NEAT AND WORKMANLIKE MANNER AND IN ACCORDANCE WITH ALL APPLICABLE CODES, ORDINANCES, REGULATIONS, AND ALL OTHER APPLICABLE LAWS, RULES AND REGULATIONS OF STATE, LOCAL, FEDERAL AND NATIONAL GOVERNMENTS.
- ALL FINISHES SHALL BE DONE IN A NEAT AND WORKMANLIKE MANNER AND IN ACCORDANCE WITH ALL APPLICABLE CODES, ORDINANCES, REGULATIONS, AND ALL OTHER APPLICABLE LAWS, RULES AND REGULATIONS OF STATE, LOCAL, FEDERAL AND NATIONAL GOVERNMENTS.
- ALL FINISHES SHALL BE DONE IN A NEAT AND WORKMANLIKE MANNER AND IN ACCORDANCE WITH ALL APPLICABLE CODES, ORDINANCES, REGULATIONS, AND ALL OTHER APPLICABLE LAWS, RULES AND REGULATIONS OF STATE, LOCAL, FEDERAL AND NATIONAL GOVERNMENTS.

- DEMOLITION NOTES
- CONTRACTOR SHALL FURNISH ALL LABOR AND MATERIALS REQUIRED TO COMPLETE THE DEMOLITION, INCLUDING REMOVAL AND DISPOSITION OF ALL ITEMS UNDER THE PROJECT AREA.
- REMOVE ALL PARTITIONS, WALLS AND ATTACHMENTS SHALL BE FULLY DEMOLISHED FROM THE WALL.
- REMOVE ALL PARTITIONS, WALLS AND ATTACHMENTS SHALL BE FULLY DEMOLISHED FROM THE WALL.
- REMOVE ALL PARTITIONS, WALLS AND ATTACHMENTS SHALL BE FULLY DEMOLISHED FROM THE WALL.
- REMOVE ALL PARTITIONS, WALLS AND ATTACHMENTS SHALL BE FULLY DEMOLISHED FROM THE WALL.
- REMOVE ALL PARTITIONS, WALLS AND ATTACHMENTS SHALL BE FULLY DEMOLISHED FROM THE WALL.
- REMOVE ALL PARTITIONS, WALLS AND ATTACHMENTS SHALL BE FULLY DEMOLISHED FROM THE WALL.
- REMOVE ALL PARTITIONS, WALLS AND ATTACHMENTS SHALL BE FULLY DEMOLISHED FROM THE WALL.
- REMOVE ALL PARTITIONS, WALLS AND ATTACHMENTS SHALL BE FULLY DEMOLISHED FROM THE WALL.
- REMOVE ALL PARTITIONS, WALLS AND ATTACHMENTS SHALL BE FULLY DEMOLISHED FROM THE WALL.

SHEET INDEX

- A-1 COVER SHEET
- A-2 EXISTING FLOOR PLAN
- A-3 PROPOSED FLOOR PLAN
- A-4 SITE PLAN
- A-5 EQUIPMENT DETAILS
- A-6 FINISH SCHEDULES

CODE RESEARCH

NUMBER OF STORIES:	
OCCUPANCY:	
CONSTRUCTION TYPE:	
SQUARE FOOTAGE:	
OCCUPANT LOAD:	
HAZARDOUS CONTENTS CLASSIFICATION	
EFFECTIVE CODES:	

ELECTRICAL SYMBOLS

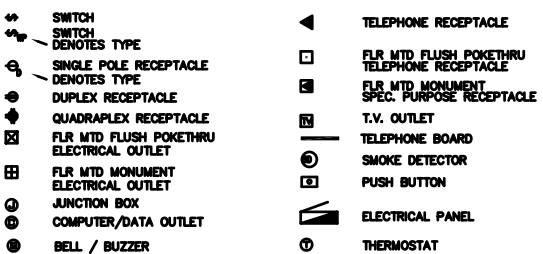

SYMBOL LEGEND

AFF	ABOVE FINISHED FLOOR	NTS	NOT TO SCALE
AL	ALUMINUM	NO	NUMBER
BLDG	BUILDING	OC	ON CENTER
BR	BRASS	OC	ON CENTER
BZ	BRONZE	PL	PLASTIC LAMINATE
C	CARPET	RF	RUBBER FLOORING
CLG	CEILING	REV	REVISION
CONC	CONCRETE	SS	STAINLESS STEEL
CP	COPPER	SO FT	SQUARE FEET
CT	CERAMIC TILE	STL	STEEL
CW	COLD WATER	SUSP	SUSPENDED
DM	DIMENSION	T&G	TONGUE AND GROOVE
DR	DOOR	TYP	TYPICAL
DN	DOWN	UNO	UNLESS NOTED OTHERWISE
DWG	DRAWING	UPH	UPHOLSTERY
EW	ELECTRIC WATER COOLER	VEN	VENEER
FF	FACTORY FINISH	VB	VINYL BASE
FLUR	FLOURESCENT	VF	VINYL FLOORING
FWC	FABRIC WALLCOVERING	VF	VINYL FLOORING
HGT	HEIGHT	VFP	VENEER PANEL
HW	HOT WATER	VVC	VINYL WALLCOVERING
J-BOX	JUNCTION BOX	W	WOOD
LGT	LIGHTING	W/W	WOOD WITH
M	MARBLE	WF	WOOD FLOORING
MFG	MANUFACTURER	WP	WATERPROOF
		WT	WINDOW TREATMENT
		WVC	WOOD WALLCOVERING

7-ELEVEN

32532
 27 WASHINGTON AVE
 PORTLAND, ME 04101

Revisions	
Verify By	
Drawn AS	
Scale	
Date	3/24/10
Sheet	1 of 1
Drawing Number	A-1



- ▨▨▨▨ LOAD BEARING WALLS
 - ▬▬▬▬ NON LOAD BEARING WALLS
 - CD - CLEAN OUT
 - FD - FLOOR DRAIN
 - CD - CONDENSATION DRAIN
 - CL - CONDENSATION LINE
 - VF - WATER FAUCET
 - VS - WATER SUPPLY LINES
 - ⊖ - 110V SIMPLEX
 - ⊕ - 110V DUPLEX
 - ⊕ - 110V QUADRAPLEX
 - ⊕ - 220V SIMPLEX
 - BL - BUILDING LIGHT
 - N - PHONE JACK
 - ⊕ - BLANKED OUTLET
 - TMS - TANK MONITORING SYSTEM
- PROPOSED DRAWING SYMBOLS
- ▲ - EXISTING RELOCATED
 - ⊕ - NEW COUNTER
 - ⊕ - NEW TOP INCLUDING TOP LENGTH
 - ⊕ - NEW EQUIPMENT
 - ⊕ - NEW COMBIBENT SHEET
 - ⊕ - NEW SINK BACKPLASH
 - ⊕ - EQUIPMENT BEING REMOVED

Existing Store Layout

2466-32532-EXISTING

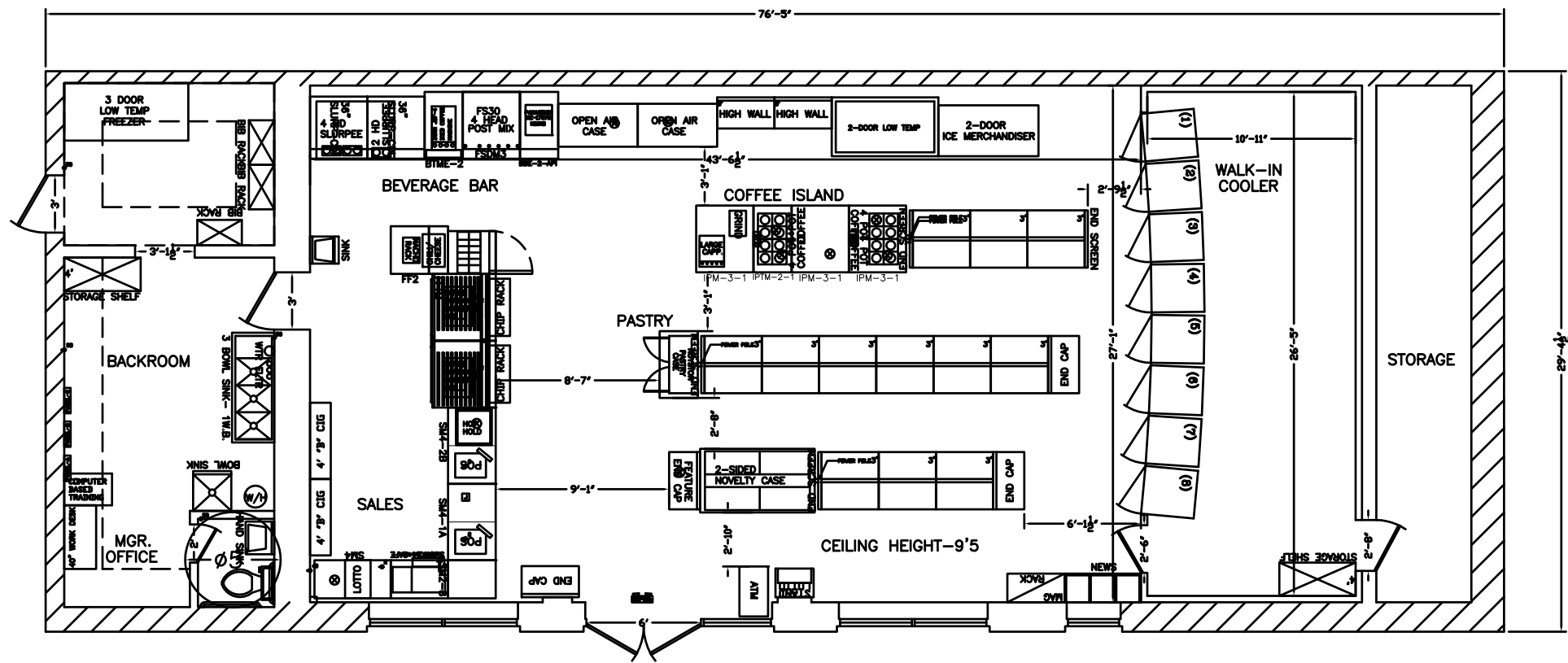

7-ELEVEN AQIP Reinvented

7-ELEVEN

32532
27 WASHINGTON AVENUE
PORTLAND, ME. 04101

Revisions
Verify By FJ
Drawn FJ
Scale 1/8" = 1'-0"
Date 2-17-10
Sheet 1 of 1
ROYSTON
Drawing Number A-2

DISCLAIMER
THIS IS NOT A LEGAL DOCUMENT.
INTENT IS TO SHOW CURRENT
EQUIPMENT CONDITIONS.

- ▨ LOAD BEARING WALLS
- ▨ NON LOAD BEARING WALLS
- - CLEAN OUT
- FJ - FLOOR DRAIN
- CD - CONDENSATION DRAIN
- CL - CONDENSATION LINE
- WF - WATER FAUCET
- WS - WATER SUPPLY LINES
- - 110V SIMPLEX
- - 110V DUPLEX
- - 110V QUADRAPLEX
- - 220V SIMPLEX
- BL - BUILDING LIGHT
- Ⓜ - PHONE JACK
- - BLANKED OUTLET
- TMS - TANK MONITORING SYSTEM
- PROPOSED DRAWING SYMBOLS**
- △ - EXISTING RELOCATED
- ⊙ - NEW COUNTER
- ◇ - NEW TOP INCLUDING TOP LENGTH
- ⊕ - NEW EQUIPMENT
- ⊖ - NEW CONDIMENT SHEETZ
- ⊗ - NEW SINK BACKSPLASH
- ⊘ - EQUIPMENT BEING REMOVED

Proposed Store Layout

2466-32532-PROPOSED

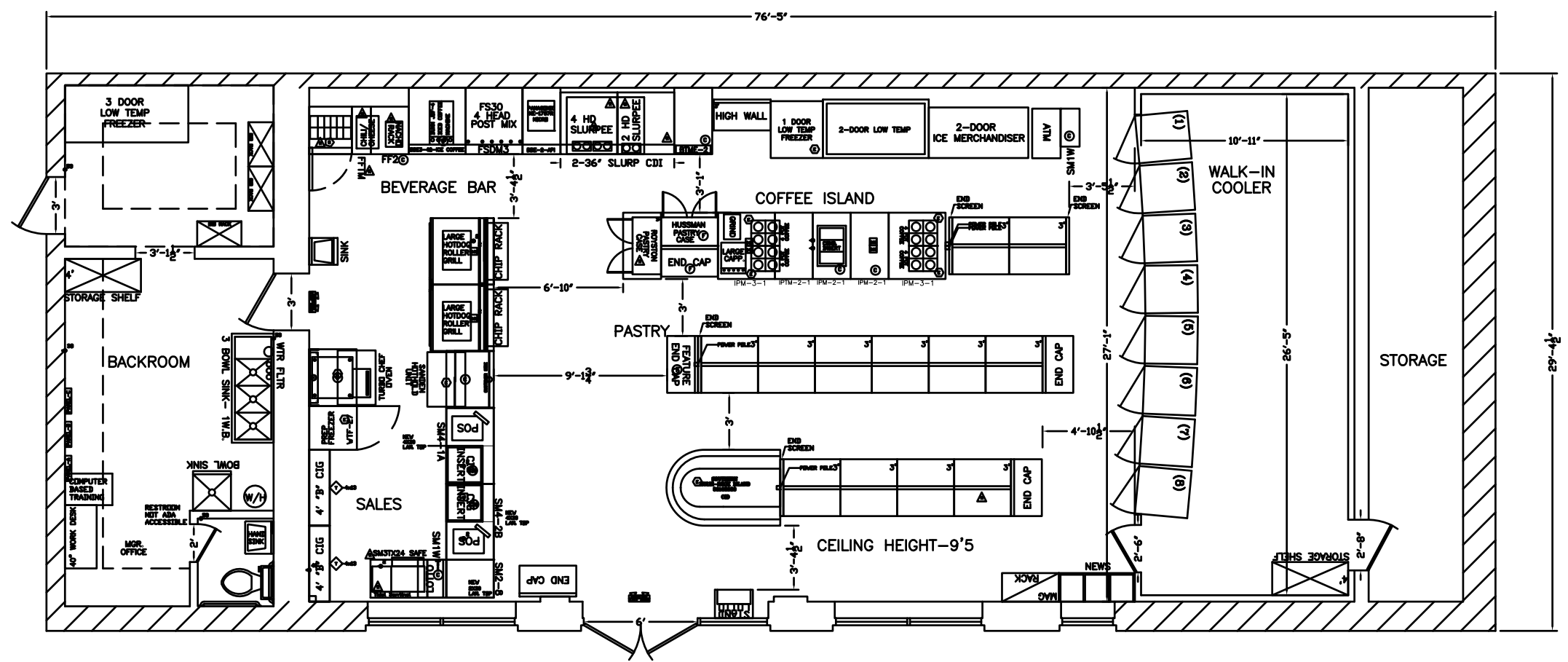

7-ELEVEN AQIP Reinvented

7-ELEVEN

32532
27 WASHINGTON AVENUE
PORTLAND, ME. 04101

Revisions

Verify By
FJ

Drawn
FJ

Scale
1/8" = 1'-0"

Date
2-17-10

Sheet
1 of 1

ROYSTON

Drawing Number

A-3

DISCLAIMER

THIS IS NOT A LEGAL DOCUMENT.
INTENT IS TO SHOW CURRENT
EQUIPMENT CONDITIONS.

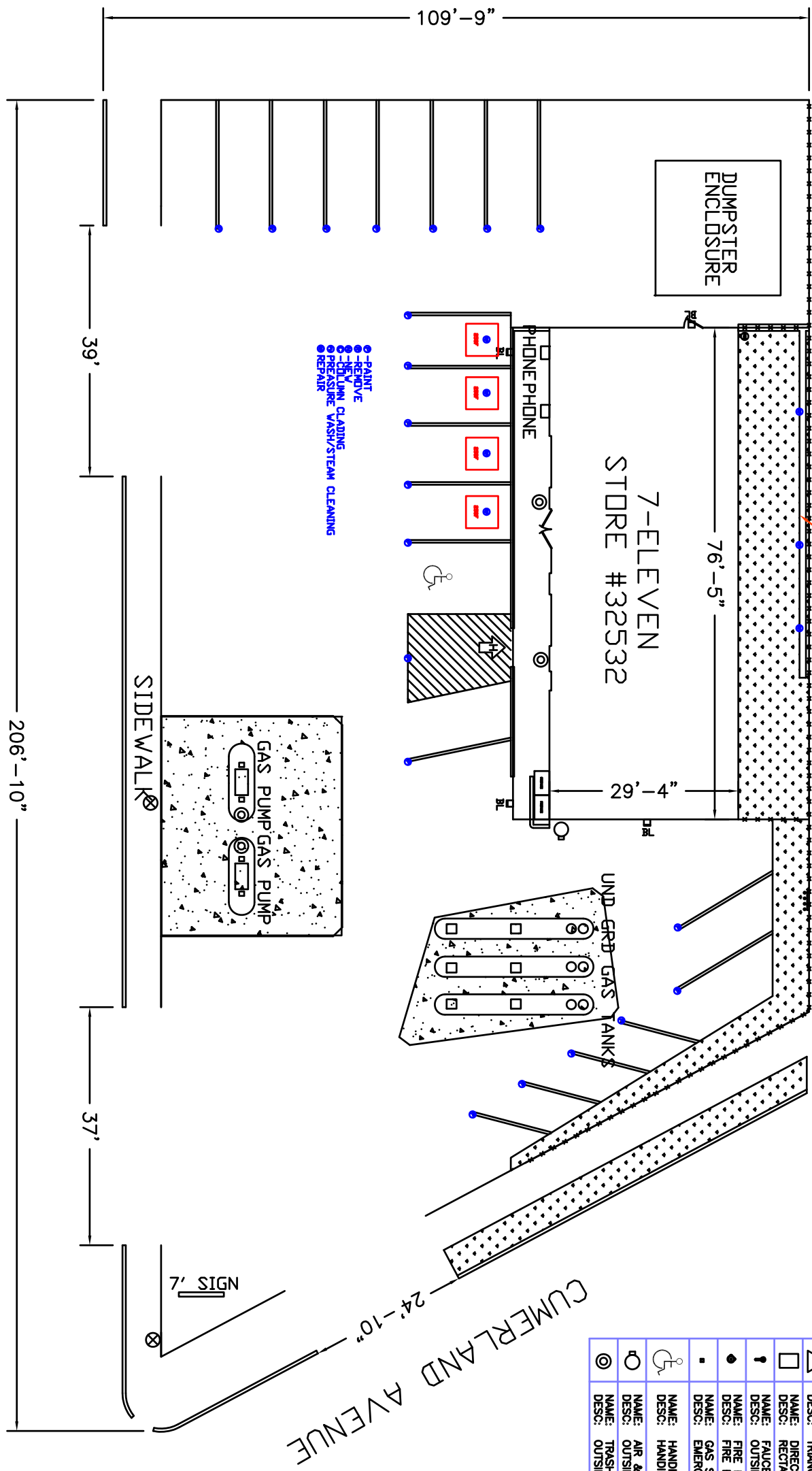
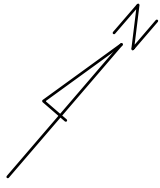

⊕	NAME: OUTSIDE LIGHT-QUAD DESC: OUTSIDE QUADRUPLE LIGHT POLE
⊕	NAME: OUTSIDE LIGHT-TPL DESC: OUTSIDE TRIPLE LIGHT POLE
⊕	NAME: OUTSIDE LIGHT-DBL DESC: OUTSIDE DOUBLE LIGHT POLE
⊕	NAME: OUTSIDE LIGHT-SGL DESC: OUTSIDE SINGLE LIGHT POLE
⊗	NAME: PMR POLE DESC: OUTSIDE POWER POLE FOR POWER WIRES
⊗	NAME: MAN HOLE COVER DESC: COVER FOR MAN HOLES ON PREMISES
⊗	NAME: GAS VENT RISERS DESC: GAS VENT RISERS FOR VENTILATION OF TANKS
⊗	NAME: STOP SIGN DESC: STOP SIGN
△	NAME: TRAFIC SIGN DESC: TRIANGULAR TRAFIC SIGN
□	NAME: DIRECTION SIGN DESC: RECTANGULAR DIRECTIONAL SIGN
⬇	NAME: FAUCET DESC: OUTSIDE FAUCET FOR STORE
⬆	NAME: FIRE HYDRANT DESC: FIRE HYDRANT
⬇	NAME: GAS SHUT OFF DESC: EMERGENCY GAS SHUT OFF SWITCH
♿	NAME: HANDICAP PARKING SYMBOL DESC: HANDICAP PARKING SYMBOL
⊕	NAME: AIR & VAC DESC: OUTSIDE VACUUM AND AIR MODULE
⊕	NAME: TRASH CAN DESC: OUTSIDE CONCRETE TRASH CAN

WASHINGTON AVENUE

CUMBERLAND AVENUE

DISCLAIMER
THIS IS NOT A LEGAL DOCUMENT.
INTENT IS TO ESTIMATE SITE
DIMENSIONS BASED ON VISUAL
INSPECTION AND MEASUREMENTS USING A
MEASURING WHEEL.

Verify By
FJ
Drawn
FJ
Scale
1" = 20'-0"
Date
2/17/2010
Sheet
1 of 1

7-ELEVEN
32532
27 WASHINGTON AVENUE
PORTLAND, ME. 04101

SITE PLAN



Drawing Number
A-4

TRUE TRUE FOOD SERVICE EQUIPMENT, INC.
 St. Charles Industrial Center • P.O. Box 970 • O'Fallon, Missouri 63366
 (636)240-2400 • FAX (636)272-2408 • (800)325-6152 • www.truefg.com
 Parts Dept. (800)424-TRUE • Parts Dept. FAX# (636)272-9471

Model: **TWT-27F** Worktop: **Solid Door Freezer**

Model	Doors	Capacity (Cu. Ft.)	Shelves	Cabinet Dimensions (inches)			HP	Voltage	Amps	NEMA Config.	Cord Length (total ft.)	Crated Weight (lbs.)
				L	D*	H*						
TWT-27F	1	6.5 185	2	27 ⁵ / ₈ 702	30 ¹ / ₈ 766	33 ³ / ₈ 848	1/3 1/2	115/60/1 230-240/50/1	8.3 3.4	5-15P ▲	7 2.13	195 89

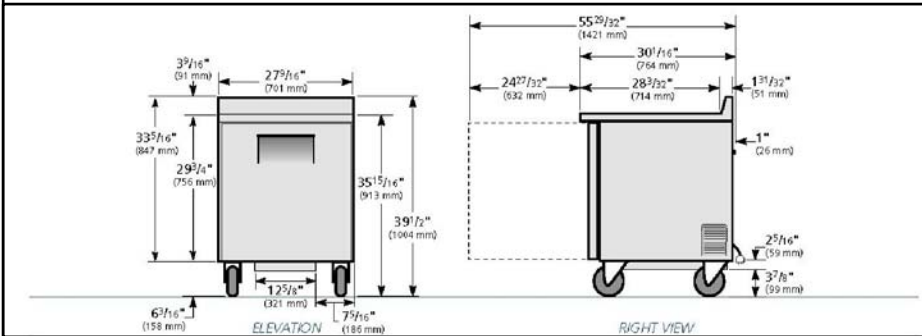

TRUE-UNDER COUNTER FREEZER

SCALE: NTS

TRUE TRUE FOOD SERVICE EQUIPMENT, INC.
 2001 East Terra Lane • P.O. Box 970 • O'Fallon, Missouri 63366
 (636)240-2400 • FAX (636)272-2408 • (800)325-6152 • www.truefg.com
 Parts Dept. (800)424-TRUE • Parts Dept. FAX# (636)272-9471

Model: **TWT-27** Worktop: **Solid Door Refrigerator**

Model	Doors	Capacity (Cu. Ft.)	Shelves	Cabinet Dimensions (inches)			HP	Voltage	Amps	NEMA Config.	Cord Length (total ft.)	Crated Weight (lbs.)
				L	D*	H*						
TWT-27	1	6.5 185	2	27 ⁵ / ₈ 702	30 ¹ / ₈ 766	33 ³ / ₈ 848	1/6 1/4	115/60/1 230-240/50/1	3.9 2.9	5-15P ▲	7 2.13	185 84

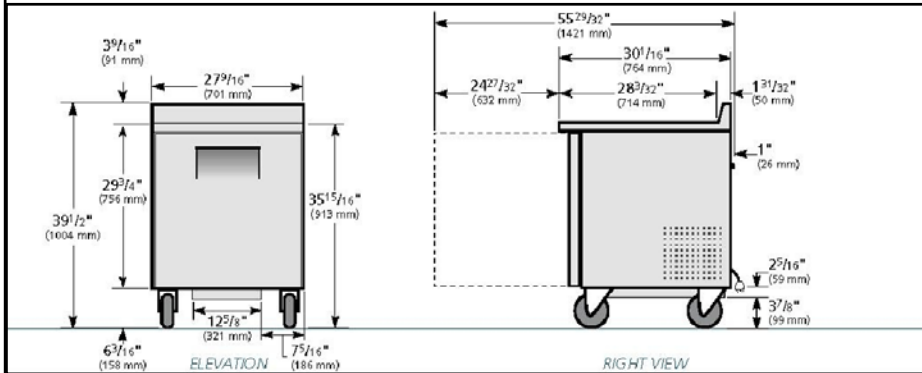

TRUE-UNDER COUNTER REFRIGERATOR

SCALE: NTS

SANDEN

Model Name	CHS-0901WUSE	
Installation Location	Indoor	
Effective Internal Volume	10374.05 cubic inch	
Performance	Ambient 77° F Relative Humidity 60% Air Velocity 0.2m/sec.	
External Dimension (in)	Wide	35.28in
	Depth	19.68in
Weight (lb)	Height	27.56in
		155
Power	115V 50/60Hz	
Power consumption (W)	1006	
Power core length	78in (effective length)	
Attachment	Tray H(4) • Tray L(8) • Net(12) Pop Stand(1)	
Accessory	—	
Shelf allowance volume (lb)	12	

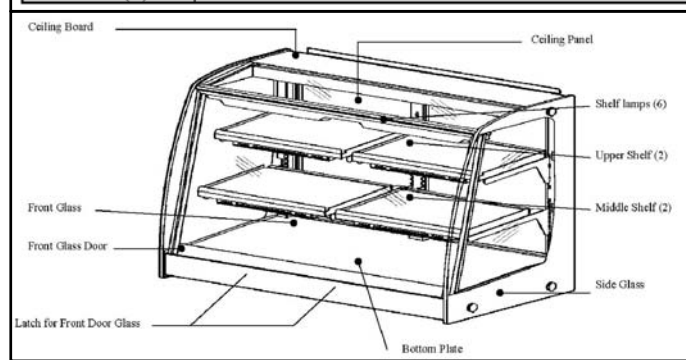

SANDEN-HOT HOLD DISPLAY

SCALE: NTS

ROYSTON

1556 Old Elbert Road
 Royston, GA 30662
 Phone 706-245-6116

**PASTRY UNIT (A)
 MODEL 6445**

Model 10006445 - A Non-Refrigerated 3 Sided Pastry Case with 5 shelves for merchandising, 2 lower shelves for storage, and side bag & box holder. Case is designed to display fresh products that have a fast turnover requiring no refrigeration.

Construction - Welded sheet metal and steel tubing.

Lights - 2 x 20 watt fluorescent light fixture UL/CE listed.

Door closers - Pneumatic door closers with built in hold-open feature.

Finish - Powder coated with a NSF listed powder.

Base - Removable base skirt for cleaning. Unit supported with stainless steel legs.

Electrical - Electrical requirement is 120V/60Hz. Unit has a 5'-0" power cord with a 3 prong grounded plug.

Dimensions - L=42.0", D=24.0", H=61.7"

Certification - Unit is NSF listed.

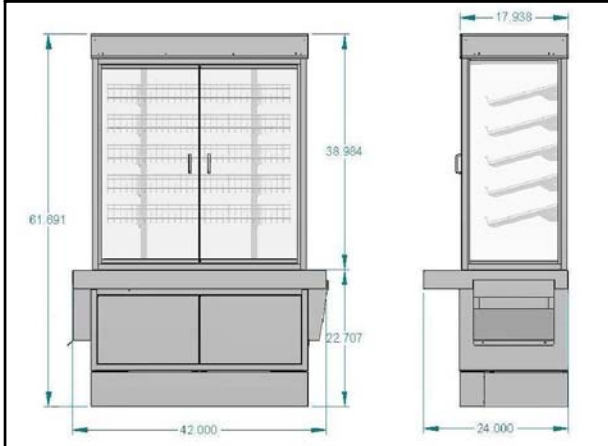

ROYSTON-PASTRY CASE UNIT A

SCALE: NTS

ROYSTON

1556 Old Elbert Road
 Royston, GA 30662
 Phone 706-245-6116

**PASTRY UNIT (B)
 MODEL 6446**

Model 10006446 - A Non-Refrigerated Pastry Case with 5 shelves for merchandising, 2 lower shelves for storage, and a front bag/box holder. Case is designed to display products that have a fast turnover requiring no refrigeration.

Construction - Welded sheet metal and steel tubing.

Lights - 2 x 20 watt fluorescent light fixture UL/CE listed.

Door closers - Pneumatic door closers with built in hold-open feature.

Finish - Powder coated with a NSF listed powder.

Base - Removable base skirt for cleaning. Unit supported with stainless steel legs.

Electrical - Electrical requirement is 120V/60Hz. Unit has a 5'-0" power cord with a 3 prong grounded plug.

Dimensions - L=36.0", D=21.0", H=61.7"

Certification - Unit is NSF listed.

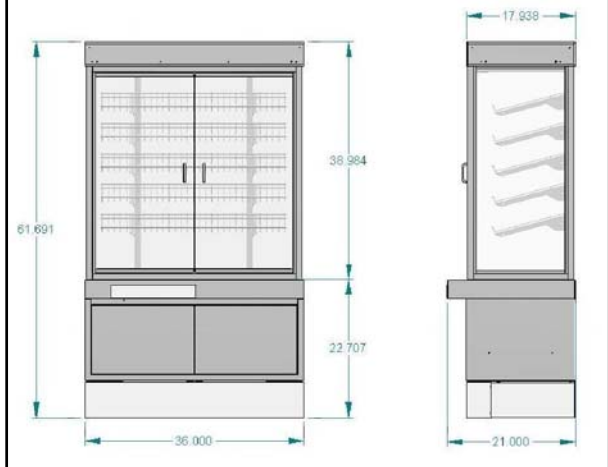

ROYSTON-PASTRY CASE UNIT B

SCALE: NTS

TURBOCHEF

DIMENSIONS
 Single Units (allow +/- .05" (1.27 mm) tolerance)
 Height 19.09" (485 mm)
 on legs 23.03" (585 mm)
 Width 25.9" (659 mm)
 Depth 26.06" (662 mm)
 with handle 28.06" (713 mm)
 Weight 190 lbs. (86 kg)

Stacked Units (allow +/- .05" (1.27 mm) tolerance):
 Stacking Kit optional
 Height 38.18" (970 mm)
 Width 25.9" (659 mm)
 Depth 26.06" (662 mm)
 with handle 28.06" (713 mm)
 Weight 380 lbs. (172 kg)

Cook Chamber
 Height 8" (203 mm)
 Width 15.5" (393 mm)
 Depth 14.7" (373 mm)

Wall Clearance
 Top/Sides 2" (51 mm)
 Back 0" (0 mm)

ELECTRICAL SPECIFICATIONS

North American Markets
 NGC (1 Phase, 60 Hz)
 Operating Voltage 208/240 VAC
 Current Draw 30 amp
 Phase 1 Phase
 Frequency 60 Hz
 Plug NEMA 6-30
 Max Input 5990/6675 watts
 Microwave Input Power 3500 watts

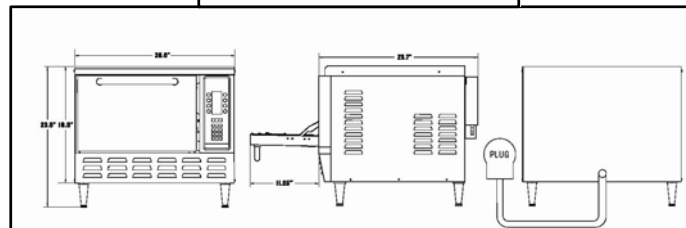

TURBO CHEF-SPEED COOK OVEN

SCALE: NTS

7-ELEVEN AQIP Reinvented

7-ELEVEN

32532

27 WASHINGTON AVE
 PORTLAND, ME 04101

Revisions

Verify By

Drawn AS

Scale

Date 3/24/10

Sheet

1 of 1

ROYSTON

Drawing Number

A-5

SECTION 09660 – RESILIENT FLOORING

SUBMITTALS: WITH MANUFACTURER'S PRODUCT INSTRUCTIONS, SUBMIT THE FOLLOWING:
 SAMPLES OF EACH TYPE, COLOR AND PATTERN OF RESIDENT FLOORING AND ACCESSORIES, FULL SIZE FOR TILE, AND 2-1/2" LONG FOR ACCESSORIES.
 MAINTENANCE INSTRUCTIONS FOR EACH TYPE OF FLOORING.
MANUFACTURERS:
 ARMSTRONG WORLD INDUSTRIES, INC.
 AZROCK COMMERCIAL FLOORING
PRODUCT:
RUBBER WALL BASE: FS SS-W-40, TYPE II, 6" HIGH, 0.0080" GAUGE WITH MATCHING STOPS AND PERFORMED CORNER UNITS, STANDARD TOP-SET COVE, MANUFACTURER: ROPPE, COLOR, REFER TO MATERIAL SCHEDULE ON SHEET A-4.
VINYL EDGE STRIPS: ASTM F1086, COMPOSITION 1, 12" X 12" X 1/8" GAUGE, EQUAL TO ARMSTRONG IMPERIAL MODERN TILE, COLOR REFER TO MATERIAL SCHEDULE ON SHEET A-4.
 COMPOSITION – ASBESTOS FREE
RESILIENT EDGE STRIPS: NOT LESS THAN 1" WIDTH, 1/8" GAUGE, TAPERED BULLNOSE EDGE, COLOR TO MATCH FLOORING OR AS SELECTED BY OWNER.
METAL EDGE STRIPS: EXTRUDED ALUMINUM MILL FINISH, BUTT TYPE FOR CONCEALED ANCHORAGE, SIZE AS SHOWN.
INSTALLATION: COMPLY WITH FLOORING MFR.'S RECOMMENDATIONS OF TYPE (S) OF MATERIALS, PROJECT CONDITIONS AND INTENDED USE.
 CLEAN FLOORS AND APPLY LEVELING COMPOUND AND SUBSTRATE PRIMER IF REQUIRED, IN ACCORDANCE WITH FLOORING MFR.'S INSTRUCTIONS.
 LAY TILE FLOORING FROM CENTER MARKS ESTABLISHED WITH PRINCIPLE WALLS, ADJUST AS REQUIRED TO AVOID USE OF CUT UNITS LESS THAN 1/2 TILE WIDE AT PERIMETERS. MATCH TILES FOR COLOR AND PATTERN BY USING IN MANUFACTURED AND PACKAGED SEQUENCED.
 APPLY WALL BASE IN LENGTHS AS LONG AS PRACTICABLE TO WALLS, COLUMNS AND ALL PERMANENT FIXTURES WHERE INDICATED. MITERED OUTSIDE CORNERS NOT ACCEPTABLE.
 INSTALL RESILIENT EDGE STRIPS AT EDGES OF RESILIENT FLOORING WHICH WOULD OTHERWISE BE EXPOSED.
 INSTALL METAL EDGE STRIPS WHERE INDICATED, USING COUNTERSUNK STAINLESS STEEL ENCHORS.
 CLEAN FLOORS AND ACCESSORIES AFTER INSTALLATION AND APPLYING PROTECTIVE POLISH IN ACCORDANCE WITH FLOORING MFR.'S INSTRUCTIONS.
 END OF SECTION 09660

SECTION 09900 – PAINTING

DESCRIPTION OF WORK: PAINTING AND FINISHING OF INTERIOR AND EXTERIOR ITEMS AND SURFACES, UNLESS OTHERWISE INDICATED.
 INCLUDES FIELD PAINTING OF BORE AND COVERED PIPES AND DUCTS (INCLUDING COLOR CODING), AND HANGERS, EXPOSED STEEL AND IRON WORK, AND PRIMED METAL SURFACES OF EQUIPMENT INSTALLED UNDER MECHANICAL AND ELECTRICAL WORK.
BLOCK SEALER: ON ALL EXTERIOR BLOCK SURFACES USE 2 COATS OF PRIM-A-PELL CLEAR BLOCK SEALER.
EXPOSED INSIDE CONCRETE FLOOR: ALSO USE 2 COATS OF PRIM-A-PELL CLEAR BLOCK SEALER.
 PAINT EXPOSED SURFACES, EXCEPT AS OTHERWISE INDICATED, WHETHER OR NOT COLORS ARE DESIGNATED, COLORS WILL BE SELECTED BY OWNER FROM STANDARD COLOR AVAILABLE FOR THE COATINGS REQUIRED.
WORK NOT INCLUDED: UNLESS OTHERWISE INDICATED, SHOP PAINTING OF FERROUS METAL ITEMS AND FABRICATED COMPONENTS ARE INCLUDED UNDER THE RESPECTIVE TRADES. PRE-FINISHED ITEMS, SUCH AS METAL TOILET PARTITIONS, ACOUSTIC MATERIAL AND THE LIKE, ARE NOT INCLUDED. UNLESS OTHERWISE INDICATED, PAINTING NOT REQUIRED ON SURFACES AND CONCEALED AREAS EXCEPT FOR PIPING, EQUIPMENT AND OTHER SUCH ITEMS WITHIN CONCEALED SPACES. FINISHED METALS SUCH AS ANODIZED ALUMINUM, STAINLESS STEEL, BRONZE AND SIMILAR METALS WILL NOT BE PAINTED. DO NOT PAINT ANY MOVING PARTS OF OPERATION UNITS, OR OVER ANY EQUIPMENT IDENTIFICATION, PERFORMANCE RATING, NAME, NOMENCLATURE PLATES OR CODE-REQUIRED LABELS.
JOB CONDITIONS: DO NOT APPLY PAINT IN SNOW, RAIN, FOG OR MIST OR WHEN RELATIVE HUMIDITY EXCEEDS 85% DO NOT APPLY PAINT TO DAMP OR WET SURFACES.
PROTECTION: PROTECT WORK OF OTHER TRADES. CORRECT ANY PAINTING RELATED DAMAGES BY CLEANING, REPAIRING OR REPLACING AND REFINISHING, AS DIRECTED BY OWNER.
COORDINATION: PROVIDE FINISH COATS WHICH ARE COMPATIBLE WITH PRIME PAINTS USED. PROVIDE BARRIER COATS OVER INCOMPATIBLE PRIMERS WHERE REQUIRED. NOTIFY OWNER IN WRITING OF ANTICIPATED PROBLEMS USING SPECIFIED COATINGS WITH SUBSTRATES PRIMED BY OTHERS.
SURFACE PREPARATION: PERFORMANCE PREPARATION AND CLEANING PROCEDURES IN STRICT ACCORDANCE WITH COATING MFR.'S INSTRUCTIONS FOR EACH SUBSTRATE CONDITION.
 • REMOVE HARDWARE AND ACCESSORIES, MACHINED SURFACES, PLATES, LIGHTING FIXTURES AND SIMILAR ITEMS IN PLACE AND NOT TO BE FINISHED-PAINTED OR PROVIDE SURFACE-APPLIED PROTECTION. REINSTALL REMOVED ITEMS AND REMOVE PROTECTIVE COVERINGS AT COMPLETION OF WORK.
 • SEAL WOOD REQUIRED TO BE JOB-PAINTED, PRIME EDGES, ENDS, FACE, UNDERSIDES AND BACKSIDES OF COUNTERS, CASED, CABINETS, ETC.
 • CLEAN FERROUS SURFACES WHICH ARE GALVANIZED OR SHOP COATED. REMOVE OIL, GREASE, DIRT, LOOSE MILL SCALE AND FOREIGN SUBSTANCES BY SOLVENT OR MECHANICAL CLEANING. TOUCH-UP SHOP APPLIED PRIME COATS WHEREVER DAMAGED.
 • CLEAN GALVANIZED SURFACES FREE OF OIL AND SURFACE CONTAMINANTS WITH NON-PETROLEUM BASED SOLVENT.
MATERIAL PREPARATION: MIX, PREPARE AND STORE PAINTING AND FINISHING MATERIALS IN ACCORDANCE WITH MFR.'S DIRECTIONS.

SECTION 09900 – PAINTING – CONTINUED

PAINT SCHEDULE:

PAINTING SCHEDULE (BENJAMIN-MOORE PAINT)			
APPLICATION	COLOR	FINISH	VEHICLE
EXTERIOR DOORS, FRAMES, GRAVEL GUARDS, AND LIGHT POLES	BRONZETONE No. 16360 No. 16362	SEMI-GLOSS	ALKYD
INTERIOR DOORS AND FRAMES	BEIGE No. 226	SEMI-GLOSS	LATEX ENAMEL
INTERIOR GYPSUM BOARD SURFACES	BEIGE No. 226	SEMI-GLOSS	LATEX ENAMEL
INTERIOR MILLWORK	BEIGE No. 133-2A OY-2X14 BK6, O6-6 OY-16 WH-4X	GLOSS	ALKYD ENAMEL

PAINT FORMULA'S:
PAINT MANUFACTURER: (UNLESS SPECIFIED OTHERWISE)
 BENJAMIN MOORE & COMPANY
FORMULA 1: EXTERIOR FERROUS (NON-GALVANIZED) METAL SURFACES.
 1. PREPARATION: SOLVENT CLEAN SURFACES. REMOVE LOOSE PAINT AND RUST.
 2.FINISHING:
 1ST COAT: PRIMER 163.
 2ND & 3RD COATS: SEMI-GLOSS 071-ALKYD.
 (NOTE: OMIT FIRST COAT ON SURFACES ALREADY PRIME PAINTED. SPOT PRIME AS REQUIRED.)
FORMULA 2: EXTERIOR GALVANIZED SURFACES; (DOORS, FRAMES, GRAVEL GUARD, FLASHING, POLES AND PERIMETER LIGHTS.
 1. PREPARATION: WASH SURFACES WITH XYLOL OR MINERAL SPIRITS.
 2.FINISHING:
 1ST COAT: GALVANIZED METAL PRIMER 155.
 2ND & 3RD COATS: SEMI-GLOSS 071-ALKYD.
FORMULA 3: INTERIOR FERROUS (NON-GALVANIZED STEEL) METAL SURFACES:
 1. PREPARATION: SOLVENT CLEAN SURFACES. POWER TOOL CLEAN.
 2.FINISHING:
 1ST COAT: METAL PRIMER 163.
 2ND & 3RD COATS: AQUA GLO SEMI-GLOSS No. 333
 (NOTE: OMIT FIRST COAT ON SURFACES ALREADY PRIME PAINTED. SPOT PRIME AS REQUIRED.)
FORMULA 4: INTERIOR GALVANIZED STEEL SURFACES:
 1. PREPARATION: WASH SURFACES WITH MINERAL SPIRITS.
 2.FINISHING:
 1ST COAT: GALVANIZED METAL PRIMER 155.
 2ND & 3RD COATS: AQUA GLO SEMI-GLOSS No. 333
FORMULA 5: GYPSUM WALLBOARD:
 1. PREPARATION: GYPSUM WALLBOARD: APPLY PROKO CO. VINYL SAND FINISH IN MEDIUM SAND FINISH TEXTURE AS APPROVED BY ARCHITECT/OWNER.
 2. LATEX SEMI-GLOSS FINISH:
 1ST COAT: PRIMER SEAL 201.
 2ND & 3RD COATS: SEMI-GLOSS AQUA GLO 333
FORMULA 6: INTERIOR WOOD DOORS AND FRAMES:
 1. PREPARATION: CLEAN, FILL, PATCH, SAND, WASH SURFACES WITH XYOLO OR MINERAL SPIRITS.
 2. LATEX ENAMEL SEMI-GLOSS FINISH:
 1ST COAT: LATEX ENAMEL UNDERBODY No. 345
 2ND & 3RD COATS: AQUA GLO SEMI-GLOSS No. 333
FORMULA 7: PAINTED MILLWORK:
 1. PREPARATION: CLEAN, FILL, PATCH, SAND, WASH SURFACES WITH XYOLO OR MINERAL SPIRITS.
 2. LATEX ENAMEL SEMI-GLOSS FINISH:
 1ST COAT: LATEX ENAMEL UNDERBODY No. 345
 2ND & 3RD COATS: AQUA GLO SEMI-GLOSS No. 333
APPLICATION: APPLY PAINTING AND FINISHING MATERIALS IN ACCORDANCE WITH MANUFACTURER'S WRITTEN SYSTEMS SPECIFICATIONS. USE APPLICATORS AND TECHNIQUES BEST SUITED FOR MATERIALS AND SURFACE TO WHICH APPLIED.
 APPLY ADDITIONAL COAT WHEN UNDERCOATS, STAINS OR OTHER CONDITIONS SHOW THROUGH FINAL PAINT COAT UNTIL PAINT FILM IS OF UNIFORM FINISH, COLOR AND APPEARANCE.
 PAINT SURFACES BEHIND MOVABLE EQUIPMENT AND FURNITURE SAME AS SIMILAR EXPOSED SURFACES. PAINT SURFACES BEHIND PERMANENTLY FIXED FURNITURE WITH PRIME COAT ONLY BEFORE EQUIPMENT IS INSTALLED.

SECTION 09900 – PAINTING – CONTINUED

PAINT INTERIOR SURFACES OF DUCTS, WHERE VISIBLE THROUGH REGISTERS OR GRILLES, FLAT, NON-SPECULAR BLOCK.
 PAINT BACK SIDES OF ACCESS PANELS, AND REMOVABLE OR HINGED COVERS TO MATCH EXPOSED SURFACES.
 FINISH EXTERIOR DOORS ON TOPS, BOTTOMS, AND EDGES SAME AS EXTERIOR FACES, UNLESS OTHERWISE INDICATED.
 SAND LIGHTLY BETWEEN SUCCEEDING ENAMEL OR VARNISH COATS.
 OMIT FIRST COAT (PRIMER) ON METAL SURFACES WHICH HAVE BEEN SHOP-PRIMED AND TOUCH-UP PAINTED, UNLESS OTHERWISE SPECIFIED.
 APPLY PRIME COAT TO MATERIAL WHICH IS TO BE PAINTED OR FINISHED, AND WHICH HAS NOT BEEN PRIME COATED BY OTHERS.
 APPLY EACH MATERIAL AT NOT LESS THAN MANUFACTURER'S RECOMMENDATION SPREADING RATE, TO PROVIDE A TOTAL DRY FILM TO THICKNESS NOT LESS THAN 4.0 MILS FOR ENTIRE COATING SYSTEM OF PRIME AND FINISH COATS FOR 3-COAT WORK.
COMPLETED WORK: MATCH APPROVED SAMPLES FOR COLOR, TEXTURE AND COVERAGE. REMOVE, REFINISH OR REPAINT WORK NOT IN COMPLIANCE WITH SPECIFIED REQUIREMENTS.
 END OF SECTION 09900

SECTION 10800 – TOILET ACCESSORIES

SUBMITTALS: MANUFACTURER'S DATA AND INSTALLATION INSTRUCTIONS.
 MANUFACTURERS OFFERING PRODUCTS TO COMPLY WITH REQUIREMENTS FOR GENERAL TOILET ACCESSORIES INCLUDE THE FOLLOWING:
 AMERICAN SPECIALTIES, INC.
 AMERICAN DISPENSER CO., INC.
 BOBRICK WASHROOM EQUIPMENT, INC.
 THE CHARLES PARKER COMPANY.
GENERAL: PROVIDE TOILET ACCESSORIES AS SCHEDULED BELOW. SCHEDULE IS BASED ON AMERICAN SPECIALTIES, INC.
MATERIALS:
STAINLESS STEEL: AISI TYPE 302/304, WITH POLISHED No. 4 FINISH, 22 GAUGE MIN., UNLESS OTHERWISE INDICATED.
GALVANIZED STEEL MOUNTING DEVICES: ASTM A386, HOT DIPPED GALVANIZED AFTER FABRICATION.
FASTENERS: SCREWS, BOLTS, AND OTHER DEVICES OF SAME MATERIAL AS ACCESSORY UNIT OR OF GALVANIZED STEEL WHERE CONCEALED.
FABRICATION:
GENERAL: STAMPED NAMES OR LABELS ON EXPOSED FACES OF TOILETS ACCESSORY UNITS ARE NOT PERMITTED. WHERE EVER LOCKS ARE REQUIRED FOR PARTICULAR TYPE OF ACCESSORY, PROVIDE SAME KEYING THROUGHOUT PROJECT. FURNISH TWO KEYS FOR EACH LOCK, PROPERLY IDENTIFIED.
SURFACE-MOUNTED ACCESSORIES: FABRICATE UNITS WITH TIGHT SEAMS AND JOINTS, EXPOSED EDGES ROLLED. HANG DOORS OR ACCESS PANELS WITH CONTINUOUS PIANO HINGE OR MIN. OF TWO 1-1/2" PIN HINGES AS SAME METAL AS UNIT CABINET. PROVIDE CONCEALED ANCHORAGE WHERE EVER POSSIBLE.
PAPER TOWELS DISPENSER: MODEL NO. ASI-0210; SURFACE MOUNTED. FABRICATED OF STAINLESS STEEL WITH HINGED FRONT EQUIPPED WITH TUMBLER LOCKSET AND SPRING LATCH BOLT. PROVIDE PIERCED SLOTS OF SIDES AS REFILL INDICATOR.
CAPACITY: NOT LESS THAN EITHER 300C-FOLD OR 400 MULTIFOLD PAPER TOWELS.
WASTE RECEPTACLES: FOR CODE COMPLIANCE. WASTE RECEPTACLES TO BE PROVIDED BY 7-ELEVEN CORPORATION.
TOILET TISSUE DISPENSERS: MODEL NO ASI-0715 DOUBLE-ROLL, SIZE TO ACCOMMODATE TWO SEPARATE ROLLS OF CORE TYPE TISSUE TO 5" DIAMETER. FABRICATED WITH SPINDLESS CHROME-PLATED STEEL CONSTRUCTION WITH TENSION SPRING DELIVERY CONTROL; DESIGNED FOR SURFACE MOUNTING, SELF-LOCKING DEVICE EXTENDS THROUGH CORE AND PREVENTS REMOVAL OF CORE UNTIL ROLL IS COMPLETELY EMPTY.
GRAB BARS (GB BR): ASI-V3500P SERIES.
STAINLESS STEEL TYPE: PROVIDE GRAB BARS WITH WALL THICKNESS NOT LESS THAN 18 GAUGE AND AS FOLLOWS:
MOUNTING: EXPOSED.
GRIPPING SURFACES: NON-SLIP, POLISHED FINISH.
BAR SIZE: OUTSIDE DIAMETER 1-1/2".
 LENGTH: (1) 36", TYPE-01
 (1) 42", TYPE-02
MIRROR: CHANNEL FRAME ASI-0620, 18 X 30. FRAME 1/2" X 1/2" X 1/2" 20 GAUGE TYPE 304L STAINLESS CHANNEL. MIRROR IS INSTALLED ON TWO WALL BRACKETS AND HELD SECURE BY TAMPER-PROOF SCREW ON BOTTOM OF UNIT.
INSTALLATION:
GENERAL: INSTALL TOILET ACCESSORY UNITS IN ACCORDANCE WITH MANUFACTURER'S INSTRUCTIONS, USING FASTENERS APPROPRIATE TO SUBSTRATE AND RECOMMEND BY MANUFACTURER OF UNIT. INSTALL UNIT PLUMB AND LEVEL, FIRMLY ANCHORED IN LOCATIONS INDICATED. INSTALLATION SHALL CONFORM TO A.D.A. REQUIREMENTS.
 ADJUST TOILET ACCESSORIES FOR PROPER OPERATION AND VERIFY THAT MECHANISMS FUNCTION SMOOTHLY.
 CLEAN AND POLISH ALL EXPOSED SURFACES AFTER REMOVING PROTECTIVE COATINGS.
 END OF SECTION 10800

7-ELEVEN AQIP Reinvented

7-ELEVEN

32532
 27 WASHINGTON AVE
 PORTLAND, ME 04101

Revisions

Verify By

Drawn AS

Scale

Date 3/24/10

Sheet

1 of 1

ROYSTON

Drawing Number

A-6