

PLAN REFERENCES:

- EXISTING CONDITIONS FROM PLAN ENTITLED "EXISTING CONDITIONS SURVEY", DATED OCTOBER 12, 2016 FROM SEBAGO TECHNICS.
- BUILDING LAYOUT FROM CAD FILE ENTITLED "1. ARCHITECTURAL SITE PLAN".

NOTE:

- FOUNDATION DRAINAGE/PUMP DESIGN BY OTHERS.

REV.	DESCRIPTION	DATE
1.	REVISED PER CITY COMMENTS	1/17/17
2.	REVISED PER CITY COMMENTS	3/8/17
3.	REVISED PER CITY COMMENTS	4/4/17
4.	REVISED PER CITY COMMENTS	7/10/17

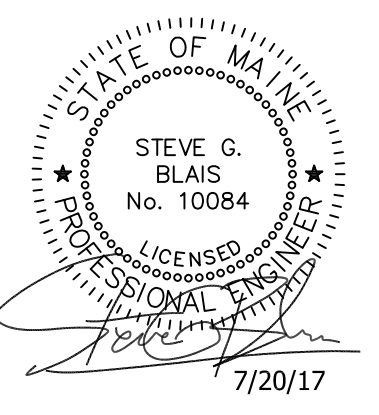

GRADING & UTILITY PLAN
221 CONGRESS STREET
PORTLAND, MAINE 04101

DRAWING: PROJECT:

ISSUED DATE: 7/10/17
DESIGNED BY: JDY
DRAWN BY: DRH
CHECKED BY: SGB
PROJECT NUMBER: 16123

C-104

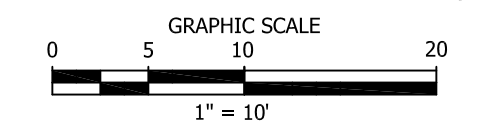
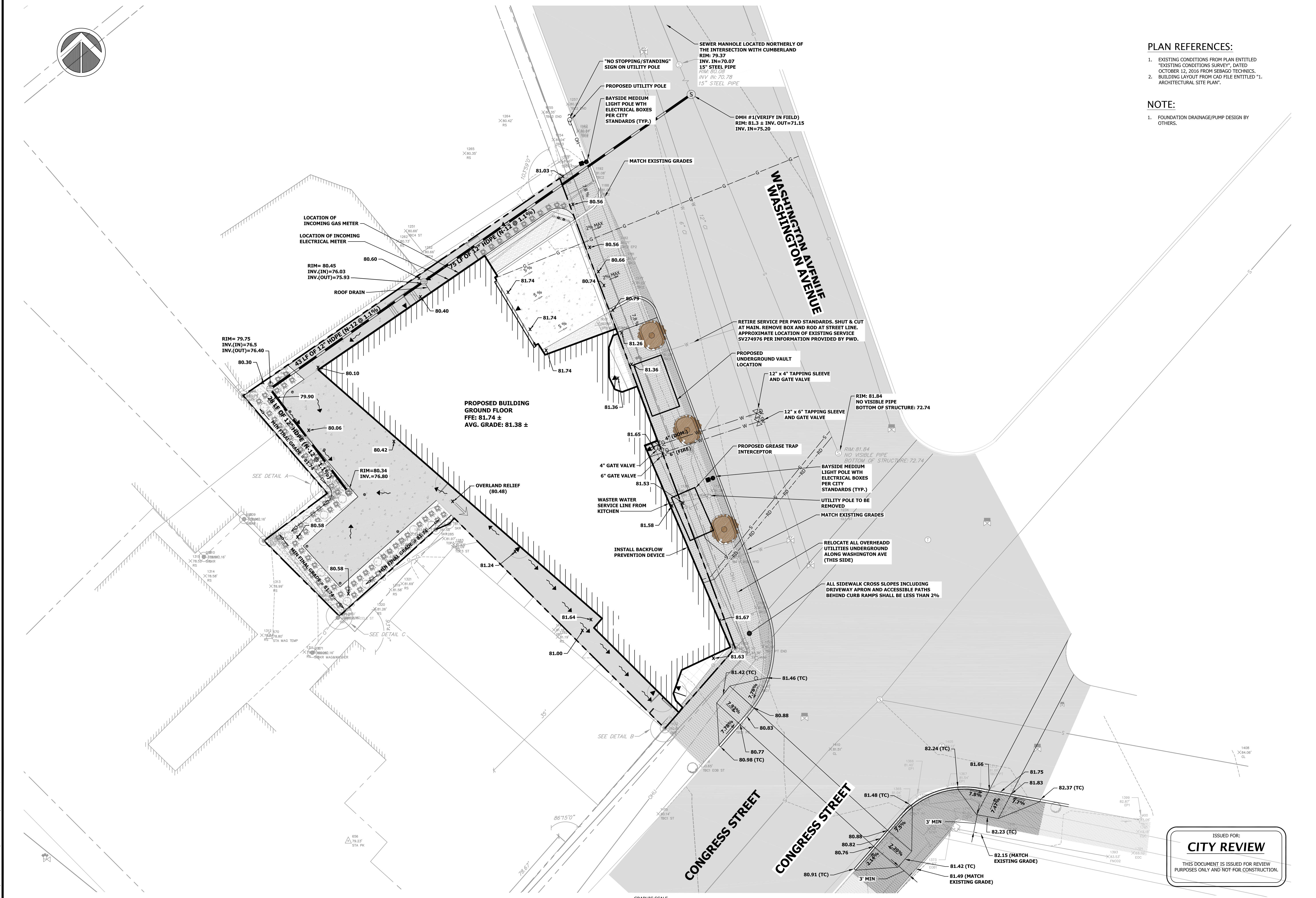

ISSUED FOR:
CITY REVIEW
THIS DOCUMENT IS ISSUED FOR REVIEW PURPOSES ONLY AND NOT FOR CONSTRUCTION.

2016 Project 16123 221 Congress St., Portland, ME 04101. Drawing: 16123-04 Grading & Utility Plan. Date: 7/10/17.