

INTERSECTION IMPROVEMENTS
221 CONGRESS STREET
221 CONGRESS STREET
PORTLAND, MAINE 04101

DRAWING: PROJECT:
ISSUED DATE: 3/8/17
DESIGNED BY: JDY
DRAWN BY: DRH
CHECKED BY: SGB
PROJECT NUMBER: 16123

C-401

PROPOSED SIGNAL HEADS:

NOTES:

- EXISTING SIGNAL EQUIPMENT NOT REMAINING OR BEING RE-USED SHALL BE REMOVED AND DELIVERED TO THE CITY OF PORTLAND.
- INTENT IS TO RE-USE EXISTING PEDESTRIAN COUNTDOWN INDICATORS AND INSTALL NEW PEDESTRIAN PUSH BUTTONS MEETING CITY OF PORTLAND SPECIFICATIONS.
- CONTRACTOR TO COORDINATE WITH CITY OF PORTLAND AND ALL UTILITIES TO CONFIRM LOCATIONS AND POTENTIAL CONFLICTS PRIOR TO CONSTRUCTION.
- CONTRACTOR SHALL PERFORM SIGNAL WORK IN A MANNER THAT WILL CAUSE MINIMUM DISRUPTION TO EXISTING TRAFFIC PATTERNS. EXISTING TRAFFIC SIGNAL PROGRAMMING TO REMAIN.
- CONTRACTOR TO REMOVE ANY CONFLICTING SIGNAGE AND MARKINGS.

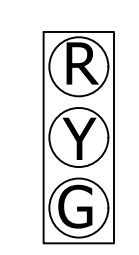

ALL INDICATIONS SHALL BE 12" L.E.D WITH 5" BACKPLATE WITH REFLECTORIZED BANDING PER CITY OF PORTLAND SPECIFICATIONS.

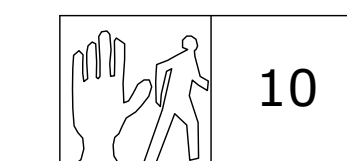

PEDESTRIAN CROSSING SIGNAL

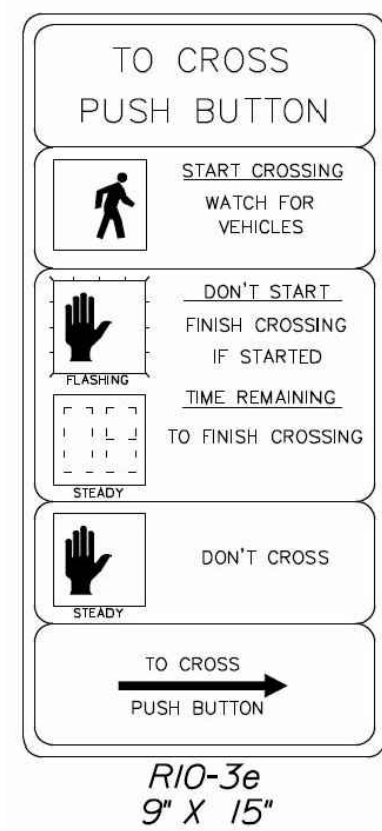

1 PEDESTRIAN SIGNAL PHASE SIGNS
NOT TO SCALE

- LEGEND**
- 3-BALL SECTION 12" LED SIGNAL HEAD
 - PROPOSED CROSSWALK
 - 8' PEDESTAL POLE WITH PEDESTRIAN INDICATION & PUSH BUTTON
 - 12" X 12" ELECTRICAL JUNCTION BOX
 - UNDERGROUND ELECTRIC
 - 35' MAST ARM ON NEW FOUNDATION
 - EXISTING CURB

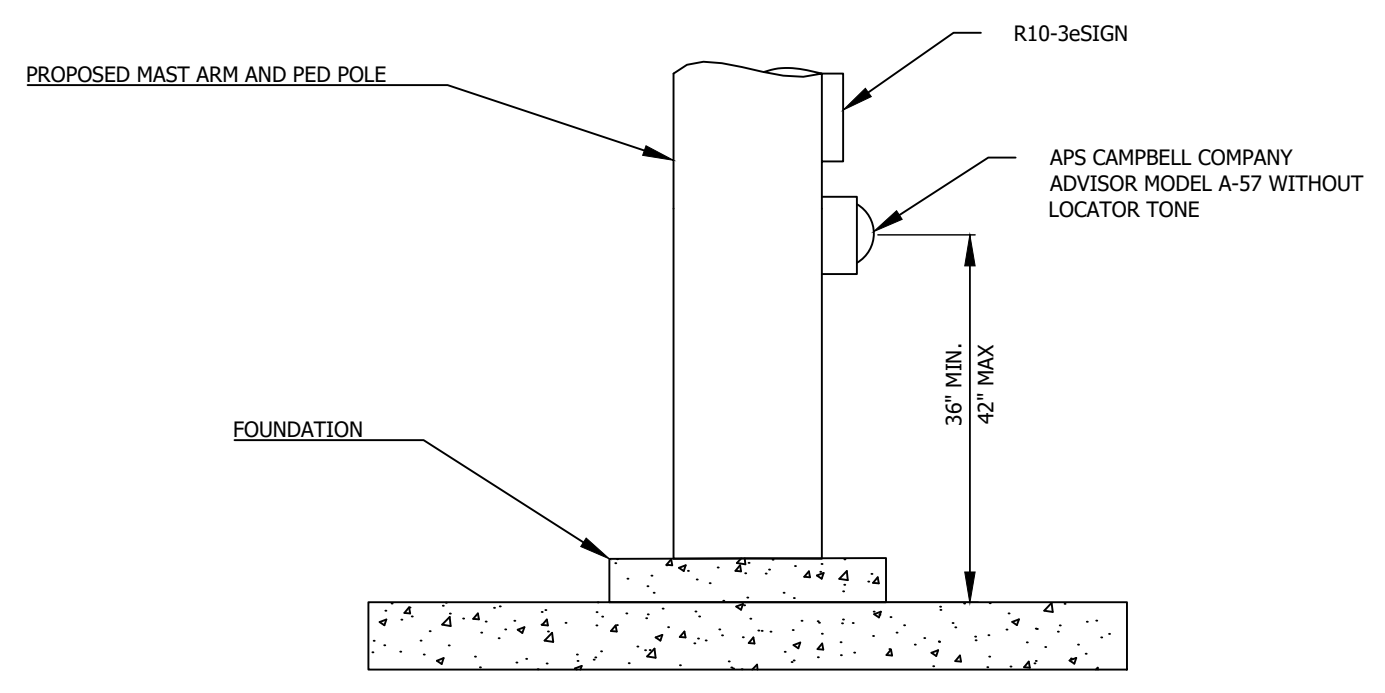

2 APS PUSH BUTTON ASSEMBLY MAST ARM MOUNTED DETAIL
NOT TO SCALE

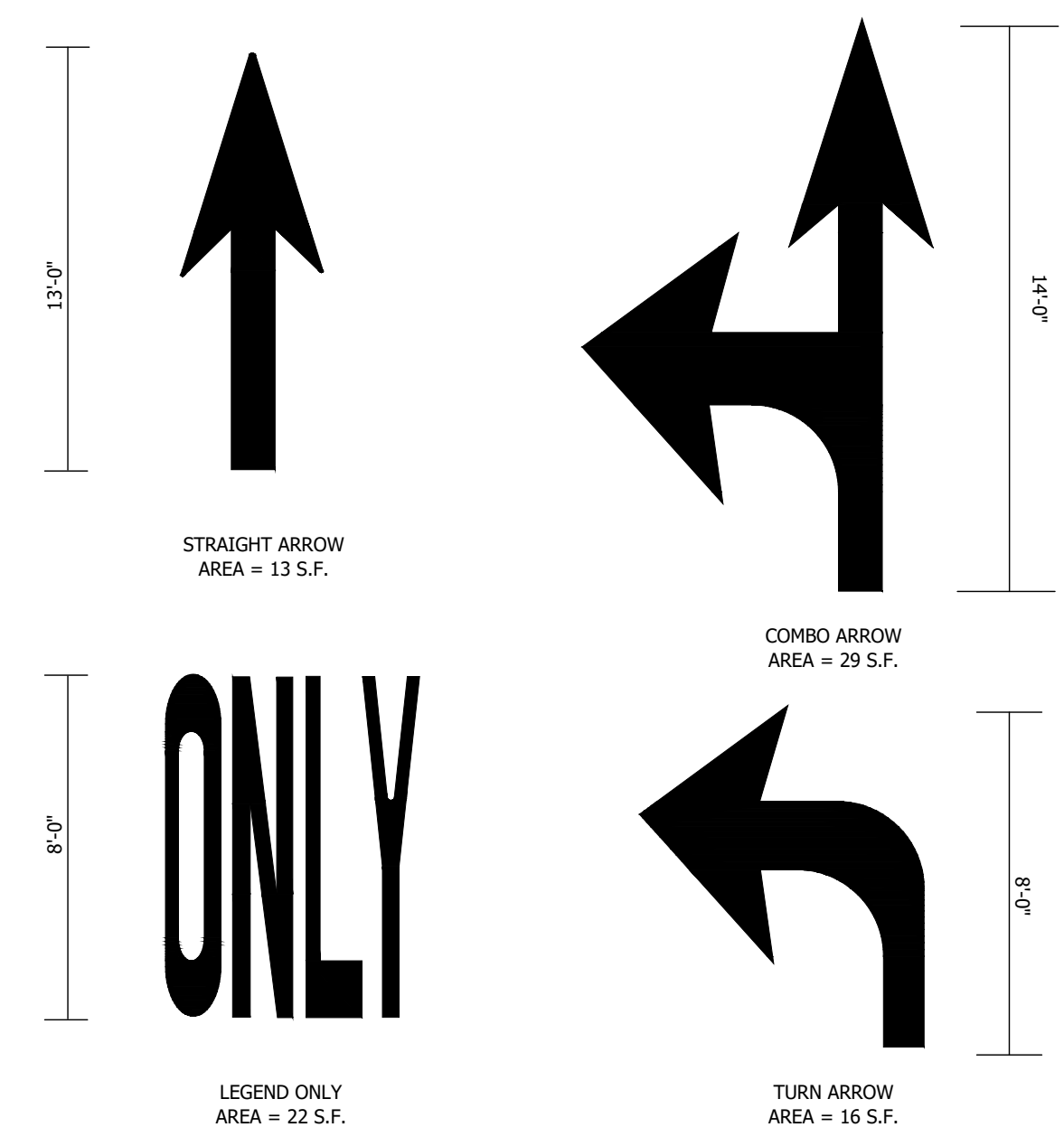

3 TRAFFIC PAVEMENT MARKINGS
NOT TO SCALE

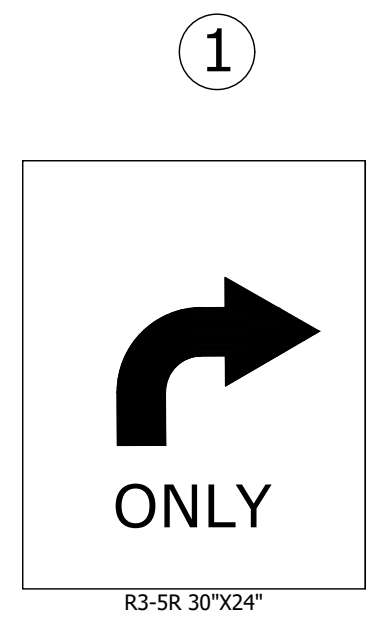

5 MAST ARM SIGNS
NOT TO SCALE

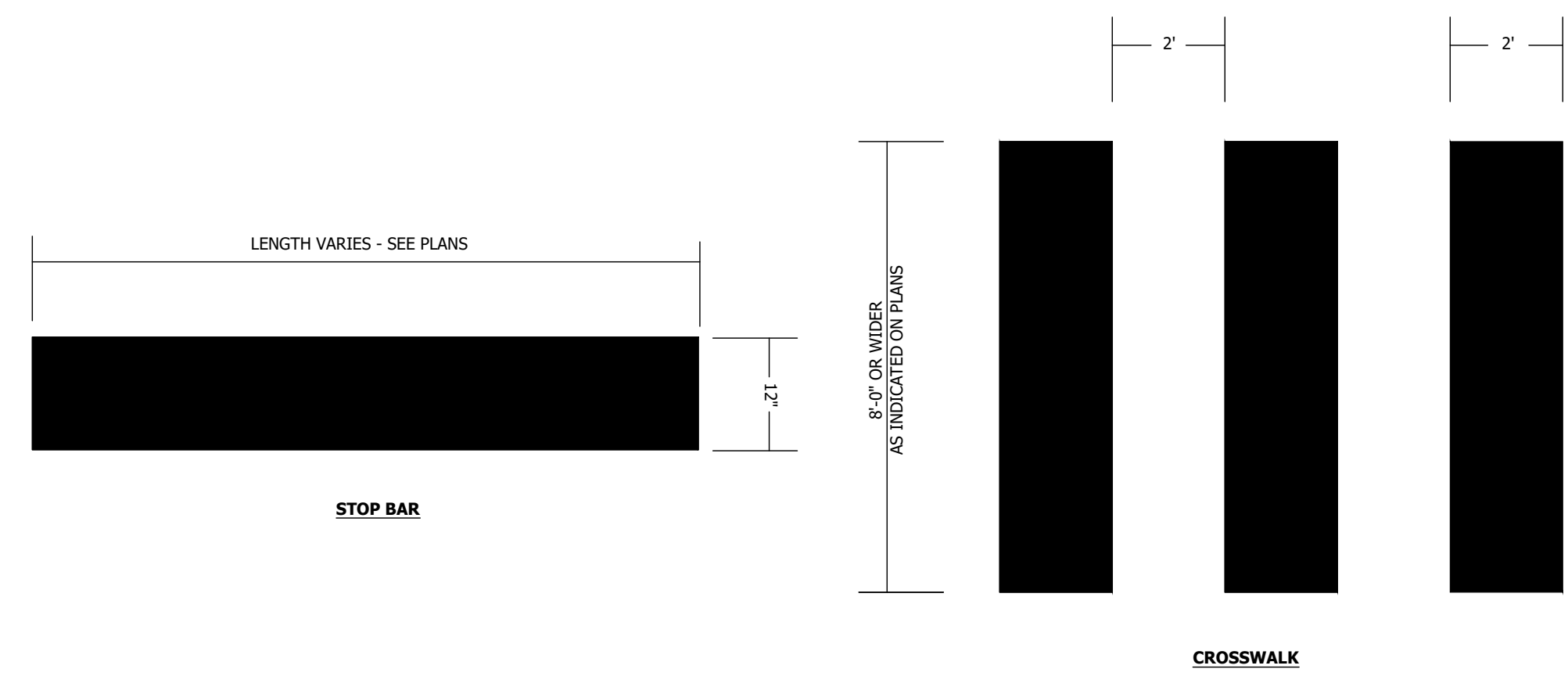

6 PEDESTRIAN PAVEMENT MARKINGS
NOT TO SCALE

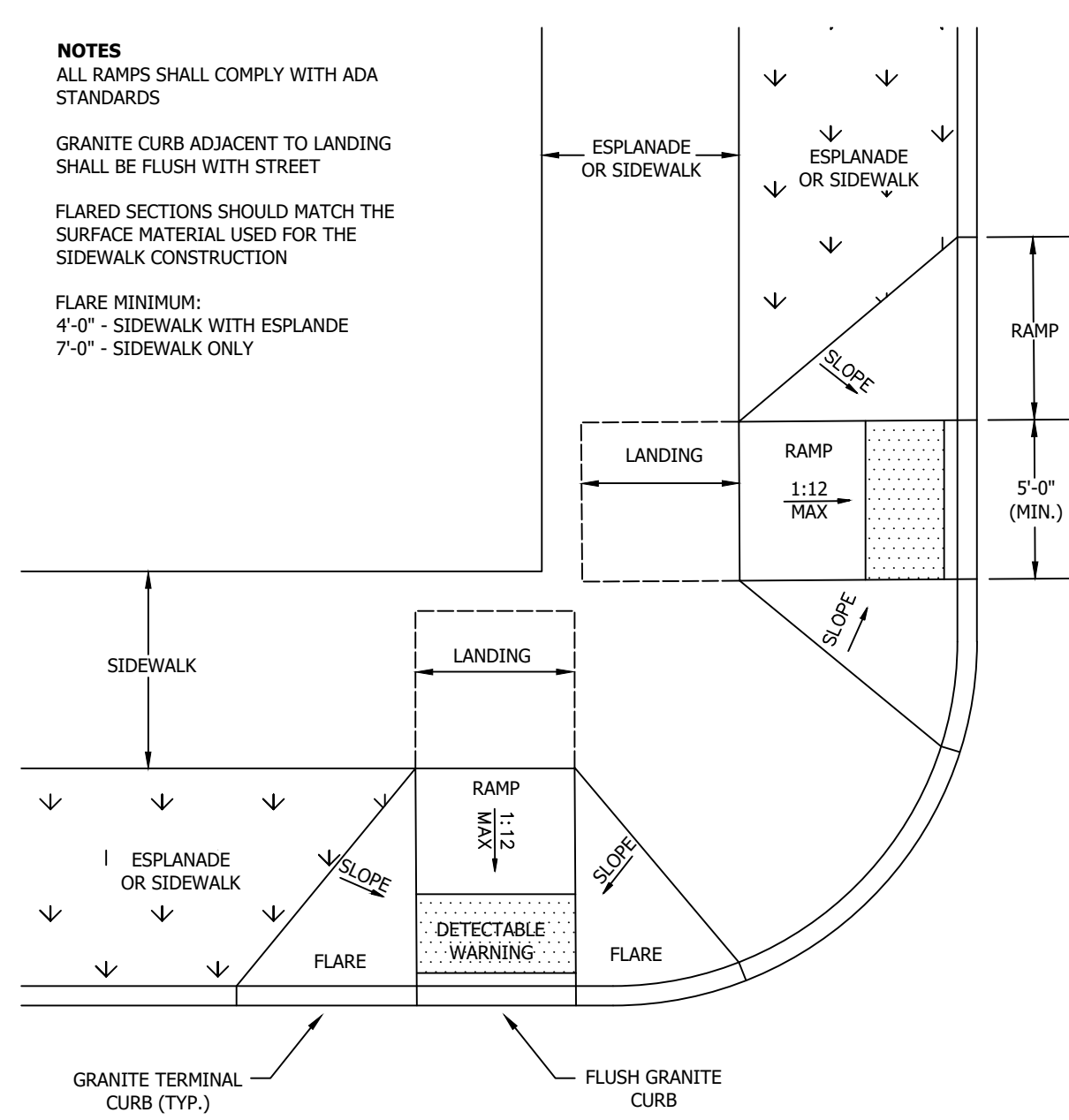

4 DIAGONAL SIDEWALK RAMP LAYOUT AT INTERSECTION
NOT TO SCALE

- NOTES**
- ALL RAMP SHALL COMPLY WITH ADA STANDARDS
 - GRANITE CURB ADJACENT TO LANDING SHALL BE FLUSH WITH STREET
 - FLARED SECTIONS SHOULD MATCH THE SURFACE MATERIAL USED FOR THE SIDEWALK CONSTRUCTION
 - FLARE MINIMUM:
4'-0" - SIDEWALK WITH ESPLANADE
7'-0" - SIDEWALK ONLY

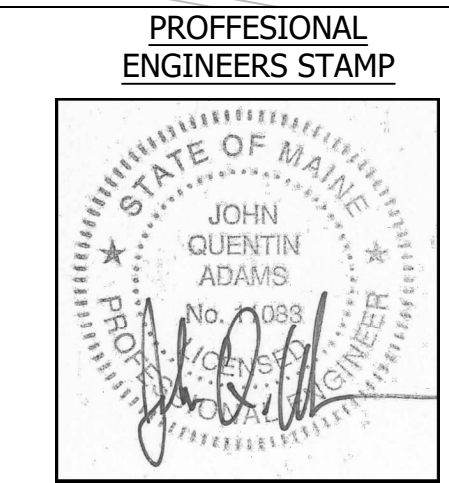
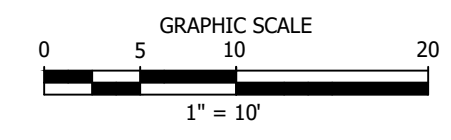
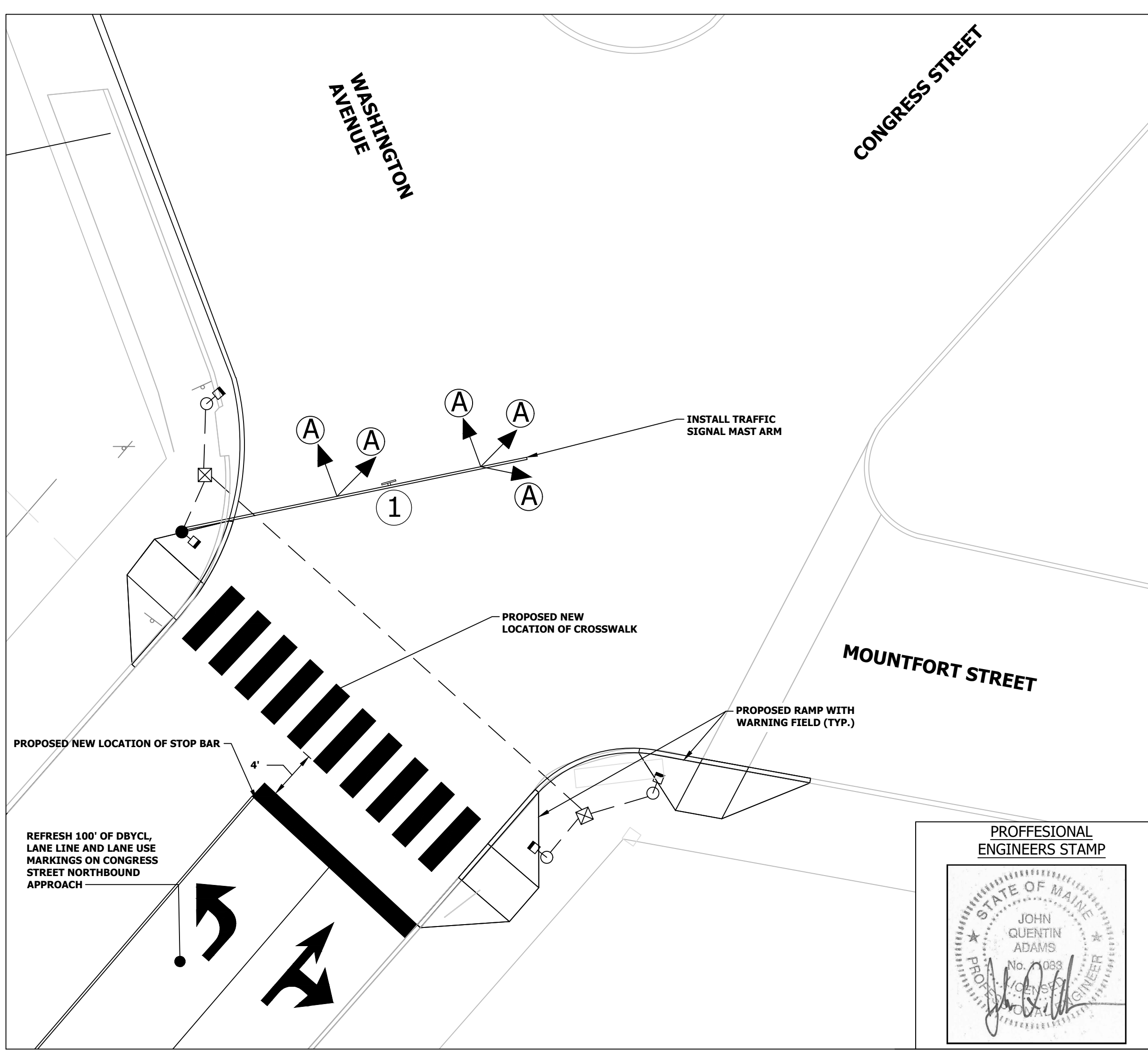

C:\Users\jquaden\OneDrive\Documents\20170308_16123\221 CONGRESS STREET IMPROVEMENTS\221 CONGRESS STREET IMPROVEMENTS.dwg, 2/21/2017, 10:23 AM