

REV.	DESCRIPTION	DATE
1.	REVISED PER CITY COMMENTS	1/17/17
2.	REVISED PER CITY COMMENTS	3/8/17
3.	REVISED PER CITY COMMENTS	4/4/17
4.	REVISED PER CITY COMMENTS	7/10/17

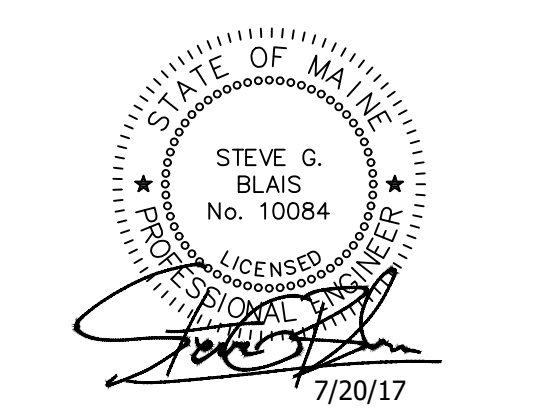

NOTE:
BORDER COURSE OF BRICK SHALL BE
MORTARED TO PAVEMENT BASE.

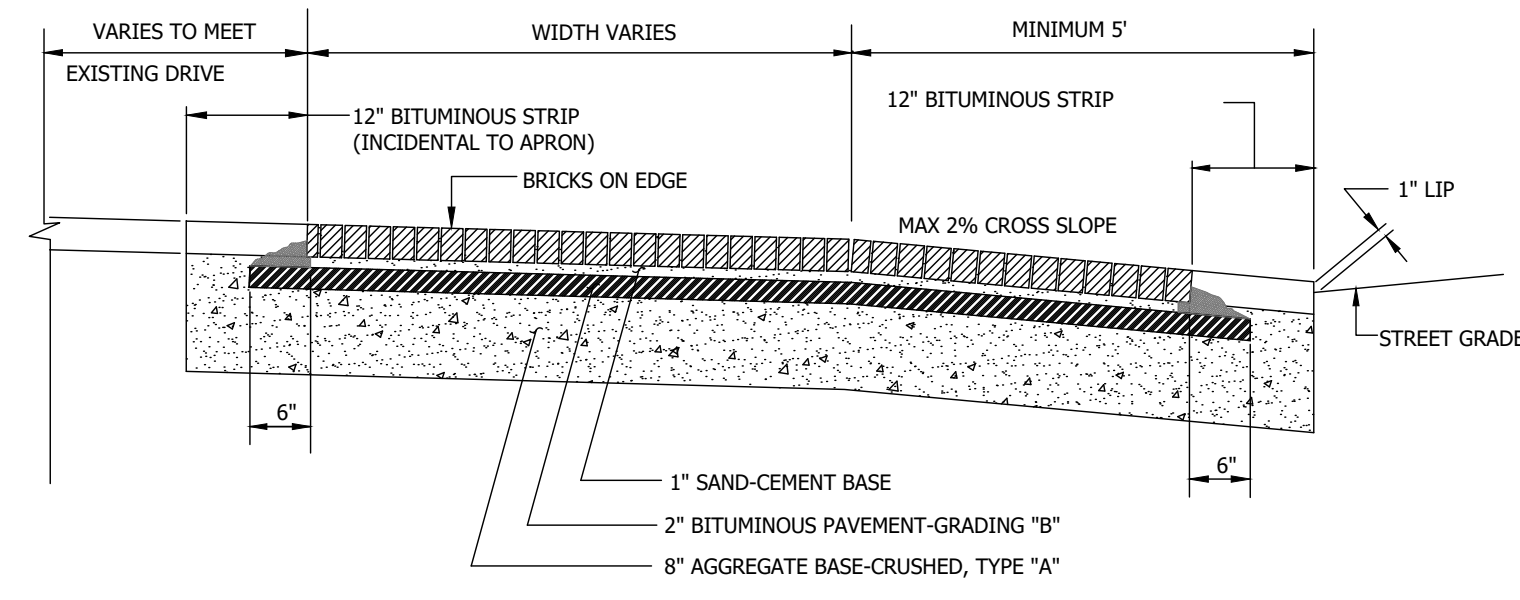

1 BRICK DRIVEWAY APRON
NOT TO SCALE

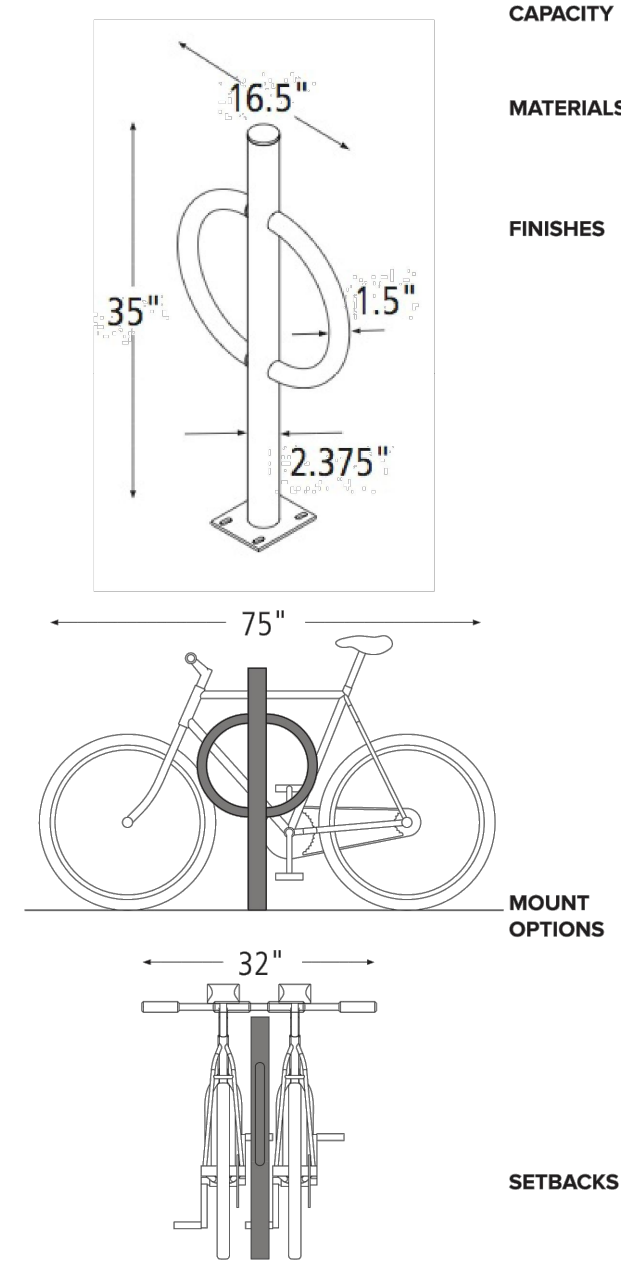

4 DERO "BIKE HITCH STYLE" BIKE RACK
NOT TO SCALE

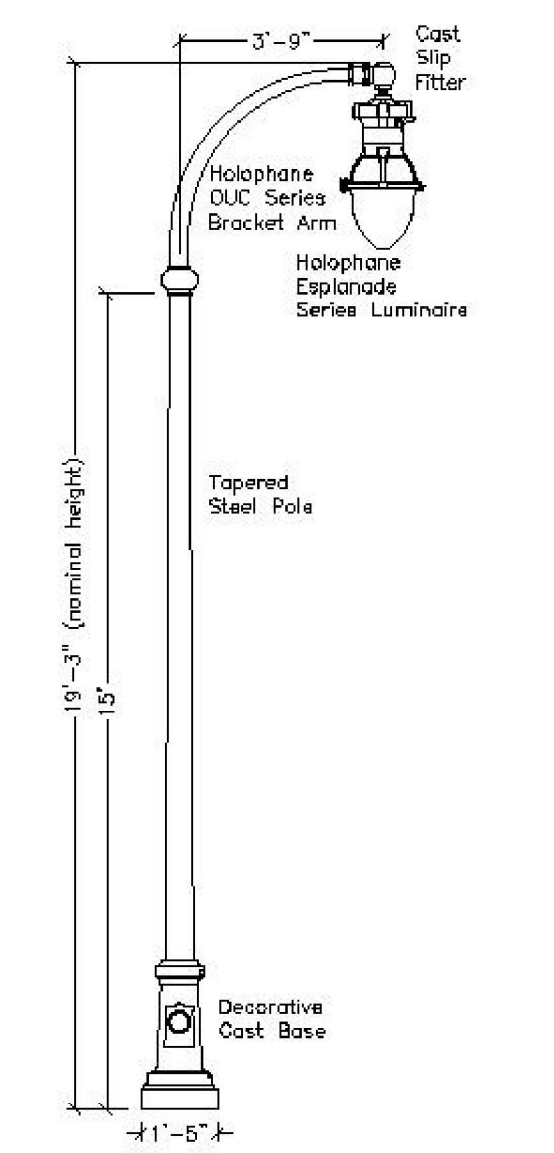

6 BAYSIDE MEDIUM SCALE RESIDENTIAL LIGHT
NOT TO SCALE

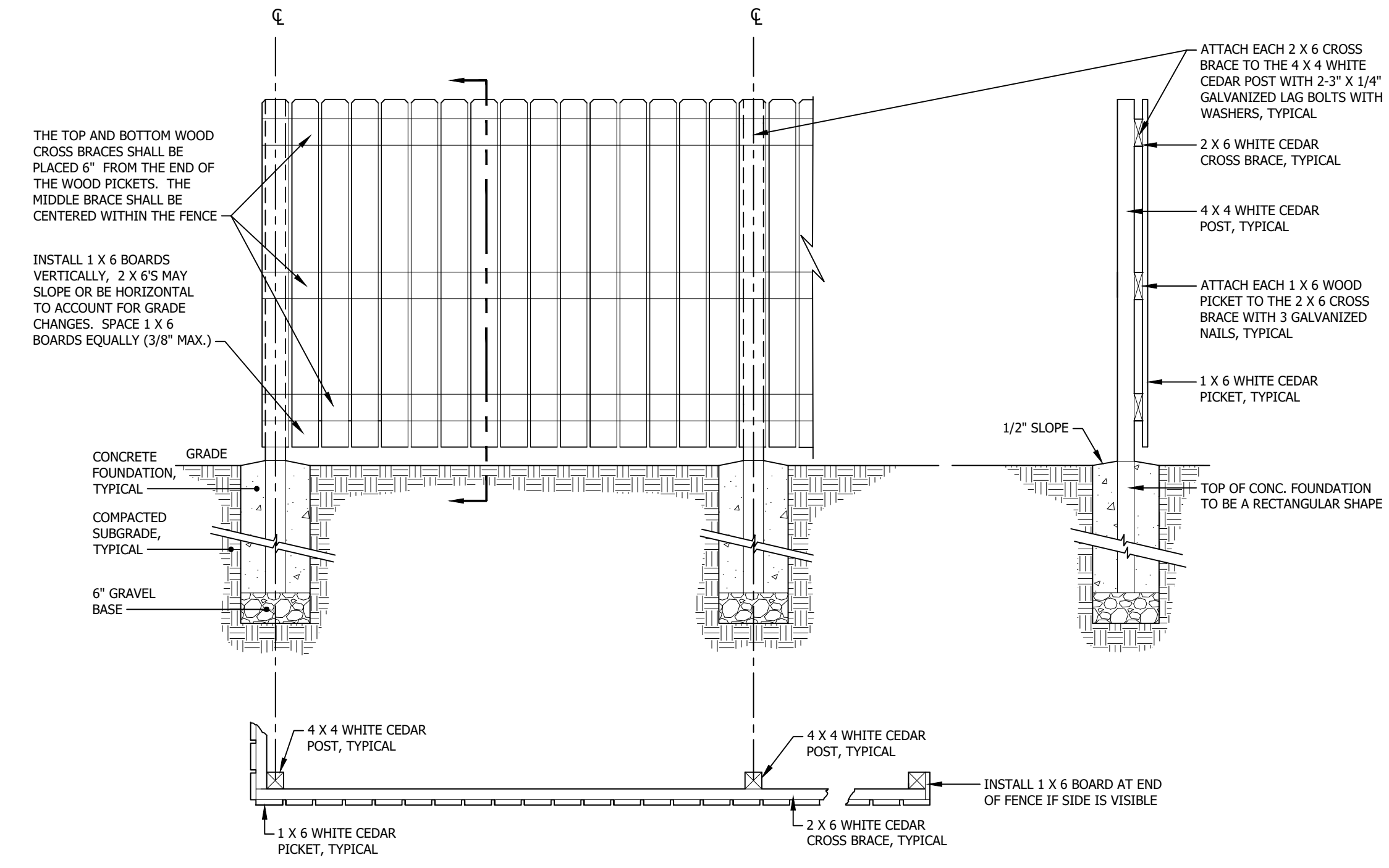

2 WOOD FENCE/ ENCLOSURE DETAIL
NOT TO SCALE

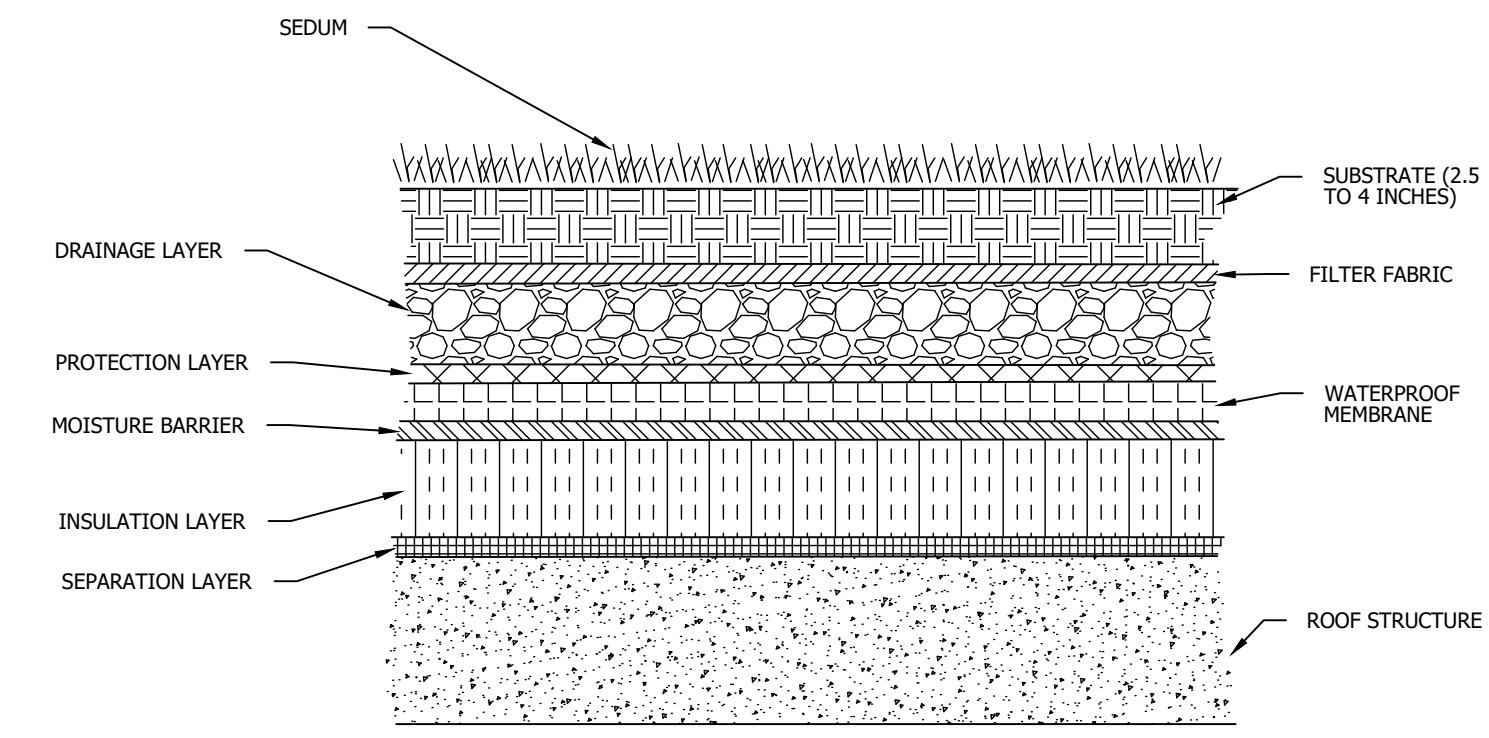

5 VEGETATED ROOF CROSS SECTION
NOT TO SCALE

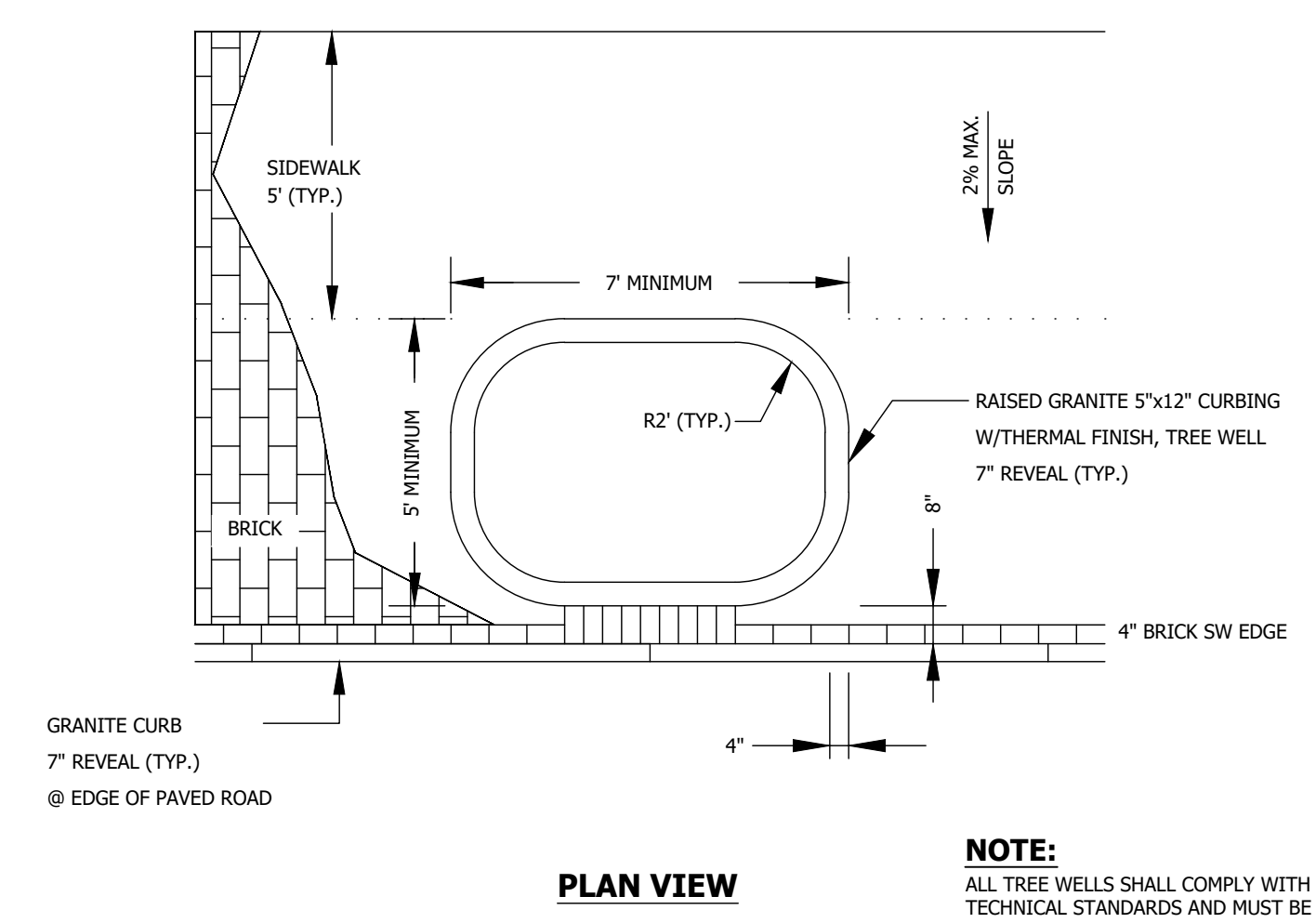

7 TREE WELL IN BRICK SIDEWALK
NOT TO SCALE

NOTE:
ALL TREE WELLS SHALL COMPLY WITH CITY
TECHNICAL STANDARDS AND MUST BE
APPROVED BY THE CITY ARBORIST.

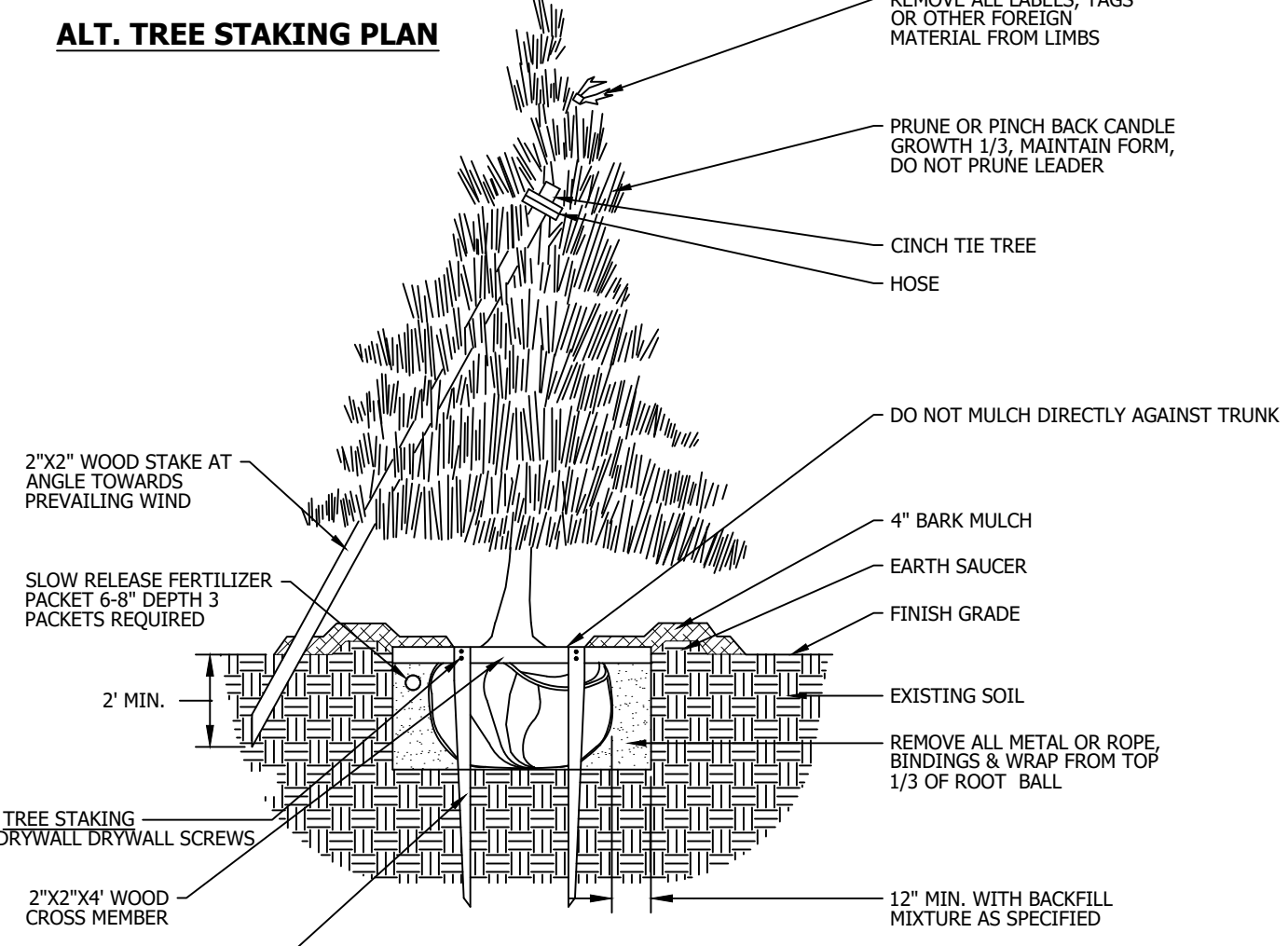
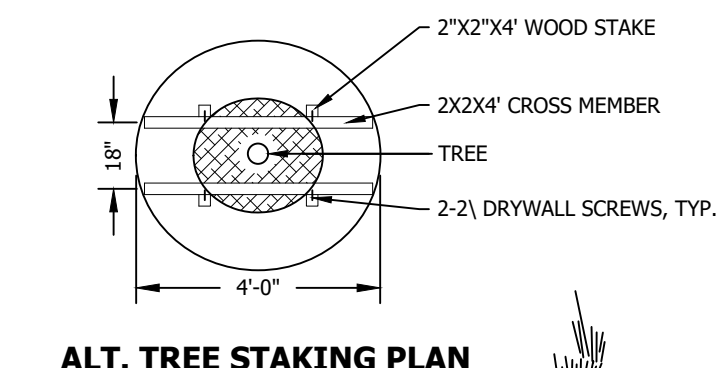

**9 DECIDUOUS TREES UNDER 2\"/>

NOT TO SCALE**

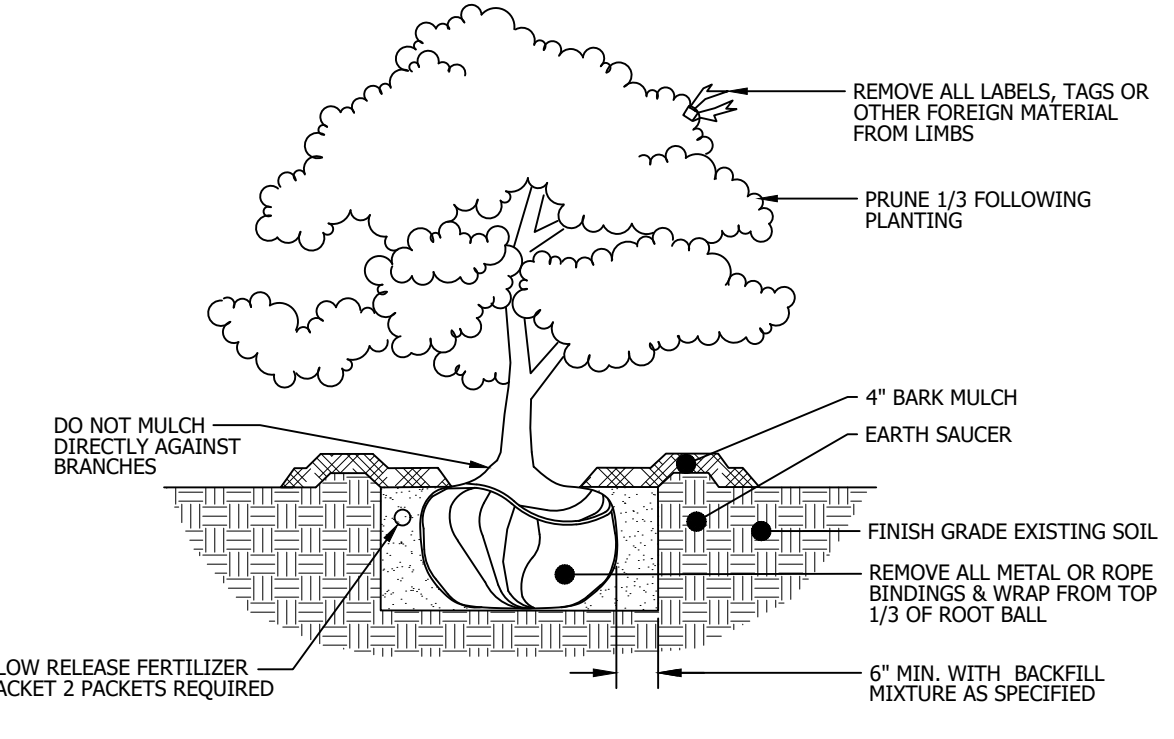

8 DECIDUOUS & EVERGREEN SHRUB DETAIL
NOT TO SCALE

SITE DETAILS II
221 CONGRESS STREET
221 CONGRESS STREET
PORTLAND, MAINE 04101

DRAWING:
PROJECT:

ISSUED DATE: 7/10/17
DESIGNED BY: JDY
DRAWN BY: DRH
CHECKED BY: SGB
PROJECT NUMBER: 16123

C-302