

HYDRAULIC DESIGN DATA	
System # & Area	#1 - #2
No. of Sprinklers	4
Density	0.05 GPM
Designed Area	4 SPRINKS
Hose Allowance	N/A
Water Flow Rate	54 GPM
Residual Pressure at Base of Riser	58 PSI
Safety Factor at Base of Riser	2221 PSI

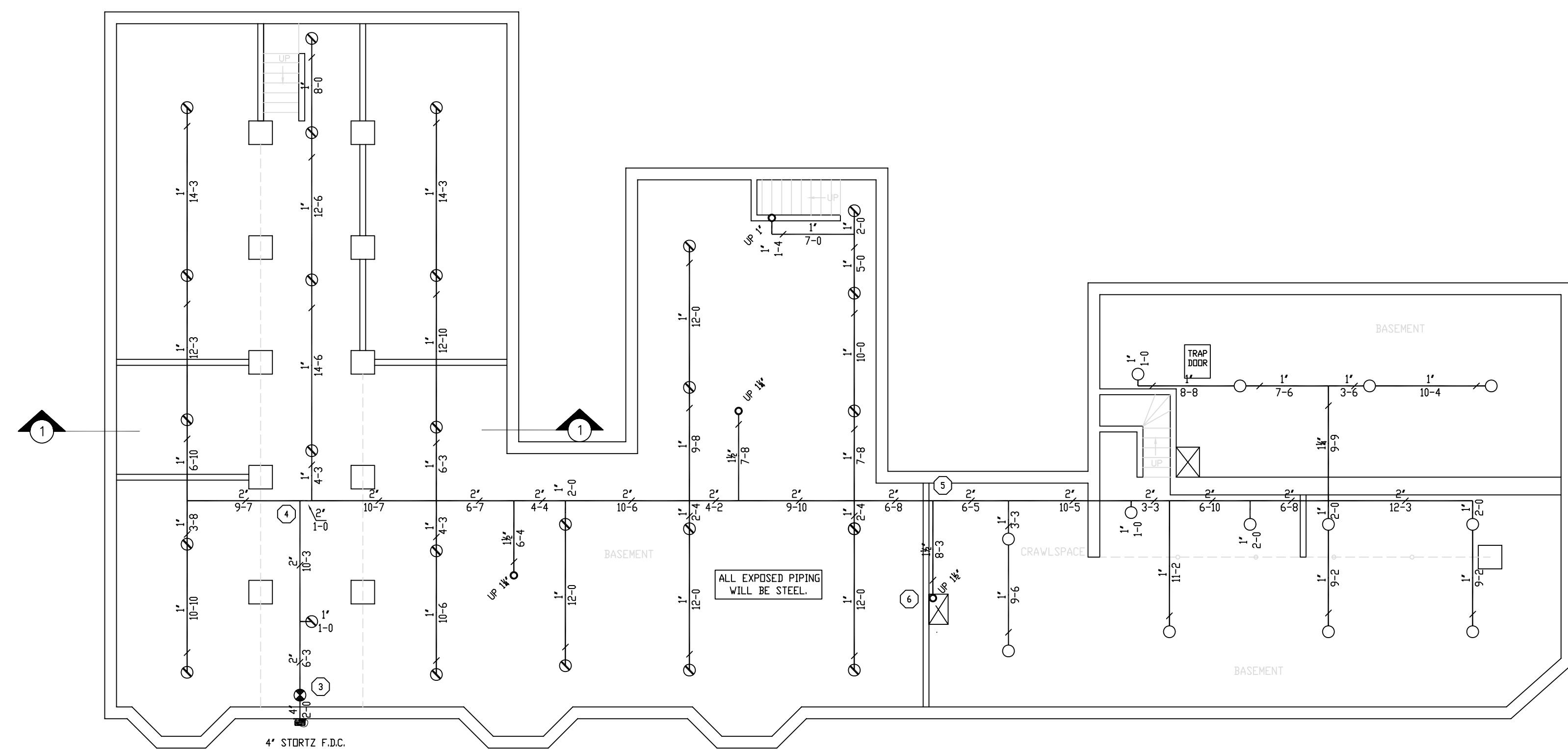

BASEMENT FIRE PROTECTION

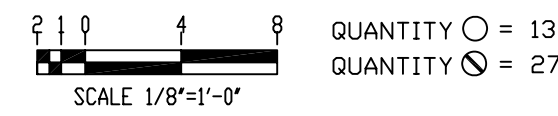

QUANTITY ○ = 13
 QUANTITY ◐ = 27

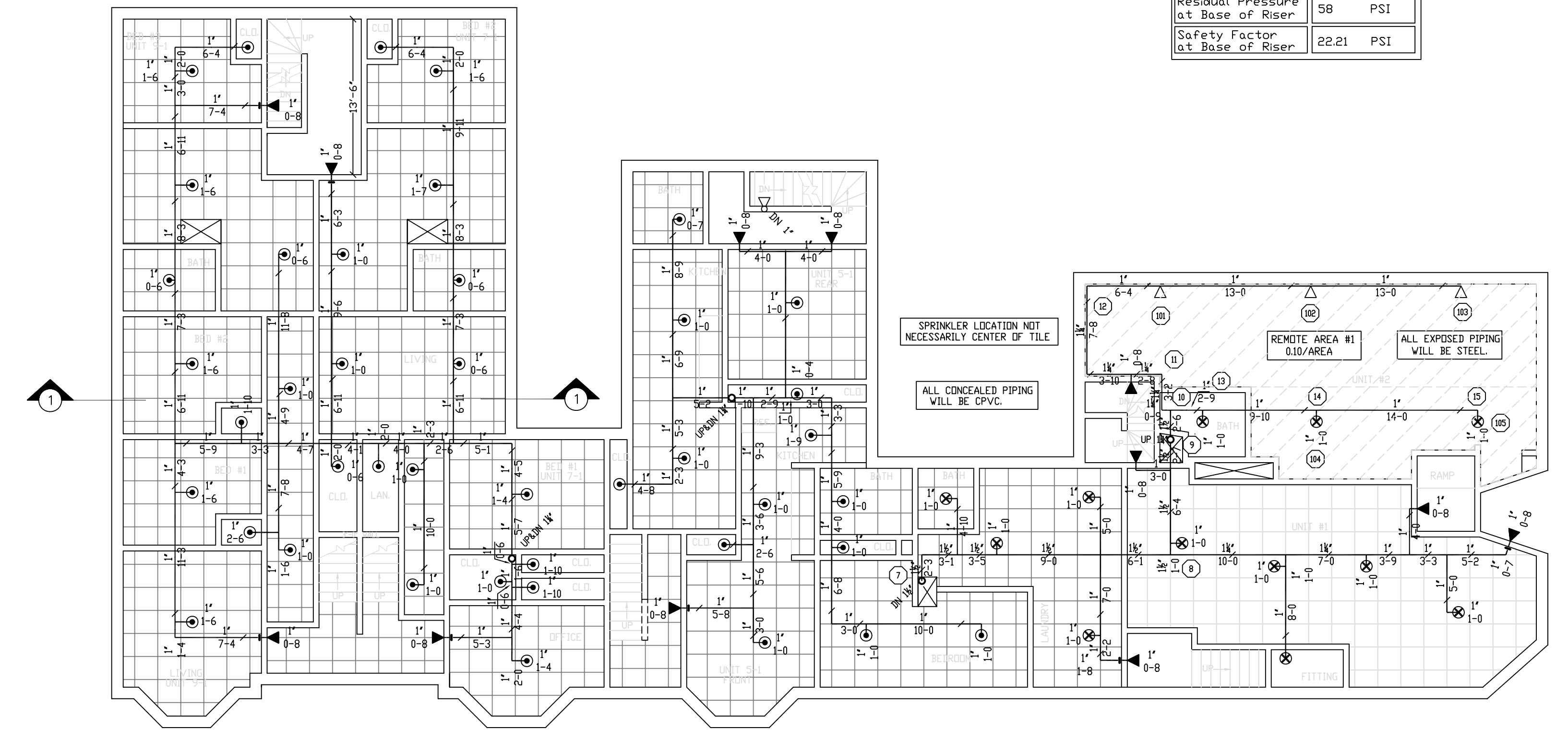

FIRST FLOOR FIRE PROTECTION

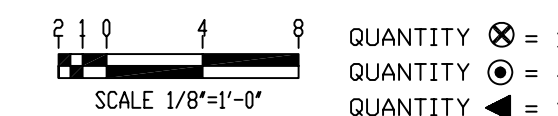

QUANTITY ⊗ = 12
 QUANTITY ⊙ = 42
 QUANTITY ◐ = 12
 QUANTITY ◑ = 4

REVISIONS	NOTES	SPRINKLER TYPE	IDENTIFICATION NO.	MFG.	ESC.	MODEL	FINISH	ORIFICE	TEMP.	SYMBOL	QUANT.
1/2/14 ADDED SPRINKLERS TO APARTMENT BATHROOMS AND CLOSETS.	K=5.6 PENDANT SPRINKLER COVERAGE: 15'X15'	QUICK RESP. PENDANT K= 5.6	TY3231	TYCO	N/A	TY-FRB	WHITE	1/2"	155°	⊗	12
	K=5.6 SIDEWALL SPRINKLER COVERAGE: 14'X14'	QUICK RESP. UPRIGHT K= 5.6	TY3131	TYCO	N/A	TY-FRB	BRASS	1/2"	155°	○	13
	K=4.9 PENDANT SPRINKLER COVERAGE: 16'X16'	QUICK RESP. PENDANT K= 4.9	TY2234	TYCO	2 PIECE	LFII	WHITE	1/2"	155°	◐	42
		QUICK RESP. PENDANT K= 4.9	TY2234	TYCO	N/A	LFII	BRASS	1/2"	155°	◑	27
		QUICK RESP. SIDEWALL K= 5.6	TY 3331	TYCO	N/A	TY-FRB	BRASS	1/2"	155°	◒	4
		DRY SIDEWALL K= 5.6	TY 3335	TYCO	N/A	DS-1	BRASS	1/2"	155°	◓	12
		TOTAL SPRINKLERS THIS DRAWING									110

STANDARD SYMBOLS	STANDARD SYMBOLS
⊗ - POST INDICATOR VALVE	⊗ - ALARM CHECK VALVE
○ - KEY VALVE	◐ - RISER W/ALARM VALVE
◐ - FIRE HYDRANT	◑ - RISER W/DRY VALVE
◑ - FIRE DEPT. CONNECTION	◒ - RISER W/ELEC. FLOW SWITCH
◒ - O.S. & Y GATE VALVE	◓ - RISER W/DELUGE VALVE
◓ - SWING CHECK VALVE	◔ - WATER MOTOR BELL
◔ - NEW UNDERGROUND	◕ - ELECTRIC BELL
◕ - EXIST UNDERGROUND	◖ - FLUSH FIRE DEPT. CONNECTION

INSPECTIONS
1.
2.
3.
4.
5.
RESPONSIBLE MANAGING SUPERVISOR #348
CONTRACTOR LICENSE #295

229 CONGRESS STREET
 PORTLAND, MAINE 04101

FIRE PROTECTION PLAN

FREEDOM FIRE PROTECTION, INC.
 209 QUAKER RIDGE ROAD
 CASCO, MAINE 04015

JOB No. M0153
 DATE 12/27/13
 DRAWN BY M/JN
 SCALE AS NOTED
 SHEET No. FP-2 of 3