

CONGRESS STREET
AND PORTION OF WASHINGTON STREET

Key
New Door

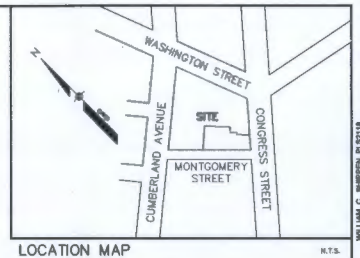

TITLE DESCRIPTION

THE SURVEY AND THE INFORMATION CONTAINED HEREIN IS BASED ON THE SURVEY AND THE INFORMATION CONTAINED THEREIN AS FOLLOWS:

A CERTAIN LOT OR PARCEL OF LAND WITH THE BUILDING THEREON, SITUATED ON CONGRESS STREET IN THE CITY OF PORTLAND, COUNTY OF CUMBERLAND, AND STATE OF MAINE, BOUNDED AND DESCRIBED AS FOLLOWS:

BEING THE INTERSECTION OF THE NORTHERLY SIDE OF CONGRESS STREET AND THE NORTHERLY SIDE OF WASHINGTON STREET, THENCE NORTHERLY BY SAID CONGRESS STREET 44.8 FEET, MORE OR LESS, TO LAND WHICH ABRAHAM HERMAN CONVEYED TO ABRAHAM FARMS BY DEED DATED JULY 18, 1920, AND RECORDED IN CUMBERLAND COUNTY REGISTRY OF DEEDS IN BOOK 1056, PAGE 135; THENCE NORTHERLY BY AN INTERIOR ANGLE OF 84.1587 FEET TO A CORNER OF THE BRICK WALL OF THE BUILDING CONVEYED TO SAID FARMS AS ABOVE; THENCE CONTINUING NORTHERLY BY THE FACE OF SAID BRICK WALL 20.83 FEET TO A CORNER THEREOF SUBJECT TO THE CONDITION THAT A STRIP OF LAND 6 INCHES WIDE ADJOINING THE WESTERLY FACE OF SAID BRICK WALL IS TO BE KEPT OPEN AND FREE FROM THE OBSTRUCTION OF ANY KIND BY MICHAEL RUBINOFF AND JACOB E. RUBINOFF AND THEIR HEIRS AND ASSIGNS, THENCE NORTHERLY FROM THE CORNER AND BY THE FACE OF SAID BRICK WALL 4.61 FEET TO AN ANGLE IN THE SAID WALL, THENCE FROM SAID ANGLE NORTHERLY BY THE FACE OF THE BRICK WALL 14.07 FEET TO A CORNER THEREOF, THENCE FROM SAID CORNER AND BY THE FACE OF A BRICK WALL OF SAID BUILDING 14.07 FEET TO AN ANGLE THEREOF, THENCE NORTHERLY FROM SAID ANGLE AND BY THE FACE OF THE BRICK WALL OF A HOUSE ON THE LOT NEXT EASTERLY 14.63 FEET TO A CORNER OF SAID BUILDING HOUSE, THENCE WESTERLY FROM SAID CORNER AND SAID HOUSE 6.5 FEET, MORE OR LESS, BY THE BRICK WALL OF SAID HOUSE TO AN ANGLE THAT WILL BE A RIGHT ANGLE LINE FROM THE FACE OF SAID WALL THAT SHALL STRIKE SAID BRICK WALL ON THE SECOND STORY; THENCE NORTHERLY BY SAID BRICK WALL 5.72 FEET TO THE NORTHERLY CORNER OF SAID POST; THENCE NORTHERLY FROM SAID CORNER AND BY THE WESTERLY LINE OF A LOT OF LAND FORMERLY OF ARNON WOODMAN HOMESTEAD, THE SECH LAST COURSE FROM CONGRESS STREET AND LAND CONVEYED TO SAID ABRAHAM FARMS, AS ABOVE MENTIONED, AND A STRIP OF LAND 2 FEET WIDE ADJOINING SAID LAST COURSE FROM CONGRESS STREET AND NORTHERLY SIDE, RESPECTIVELY, BY SAID WOODMAN HOMESTEAD AND LAND FORMERLY OF BERSE SPEAR 33.34 FEET, MORE OR LESS, TO THE NORTHERLY CORNER OF LAND CONVEYED TO MATTHEW BROWN BY SAID WOODMAN HOMESTEAD, MARCH 8, 1827 AND RECORDED IN SAID REGISTRY OF DEEDS IN BOOK 235, PAGE 187; AND TO SAID GREAT BRICK WALL, THENCE WESTERLY BY SAID GREAT BRICK WALL 13.72 FEET, MORE OR LESS, TO A POINT LOCATED EASTERNLY FROM MONTGOMERY STREET ON SAID WOODMAN LINE AND THE SOUTHWESTERLY CORNER OF SAID BERSE SPEAR LAND; THENCE NORTHERLY 2.3 FEET BY AN ANGLE OF 90° TO A CORNER OF SAID BERSE SPEAR LAND; MORE OR LESS, TO A CORNER OF SAID BERSE SPEAR LAND; THENCE BY MICHAEL RUBINOFF 1.4 FEET BY THE FACE OF A PICKET FENCE TO A CORNER OF SAID BERSE SPEAR LAND; THENCE EASTERLY 35.5 FEET BY THE EASTERLY SLOPE OF CONGRESS STREET, THE BY SAID MONTGOMERY STREET AND MAKING AN INCLUDED ANGLE OF 90° WITH THE LAST COURSE, 129.29 FEET TO THE POINT OF BEGINNING.

SURVEYED DESCRIPTION

A CERTAIN PARCEL OF LAND SITUATED ON THE NORTHERLY SIDE OF CONGRESS STREET AND THE NORTHERLY SIDE OF MONTGOMERY STREET IN THE CITY OF PORTLAND, COUNTY OF CUMBERLAND, STATE OF MAINE BEING BOUNDED AND DESCRIBED AS FOLLOWS:

BEING ON THE NORTHERLY SLOPE OF CONGRESS STREET LAND NOW OR FORMERLY OF MAIR IN MAINE, LLC AS DESCRIBED IN A DEED RECORDED IN BOOK 2363, PAGE 289 IN THE CUMBERLAND COUNTY REGISTRY OF DEEDS (CORD);

THENCE N 47° 50' 01" E BY ALONG LAND OF SAID MAIR IN MAINE, A DISTANCE OF 10.70 FEET TO THE SOUTHERLY CORNER OF THE BRICK BUILDING STANDING ON LAND OF SAID MAIR IN MAINE;

THENCE BY THE SOUTHERLY SIDE OF CONGRESS STREET AND MAKING AN INCLUDED ANGLE OF 90° WITH THE LAST COURSE, 129.29 FEET TO THE POINT OF BEGINNING.

N 47° 58' 04" W 20.82 FEET.

N 40° 47' 07" E 4.82 FEET.

N 47° 31' 00" W 11.81 FEET.

N 44° 00' 17" E 14.10 FEET.

N 47° 17' 07" E 24.97 FEET.

N 45° 28' 08" E 8.50 FEET.

THENCE N 44° 33' 24" W, BY AND ALONG LAND OF SAID MAIR IN MAINE, A DISTANCE OF 12.72 FEET TO AN ANGLE POINT.

THENCE N 48° 00' 22" E, BY AND ALONG LAND OF SAID MAIR IN MAINE, A DISTANCE OF 10.90 FEET TO AN ANGLE POINT.

THENCE N 45° 27' 17" N, BY AND ALONG LAND OF SAID MAIR IN MAINE, A DISTANCE OF 1.64 FEET TO AN ANGLE POINT.

THENCE N 48° 51' 37" E, BY AND ALONG LAND OF SAID MAIR IN MAINE, A DISTANCE OF 12.32 FEET TO AN ANGLE POINT.

THENCE N 48° 23' 11" E, BY AND ALONG LAND OF SAID MAIR IN MAINE, A DISTANCE OF 1.31 FEET TO AN ANGLE POINT.

THENCE N 48° 23' 11" E, BY AND ALONG LAND OF SAID MAIR IN MAINE, A DISTANCE OF 1.44 FEET TO AN ANGLE POINT.

THENCE N 42° 49' 20" W, BY AND ALONG SAID LAND OF BROWN, A DISTANCE OF 14.56 FEET TO AN ANGLE POINT.

THENCE N 45° 02' 57" W, BY AND ALONG SAID LAND OF BROWN, A DISTANCE OF 61.93 FEET TO THE NORTHERLY SIDE OF CONGRESS STREET.

THENCE N 44° 55' 30" E, BY AND ALONG SAID NORTHEASTLY SLOPE, A DISTANCE OF 129.29 FEET TO THE NORTHERLY SIDE OF CONGRESS STREET.

THENCE N 41° 10' 15" E, BY AND ALONG SAID NORTHERLY SLOPE, A DISTANCE OF 44.8 FEET TO THE POINT OF BEGINNING.

GENERAL NOTES

- THE RECORD OWNER OF THE PARCEL IS MAIA PROPERTIES, LLC BY DEED DATED FEBRUARY 23, 2010 AND RECORDED IN BOOK 3382 PAGE 110 IN THE CUMBERLAND COUNTY REGISTRY OF DEEDS (CORD).
- THE PROPERTY IS SHOWN AS LOT 6, BLOCK 6 AND LOT 6, BLOCK 6 ON THE CITY OF PORTLAND ASSESSORS MAP 13.
- TOTAL AREA OF PARCEL IS APPROXIMATELY 7,778 SQUARE FEET, 0.18 ACRES.
- BOUNDARY INFORMATION SHOWN HEREON IS BASED UPON AN ON THE GROUND SURVEY BY SEBAGO TECHNICAL, PERFORMED IN MAY OF 2014.
- PLAN REFERENCES:
 - CITY OF PORTLAND 1983 REZONATION PLAN SHEET NO. 13 AS RECORDED IN PLAN BOOK 5 PAGE 13 IN THE CUMBERLAND COUNTY REGISTRY OF DEEDS.
 - PLAN SHOWING NEW INFORMATION SET ON SOUTH STREET AND MONTGOMERY STREET CONGRESS ST. BY SEBAGO TECHNICAL, PERFORMED IN MAY OF 2014.
 - CITY OF PORTLAND PUBLIC WORKS DEPARTMENT ENGINEERING DESIGN PLAN 924/5.
- CONGRESS STREET SHEET DEPictING WIDTHS AND MOMENTUM LOCATION CITY OF PORTLAND RECORDS VOLUME 8 PAGE 146.
- MONTGOMERY STREET SHEET DEPictING WIDTHS AND MOMENTUM LOCATION CITY OF PORTLAND RECORDS VOLUME 8 PAGE 185.
- PLAN ORIENTATION IS BASED ON THE NORTH AMERICAN DATUM OF 1983(NAD83), MAINE STATE PLANE COORDINATE (MDC) WEST ZONE 1892.
- UTILITY INFORMATION DEPictED HEREIN IS COMPILED FROM PHYSICAL EVIDENCE LOCATED IN THE FIELD. UTILITIES DEPictED HEREON MAY NOT NECESSARILY REPRESENT ALL EXISTING UTILITIES. CONTRACTORS AND/OR DESIGNERS NEED TO CONTACT DIG-SAFE SYSTEMS, INC. (1-800-DIG-SAFE) AND FIELD VERIFY EXISTING UTILITIES PRIOR TO CONSTRUCTION AND/OR EXCAVATION.
- THE PARCEL IS LOCATED, BY SCALING METHODS, WITHIN ZONE C (AREAS OF MINIMAL FLOODING) AS SHOWN ON THE FLOOD INSURANCE RATE MAP FOR THE CITY OF PORTLAND COMMUNITY PANEL NUMBER 230051-001-49 WITH AN EFFECTIVE DATE OF JULY 17, 2014.
- THERE ARE NO PARKING SPACES DELINEATED ON THE SURVEYED PREMISES.
- THERE IS NO OBSERVED EVIDENCE OF EARTH MOVING HORN OR BUILDING ADDITIONS ON THE SURVEYED PREMISES.
- A PORTION OF THE BUILDING IS CURRENTLY BEING RENOVATED (SEE APPROXIMATE LIMITS).
- BUILDING HEIGHTS ARE MEASURED TO THE VERMILE ROOF LINE.

TITLE COMMITMENT

REFERENCE IS MADE TO A TITLE COMMITMENT...

ZONING

REFERENCE IS MADE TO...

CERTIFICATION:

I, WILLIAM C. SHIFFER, MANAGER OF TITLE
 SEBAGO TECHNICAL, INC.

I HEREBY CERTIFY THAT THIS MAP OR PLAN AND THE SURVEY ON WHICH IT IS BASED WERE MADE IN ACCORDANCE WITH THE 2011 MINIMUM STANDARD DETAIL REQUIREMENTS FOR ALTA/ACSM LAND TITLE SURVEYS. JOINTLY ESTABLISHED AND ADOPTED BY ALTA AND ACMA, AND INCLUDES 17248.1, 2, 3, 4, 6, 7a, 7b, 7c, 8, 9, 10, 11, 13, 14, 17 AND 19 OF TABLE A THEREIN. THE FIELD WORK WAS COMPLETED IN MAY OF 2013.

WILLIAM C. SHIFFER, MANAGER'S TITLE
 SEBAGO TECHNICAL, INC.

LEGEND

EXISTING	DESCRIPTION
---	BOUNDARY LINE, P.O.B.
-.-.-	ADJUTANT LINE, P.O.B.
----	SEWER
---	EASEMENT
○	MONUMENT
○	DEED CALL
○	BUILDING OFFSET
○	IRON
○	EDGE PAVEMENT
○	EDGE CONCRETE
○	PAVEMENT PAINT
○	CURBLINE
○	CHAIRMAN FENCE
○	METAL WALL
○	WATER GATE VALVE
○	WATER SHUT OFF
○	SEWER MH
○	OVERHEAD UTILITY
○	TELEPHONE MANHOLE
○	UTILITY POLE
○	CHY
○	POB

BUILDING OFFSETS

LETTER	DESCRIPTION
A	3.75 TO LOT LINE
B	3.6 TO LOT LINE
C	3.5 TO LOT LINE
D	11.5 TO LOT LINE
E	12.2 TO LOT LINE
F	12.2 TO LOT LINE
G	11.8 TO LOT LINE
H	3.4 TO LOT LINE
I	3.4 TO LOT LINE
J	0.5 INTO CONGRESS STREET
K	1.2 BY WINDOW INTO CONGRESS STREET
L	0.3 BY WINDOW INTO CONGRESS STREET
M	1.8 BY WINDOW INTO CONGRESS STREET
N	0.5 BY WINDOW INTO MONTGOMERY STREET
O	0.5 BY WINDOW INTO MONTGOMERY STREET
P	1.9 TO MONTGOMERY STREET LINE

NOT FOR CONSTRUCTION
 PROGRESS PRINT

NO.	DATE	STATUS

REVISIONS:
 1. AS NOTED
 2. AS NOTED
 3. AS NOTED
 4. AS NOTED
 5. AS NOTED
 6. AS NOTED

SEBAGO TECHNICAL, INC.

195 PORTLAND VENTURES
 1001 195th Street
 Portland, ME 04106
 TEL: 603.763.1414
 FAX: 603.763.1415
 WWW.SEBAGO.COM

ALTA/ACSM LAND TITLE SURVEY

SITE NAME
 195 PORTLAND VENTURES

DATE **SCALE**

DATE **1"=50'**

SHEET 1 OF 1

Key:
 New Door

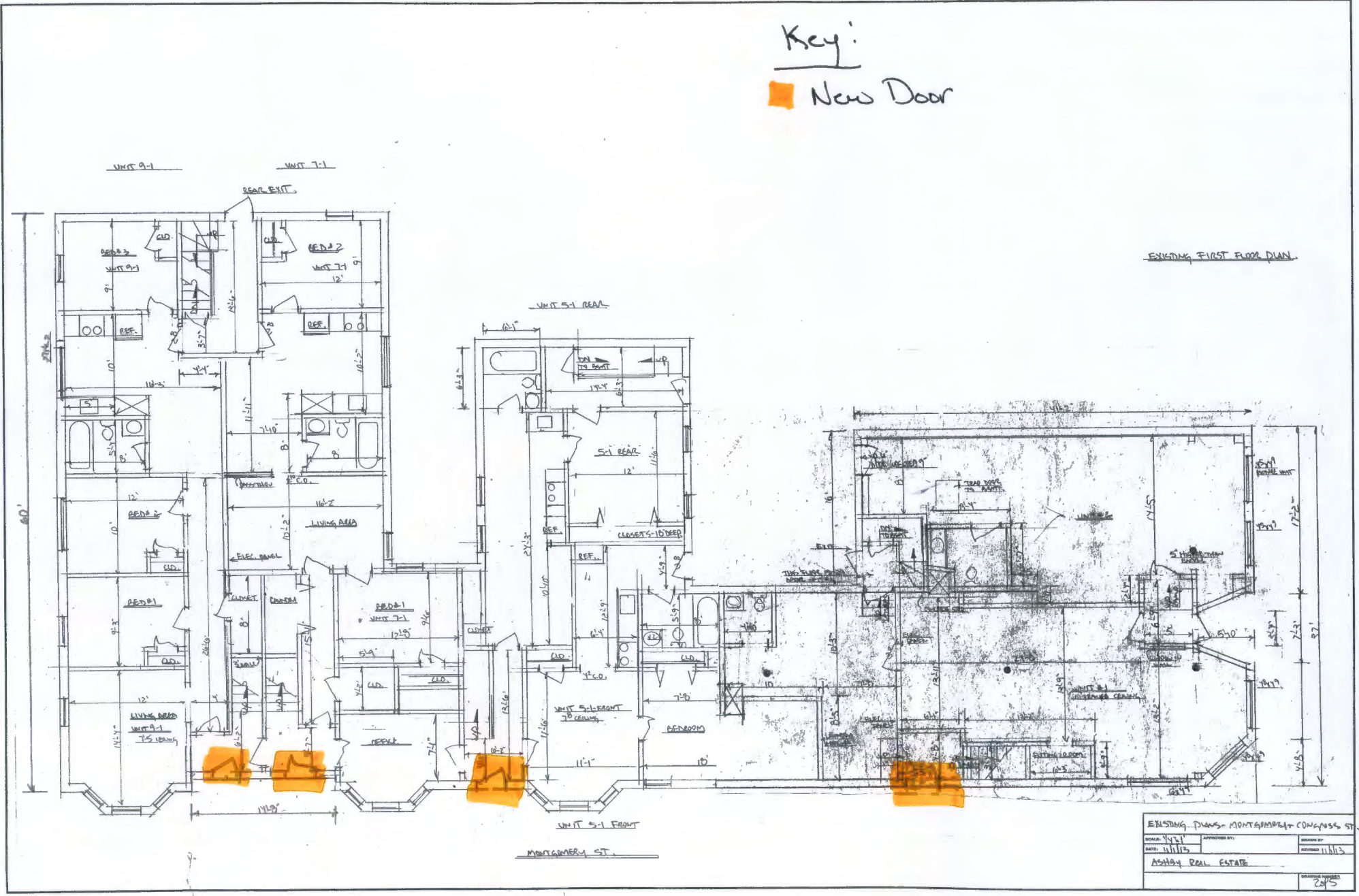

EXISTING FIRST FLOOR PLAN

EXISTING PLANS - MONTGOMERY + CONGRESS ST.		
SCALE: 1/4" = 1'-0"	APPROVED BY:	DESIGNED BY:
DATE: 11/11/13	REVISIONS:	11/11/13
ASHBY REAL ESTATE		
DRAWING NUMBER:		245



Date: 10/09/2014

1000 GALLERY BOULEVARD
SCARBOROUGH, ME 04074
(207) 883-1309

Project #: 423151092 **Project name:** 4 entry doors w/closer
Customer Name: JONES IAN
Customer Phone: (908) 432-9267
Customer Address: 7-9 MONTGOMERY ST
PORTLAND ME 04101

Product List

Item Description	Availability	Qty	Unit Price	Total Price
 Commercial Door Closer Grade 1 Adjustable 1 - 4 Item #: 103844 Manufacturer: <u>In Stock</u> Model #: DC100148	In Stock	4	\$64.97	\$259.88
<i>Image not currently available</i> S PLYMOUTH KY STRM KB-SC Item #: 492718 Manufacturer: Estimated Model #: A80PD PLY 626	Estimated 10/16/2014	4	\$171.82	\$687.28

Product Subtotal: \$947.16

Installation

Installation Configuration	Total Price
Exterior and Patio Doors - Labor Configuration	
Front Door	
BASIC LABOR EXT DOOR-SGL PRE-HUNG	
Front Door Total	\$1,316.00
LAB INST EXT DOOR-ADDL/CUSTM WORK	
Project Level Fees Total	\$763.99
Deductible Detail #422301446	\$-35.00
Installation Subtotal:	\$2,044.99

Handwritten notes in a blue circle:
10-15/14
8-PGS

Order Subtotal: \$2,992.15

Salesperson: GAVIN SEEKAMP
Accepted By:

Handwritten note: EVERYTHING EXCEPT THE DOORS (DEPENDING ON STYLE YOU CHOOSE)
Date: 10/09/2014

This Quote is valid until 11/08/2014 This is an estimate only. This estimate does not include tax, special fees (e.g., White Goods Tax),



Create Labor Estimate

[Online Help](#)

[Next](#) [Add Another](#) [Cancel](#) [Clear](#) [Undo](#) [Redo](#)

Total Linear Feet of Custom Trim to be Installed	0
Deliver Door	Yes
Customer Understands Scope of the Project	Yes
Permit Required	Yes
Who Will Obtain Permit	Customer
Additional Miles Traveled over 20	0
Bring Up To Code Description	None
Local Disposal Fee	71.43
Describe Other Work Needed	installing hd-door closers \$46ea / install labor for int-ext trim \$127.14ea door / int trim may be reused but will still have labor\$ to re-install
Other Work Charge	692.56
Comments	No Comment

Edit Information

Click on link below to edit

[Front Door](#)

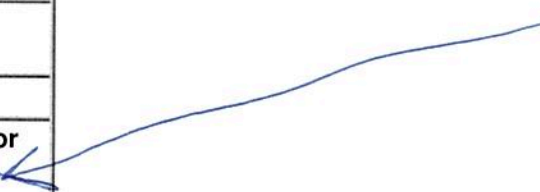



Create Labor Estimate

[Online Help](#)

[Next](#) [Add Another](#) [Cancel](#) [Clear](#) [Undo](#) [Redo](#)

Stock or SOS	SOS
Door Type	Exterior
Select Location	Front Door
Select New Door	Single Pre-hung
Number of Doors to Install	4
Side Lights or Transoms	No
Hardwood (Mahogany or Oak) Door	No
Hidden Damage Description	None
Number of additional holes bored for accessories	None
Install Specialized Mortise Hardware	No
Install Storm Door	No
Lead Safe Practices	No

Edit Information

Click on link below to edit

[General](#)

Quotation

Lowes - ME

ME
United States

Quote ID SQBHH000111-1

P.O. Number

Line	Label	Qty	UOM	Family/Part Number	Unit	Extended
------	-------	-----	-----	--------------------	------	----------

1 3.0000 EA

Entry Door
Entry Door System

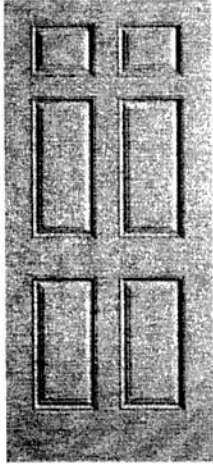

3-0 X 6-8, Left Hand Inswing, Classic-Craft Canvas Embossed/Molded Open, No glass, CCV060, Single Door, Single Bore, 2-3/4" Backset, 2-1/8" BoreDia, Steel Split Jamb, 4-1/2 to 5-1/2", No Casing, Public Access Sill Split Steel Jamb, Sill Finish Mill, ~~3 Spring Hinges~~ Split Steel Frame, ~~Satin Brass~~ (Zinc Dichromate) - US2D, Brz Comp Weatherstrip,

BRUSH NICKEL \$ 736⁰⁰ EA DOOR
BALL BEARING HINGE x 4
\$ 2944⁰⁰

2 1.0000 EA

Entry Door
Entry Door System

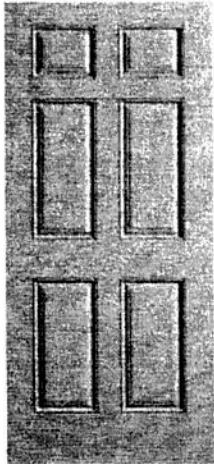

3-0 X 6-8, Right Hand Inswing, Classic-Craft Canvas Embossed/Molded Open, No glass, CCV060, Single Door, Single Bore, 2-3/4" Backset, 2-1/8" BoreDia, Steel Split Jamb, 4-1/2 to 5-1/2", No Casing, Public Access Sill Split Steel Jamb, Sill Finish Mill, ~~3 Spring Hinges~~ Split Steel Frame, ~~Satin Brass~~ (Zinc Dichromate) - US2D, Brz Comp Weatherstrip,

BRUSH NICKEL
BALL BEARING HINGE

↑
VERY HEAVY DUTY FIBERGLASS
DOOR ON A STEEL FRAME

THEY ALSO OFFER A FIBERGLASS
DOOR (NOT AS HEAVY DUTY) BUT
STILL HAS A DOOR CLOSER
REINFORCEMENT UP TOP
FOR \$ 455⁰⁰ EA DOOR

Application version 8.0.0.43

Printed on 10/9/2014

Content Version 2.1.2.0

Page 2 of 3

Door Slab Trimming

Maximum height and width trims for standard doors.

MAXIMUM EDGE AND END TRIMS

Door Slab	A Top Rail	B Bottom Rail	C Hinge Stile	D Lock Stile
Classic-Craft	1-1/4"	1-1/4"	1/8"	1/8"
Fiber-Classic	1/4"	1/4"	1/8"	1/8"
Smooth-Star	1/4"	1/4"	1/8"	1/8"
Steel	1/4"	1/4"	1/16"	1/16"

*inspect corners to verify available hardwood thickness before trimming.

NOTES:

- 90-minute positive pressure fire doors cannot be width-trimmed.
- Fiber-Classic and Smooth Star 20-minute positive pressure fire doors can only be trimmed from the bottom of the door. This machining can only be completed by certified door machine shops.
- Trimming the bottom rail may prevent the kerf door bottom from fitting properly. A replacement staple-on door bottom may need to be used.
- For resizing beyond maximum trimming, see Shop 3 - Door Slab Resizing.

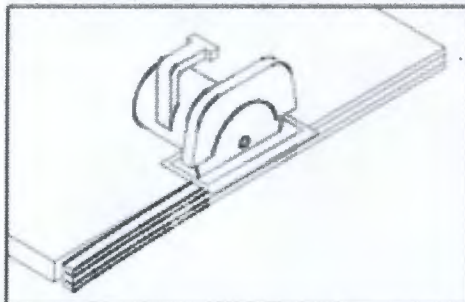
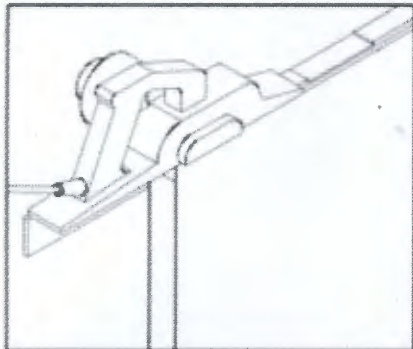

Trim Slab to Width

Set planer cutting depth.

Plane edges of slab.

Sand smooth if required.

Paint with primer if required to match original finish.

Trim Slab to Height

Measure and mark door slab.

Cut along line with saw, using carbide-tipped blade.

Touch up edges with a rasp or sandpaper.

Door
Preparation

20 minute
fire door

[Returns](#)

- DOORKNOBS
- DOOR LEVERS
- HANDLESETS
- DEADBOLTS
- HINGES
- POCKET DOOR
- KEYLESS LOCKS
- KICKPLATES

Schlage Plymouth A-Series Storeroom Commercial Knobset

*OUTSIDE KNOB ALWAYS LOCKED
INSIDE KNOB ALWAYS UNLOCKED*



Item Id: A80PD-PLY

*****0Review(s) [Review this item](#)

Buy

Finish

Select Backset



Bright Brass

2 3/8" Backset

Price: \$104.30

Quantity

[Add to Cart](#)

[Add to Wish List](#)

[Low Price Guarantee](#)

[Email a friend](#)

[Questions about this item? Be the first to ask here.](#)



*\$171.87
5057-49278
A80PD PLY 626*

[Save](#)

PayPal CREDIT
Get 6 Months to pay on \$99+
Check out with PayPal and choose PayPal Credit
Subject to credit approval. See terms. US customers only.

Others Also Bought:



★★★★★

Schlage B560

\$46.20

[Choose Options](#)



Schlage B250 Single
\$149.10

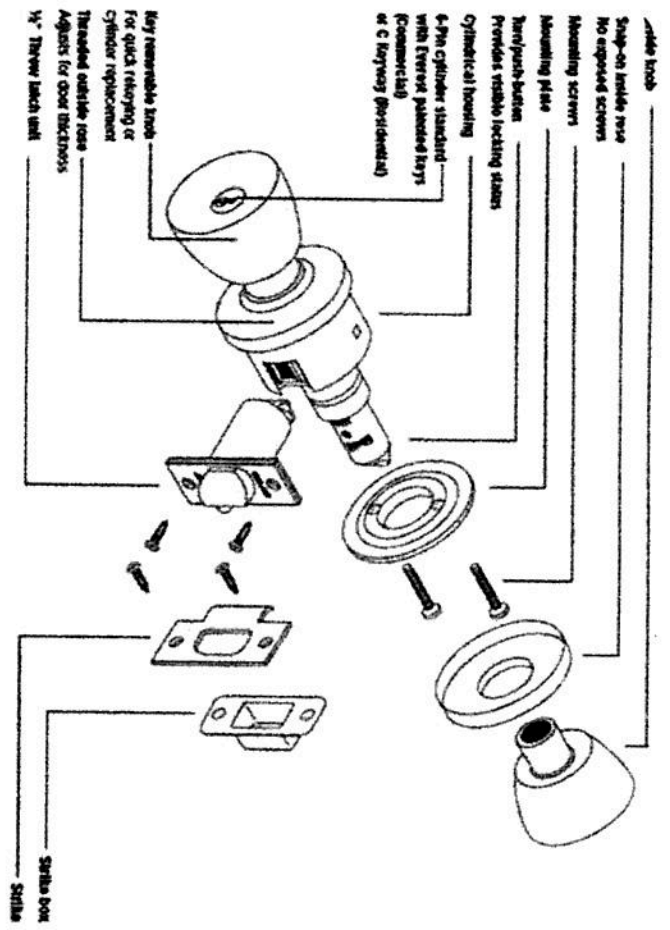

Related Items



Schlage Plymouth
 A G T
 \$152.88



Schlage Plymouth
 A G N
 \$104.30



Schlage Plymouth
 A G N
 \$104.30



Schlage Plymouth
 A G A
 \$122.50



Schlage Plymouth
 A G
 \$78.40

Choose Options Choose Options Choose Options Choose Options Choose Options

Your Store:
Scarborough, ME



**TELL MANUFACTURING,
INC. Commercial Door Closer Grade 1
Adjustable 1 - 4**

Item #: 103844 | Model #: DC100148

★★★★★

\$64.97

Tweet

8+1 0

**FREE
Store Pickup**
Your order can be available for pickup
in **Lowe's Of Scarborough, ME** today.

Lowe's Truck Delivery
Your order will be ready for delivery to
you from your selected store.

Parcel Shipping
Sent by carriers like UPS, FedEx,
USPS, etc.

TELL **\$64.97**
**MANUFACTURING,
INC. Commercial
Door Closer Grade 1
Adjustable 1 - 4**

Description

Commercial Door Closer Grade 1 Adjustable 1 - 4





- Heavy-duty commercial grade 1 surface applied closers standard features include: Certification ANSI A 156.4, Grade 1, 2 million cycles, UL listed
- Chassis/closer: non-handed, cast aluminum, mounting to regular, top jamb or parallel arm applications
- Door range: up to 180°
- Door preparation: 9-1/16" horizontal and 3/4" vertical mounting hole locations (retrofits traditional closer)
- 25-year limited warranty

Specifications

Grade Type	Grade 1	Parallel Arm Bracket Included	Yes
Interior Doors	Yes	Drop Forged Arm	Yes
Exterior Doors	Yes	Non Handed	Yes
Door Type	Wood and metal	Commercial / Residential	Commercial
Adjustable Latch	Yes		

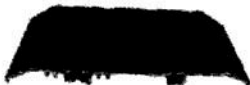
<u>Finish</u>	Millwork
<u>Product</u>	Doors
<u>Type</u>	Entry/Exterior
<u>Manufacturer</u>	Therma-Tru - Huttig Saco Maine
<u>Product Material</u>	
<u>Impact Rated</u>	
<u>Material Type</u>	
<u>Configuration</u>	
<u>Transom Type</u>	
<u>Product Style</u>	
<u>Glass Style</u>	
<u>Model</u>	
<u>Handing</u>	?
<u>Brickmould</u>	
<u>Slab Width</u>	
<u>Custom Height</u>	
<u>Slab Height</u>	
<u>Sidelite Width</u>	
<u>Sidelite Height</u>	
<u>Transom Width</u>	
<u>Transom Height</u>	
<u>Sidelite Style</u>	
<u>Sidelite Model</u>	
<u>Left Sidelite Model</u>	
<u>Right Sidelite Model</u>	
<u>Sidelite Glass Style</u>	
<u>Transom Glass Style</u>	
<u>Transom Model</u>	
<u>Total Unit Width</u>	?

Select Sill

 <p><u>Mill Finish</u> <u>Non-Adjustable</u> <u>ADA Sill</u></p>	 <p><u>Brass High</u> <u>Performance</u> <u>Adjustable Inswing</u> <u>Sill</u></p>	 <p><u>Mill High</u> <u>Performance</u> <u>Adjustable Inswing</u> <u>Sill</u></p>
 <p><u>Bronze High</u> <u>Performance</u> <u>Adjustable Inswing</u> <u>Sill</u></p>	 <p><u>Aluminum</u> <u>Non-Adjustable</u> <u>Outswing Sill</u></p>	



