

Form # P 04

DISPLAY THIS CARD ON PRINCIPAL FRONTAGE OF WORK CITY OF PORTLAND

Please Read Application And Notes, If Any, Attached

BUILDING INSPECTION PERMIT

Permit Number: 041354

This is to certify that Bedard Kami-L./Sheds, U.S.A.
has permission to Build 8'x8' shed to be installed at rear of property
AT 39 Barclay Ave CBL 339-D011001

provided that the person or persons, firm or corporation accepting this permit shall comply with all of the provisions of the Statutes of Maine and of the Ordinances of the City of Portland regulating the construction, maintenance and use of buildings and structures, and of the application on file in this department.

Apply to Public Works for street line and grade if nature of work requires such information.

Notification of inspection must be given and written permission procured before this building or part thereof is lathed or otherwise closed-in. 24 HOUR NOTICES REQUIRED.

A certificate of occupancy must be procured by owner before this building or part thereof is occupied.

OTHER REQUIRED APPROVALS

Fire Dept. _____
Health Dept. _____
Appeal Board _____
Other _____
Department Name _____

Jeanne Banke 9/22/04
Director - Building & Inspection Services

PENALTY FOR REMOVING THIS CARD

Permit No:		Issue Date:		CBL: 339 D011001	
Location of Construction: 39 Barclay Ave		Owner Name: Bedard Kami L		Owner Address: 39 Barclay Ave	
Business Name:		Contractor Name: Sheds, U.S.A.		Phone: 797-4128	
Contractor Address: P.O.Box 6622 Portsmouth		Phone: 6038681300		Permit Type: Sheds	
Lessee/Buyer's Name		Phone:		Zone: R3	
Past Use: Single Family Home		Proposed Use: Single family home w/ 8'x8' unattached shed		Permit Fee: \$39.00	
See permit # 030360 Proposed Project Description: Build 8'x8' shed to be installed at rear of property		FIRE DEPT: <input type="checkbox"/> Approved <input type="checkbox"/> Denied INSPECTION: Use Group: R3 Type: accessory BOCA 1999 Signature: AMB 9/22/04		Cost of Work: \$1,715.00 CEO District: 5	
PEDESTRIAN ACTIVITIES DISTRICT (P.A.D.) Action: <input type="checkbox"/> Approved <input type="checkbox"/> Approved w/Conditions <input type="checkbox"/> Denied Signature: _____ Date: _____		Zoning Approval			
Permit Taken By: dmm Date Applied For: 09/10/2004					

1. This permit application does not preclude the Applicant(s) from meeting applicable State and Federal Rules. 2. Building permits do <i>not</i> include plumbing, septic or electrical work. 3. Building permits are void if work is not started within six (6) months of the date of issuance. False information may invalidate a building permit and stop all work..	Special Zone or Reviews <input type="checkbox"/> Shoreland <input type="checkbox"/> Wetland <input type="checkbox"/> Flood Zone <input type="checkbox"/> Subdivision <i>OK</i> <input type="checkbox"/> Site Plan Maj <input type="checkbox"/> Minor <input type="checkbox"/> MM <input type="checkbox"/> Date: <i>AMB 9/22/04</i>	Zoning Appeal <input type="checkbox"/> Variance <input type="checkbox"/> Miscellaneous <input type="checkbox"/> Conditional Use <input type="checkbox"/> Interpretation <input type="checkbox"/> Approved <input type="checkbox"/> Denied Date: _____	Historic Preservation <input checked="" type="checkbox"/> Not in District or Landmark <input type="checkbox"/> Does Not Require Review <input type="checkbox"/> Requires Review <input type="checkbox"/> Approved <input type="checkbox"/> Approved w/Conditions <input type="checkbox"/> Denied Date: <i>AMB</i>
---	--	---	---

CERTIFICATION

I hereby certify that I am the owner of record of the named property, or that the proposed work is authorized by the owner of record and that I have been authorized by the owner to make this application as his authorized agent and I agree to conform to all applicable laws of this jurisdiction. In addition, if a permit for work described in the application is issued, I certify that the code official's authorized representative shall have the authority to enter all areas covered by such permit at any reasonable hour to enforce the provision of the code(s) applicable to such permit.

SIGNATURE OF APPLICANT	ADDRESS	DATE	PHONE
RESPONSIBLE PERSON IN CHARGE OF WORK, TITLE		DATE	PHONE

City of Portland, Maine - Building or Use Permit

389 Congress Street, 04101 Tel: (207) 874-8703, Fax: (207) 874-8716

Permit No: 04-1354	Date Applied For: 09/10/2004	CBL: 339 D011001
------------------------------	--	----------------------------

Location of Construction: 39 Barclay Ave	Owner Name: Bedard Kami L	Owner Address: 39 Barclay Ave	Phone: () 797-4128
Business Name:	Contractor Name: Sheds, U.S.A.	Contractor Address: P.O.Box 6622 Portsmouth	Phone: (603) 868-1300
Lessee/Buyer's Name	Phone:	Permit Type: Sheds	

Proposed Use: Single family home w/ 8'x8' unattached shed	Proposed Project Description: Build 8'x8' shed to be installed at rear of property
---	--

Dept: Zoning	Status: Approved	Reviewer: Jeanine Bourke	Approval Date: 09/22/2004
Note:	Ok to Issue: <input checked="" type="checkbox"/>		
1) It is the responsibility of the owner to delineate the property lines for the setback inspection.			
Dept: Building	Status: Approved	Reviewer: Jeanine Bourke	Approval Date: 09/22/2004
Note:	Ok to Issue: <input checked="" type="checkbox"/>		

Sheds USA Inc. Mill Store specs

Delivered - Built - Guaranteed

Roof Construction

1/2" 5-ply plywood
 2x4 trusses w/TPI plates, 24" on center
 3ft, 3-tab, self-sealing asphalt shingles
 All Peak roof pitches are 5/12
 Gambrel roofpitch is 12/12 at bottom
 changing to 5/12 pitch at the top

Roof Height

6ft wide peak - 8'
 8ft wide peak - 8'3"
 8ft wide gambrel - 9'
 10ft wide peak - 8'11"
 10ft wide gambrel - 9'5"
 12ft wide peak - 9'6"
 12ft wide gambrel - 9'10"

Walls

2x4 construction, 24" on center
 Siding Types:
 Primed shed panel
 Pine (tongue & groove)
 Cedar (tongue & groove)
 Maintenance Free Vinyl on 1/2" plywood
 Peak/ Gambrel wall height - 71-1/2"
 Extended Peak front wall height - 75"

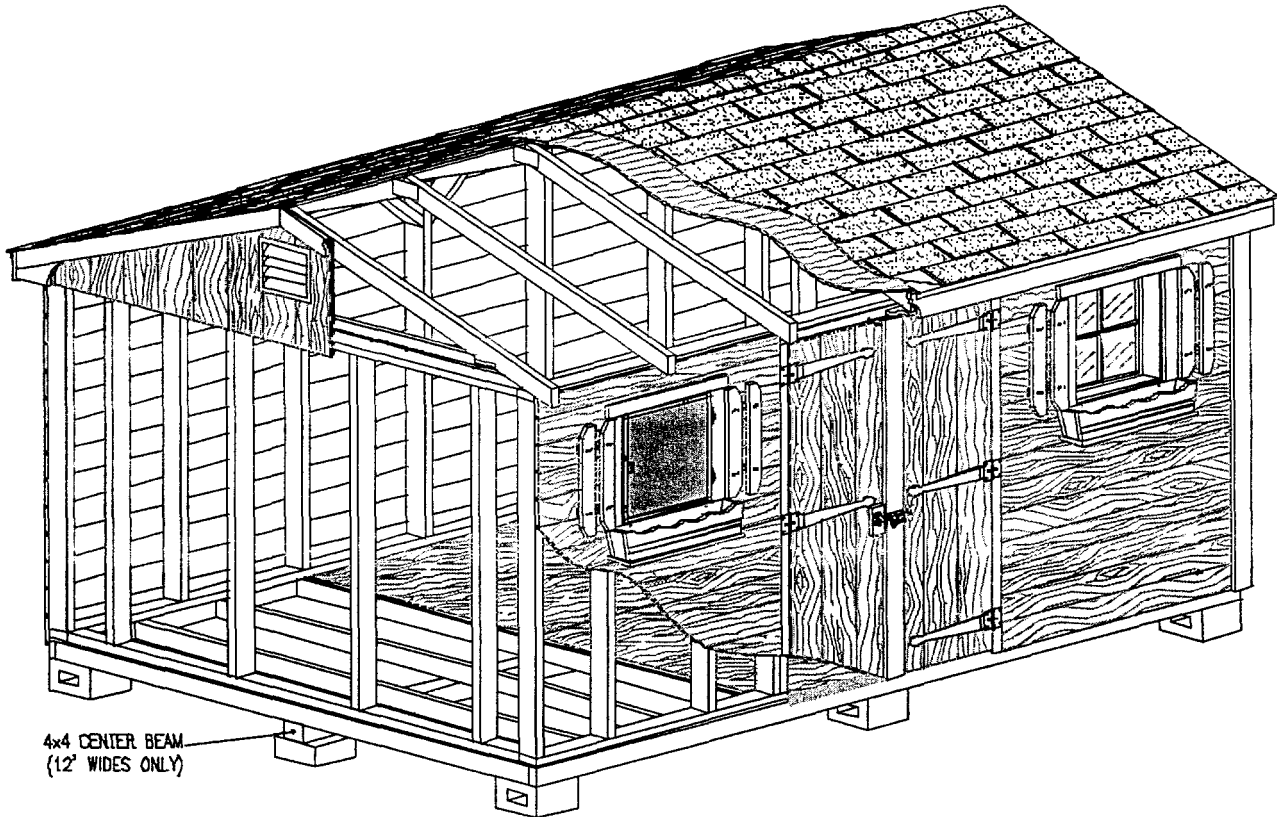

Windows

Size: 18" wide x 22" tall (approx)
 Includes flower box & shutters
 Optional window screens
 Wooden Sheds - functional windows
 Vinyl Sheds - non-functional windows
 With optional upgrade to functional

Doors

Standard 40" double door (except 6'x6' shed)
 Optional 54", 66". & 78" double door
 Optional 26" single door
 Door height 69", opening height 67-1/2"

Floor

5/8" plywood
 optional 5/8" PT plywood
 Floor joists - 16" on center
 2x4* - 6' & 8' wide sheds
 (*optional upgrade to 2x6)
 2x6 - 10' & 12' wide sheds
 pressure-treated joists optional
 Concrete block supports
 PT 4x4 runner under 12' wide sheds

Note: Options may not be available for all sheds. Call your Distributor or Sheds USA for more information.

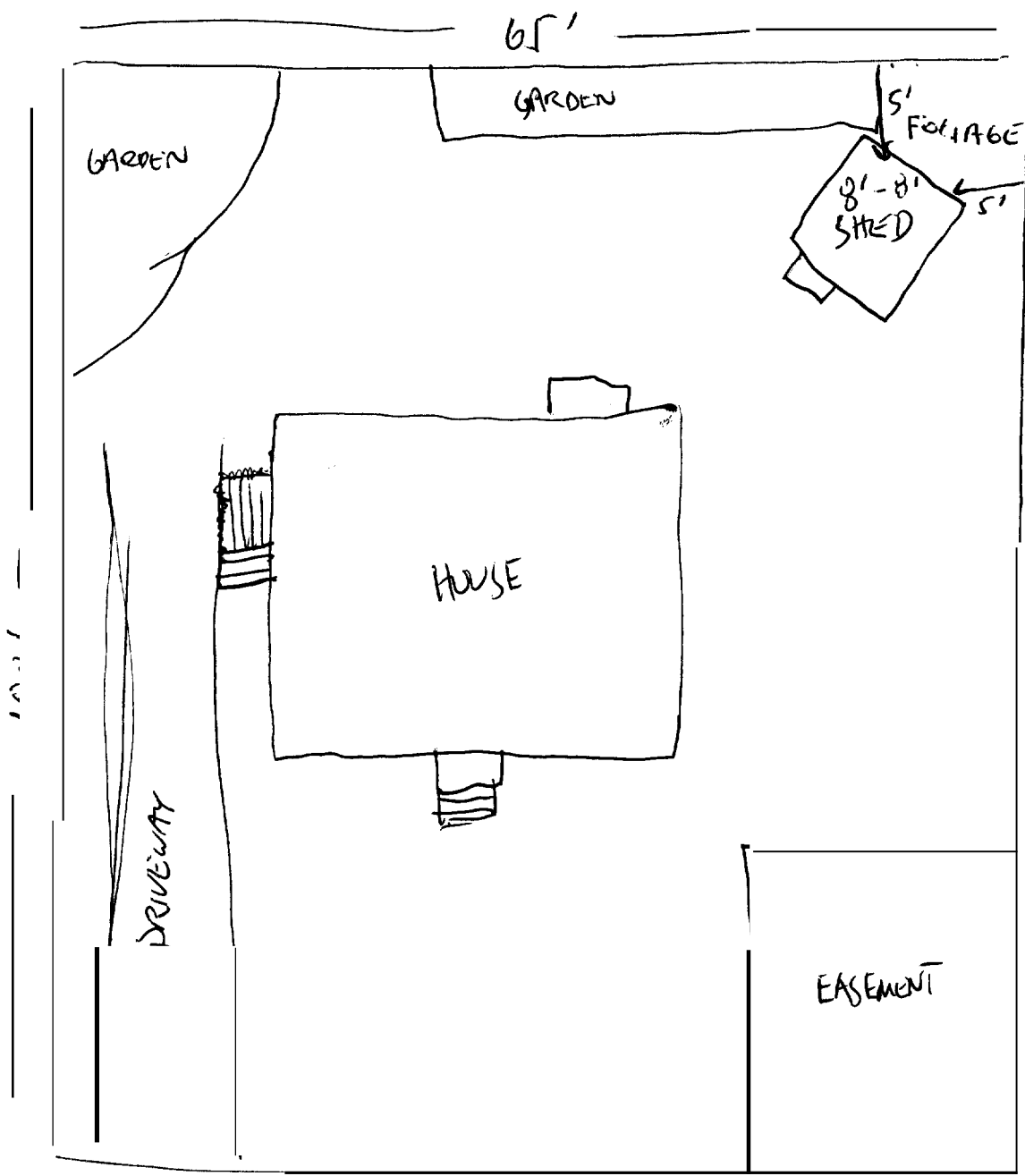

R3 Zone
 #00 SF or less
 min. 5' from
 Rear & Side
 Property Lines

For: Kami Bedard
 39 Barclay Ave.
 Portland, ME 04103
 791-1142

SEP - 9 2004
 ME