

4 ELEVATION NORTH
1/2"=1'-0"

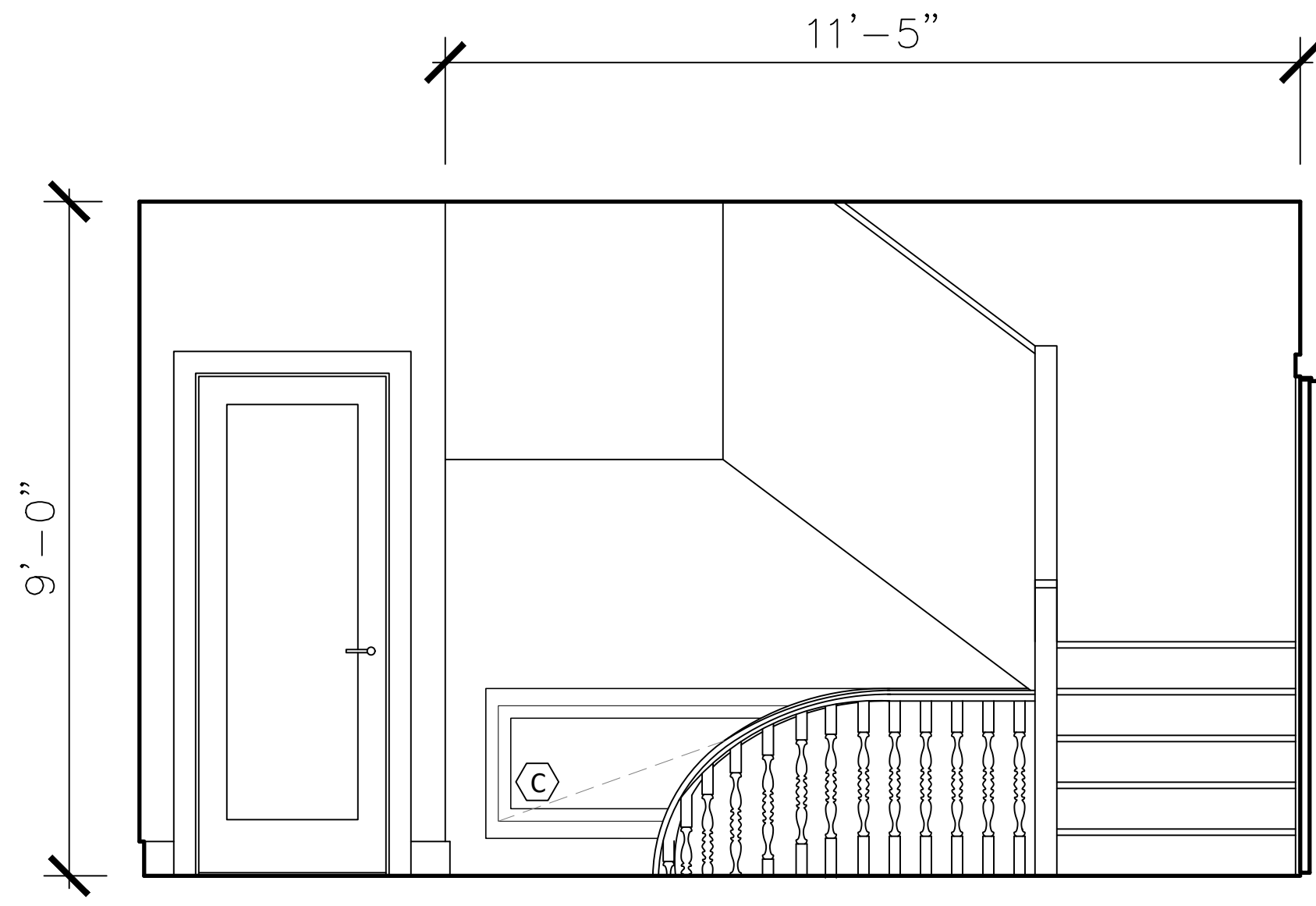

2 ELEVATION EAST
1/2"=1'-0"

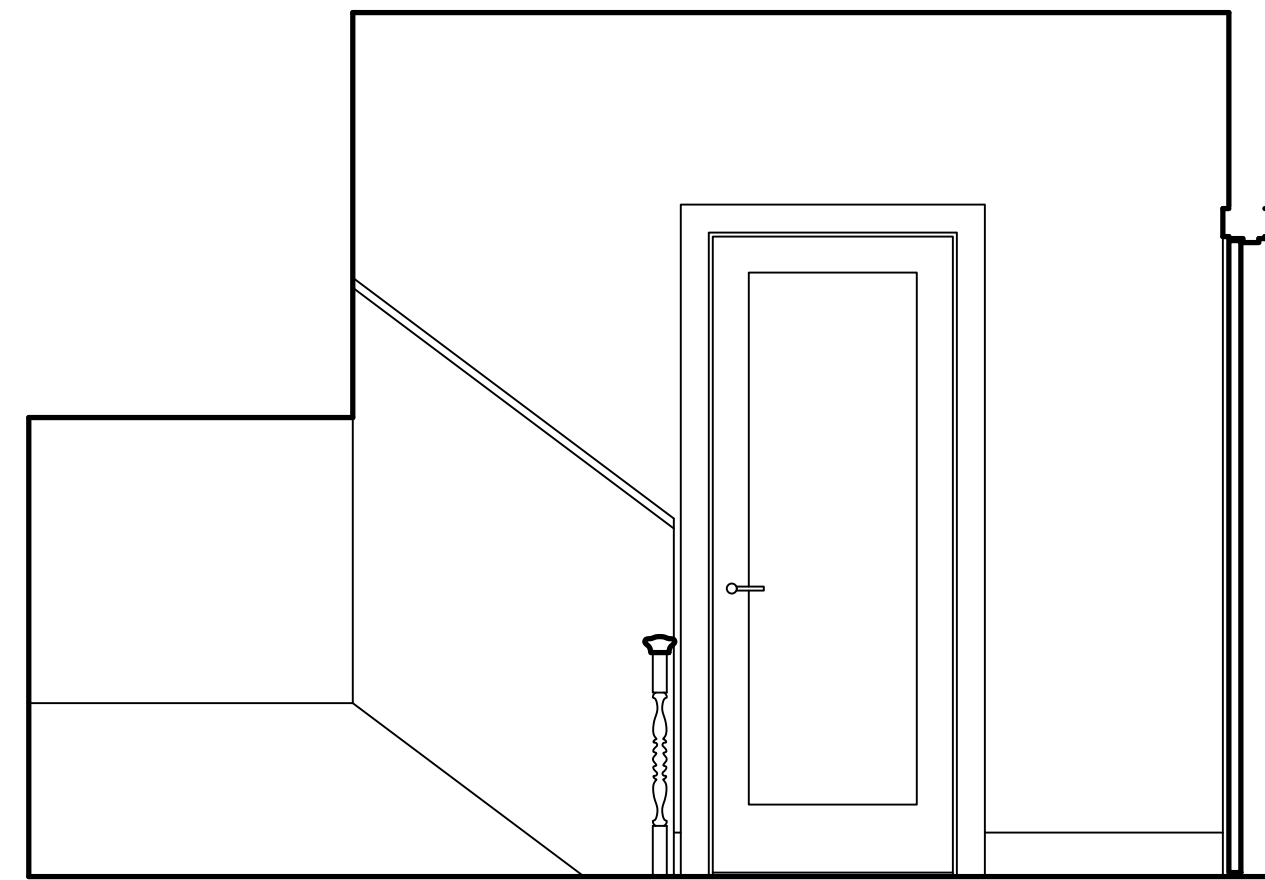

3 ELEVATION SOUTH
1/2"=1'-0"

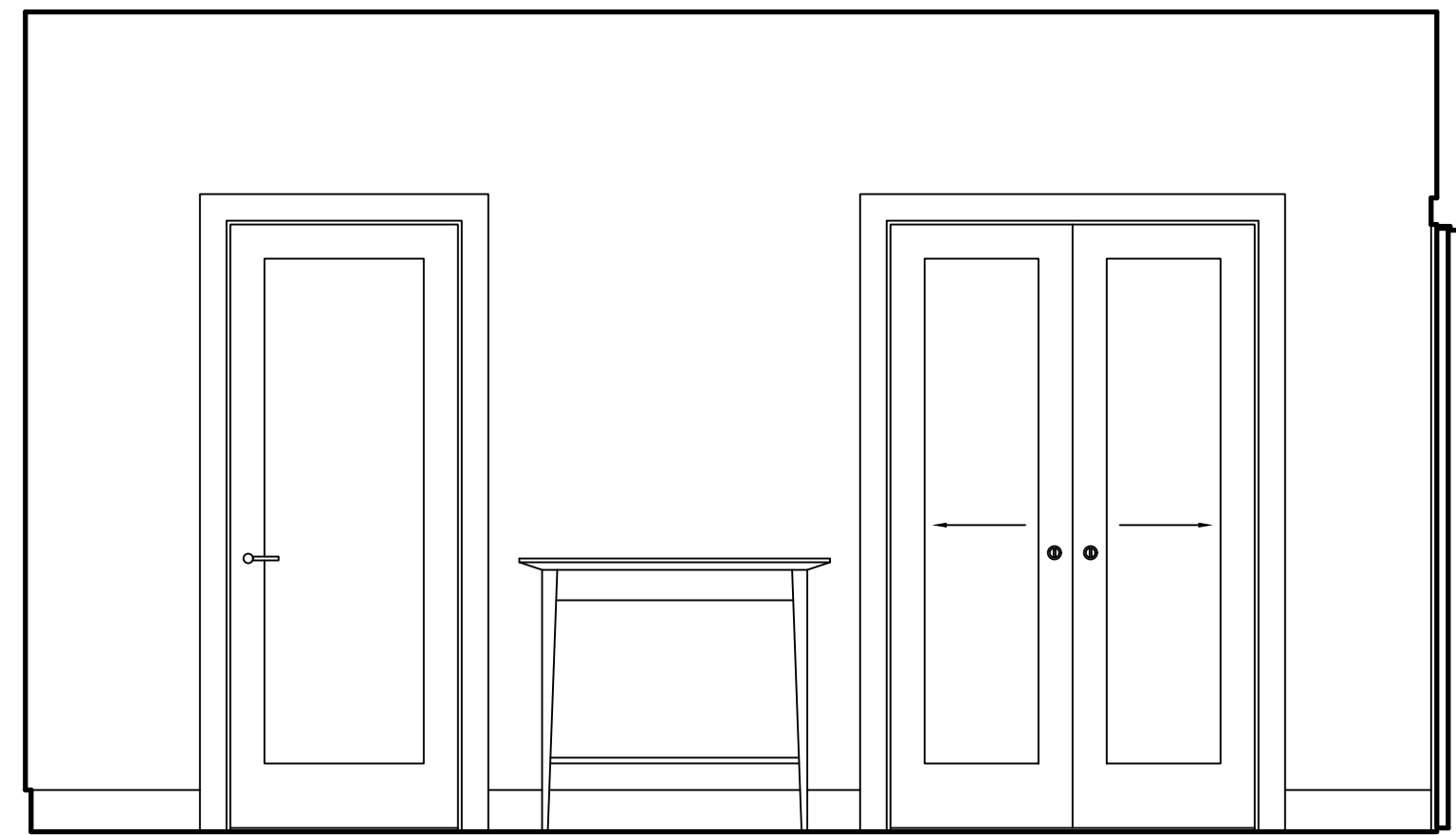

1 ELEVATION WEST
1/2"=1'-0"

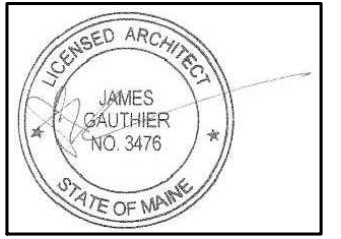

Rachel Conly Design LLC
26 Sterling Street
Peaks Island, Maine 04108
207.766.5625
www.rachelconlydesign.com

DATE	NOTES
2018.03.01	Issued for Permit
REVISED	

PROJECT
Renovations to
123 Cumberland Ave.
Portland, ME 04101
Phase I

INTERIOR
ELEVATIONS
2ND FLOOR
HALLWAY

A4.5