

2 EXISTING FIRST FLOOR PLAN  
1/4"=1'-0"

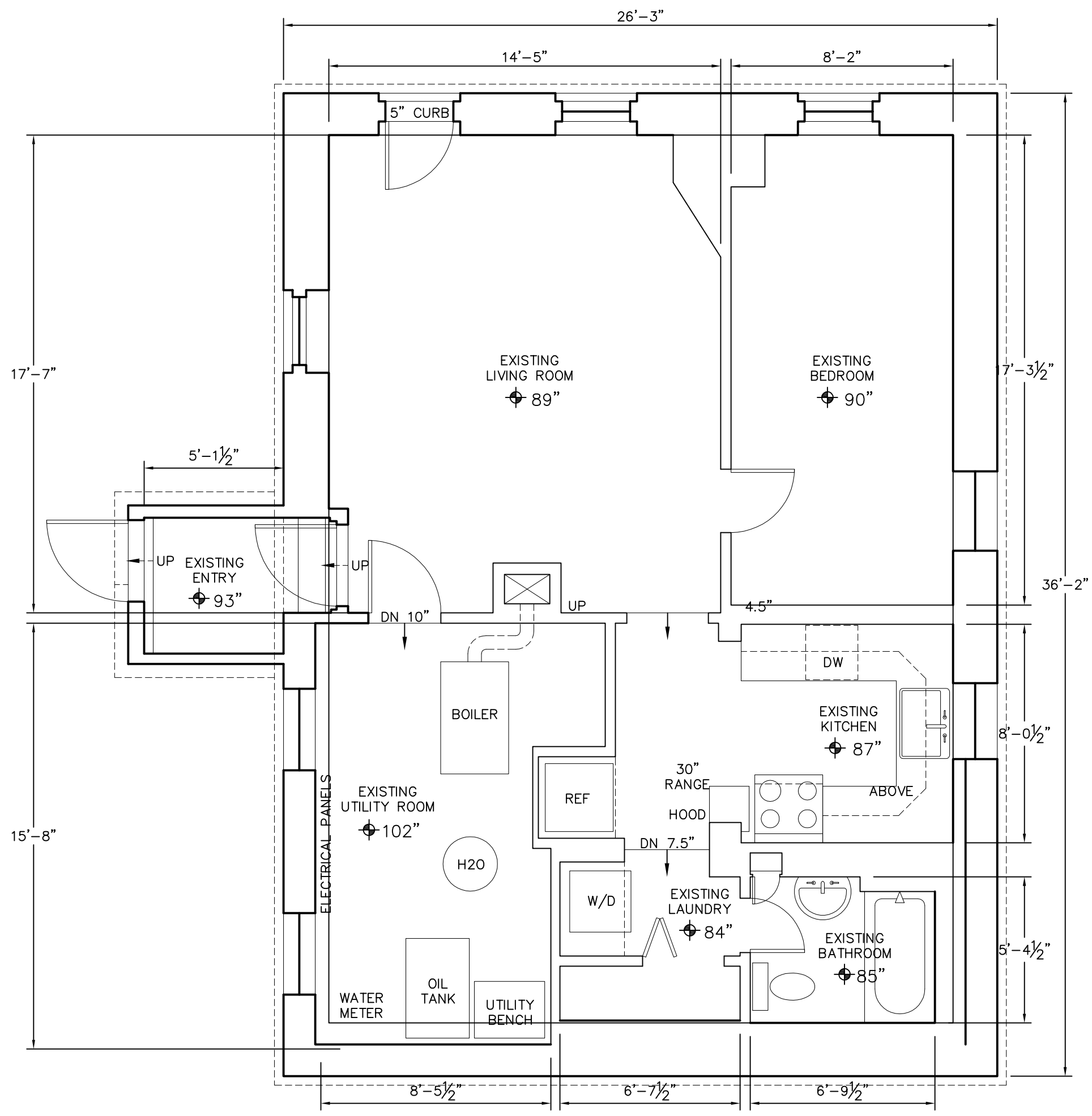

1 EXISTING GROUND FLOOR PLAN  
1/4"=1'-0"

**NOT FOR CONSTRUCTION. FOR INTERIOR DEMO ONLY.**

DATE	NOTES
2017.12.18	Interior Non-Structural Demolition Permit
REVISED	



PROJECT  
Renovations to  
123 Cumberland Ave.  
Portland, ME

EXISTING GROUND &  
1st FLOOR PLANS

**AE1.1**

Rachel Conly Design LLC  
26 Sterling Street  
Peaks Island, Maine 04108  
207.766.5625  
www.rachelconlydesign.com