

PLANTING NOTES:

1. ALL PLANT SELECTION AND INSTALLATION WILL BE IN COMPLIANCE WILL THE CITY OF PORTLAND TECHNICAL MANUAL (SECTION 4).
2. CONTRACTOR TO VERIFY ALL UTILITIES ON PROPERTY AND TO PROTECT ALL UTILITIES DURING EXCAVATION FOR PLANTS.
3. IF THERE IS A DISCREPANCY BETWEEN THE NUMBER OF PLANTS SHOWN ON THE PLAN AND THE NUMBER OF PLANTS SHOWN IN PLANT LIST (IF ANY), THE NUMBER OF PLANTS SHOWN ON PLAN WILL TAKE PRECEDENCE.
4. ALL MATERIAL SHALL COMPLY WITH THE LATEST EDITION OF THE AMERICAN STANDARD FOR NURSERY STOCK, AMERICAN ASSOCIATION OF NURSERYMAN.
5. THE ENGINEER MAY TAG ALL PLANTS AT THE NURSERY AND INSPECT THEM AFTER DELIVERY TO THE SITE. ALL PLANT MATERIALS SHALL BE INSPECTED BY THE ENGINEER ON SITE PRIOR TO INSTALLATION.
6. ALL PROPOSED PLANTS SHALL BE LOCATED CAREFULLY AS SHOWN ON THE PLANS AND THE PLACEMENTS SHALL BE APPROVED BY ENGINEER BEFORE THE PLANTS ARE INSTALLED.
7. ALL DISTURBED AREAS NOT TO BE PAVED OR PLANTED SHALL BE LOAMED AND SEEDDED AS SHOWN. THE SEED MIX SPECIFICATIONS ARE AS FOLLOWS: LESCO FINE FESCUE LINKS BLEND OF 35% HARD FESCUE, 35% CREEPING RED FESCUE, 20% CHEWINGS FESCUE AND 10% SHEEP FESCUE. ADD 5% LITTLE BLUESTEM AND 5% NORTHEAST WILDFLOWER SEED MIXTURE BY WEIGHT TO THE LINKS BLEND.
8. STAKING AND GUYING SHALL BE DETERMINED BY THE ENGINEER ON A TREE BY TREE BASIS. FOR PRICING PURPOSES, PROVIDE A PER TREE UNIT COST FOR STAKING AND GUYING. IF STAKING AND GUYING IS REQUIRED, REMOVE TREE WRAP, STAKES, AND GUY WIRES AT END OF FIRST GROWING SEASON.
9. FOR TREE PLANTING IN LAWN AREAS, ANY DISTURBED LAWN SHALL BE LOAMED AND SEEDDED AS NECESSARY.

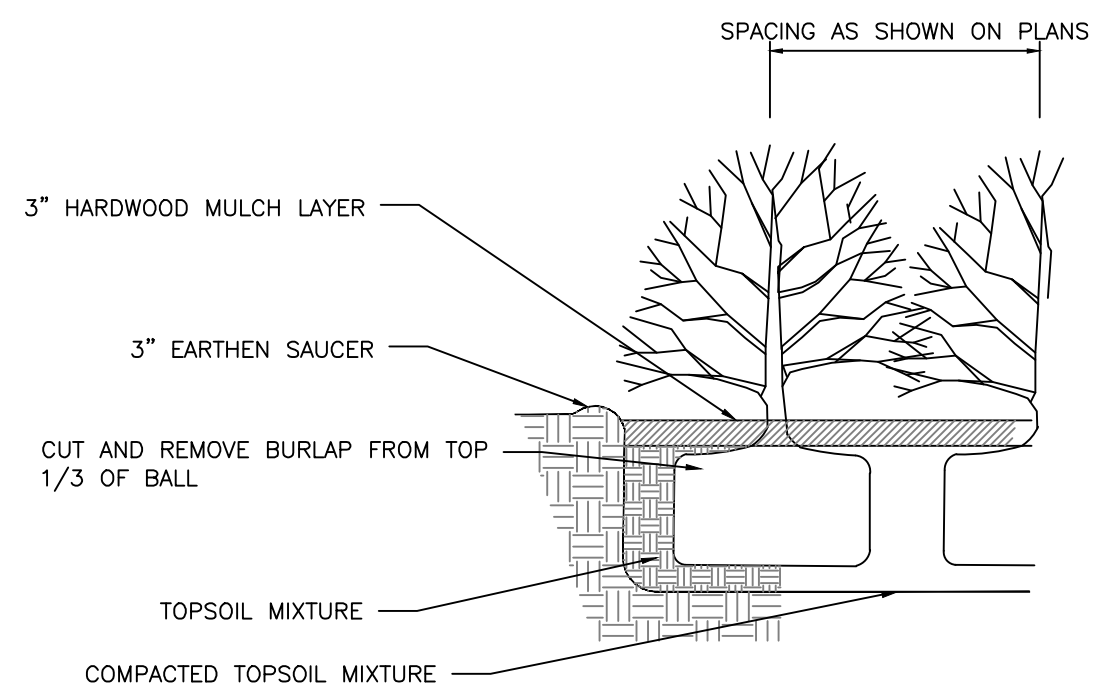

SHRUB PLANTING DETAIL
NOT TO SCALE

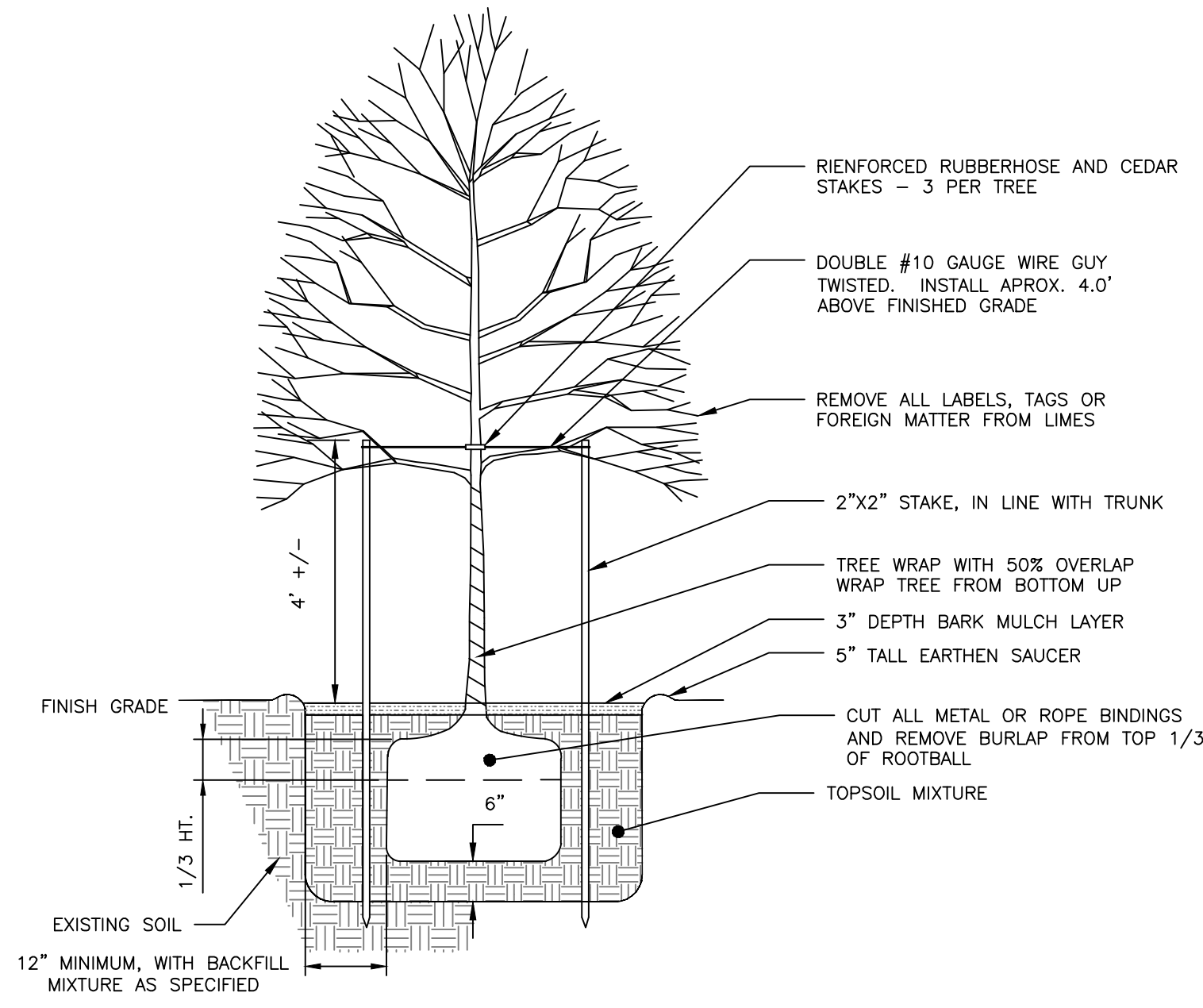

TREE PLANTING DETAIL
NOT TO SCALE

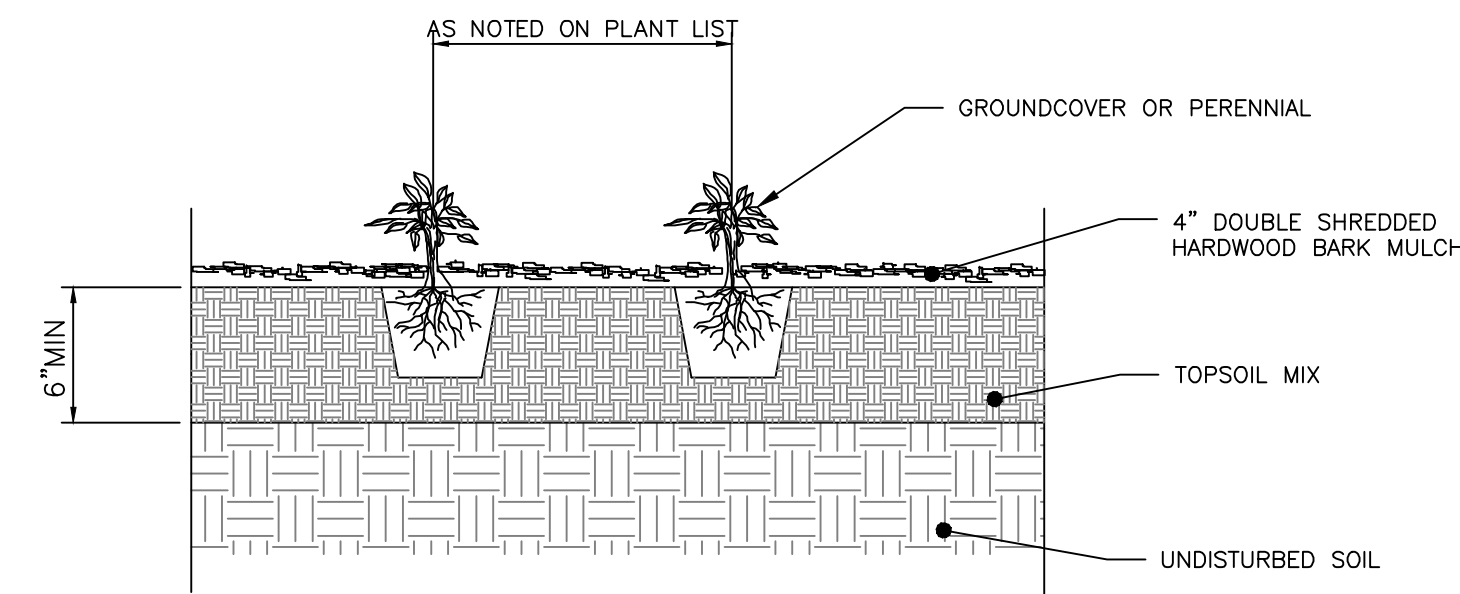

PERENNIAL PLANTING DETAIL
NOT TO SCALE

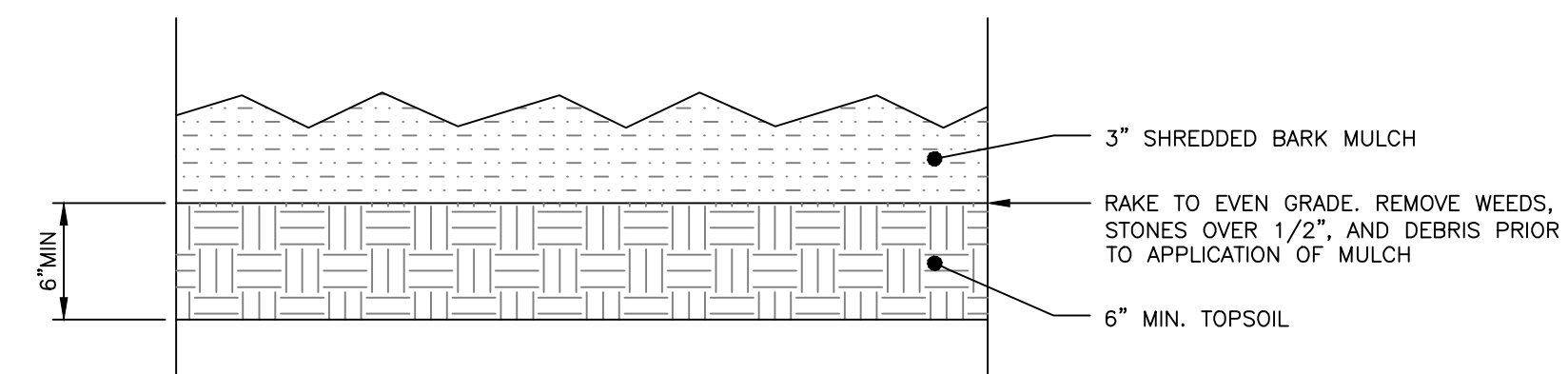

BARK MULCH DETAIL
NOT TO SCALE

NOTES:

1. DIG HOLE AT LEAST 2 TIMES THE DIAMETER OF THE ROOT BALL AND AS DEEP AS THE ROOT BALL (NO DEEPER). SET ROOT BALL CENTERED, WITH THE TOP AT DOWNHILL EDGE OF THE HOLE.
2. TOPSOIL BACKFILL SHALL BE NATURAL FRABLE, FERTILE, FINE LOAMY SOIL POSSESSING THE CHARACTERISTICS OF TOPSOIL IN THE VICINITY WHICH PRODUCE A HEAVY GROWTH. TOPSOIL SHALL CONTAIN NOT LESS THAN 6% NOR MORE THAN 20% ORGANIC MATTER. TOP SOIL SHALL HAVE A pH VALUE OF NOT LESS THAN 5.5 NOR MORE THAN 7.0.
3. CONTAINER GROWN STOCK - REMOVE CONTAINER PROTECTING THE ROOT BALL, GENTLY COMB OUT THE ROOTS, PRUNE DAMAGED ROOTS.
4. BACKFILL THE HOLE WITH TOPSOIL TO A DEPTH NOT TO EXCEED 8" THEN WATER SUFFICIENTLY TO SETTLE TOPSOIL. REPEAT SOIL BACKFILL, WATER, DRAIN, TOPSOIL SHALL BE TAMPED UNDER EDGES OF THE BALLED PLANTS, BACKFILL TO FINISH GRADE AND CREATE AN EARTHEN SAUCER. SOAK PLANTS TWICE WITHIN THE FIRST TWENTY-FOUR HOURS OF PLANTING.

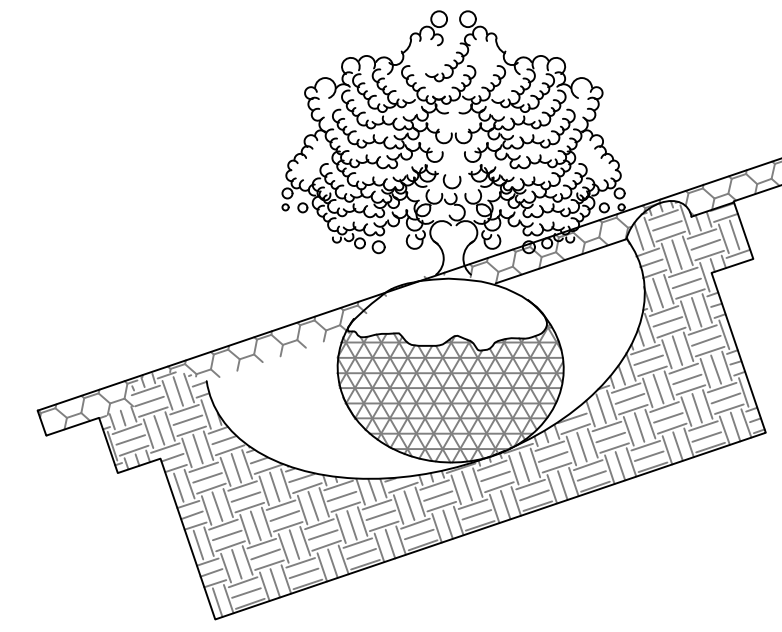

TYPICAL PLANTING
NOT TO SCALE

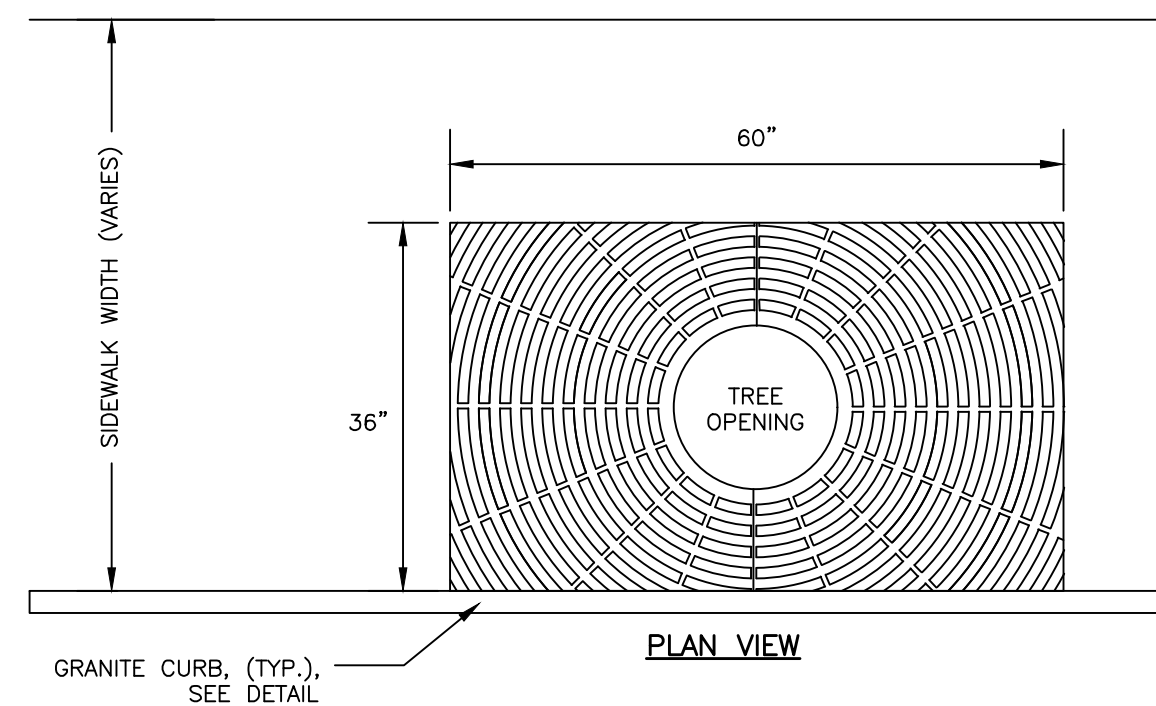

EXPANDABLE TREE GRATE
NEENAH MODEL R-8810
NOT TO SCALE

NOTES:

1. 16" EXPANDABLE TREE OPENING; .25" SLOT OPENINGS.
2. SIDEWALK MATERIAL PER PLAN. WHEN INSTALLED IN A BRICK SIDEWALK, GRATE REQUIRES A FRAME TO BE INSTALLED TO HOLD GRATE IN PLACE. CONTRACTOR TO INSTALL IN ACCORDANCE WITH MANUFACTURER'S INSTALLATION PROCEDURE FOR PAVERS. CONTRACTOR TO SUBMIT INSTALLATION PROCEDURES FOR REVIEW FROM ENGINEER PRIOR TO CONSTRUCTION.

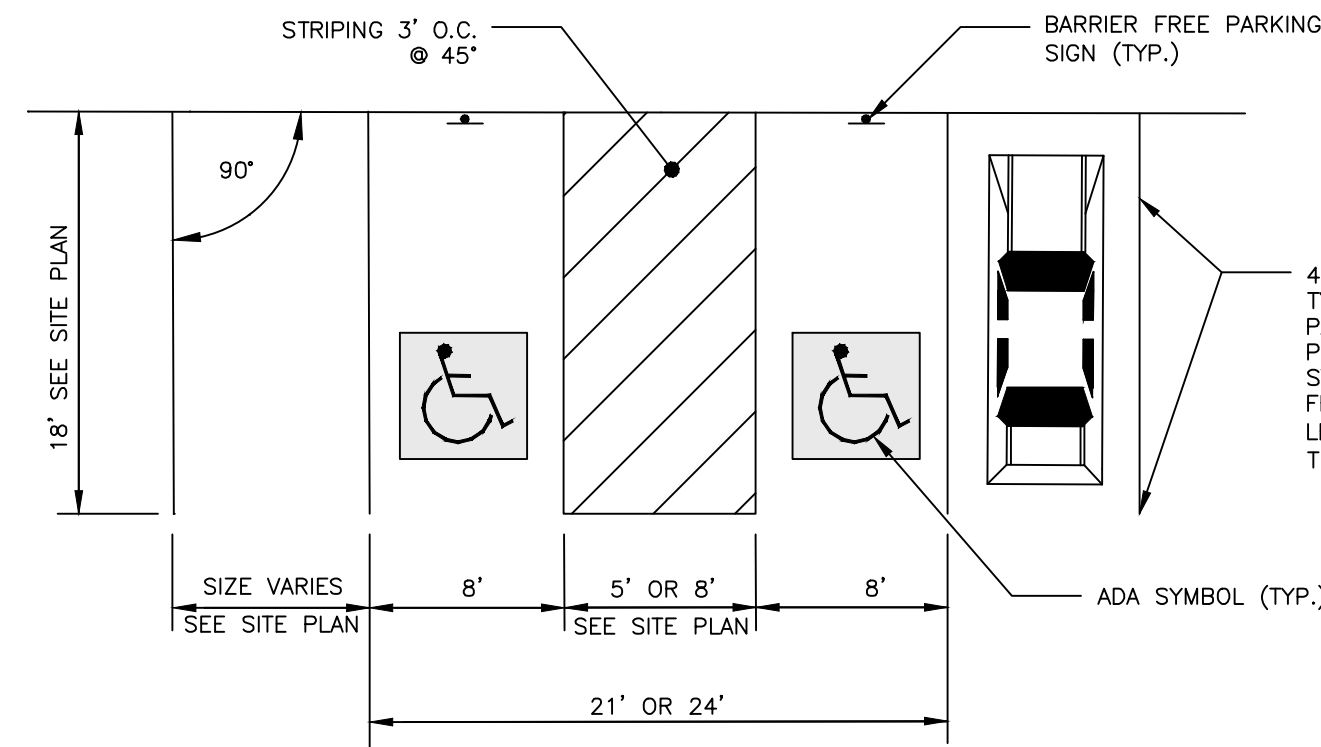

PARKING SPACE DIMENSIONS
NOT TO SCALE

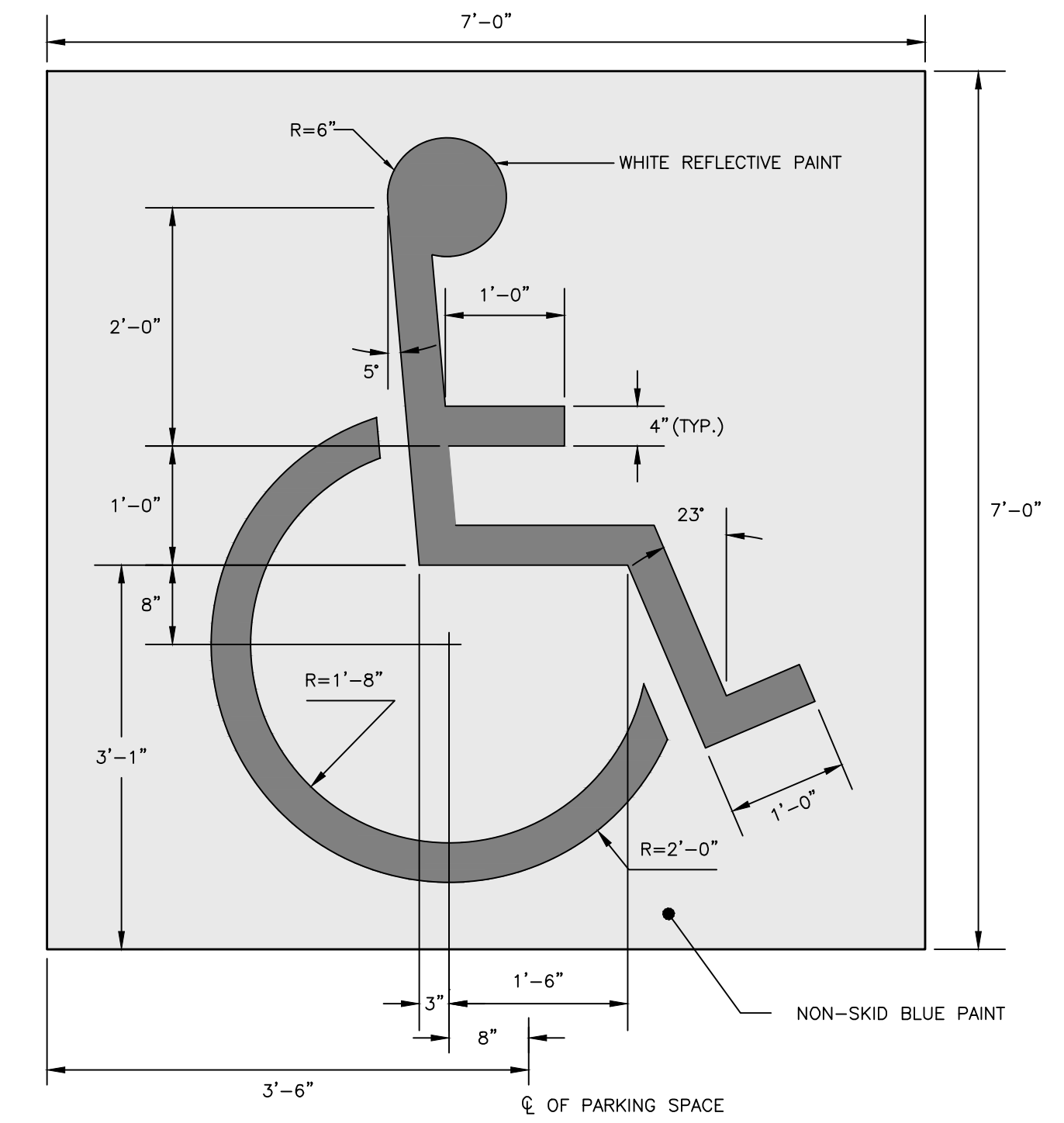

INTERNATIONAL BARRIER FREE SYMBOL
NOT TO SCALE

NOTES:

1. ALL ASPECTS OF RESERVED PARKING SIGN CONSTRUCTION SHALL BE IN ACCORDANCE WITH MANUAL ON UNIFORM TRAFFIC CONTROL DEVICES, 2009 OR MOST RECENT EDITION
2. SIGN SHALL BE CONSTRUCTED AS SIGN R7-8 UNDER THE "PARKING AND STANDING SIGNS AND PLAQUES" (R7 SERIES) WITHIN THE MANUAL ON UNIFORM TRAFFIC CONTROL DEVICES, 2009 OR MOST RECENT EDITION. VAN ACCESSIBILITY SHALL BE CONSTRUCTED AS SIGN R7-8a OR R7-8b.
3. SIGN POST CONSTRUCTION AND MOUNTING SHALL BE IN ACCORDANCE WITH CHAPTER 2A OF THE MANUAL ON UNIFORM TRAFFIC CONTROL DEVICES, 2009 OR MOST RECENT EDITION.

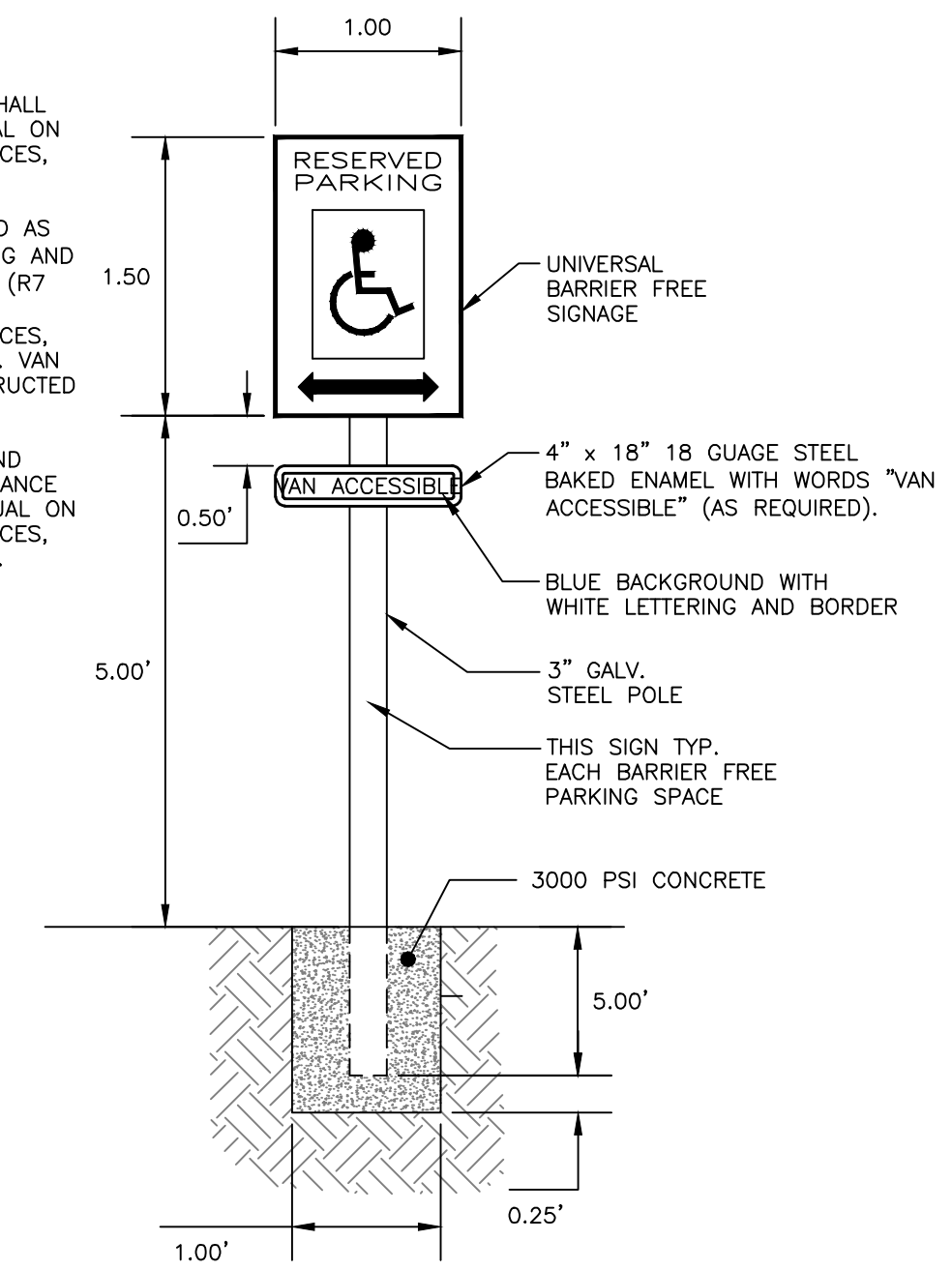

BARRIER FREE PARKING SIGN
NOT TO SCALE

PRELIMINARY
NOT ISSUED FOR
CONSTRUCTION

ISSUED FOR	BY
PRELIM APP	WHS
	3/28/17

SITE DETAILS - 2
155 SHERIDAN STREET
VAZZA REAL ESTATE GROUP
BD SHERIDAN, LLC
1266 FURNACE BROOK PARKWAY, SUITE 300 QUINCY, MA 02169

ENGINEERING, INC.

A C O R N

158 BANKFOURTH ST. PORTLAND, MAINE 04102
 (207) 775-2655

FILE:	CIVIL_1069
JN:	1069
SCALE:	NTS
DESIGNED BY:	WHS
DRAWN BY:	SJL
CHECKED BY:	WHS

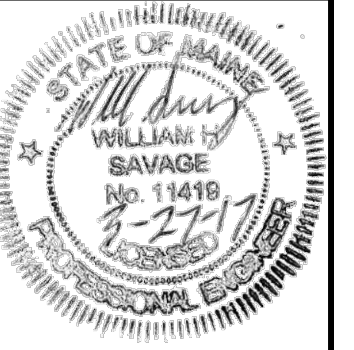

DRAWING NO.
C-41