

GENERAL NOTES

1. DRAWING NOTES:
CONTRACTOR TO FURNISH AND INSTALL ALL NOTED LABOR AND MATERIALS UNLESS OTHERWISE NOTED.

2. CODE COMPLIANCE:
ALL WORK SHALL CONFORM TO THE LATEST EDITION OF STATE, LOCAL AND OTHER CODES WHICH APPLY TO THIS PROJECT OR HAVE JURISDICTION.

3. COORDINATION:
IT IS THE RESPONSIBILITY OF THE CONTRACTOR TO COORDINATE ALL DISCIPLINES AND TRADES SO THAT ALL BUILDING SYSTEMS AND COMPONENTS CAN BE ASSEMBLED WITHOUT CONFLICTS. IN THE EVENT THAT THE CONSTRUCTION DOCUMENTS DEFINE CONDITIONS WHICH PROHIBIT, OR MAY PROHIBIT, SUCH ASSEMBLY, THE CONTRACTOR SHALL BRING TO THE ARCHITECTS ATTENTION, IN WRITING AND IN A TIMELY FASHION, SUCH CONDITION. THE CONTRACTOR SHALL NOT PROCEED WITH RELATED WORK WITHOUT A WRITTEN RESOLUTION CLARIFICATION FROM THE ARCHITECT.
THE CONTRACTOR AND HIS/HER SUBCONTRACTORS SHALL BE RESPONSIBLE FOR PROVIDING MATERIALS AND SYSTEMS SHOWN IN THE CONSTRUCTION DOCUMENTS REGARDLESS OF WHERE THE INFORMATION IS LOCATED. WHERE COMPONENTS OF A SYSTEM ARE INDICATED THE CONTRACTOR SHALL BE RESPONSIBLE FOR PROVIDING ALL LABOR AND MATERIALS NECESSARY TO COMPLETE THE SYSTEM.

4. DISCREPANCIES & CLARIFICATIONS:
EXISTING DIMENSIONS SHOWN ON THE DRAWINGS ARE BELIEVED TO BE ACCURATE, BUT CANNOT BE GUARANTEED. MEASURE AND VERIFY DIMENSIONS IN FIELD PRIOR TO FABRICATION AND CONSTRUCTION. IT IS THE RESPONSIBILITY OF THE CONTRACTOR TO BRING TO THE ARCHITECTS ATTENTION, IN WRITING, ANY DISCREPANCIES OR AMBIGUITIES IN THE DRAWINGS AND/OR SPECIFICATIONS. THE CONTRACTOR SHALL NOT PROCEED WITH RELATED WORK WITHOUT A WRITTEN RESOLUTION OR CLARIFICATION FROM THE ARCHITECT.

5. LAYOUT:
UNLESS INDICATED OTHERWISE, CENTER WALL FRAMING AND PARTITION FRAMING ON COLUMN LINES. FLOOR PLAN DIMENSIONS ARE TO CENTER OF FRAMING, FACE OF CONCRETE, FACE OF CMU, OR FROM COLUMN CENTERLINES, UNLESS INDICATED OTHERWISE. DOORS AND WINDOWS ARE DIMENSIONED TO CENTERLINES UNLESS INDICATED OTHERWISE.

6. CENTERING:
UNLESS INDICATED OTHERWISE, CENTER BUILDING ELEMENTS WITHIN OR BETWEEN OTHER BUILDING ELEMENTS WHEN CONDITIONS OR THE DRAWINGS INDICATE OR IMPLY THAT SUCH IS THE INTENT, WHETHER OR NOT DIMENSIONS ARE INCLUDED.

7. SYMMETRY:
WHERE CONDITIONS OR THE DRAWINGS INDICATE OR IMPLY THAT SYMMETRY IS INTENDED, INFORMATION PROVIDED AT ONE SIDE APPLIES EQUALLY TO BOTH SIDES, UNLESS CONDITIONS CLEARLY PRECLUDE SUCH APPLICATION.

8. ACCESSIBILITY:
ALL HANDICAPPED ACCESSIBLE BATHROOMS, GRAB BARS, AND DOOR OPENINGS SHALL MEET THE REQUIREMENTS OF TITLE 94-348, CHAPTER 5 OF THE MAINE HUMAN RIGHTS COMMISSION TITLE LATEST EDITION & THE DEPARTMENT OF JUSTICE ADA STANDARDS FOR ACCESSIBLE DESIGN.

9. DRAWING SCALES:
WORK FROM THE GIVEN DIMENSIONS ONLY. SCALE IS INDICATED ON THE DRAWINGS FOR CONVENIENCE ONLY. IT IS NOT INTENDED THAT INFORMATION BE DETERMINED BY SCALING THE DRAWINGS SINCE SOME ITEMS MAY NOT BE TO SCALE.

10. WATER-RESISTANT GWB:
INSTALL WATER-RESISTANT GYPSUM WALL BOARD IN ALL REST ROOMS & TOILET ROOMS OR AT ANY WALL WITH PLUMBING FIXTURES.

10A. HIGH IMPACT GWB:
INSTALL HIGH IMPACT GYPSUM WALL BOARD IN ALL STAIRWELLS

11. INTERIOR ELEVATIONS:
INTERIOR ELEVATIONS MAY BE REVERSED FROM AND/OR SIMILAR TO ACTUAL CONDITIONS. SEE FLOOR PLANS FOR WINDOW AND DOOR QUANTITIES AND LOCATIONS, FOR CASEWORK LAYOUTS, AND FOR MONITOR LOCATIONS.

12. BUILDING INSULATION:
PROVIDE AS INDICATED IN WALL SECTIONS AND IN ACCORDANCE WITH PARTITION TYPES, WHETHER OR NOT SHOWN IN DETAILS AND OTHER DRAWINGS. FOR CLARITY, INSULATION MAY NOT BE SHOWN IN SOME CASES, EVEN IF IT IS TO BE PROVIDED.

13. BLOCKING:
INSTALL BLOCKING BEHIND ALL SURFACE-APPLIED FIXTURES TRIM, CASEWORK, SHELVES, BRACKETS, TOILET ACCESSORIES, CHAIR RAILS, PICTURE RAILS, GRAB BARS, BASE MOLDINGS, AND AS OTHERWISE REQUIRED, WHEN SUCH ITEMS ARE APPLIED ON STUD WALLS.

14. PENETRATIONS AT STRUCTURAL MEMBERS:
BEFORE PENETRATING JOISTS, BEAMS OR OTHER STRUCTURAL MEMBERS, CONSULT WITH THE ARCHITECT.

15. DAMAGED WORK:
BUILDING OR SITE COMPONENTS WHICH ARE AFFECTED BY NEW WORK, DEMOLITION, OR WHICH MAY BE DAMAGED BY THE GENERAL CONTRACTOR OR ANY SUB-CONTRACTOR SHALL BE REPLACED OR RESTORED TO ORIGINAL CONDITION AND COLOR TO MEET THE APPROVAL OF THE ARCHITECT.

16. UTILITIES:
VERIFY THE SIZE AND LOCATION OF ALL UNDERGROUND UTILITIES AND REPORT ANY DISCREPANCIES TO THE ARCHITECT IN WRITING. DO NOT PROCEED WITH WORK UNTIL THE DISCREPANCY HAS BEEN RESOLVED TO THE SATISFACTION OF THE ARCHITECT.

17. RATED CONSTRUCTION:
PROVIDE RATED CONSTRUCTION AS REQUIRED BY CODE, AS SPECIFIED, AND AS INDICATED ON DRAWINGS. IT IS THE RESPONSIBILITY OF THE CONTRACTOR TO PROVIDE AND INSTALL ALL COMPONENTS REQUIRED TO CREATE SUCH RATED CONSTRUCTION, REGARDLESS OF WHETHER OR NOT SUCH COMPONENTS ARE INDICATED. PROVIDE CONTINUITY OF SUCH RATED CONSTRUCTION AROUND AND BETWEEN SPACES, INCLUDING AT CHASES AND AT FLOORS, TO MAINTAIN COMPLETE SEPARATIONS, EVEN IF NOT SPECIFICALLY INDICATED.

18. SHOP DRAWINGS:
SUBMIT SHOP DRAWINGS TO THE ARCHITECT FOR REVIEW PRIOR TO FABRICATIONS. SUBMITTALS REQUIRED INCLUDE, BUT ARE NOT LIMITED TO, SHOP DRAWINGS FOR ALL PREFABRICATED CONCRETE, STEEL, MILLWORK & SIGNAGE, SAMPLES OF ALL PROPOSED PAINTS, METALS, WALL COVERINGS, LAMINATES, SOLID SURFACE MATERIALS, CERAMIC TILE, AND HARDWARE. SUBMIT MANUFACTURERS' DATA FOR ALL LIGHTING SYSTEMS, AND HARDWARE.

19. PERMITS:
THE GENERAL CONTRACTOR SHALL OBTAIN AND PAY FOR ANY BUILDING PERMITS REQUIRED AND CARRY ANY INSURANCE COVERAGES REQUIRED.

20. INTERIOR FINISHES:
ALL INTERIOR FINISHES AND FURNISHINGS ARE TO BE CLASS 'A' FIRE-RATED AND ARE TO COMPLY WITH SECTION 920.0 BOCA (INTERIOR FLAME SPREAD).

21. ELECTRICAL DESIGN:
REFER TO ELECTRICAL DRAWINGS AND SPECIFICATIONS

22. WASTE REMOVAL:
THE GENERAL CONTRACTOR SHALL DISPOSE OF ALL WASTE AND DEBRIS OFF THE PREMISES.

23. LANDLORD COORDINATION:
THE GENERAL CONTRACTOR MUST COORDINATE WITH THE BUILDING OWNER ALL ACTIVITIES INCLUDING BUT NOT LIMITED TO WORK WHICH WILL GENERATE EXCESSIVE NOISE AND MODIFICATION TO UTILITIES. WORK MUST NOT INTERFERE WITH EXISTING SMOKE DETECTORS, ALARMS OR BUILDING SYSTEM MANAGEMENT.

24. TEMPORARY FACILITIES:
PROVIDE ALL TEMPORARY FACILITIES AND SERVICES, CONSTRUCTION AND SUPPORT FACILITIES, AND SECURITY AND PROTECTION AS NEEDED TO PROTECT NEW AND EXISTING CONSTRUCTION FOR THE DURATION OF A COMPLETE INSTALLATION.

25. FINAL CLEANING:
EMPLOY EXPERIENCED WORKERS FOR FINAL CLEANING. CLEAN EACH SURFACE TO THE CONDITION EXPECTED IN A COMMERCIAL BUILDING CLEANING PROGRAM.

26. MANUFACTURERS INSTRUCTIONS:
ALL MATERIALS & EQUIPMENT SHALL BE INSTALLED ACCORDING TO MANUFACTURER'S SPECIFICATIONS.

27. GUARANTEE:
GUARANTEE: ALL MATERIALS AND WORKMANSHIP SHALL BE GUARANTEED FOR A PERIOD OF ONE YEAR FROM THE DATE OF FINAL ACCEPTANCE UNLESS OTHERWISE SPECIFIED FOR A LONGER PERIOD OF TIME ON A CERTAIN ITEM.

28. ASBESTOS:
ALL MATERIAL USED FOR THE CONSTRUCTION OF THIS PROJECT, WHETHER BUILDING MATERIALS OR APPURTENANCES, SHALL BE NON-ASBESTOS CONTAINING MATERIAL.

29. HAZARDOUS FUMES:
THE GENERAL CONTRACTOR SHALL CONFIRM THAT ALL MATERIAL AND FINISHES SPECIFIED AND THEIR FABRICATION OR INSTALLATION WILL NOT RELEASE FUMES OR AROMAS DURING CONSTRUCTION WHICH MAY BE A HAZARD OR NUISANCE TO PERSONNEL.

30. PEST CONTROL:
SEAL AND CAULK AROUND ALL PENETRATIONS, CRACKS AND CREVICES AND ANY OPENINGS CAPABLE OF HARBORING INSECTS/RODENTS.

31. EXPOSED UTILITIES:
ALL EXPOSED UTILITY WIRES AND PIPES (ELECTRICAL, PLUMBING, ETC.) SHALL BE INSTALLED IN A WAY THAT DOES NOT OBSTRUCT OR PREVENT THE CLEANING OF FLOORS, WALLS, AND CEILING AREAS. THEY SHALL BE INSTALLED A MINIMUM OF 6" OFF FLOORS AND 1" OFF WALLS, CEILINGS AND ADJACENT PIPES.

32. OWNER SUPPLIED EQUIPMENT:
EQUIPMENT SUPPLIED BY THE OWNER AND INSTALLED BY THE GENERAL CONTRACTOR. EQUIPMENT INFORMATION AND SPECIFICATIONS ARE TO BE THE MOST CURRENT AVAILABLE AT THE TIME OF DOCUMENTATION PREPARATION. THE GENERAL CONTRACTOR SHALL BE RESPONSIBLE FOR VERIFYING WITH THE OWNER THE EXACT DIMENSIONS AND EQUIPMENT CONNECTION REQUIREMENTS (INCLUDING ELECTRICAL CIRCUIT REQUIREMENTS) OF EQUIPMENT TO BE SUPPLIED. THE GENERAL CONTRACTOR SHALL MAKE ALL FINAL CONNECTIONS AS NOTED ON THE DRAWINGS, INSTALL THE SET UP IN WORKING ORDER, CHECK WARRANTIES, TEST AND NOT VOID WARRANTIES. THE GENERAL CONTRACTOR SHALL COORDINATE WITH THE OWNER DELIVERY, STORAGE AND INSTALLATION OF ALL OWNER SUPPLIED EQUIPMENT. THE GENERAL CONTRACTOR SHALL STORE EQUIPMENT IF REQUESTED BY THE OWNER UNTIL INSTALLATION. SEE DRAWINGS FOR OTHER OWNER SUPPLIED/GENERAL CONTRACTOR INSTALLED ITEMS.

33. FIRE PROTECTION NOTE:
EXISTING SPRINKLER HEADS, ALARM SYSTEM AND DETECTORS ARE TO BE MODIFIED TO CONFORM, WITH THE PROPOSED PLAN. COORDINATE WITH THE ARCHITECT, ANY MODIFICATION OR LOCATIONS WHERE EXISTING SYSTEMS ARE AFFECTED BY THE NEW DESIGN.

34. SOILS AT FOOTINGS:
REPORT THE LOCATION OF ALL UNSUITABLE SOILS AND MATERIALS BELOW ANTICIPATED LEVEL OF FOOTING TO THE ARCHITECT PRIOR TO THE SETTINGS OF FORMS.

35. ACCESS PANELS:
CONTRACTOR IS RESPONSIBLE FOR COORDINATING QUANTITY AND LOCATION OF ALL REQUIRED ACCESS PANELS FOR ALL MEP CONTROLS, CLEANOUTS, DAMPERS, PULL BOXES, ETC.

36. EXISTING HAZARDOUS MATERIALS
ALL HAZARDOUS MATERIALS INCLUDING BUT NOT LIMITED TO ASBESTOS AND LEAD PAINT ARE TO BE HANDLED, ENCAPSULATED, ABATED AND DISPOSED OF IN ACCORDANCE WITH ANY AND ALL FEDERAL, STATE AND LOCAL REQUIREMENTS AND REGULATIONS.

37. INDUSTRY STANDARDS:
ALL WORK SHALL BE PERFORMED IN ACCORDANCE WITH INDUSTRY STANDARDS. STANDARDS INCLUDE BUT ARE NOT LIMITED TO THE FOLLOWING:

- AAMA AMERICAN ARCHITECTURAL MANUFACTURERS ASSOCIATION
- ACI AMERICAN CONCRETE INSTITUTE
- ANSI AMERICAN NATIONAL STANDARDS INSTITUTE
- ASTM AMERICAN SOCIETY FOR TESTS AND MATERIALS
- AWI ARCHITECTURAL WOODWORK INSTITUTE "CUSTOM GRADE"
- AWWMA AMERICAN WELDING SOCIETY
- IGMA INSULATING GLASS MANUFACTURERS ALLIANCE
- NAAMM NATIONAL ASSOCIATION OF ARCHITECTURAL METAL MANUFACTURERS
- NBCA NATIONAL ROOFING CONTRACTORS ASSOCIATION
- NTCA NATIONAL TILE CONTRACTORS ASSOCIATION
- SMACNA SHEET METAL AND AIR CONDITIONING NATIONAL ASSOCIATION
- WDMA WINDOW AND DOOR MANUFACTURERS ASSOCIATION

ABBREVIATIONS

A AC	AIR CONDITIONING	L LAB	LABORATORY
ACT ACCT	ACOUSTICAL CEILING TILE	LAM LAMINATED	LAMINATED
AD AREA DRAIN	AD	LB LEAD	LEAD
ADAAG ACCESSIBILITY WITH DISABILITIES ACT	ADAAG	LCC LEAD COATED COPPER	LCC
ADD ADDENDUM	ADD	M MACH	MACHINE
AFF ABOVE FINISHED FLOOR	AFF	MAS MASONRY	MASONRY
AHU AIR-HANDLING UNIT	AHU	MATL MATERIAL	MATERIAL
AL ALUMINUM	AL	MAX MAXIMUM	MAXIMUM
ARCH ARCHITECT/ARCHITECTURAL	ARCH	MDO MEDIUM-DENSITY OVERLAY	MDO
AWP ACOUSTIC WALL PANEL	AWP	MECH MECHANICAL	MECHANICAL
B B	B	MEMB MEMBRANE	MEMBRANE
B TO BLS BACK-TO-BACK ANGLES	B TO BLS	MET METAL	METAL
B.B.G.C. BASE BUILDING GENERAL CONTRACTOR	B.B.G.C.	MEZZ MEZZANINE	MEZZANINE
BL BUILDING LINE	BL	MFR MANUFACTURER	MANUFACTURER
BLDG BUILDING	BLDG	MIN MINIMUM	MINIMUM
BLKS BLOCKING	BLKS	MISC MISCELLANEOUS	MISCELLANEOUS
BMT BASEMENT	BMT	MO MASONRY OPENING	MASONRY OPENING
BTWN BETWEEN	BTWN	MTD MOUNTED	MOUNTED
BO BY OTHERS	BO	MB METAL MARKER BOARD	METAL MARKER BOARD
C C	C	N N	NORTH
CER COURSE (MASONRY)	CER	# NUMBER	NUMBER
CG CERAMIC	CG	NC NOT IN CONTACT	NOT IN CONTACT
CG CORNER GUARD	CG	NOM NOMINAL DIMENSION	NOMINAL DIMENSION
CH COAT HOOK	CH	NTS NOT TO SCALE	NOT TO SCALE
CJ CONTROL JOINT	CJ	O O	ON/OVER
CLG CENTER LINE	CLG	OC ON CENTER	ON CENTER
CMU CONCRETE MASONRY UNIT	CMU	OD OUTSIDE DIAMETER/OUTSIDE DIMENSION	OUTSIDE DIAMETER/OUTSIDE DIMENSION
OD COLUMN	OD	OFF OFFICE	OFFICE
COL COLUMN	COL	OPNG OPENING	OPENING
CONC CONCRETE	CONC	OPSP OPPOSITE	OPPOSITE
CONSTR CONSTRUCTION	CONSTR	OPPH OPPOSITE HAND	OPPOSITE HAND
CONN CONNECT/CONNECTION	CONN	OSB ORIENTED STRAND BOARD	ORIENTED STRAND BOARD
CONSTR CONSTRUCTION	CONSTR	OZ OUNCE	OUNCE
CONT CONTINUOUS	CONT	P P	PURCHASED BY OWNER INSTALLED BY CONTRACTOR
CORR CORRIDOR	CORR	PBOIBC PURCHASED BY OWNER INSTALLED BY CONTRACTOR	PBOIBC
CORR CORRIDOR	CORR	PC PRECAST	PRECAST
CUI CERAMIC TILE	CUI	PL PLATE	PLATE
CUI CABINET UNIT HEATER	CUI	PLAM PLASTIC LAMINATE	PLASTIC LAMINATE
D DBL	D	PR PR	PRE-FABRICATE
DF DRINKING FOUNTAIN	DF	PRIV PRIVACY	PRIVACY
DIA DIAMETER	DIA	PRIM PRIMED	PRIMED
DIFF DIFFUSER	DIFF	PSF POUNDS PER SQUARE FOOT	POUNDS PER SQUARE FOOT
DIM DIMENSION	DIM	PSI POUNDS PER SQUARE INCH	POUNDS PER SQUARE INCH
DN DOWN	DN	PTD PAINTED	PAINTED
DR DOOR	DR	PTN PARTITION	PARTITION
DSP DRY STAND PIPE	DSP	PVC POLYVINYL CHLORIDE	POLYVINYL CHLORIDE
DWG DRAWING	DWG	PWD POUND	POUND
E E	E	PERF PERFORATED	PERFORATED
E EAST	E	Q Q	QUARRY TILE
EACH EACH	EACH	QTR QUARTER	QUARTER
ELEV ELEVATION	ELEV	R R	RISER/RADIUS
ELCC ELECTRICAL	ELCC	RA RAD	RADIUS
ELEV ELEVATION	ELEV	RB RUBBER BASE	RUBBER BASE
ENTR ENTRANCE	ENTR	RC REFLECTED CEILING PLAN	REFLECTED CEILING PLAN
EQUA EQUIVALENT	EQUA	RD ROOF DRAIN	ROOF DRAIN
EQUIP EQUIPMENT	EQUIP	REBAR REINFORCING BAR	REINFORCING BAR
EXP EXPANSION	EXP	REF REFRIGERATOR	REFRIGERATOR
EXPB EXPANSION BOLT	EXPB	REIN REINFORCED	REINFORCED
EXPJ EXPANSION JOINT	EXPJ	REQ REQUIRED	REQUIRED
EXT EXTERIOR	EXT	RES RESILIENT	RESILIENT
EPDM ETHYLENE PROPYLENE DIENE MONOMER	EPDM	REV REVERSE	REVERSE
EWV ELECTRIC WATER COOLER	EWV	RM ROOM	ROOM
F F	F	RO ROUGH OPENING	ROUGH OPENING
FAHRENHEIT	FAHRENHEIT	ROW RIGHT OF WAY	RIGHT OF WAY
FLAT BAR	FLAT BAR	S S	SOUTH
FIRE EXTINGUISHER AND CABINET	FIRE EXTINGUISHER AND CABINET	SCHED SCHEDULE	SCHEDULE
FLOOR DRAIN	FLOOR DRAIN	SQ SQUARE FEET	SQUARE FEET
FIRE EXTINGUISHER	FIRE EXTINGUISHER	SIM SIMILAR	SIMILAR
FIRE EXTINGUISHER CABINET	FIRE EXTINGUISHER CABINET	SPEC SPECIFICATION	SPECIFICATION
FIRE TREATED WOOD	FIRE TREATED WOOD	SQ SQUARE	SQUARE
FIN FINISH	FIN	SS STAINLESS STEEL	STAINLESS STEEL
FLOOR	FLOOR	ST SOUND TRANSMISSION CLASS	SOUND TRANSMISSION CLASS
FACE OF BRICK	FACE OF BRICK	STD STANDARD	STANDARD
FACE OF CONCRETE	FACE OF CONCRETE	STOR STORAGE	STORAGE
FACE OF FINISH	FACE OF FINISH	STRUCT STRUCTURE/STRUCTURAL	STRUCTURE/STRUCTURAL
FACE OF STUDS	FACE OF STUDS	SUSP SUSPENSION	SUSPENSION
FACE OF WALL	FACE OF WALL	T & G	TONGUE&GROOVE
FIRE SUPPRESSION SYSTEM	FIRE SUPPRESSION SYSTEM	TEL TELEPHONE	TELEPHONE
FOOT	FOOT	THK THICK	THICK
FOOTING	FOOTING	TOD TOP OF DECK	TOP OF DECK
FIBER REINFORCED GYPSUM	FIBER REINFORCED GYPSUM	TOS TOP OF STEEL	TOP OF STEEL
FIN TUBE RADIATION	FIN TUBE RADIATION	TYP TYPICAL	TYPICAL
FUME HOOD	FUME HOOD	TV TELEVISION	TELEVISION
G GA	G	TB TACK BOARD	TACK BOARD
GALV GALVANIZED	GALV	TOC TOP OF CONCRETE	TOP OF CONCRETE
GB GRAB BAR	GB	UL UNDERWRITERS LABORATORIES, INC.	UNDERWRITERS LABORATORIES, INC.
GC GENERAL CONTRACTOR	GC	UV UNIT VENTILATOR	UNIT VENTILATOR
GFI GROUND-Fault INTERRUPTER	GFI	VCT VINYL COMPOSITION TILE	VINYL COMPOSITION TILE
GLASS/LAMINATED GLAZED	GLASS/LAMINATED GLAZED	VERT VERTICAL	VERTICAL
GLUE-LAMINATED WOOD	GLUE-LAMINATED WOOD	VIF VERIFY IN FIELD	VERIFY IN FIELD
GROUND	GROUND	VOL VOLUME	VOLUME
GYPSUM WALL BOARD	GYPSUM WALL BOARD	W W	WEST
H HB	H	WO WITHOUT	WITHOUT
HC HANDICAP	HC	WTH WITH	WITH
HM HOLLOW METAL	HM	WD WOOD	WOOD
HORIZ HORIZONTAL	HORIZ	WF WIDE FLANGE	WIDE FLANGE
HP HORSE POWER/HIGH POINT/HEAT PUMP	HP	WP WORK POINT	WORK POINT
HOUR	HOUR	WT WEIGHT	WEIGHT
HW HOT WATER	HW		
HVAC HEATING VENTILATION AIR CONDITIONING	HVAC		
I I	I		
INSIDE DIMENSION/INSIDE DIAMETER	INSIDE DIMENSION/INSIDE DIAMETER		
IN INCHES	IN		
INFO INFORMATION	INFO		
INSUL INSULATION	INSUL		
J JT	J		
JOIST	JOIST		
JOINT	JOINT		
K KD	K		
KILN-DRIED	KILN-DRIED		
KIP 1000 POUNDS	KIP		

DRAWING LEGEND

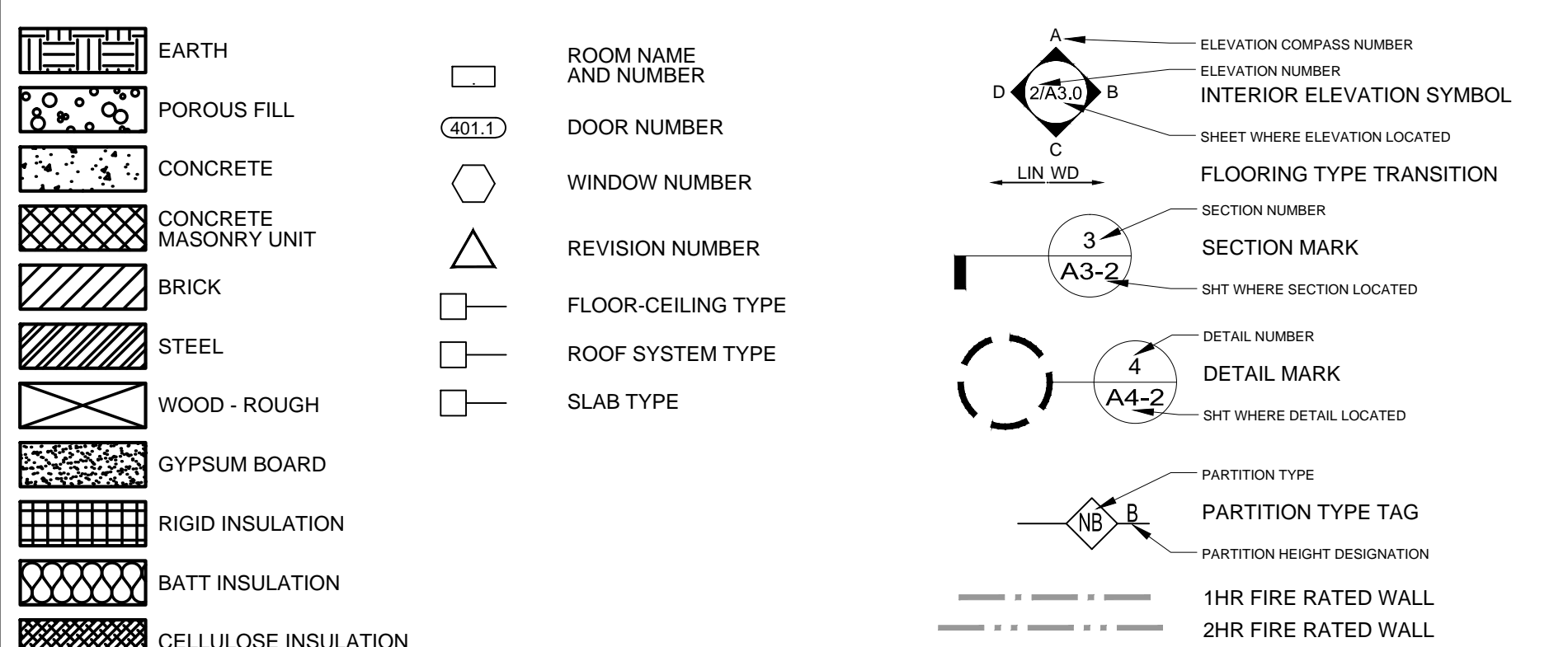

FIRESTOPPING DETAILS

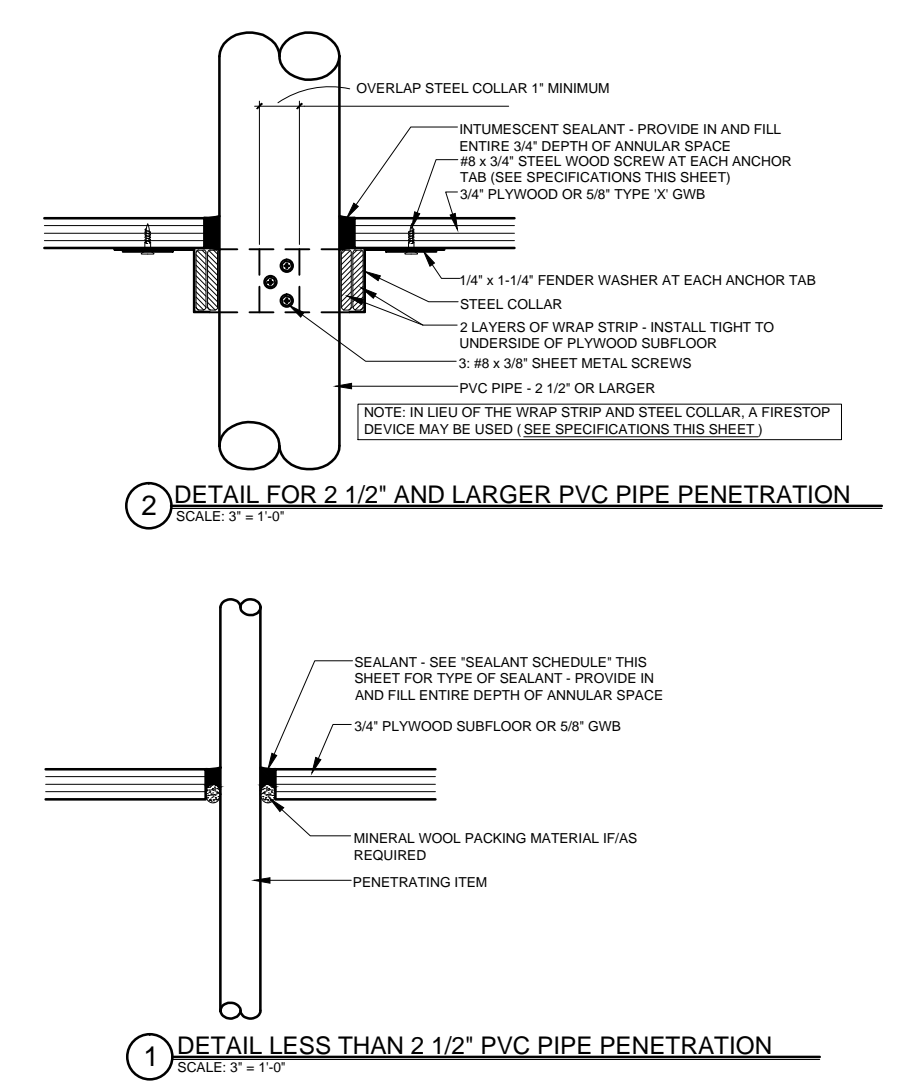

SPECIFICATIONS

WRAP STRIP: 1/4" THICK x 1 1/2" MINIMUM WIDTH INTUMESCENT MATERIAL WITH PLASTIC FILM FACING BOTH SIDES. TEMPORARILY SECURE WITH MAKING TAPE. SPECIFIED TECHNOLOGIES INC. (STI) "SpecSeal RED Wrap Strip" OR "SpecSeal BLU Wrap Strip" OR EQUAL.

STEEL COLLAR: WRAP STRIP MANUFACTURER'S STEEL COLLAR, FABRICATED FROM .016 INCH THICK GALVANIZED SHEET STEEL. WIDTH TO MATCH WRAP STRIP (1 1/2" MINIMUM). WITH 1 INCH x 2 INCH ANCHOR TABS AND RETAINER TABS. ANCHOR TABS TO BE SYMMETRICALLY OPPOSED AROUND COLLAR; PROVIDE 3 TABS FOR 2 1/2" AND 3" PIPE; PROVIDE 4 TABS FOR 4" PIPE.

INTUMESCENT SEALANT: ONE-PART, INTUMESCENT, LATEX ELASTOMER TESTED TO ASTM E 814. MINIMUM EXPANSION OF 3x AT 1000°F. .3M "FIRE BARRIER SEALANT CP 25WB4" OR EQUAL.

FIRESTOP SEALANT: SINGLE COMPONENT NONCOMBUSTIBLE FIRE RATED SEALANT TESTED TO ASTM E 814. TESTED TO 3000°F. "BOSS 136 FIRESTOP/DRAFT SEALANT" MANUFACTURED BY ACCUMETRIC, LLC. OR EQUAL.

SEALANT SCHEDULE:

INTUMESCENT SEALANT: PROVIDE AT ALL PENETRATIONS THROUGH RATED CONSTRUCTION FOR PENETRATING ITEMS INCLUDING BUT NOT LIMITED TO: PVC PIPE; ROOF LEADER PIPES; GAS PIPES & LINES; SPRINKLER PIPES; ELECTRICAL & COMMUNICATIONS CABLES & WIRES; AND ALARM SYSTEM WIRES. DO NOT USE INTUMESCENT SEALANT AT DOMESTIC HOT WATER OR HYDRONIC HEATING SYSTEM PIPES.

FIRESTOP SEALANT: PROVIDE AT ALL PENETRATIONS THROUGH RATED CONSTRUCTION FOR PENETRATING ITEMS INCLUDING DOMESTIC HOT AND COLD WATER PIPES AND HYDRONIC HEATING SYSTEM PIPES.

NOTE:
FOR LOCATIONS OF RATED CONSTRUCTION, SEE ARCHITECTURAL FLOOR PLANS AND SECTIONS

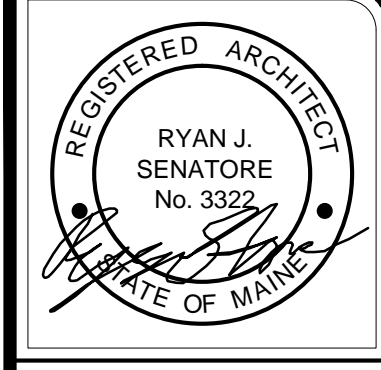

© 2017 RYAN SENATORE ARCHITECTURE

RESIDENCES
 155 SHERIDAN STREET
 PORTLAND, MAINE



RYAN SENATORE ARCHITECTURE
565 CONGRESS STREET
PORTLAND, MAINE 04101
207-650-6414
senatorearch@comcast.net

CONSULTANTS:
STRUCTURAL: Structural Integrity
77 Oak Street
Portland, ME 04101
207-774-6814

REVISIONS:

DATE: JANUARY 16, 2018

PROJECT No. 1604

DRAWN BY: RRT, RJS

CHECKED BY: RJS

SCALE: AS NOTED

SHEET TITLE:
GENERAL NOTES, ABBREVIATIONS, AND LEGENDS

GO-1