

© 2017 RYAN SENATORE ARCHITECTURE

RESIDENCES  
155 SHERIDAN STREET  
PORTLAND, MAINE



RYAN SENATORE ARCHITECTURE  
565 CONGRESS STREET  
PORTLAND, MAINE 04101  
207-650-6414  
senatorearchitecture.com

CONSULTANTS:  
STRUCTURAL:  
Structural Integrity  
77 Oak Street  
Portland, ME 04101  
207-774-4814

REVISIONS:

DATE: JANUARY 16, 2018  
PROJECT No. 1604  
DRAWN BY: RRT, RJS  
CHECKED BY: RJS  
SCALE: AS NOTED

SHEET TITLE:  
DETAILS

A5-10

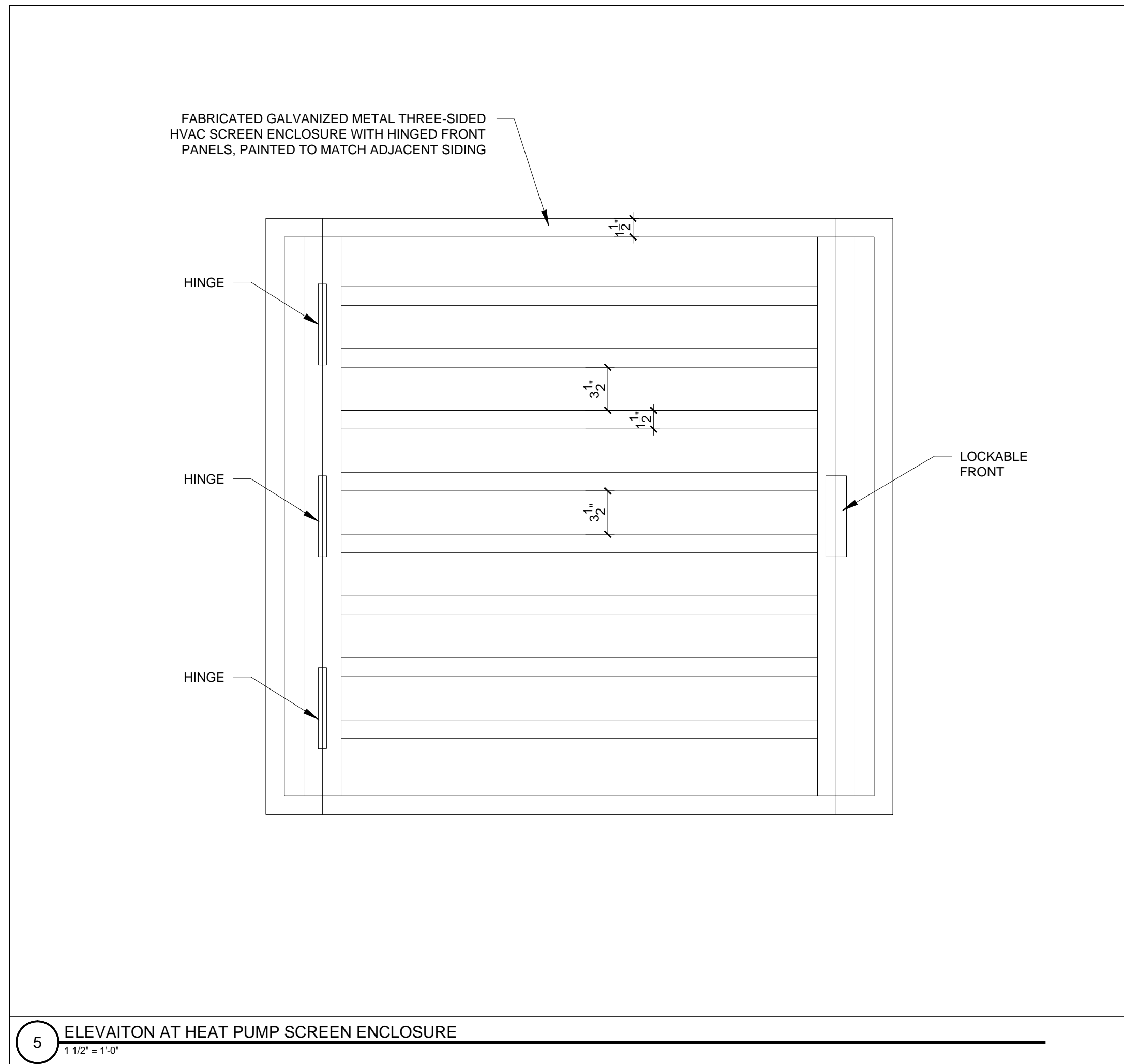

5 ELEVATION AT HEAT PUMP SCREEN ENCLOSURE  
1 1/2" = 1'-0"

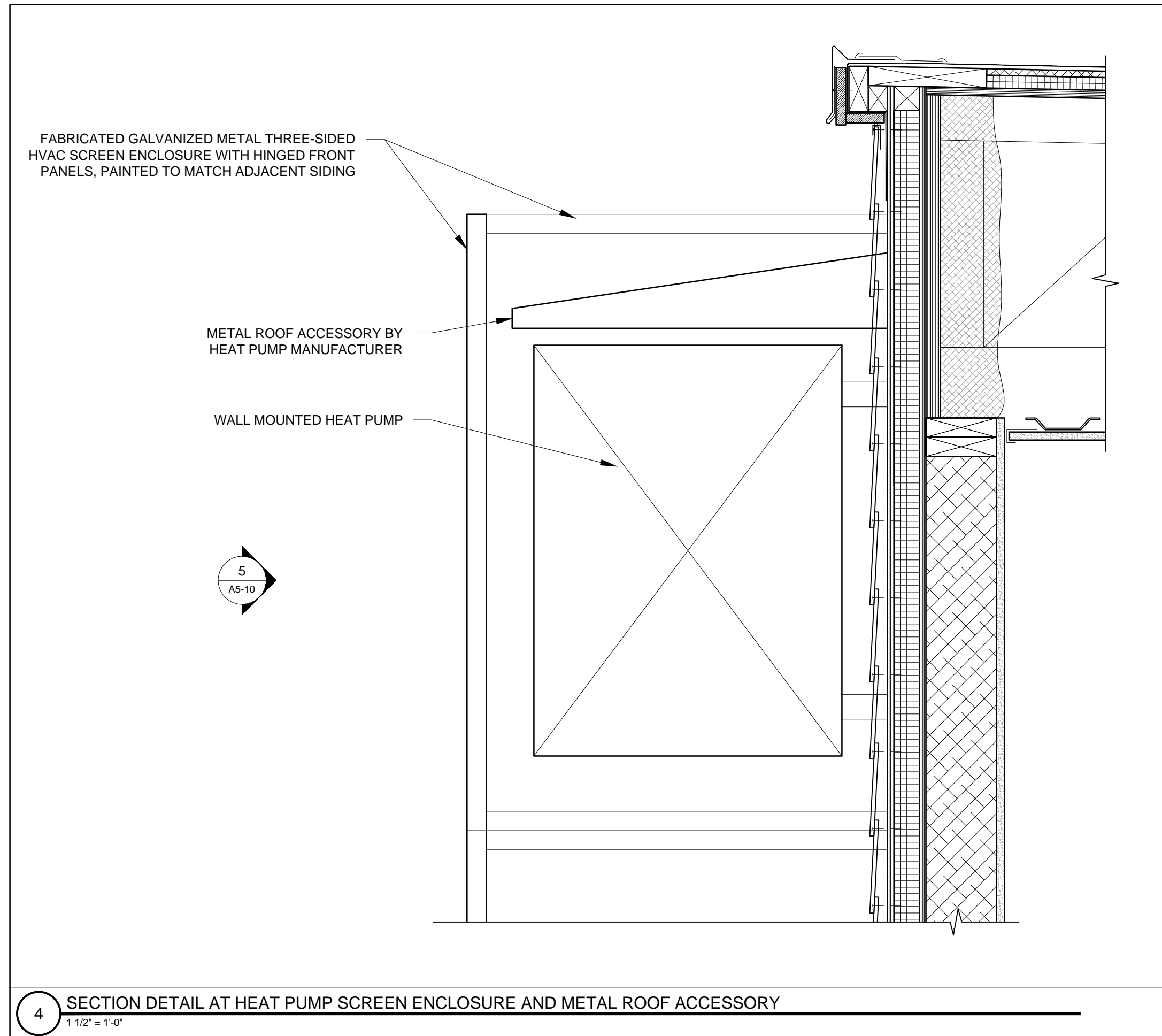

4 SECTION DETAIL AT HEAT PUMP SCREEN ENCLOSURE AND METAL ROOF ACCESSORY  
1 1/2" = 1'-0"

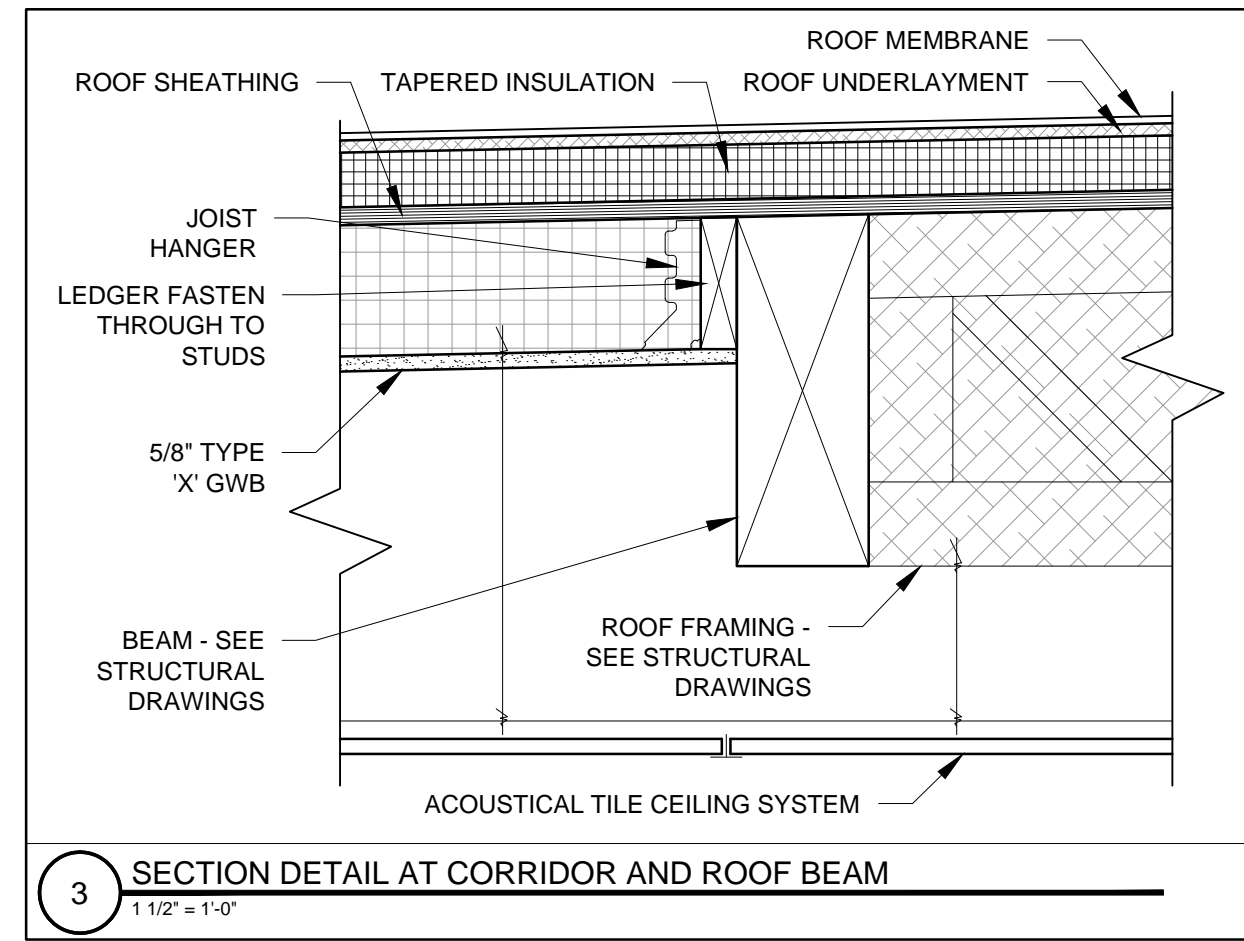

3 SECTION DETAIL AT CORRIDOR AND ROOF BEAM  
1 1/2" = 1'-0"

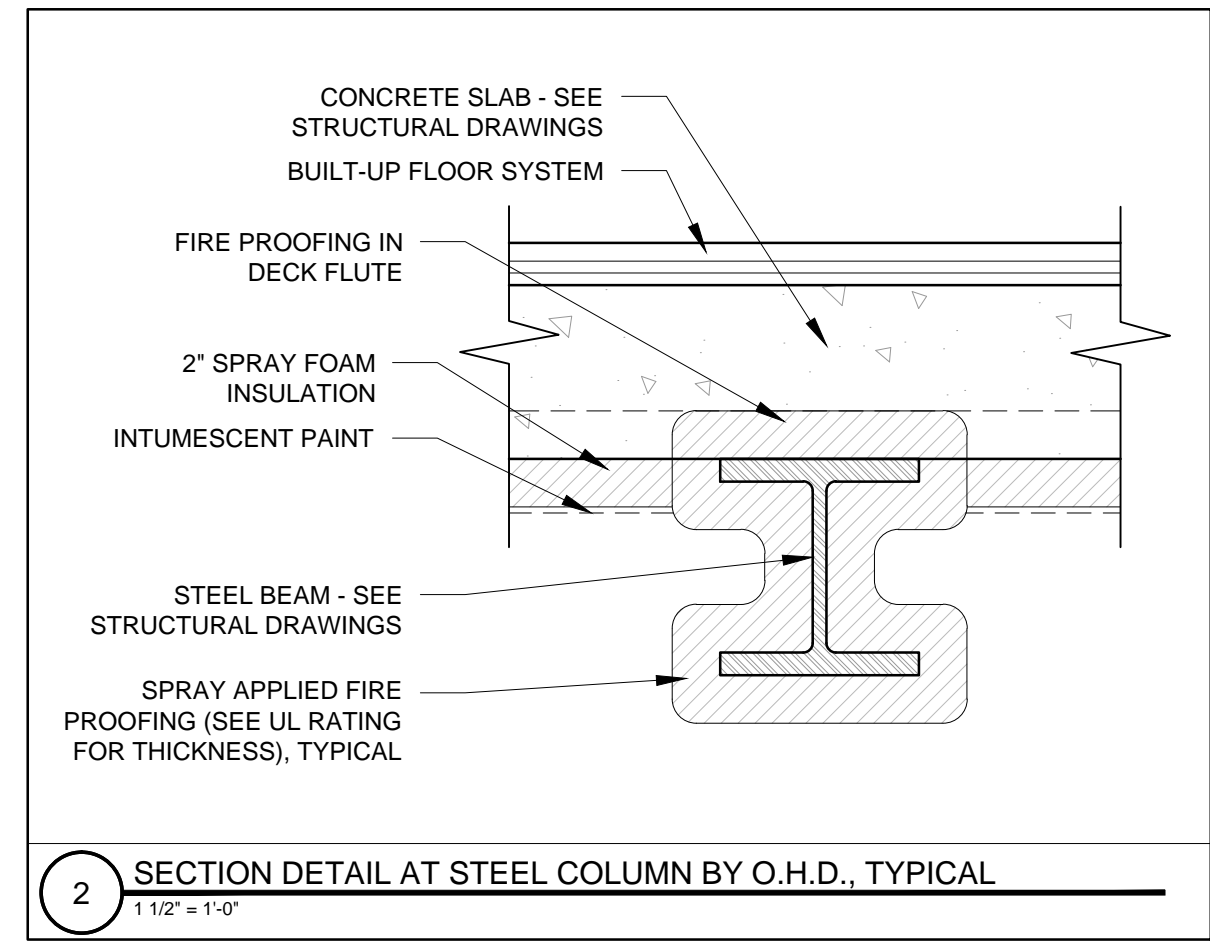

2 SECTION DETAIL AT STEEL COLUMN BY O.H.D., TYPICAL  
1 1/2" = 1'-0"

### TYPICAL COLUMN FIREPROOFING

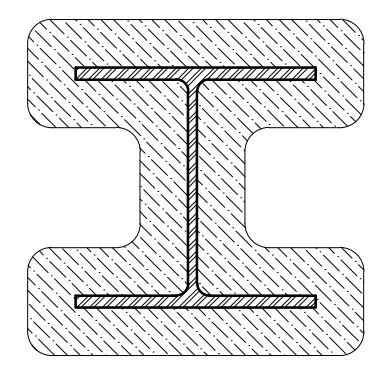

TYPE	FIRE RATING	UL NUMBER	STC RATING	IIC RATING
	3 HR	X701	N/A	N/A

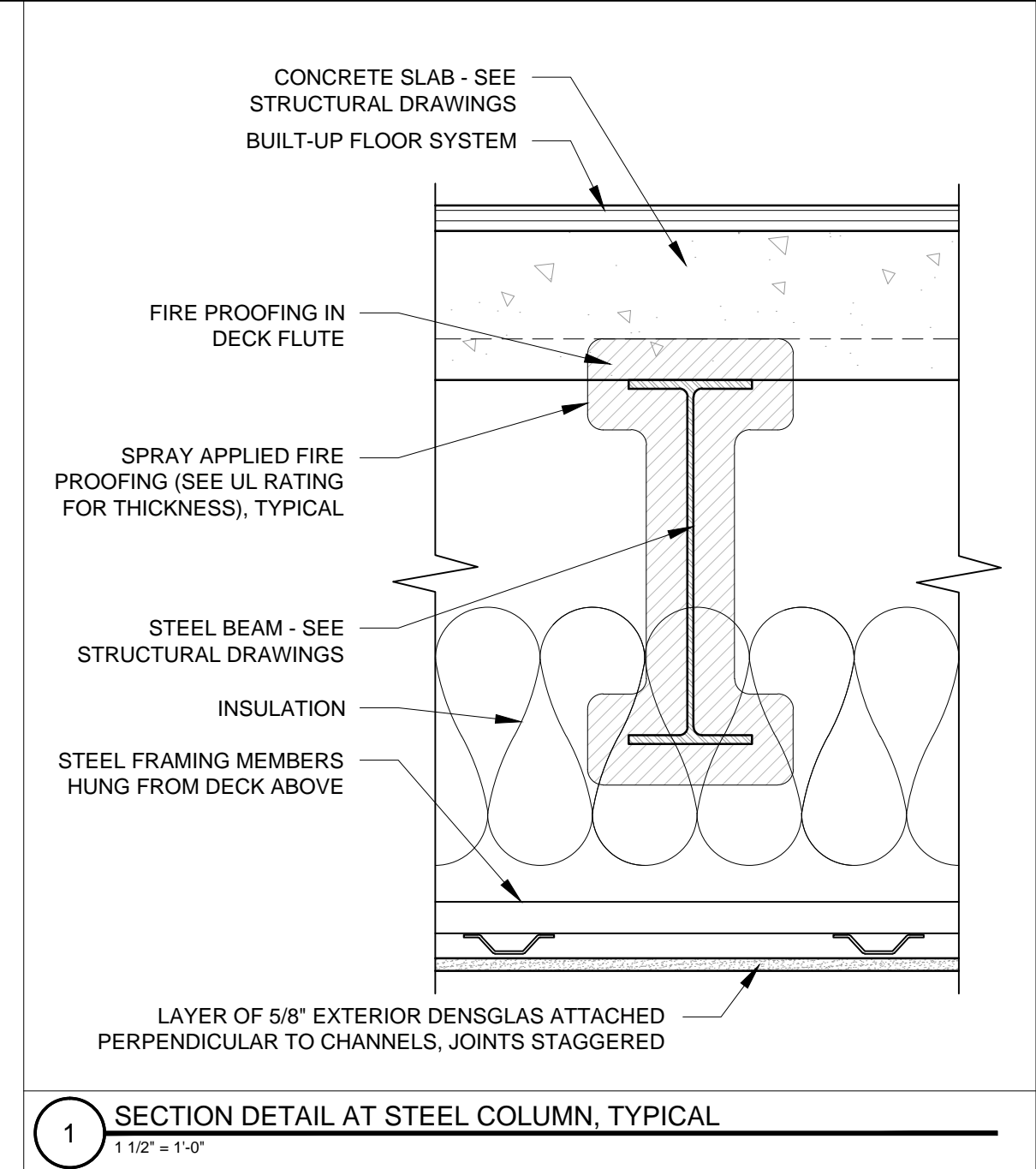

1 SECTION DETAIL AT STEEL COLUMN, TYPICAL  
1 1/2" = 1'-0"