



© 2017 RYAN SENATORE ARCHITECTURE

RESIDENCES
155 SHERIDAN STREET
PORTLAND, MAINE



RYAN SENATORE
ARCHITECTURE
565 CONGRESS STREET
PORTLAND, MAINE 04101
207-650-6414
senatorearchitecture.com

CONSULTANTS:
STRUCTURAL:
Structural Integrity
77 Oak Street
Portland, ME 04101
207-774-4814

REVISIONS:

DATE: JANUARY 16, 2018

PROJECT No. 1604

DRAWN BY: RRT, RJS

CHECKED BY: RJS

SCALE: AS NOTED

SHEET TITLE:

EAST AND WEST ELEVATIONS

A2-0

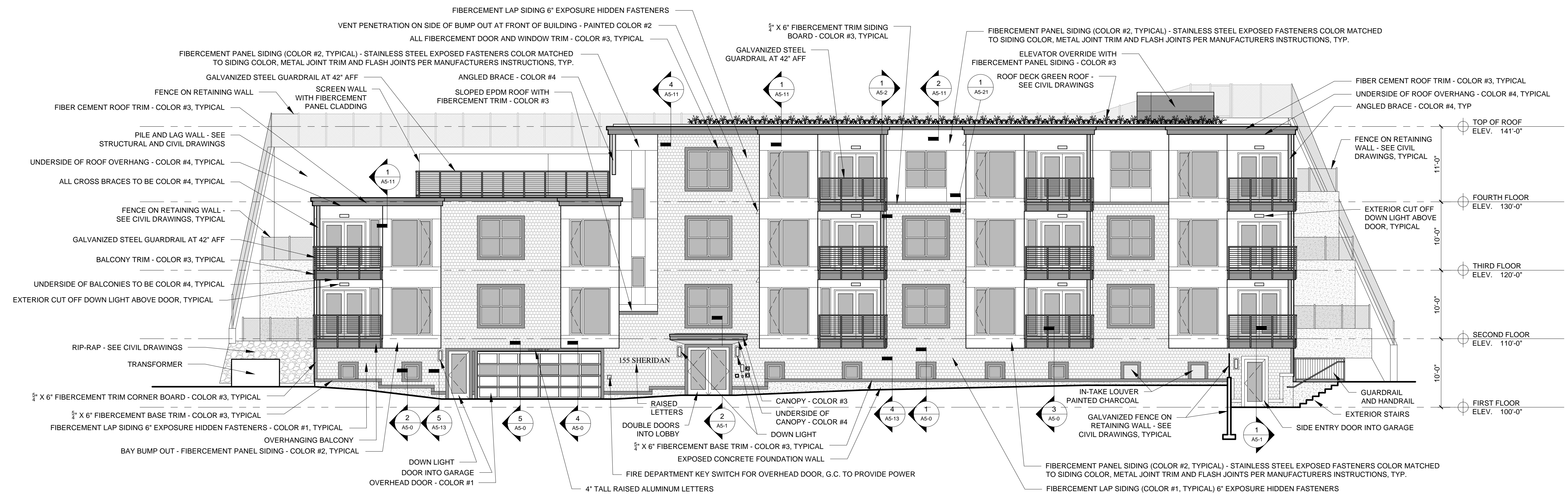

1 WEST ELEVATION
1/8" = 1'-0"

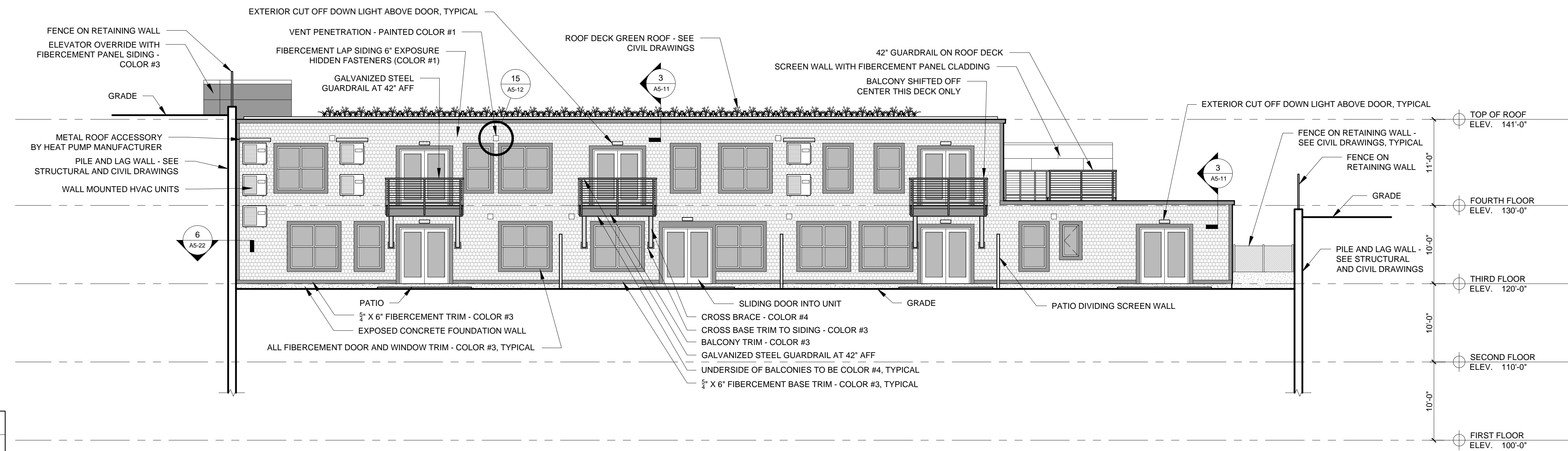

1 EAST ELEVATION
1/8" = 1'-0"

- ELEVATION NOTES**
- SEE ELECTRICAL DRAWINGS FOR EXTERIOR LIGHTING SPECS
 - FOR EXTERIOR VENT LOCATIONS SEE MECHANICAL PLANS ALL VENTS AND PENETRATIONS TO BE FLASHED INTO EXISTING FACADE AND PAINTED TO MATCH EIFS THEY ARE MOUNTED WITHIN
 - G.C. TO PROVIDE A PARTIAL FULL SCALE MOCKUP FOR OWNER APPROVAL OF FINISH PRIOR TO CONSTRUCTION

ELEVATION COLORS

	= COLOR #1 (LAP SIDING) (NAVAJO BEIGE - HARDIE SHINGLE)
	= COLOR #2 (PANEL SIDING) (HARDI PANEL - FIELD PAINT BENJAMIN MOORE "CAMBRIDGE GREEN" - #468)
	= COLOR #3 (ALL TRIM - WINDOW, BASE, CORNER, ROOF, SIDING TRANSITIONS AND BALCONIES) (FIBER CEMENT TRIM - FIELD PAINT BENJAMINE MOORE "BACKWOODS" - #469)
	= COLOR #4 (CROSS BRACES, UNDERSIDES OF BALCONIES, CANOPIES AND ROOF OVERHANGS) (FIBER CEMENT TRIM AND PANEL - FIELD PAINT BENJAMINE MOORE "OLIVE TREE" - #392)