



© 2017 RYAN SENATORE ARCHITECTURE

RESIDENCES
155 SHERIDAN STREET
PORTLAND, MAINE



RYAN SENATORE
ARCHITECTURE
565 CONGRESS STREET
PORTLAND, MAINE 04101
207-650-6414
senatorearchitecture.com

CONSULTANTS:
STRUCTURAL:
Structural Integrity
77 Oak Street
Portland, ME 04101
207-774-4814

REVISIONS:

DATE: JANUARY 16, 2018

PROJECT No. 1604

DRAWN BY: RRT, RJS

CHECKED BY: RJS

SCALE: AS NOTED

SHEET TITLE:
SECOND FLOOR
COMMON
AREAS RCP

A1-7

- REFLECTED CEILING PLAN NOTES
- 1) G.C. TO COORDINATE LOCATIONS OF PLUMBING CLEAN OUTS WITH ACCESS PANELS AS SHOWN ON REFLECTED CEILING PLANS
 - 2) G.C. TO PROVIDE ACCESS PANELS AS REQUIRED FOR ALL ELEMENTS (SPRINKLER, VALVES, ETC) NOT SHOWN ON THIS REFLECTED CEILING PLAN
 - 3) G.C. TO PROVIDE METAL FRAMING AND BLOCKING REQUIRED FOR ALL ACCESS PANELS AND CONTROL JOINTS
 - 4) ALL ACCESS PANELS TO BE FIRE RATED TO MATCH THE CEILING THEY ARE INSTALLED WITHIN
 - 5) FOR LIGHTING PLAN, SEE ELECTRICAL DRAWINGS

LIGHTING LEGEND

| SYMBOL | TAG | DESCRIPTION |
|--------|-----|--|
| ● | A | SURFACE MOUNT - TBD |
| ● | B | SURFACE MOUNTED - TBD |
| ○ | C | SURFACE MOUNT - IN CLOSETS |
| ▭ | D | SURFACE MOUNTED ON WALL ABOVE DOOR |
| ⌒ | E | WALL SCONCE IN BATHROOM OVER VANITY |
| ○ | F | SURFACE MOUNT - WET LOCATION |
| ● | G | SURFACE MOUNT - IN CORRIDORS / FITNESS |
| ○ | H | SURFACE MOUNT - CENTER IN BEDROOMS |
| ○ | J | SURFACE MOUNT - WET LOCATION |
| ⊙ | K | EXTERIOR CUT OFF DOWN LIGHT OVER DOOR |
| ● | L | SURFACE MOUNT - IN LOBBY |
| ⌒ | M | INTERIOR SCONCE LIGHTING |
| ▭ | N | 1'x4' FLORESCENT LIGHT |
| ⊕ | P | PENDANT OVER ISLAND |
| ○ | Q | LED UTILITY LIGHTING IN STAIRWELLS |
| ⊕ | R | LED PARKING GARAGE LIGHTING |
| △ | S | EXTERIOR SCONCE DOWN LIGHTING |
| ○ | T | UNDER COUNTER LIGHTING |
| ▭ | | CEILING GRILL |

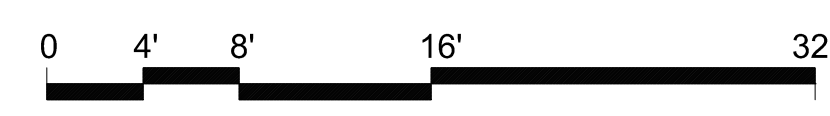
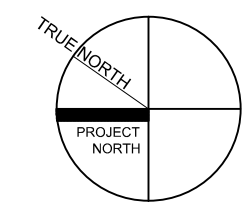
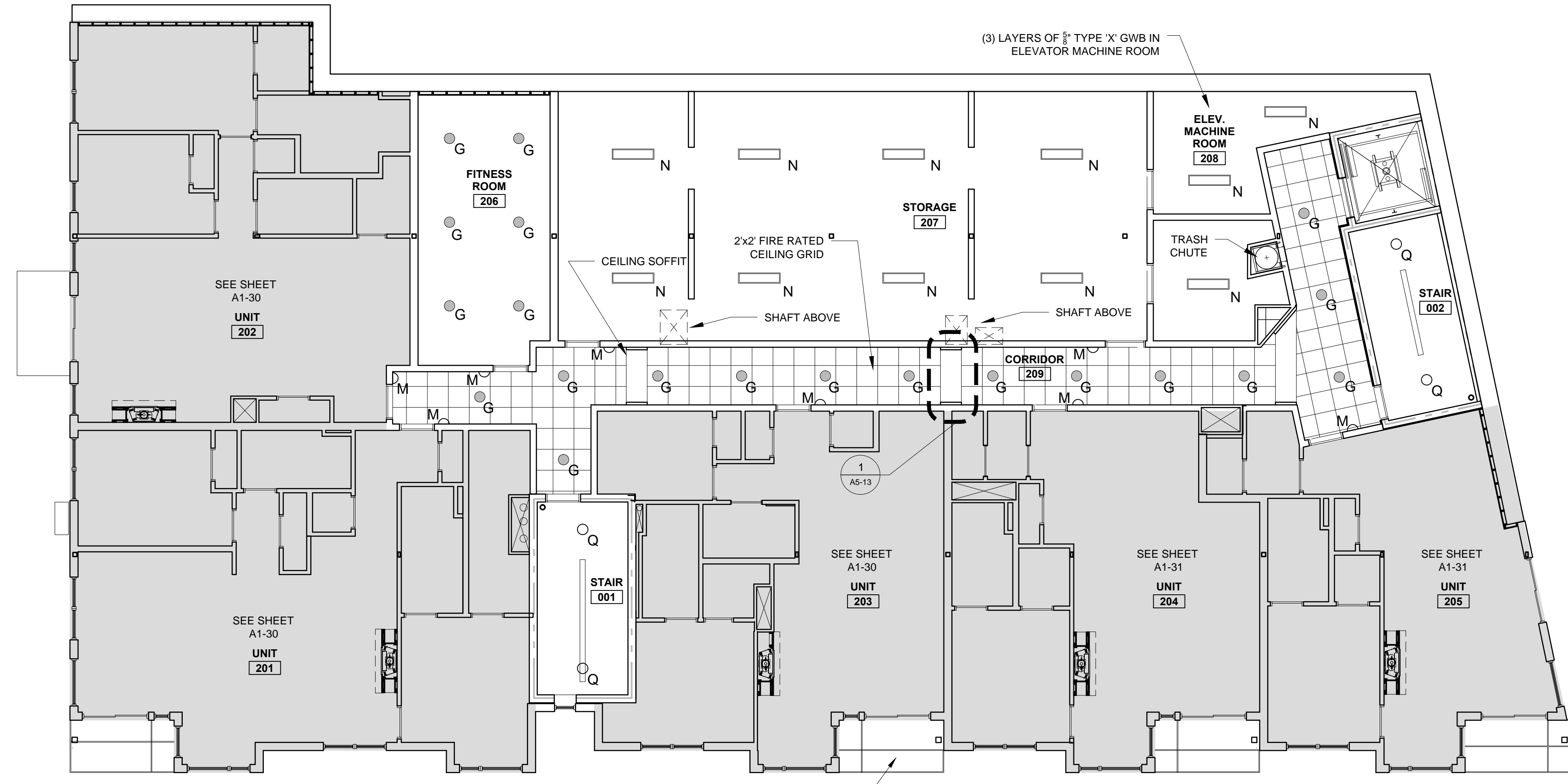

1 SECOND FLOOR COMMON AREAS REFLECTED CEILING PLAN
1/8" = 1'-0"