

NORTH

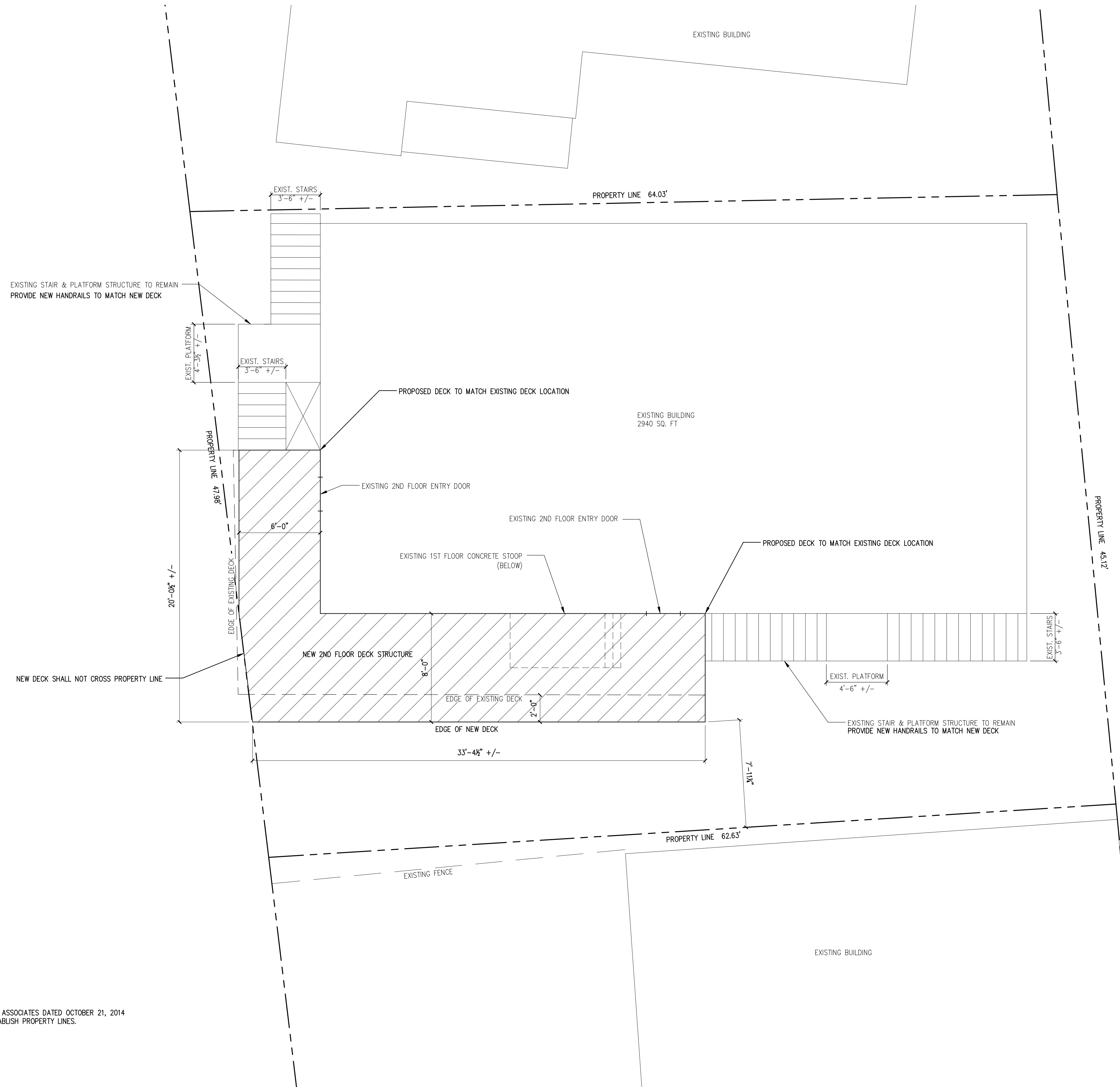

- NOTES:**
1. REFERENCE BOUNDARY SURVEY BY R.W. EATON ASSOCIATES DATED OCTOBER 21, 2014
  2. CONTRACTOR SHALL RETAIN SURVEYOR TO ESTABLISH PROPERTY LINES.

**PLAN LEGEND**

- BEARING WALL
- SHEAR WALL
- BEAM
- HSS COLUMN
- COLUMN FROM ABOVE
- COLUMN BELOW
- COLUMN ABOVE AND BELOW
- HOLD-DOWN

PROPOSED SITE PLAN

SCALE: 1"=4'-0"

PRINTED: Mar 23, 2016

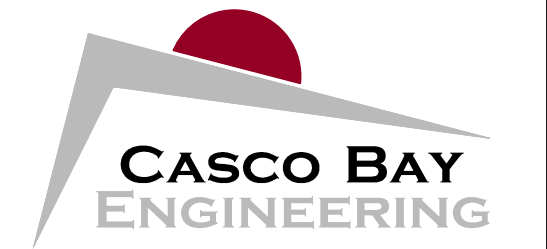

424 Fore Street  
 Portland, ME 04101  
 Phone 207.842.2800  
 Fax 207.842.2828  
[www.cascobayengineering.com](http://www.cascobayengineering.com)

CLIENT:  
**DEIDRE FOGG**

17 MARION STREET  
 PORTLAND, MAINE 04101

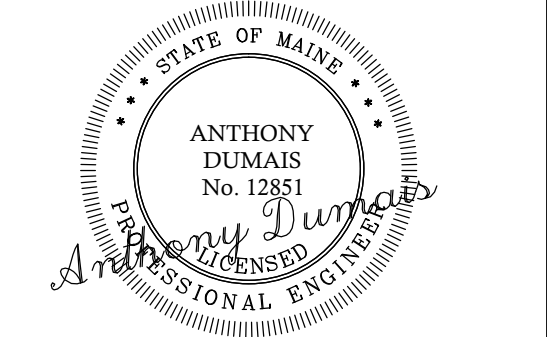

**FOGG RESIDENCE**  
 17 MARION STREET  
 PORTLAND, MAINE

**DECK RENOVATION**

No.	DESCRIPTION	ISSUED FOR CONSTRUCTION	DATE	
			DR.	DATE
0			DR.	DATE
			BY	ED
			TD	

SHEET TITLE:

**PROPOSED SITE PLAN**

DESIGNED: \_\_\_\_\_ TD  
 DRAWN: \_\_\_\_\_ TD  
 DATE: 3-22-16  
 PROJECT NUMBER: 16-040

**C1.1**