

GENERAL NOTES:

- CONTRACTOR SHALL PLACE CATCH BASIN INLET PROTECTION ON CATCH BASINS AND FIELD INLETS DOWN-GRADE OF ALL NON-STABILIZED SURFACES, PER DETAIL.
- LOCATION OF PROPOSED SEDIMENTATION BARRIER IS INDICATED ON PLAN. CONTRACTOR TO ENSURE THAT SEDIMENTATION BARRIER IS INSTALLED ALONG THE DOWN-GRADE LOCATION OF DISTURBANCE, PER DETAIL.
- CONTRACTOR SHALL INSTALL CONSTRUCTION ENTRANCE AT ALL LOCATIONS OF INGRESS AND EGRESS DURING CONSTRUCTION TO THE SITE. SEE DETAIL.
- CURB TO BE REMOVED, STOCKPILED AND RESET IN ACCORDANCE WITH DETAIL. BROKEN CURB SHALL BE PROPERLY DISPOSED OF AND SHALL BE REPLACED AT THE CONTRACTOR'S EXPENSE.
- CONTRACTOR SHALL ENSURE THAT FOUNDATION DRAINS AND UNDERDRAINS ARE CONSTRUCTED WITH POSITIVE OUTLET TO PROPOSED CONNECTIONS.
- RIPRAP SLOPE TO BE PLACE IN ALL AREAS WITH A SLOPE GREATER THAN 2H:1V.
- ALL WORK WITHIN THE CITY STREET RIGHT OF WAY SHALL MEET CITY OF PORTLAND TECHNICAL MANUAL STANDARDS.
- REFER TO STRUCTURAL PLANS FOR FOUNDATION AND SUB-CONTAINER CONSTRUCTION REQUIREMENTS.

PROPOSED STRUCTURE SCHEDULE				
STRUCTURE	DIAMETER	RIM	INV. IN	INV. OUT
DC-1	6"	70.00'	-	66.47'
DC-2	6"	70.00'	-	66.40'
FI-1	6"	70.40'	-	66.44'
FI-2	6"	70.25'	66.20'	66.20'
FI-3	6"	70.75'	66.11'	66.11'

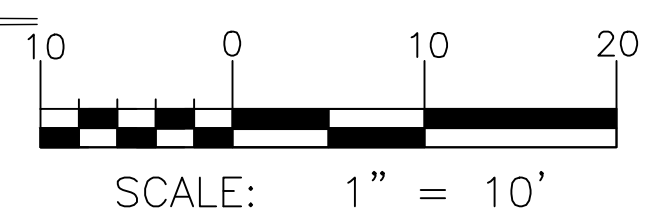
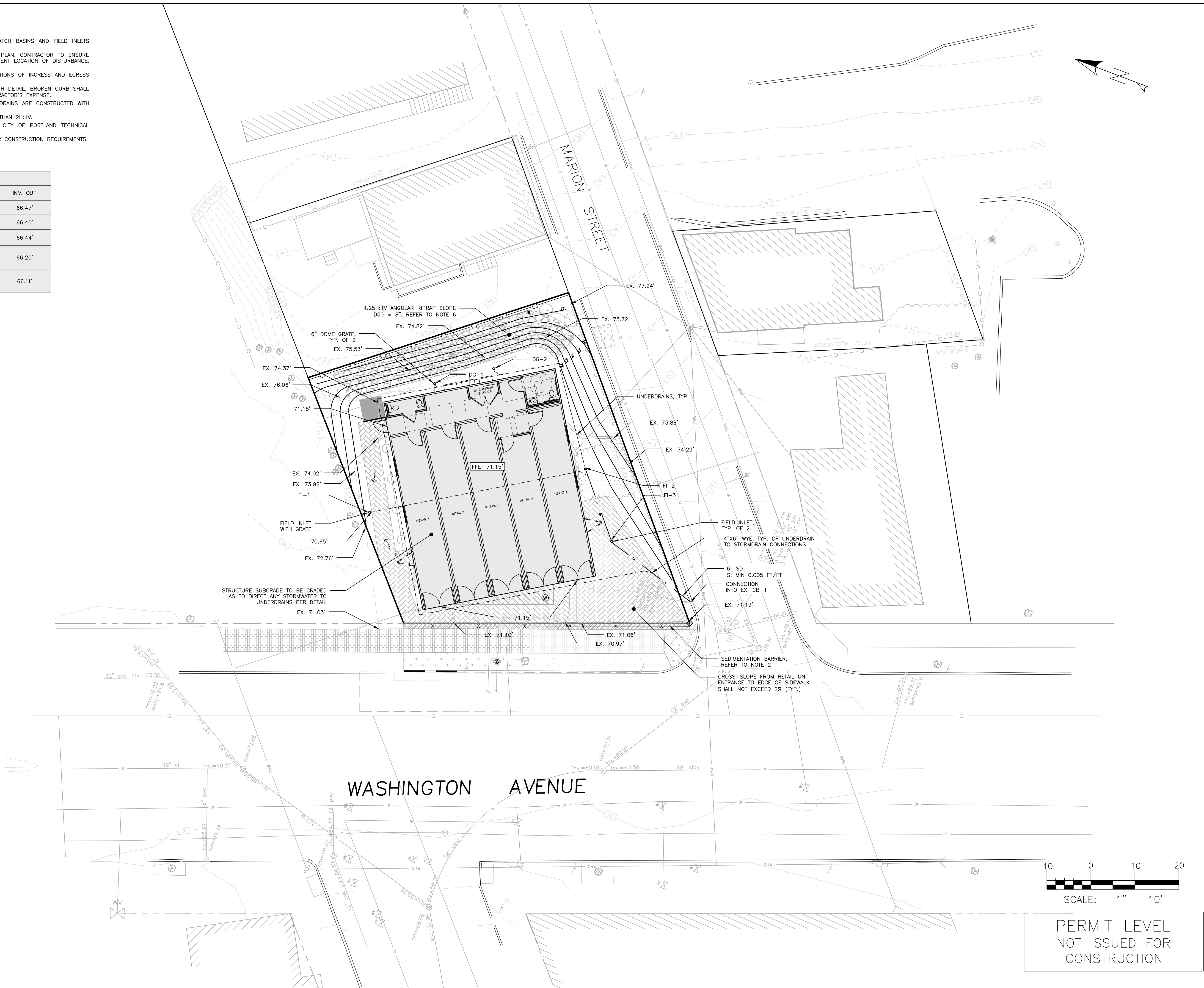

PERMIT LEVEL  
NOT ISSUED FOR  
CONSTRUCTION

ISSUED FOR	BY
FINAL APPLICATION	WHS
BUILDING PERMIT	WHS

DRAWING NAME: **GRADING, DRAINAGE, & EROSION CONTROL PLAN**  
 PROJECT NAME: **THE BLACK BOX AT 93 WASHINGTON**  
 CLIENT: **COTTON STREET HOLDINGS, LLC**  
 75 WASHINGTON AVE SUITE 2H PORTLAND, ME 04101

**A C C O R N**  
ENGINEERING, INC.

ACCORN ENGINEERING, INC. IS AN EQUAL OPPORTUNITY EMPLOYER. ALL RIGHTS RESERVED. FROM ACCORN ENGINEERING, INC. ANY REPRODUCTION, DISTRIBUTION OR SALE OF THIS DRAWING WITHOUT WRITTEN PERMISSION OF ACCORN ENGINEERING, INC. IS PROHIBITED. (207) 775-2655  
 158 BANKFOUN ST. PORTLAND, MAINE 04102

FILE: CIVIL\_1073  
 JN: 1073  
 SCALE: 1"=10'  
 DESIGNED BY: WHS  
 DRAWN BY: OJD  
 CHECKED BY: WHS

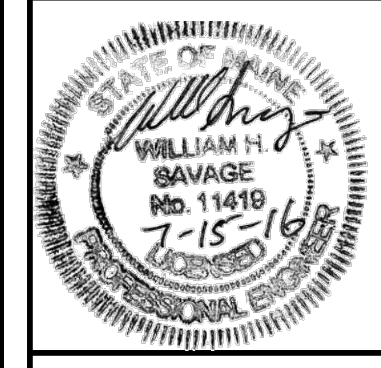

DRAWING NO.  
**C-30**