

GENERAL NOTES:

1. LOCATION OF PROPOSED CONNECTIONS APPROXIMATE. CONTRACTOR TO CONTACT ENGINEER IF FIELD INFORMATION VARIES FROM INFORMATION ON PLANS.
2. CONTRACTOR IS TO BE CAUTIONED THAT CERTAIN LOCATIONS AND/OR ELEVATIONS OF EXISTING UTILITIES HAVE BEEN PROVIDED THROUGH UTILITY COORDINATION OR OTHER OBSERVATIONS. INFORMATION IS NOT TO BE RELIED UPON AS EXACT OR COMPLETE. CONTRACTOR TO FIELD VERIFY AND COORDINATE WITH UTILITY COMPANY AND DIG SAFE NO LESS THAN 72 HOURS PRIOR TO ANY EXCAVATION TO REQUEST EXACT FIELD LOCATION OF ALL UTILITIES. IT SHALL BE THE RESPONSIBILITY OF THE CONTRACTOR TO LOCATE ALL EXISTING UTILITIES WHICH CONFLICT WITH THE PROPOSED IMPROVEMENTS INDICATED IN THE CONTRACT DOCUMENTS. CONTRACTOR TO NOTIFY ENGINEER OF ANY DIFFERENTIATIONS FROM EXISTING CONDITIONS, INCLUDING UTILITY SURVEY, PRIOR TO ANY CHANGES.
3. FOR ALL UTILITIES, ACORN ENGINEERING DESIGN LIMITS EXTEND TO OUTSIDE WALL OF BUILDING. METERING OF UTILITIES TO BE COMPLETED BY M.E.P. UNLESS SPECIFIED OTHERWISE.
4. SEWER UTILITIES: EXISTING STUB LOCATION APPROXIMATE AND BASED ON SITE VISIT OBSERVATION; CONTRACTOR TO CONFIRM EXACT STUB LOCATION. CONTRACTOR TO COORDINATE WITH ARCHITECT FOR FINAL SERVICE CONNECTION TO EXISTING 4" SEWER LINE STUBS. SEWER UTILITIES TO BE CONSTRUCTED IN ACCORDANCE WITH CITY OF PORTLAND TECHNICAL STANDARDS. CONTACT ENGINEER IF FIELD CONDITIONS FROM INVERT VARY FROM DESIGN.
5. WATER UTILITIES: EXISTING STUB LOCATION APPROXIMATE AND BASED ON SITE VISIT OBSERVATION; CONTRACTOR TO CONFIRM EXACT STUB LOCATION. CONTRACTOR TO COORDINATE WITH ARCHITECT FOR FINAL SERVICE CONNECTION TO EXISTING 3/4" DOMESTIC WATER STUB. NO FIRE SERVICE IS PROPOSED. FINAL PIPE SIZING, METERING, BACKFLOW PREVENTION, AND PRESSURE REDUCERS TO BE COMPLETED BY M.E.P. ENGINEER. DOMESTIC WATER PIPE SIZES WILL DETERMINE THE FINAL WATER METERING OPTIONS. METER MAY BE SMALLER THAN PROPOSED WATER MAIN. NON-ENTRY METER PIT TO BE LOCATED WITHIN PROPERTY LINES. WATER METERING, PRESSURE REDUCER AND BACKFLOW PREVENTION TO BE IN ACCORDANCE WITH THE PORTLAND WATER DISTRICT STANDARDS. CONTRACTOR TO FOLLOW METERING GUIDELINES OF THE PORTLAND WATER DISTRICT AND CITY OF PORTLAND.
6. ELECTRIC UTILITIES: ELECTRIC DESIGN TO BE FINALIZED BY M.E.P. ENGINEER. ELECTRICAL LOAD TO BE DETERMINED BY M.E.P. ENGINEER. PROPOSED SINGLE OR THREE-PHASE POLE MOUNTED TRANSFORMER PER ELECTRIC DESIGNER; FINAL LOCATION TO BE DEFINED BY CMP. ALL ELECTRIC CONSTRUCTION SHALL CONFORM TO CMP GUIDEBOOK OF STANDARD REQUIREMENTS, MOST RECENT EDITION.
7. GAS UTILITIES: EXISTING STUB LOCATION APPROXIMATE AND BASED ON SITE VISIT OBSERVATION; UNTIL CONFIRMED SERVICE WAS RETIRED MAY 2016. PROJECT GAS LOAD AND GAS UTILITY DESIGN TO BE FINALIZED BY M.E.P. ENGINEER. GAS METERS TO BE LOCATED BY M.E.P.
8. CABLE AND TELEPHONE PULLBOXES AND PEDESTAL LOCATIONS TO BE DETERMINED BY FAIRPOINT AND TIME WARNER PRIOR TO CONSTRUCTION. CONTRACTOR TO COORDINATE.
9. PROPOSED WATER AND SEWER SERVICE LINES TO MAINTAIN MINIMUM 18" VERTICAL CLEARANCE IF 10' HORIZONTAL CLEARANCE IS NOT FEASIBLE.
10. CONTRACTOR TO REMOVE THE EXISTING METER PIT. THE EXISTING 3/4" CURB STOP WITHIN THE PIT IS TO BE PROTECTED DURING REMOVAL AND OUTFITTED WITH A SERVICE BOX AND ROD.
11. PROPOSED WATER SERVICE PIPE MATERIAL TO MATCH EXISTING SERVICE MATERIAL.

MINIMUM HORIZONTAL UTILITY SEPARATION					
UTILITY	UGE/T/C	WATER	SEWER	GAS	STORMWATER
UGE/T/C	-	6'	5'	4'	6'
WATER	6'	-	10'	6'	3'
SEWER	5'	10'	-	5'	10'
GAS	4'	6'	5'	-	6'
STORMWATER	6'	3'	10'	6'	-

EXISTING STRUCTURE SCHEDULE				
STRUCTURE	INTERIOR DIAMETER	RIM	INV. IN	INV. OUT
CB-1	-	70.82'	66.00'	65.77'
CB-2	-	70.11'	-	64.21'
SMH-1	4'	70.38'	62.78' (DMH-1) 61.23'	61.08'
DMH-1	4'	70.62'	63.32' (CB-1) 63.42' (CB-2) 63.47' (CB-2)	63.37'

\* EXISTING STRUCTURES AS DEFINED BY THE EXISTING CONDITIONS SURVEY DATED APRIL 25TH, 2016 BY TITCOMB ASSOCIATES

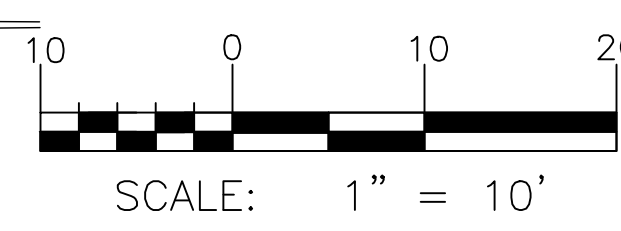
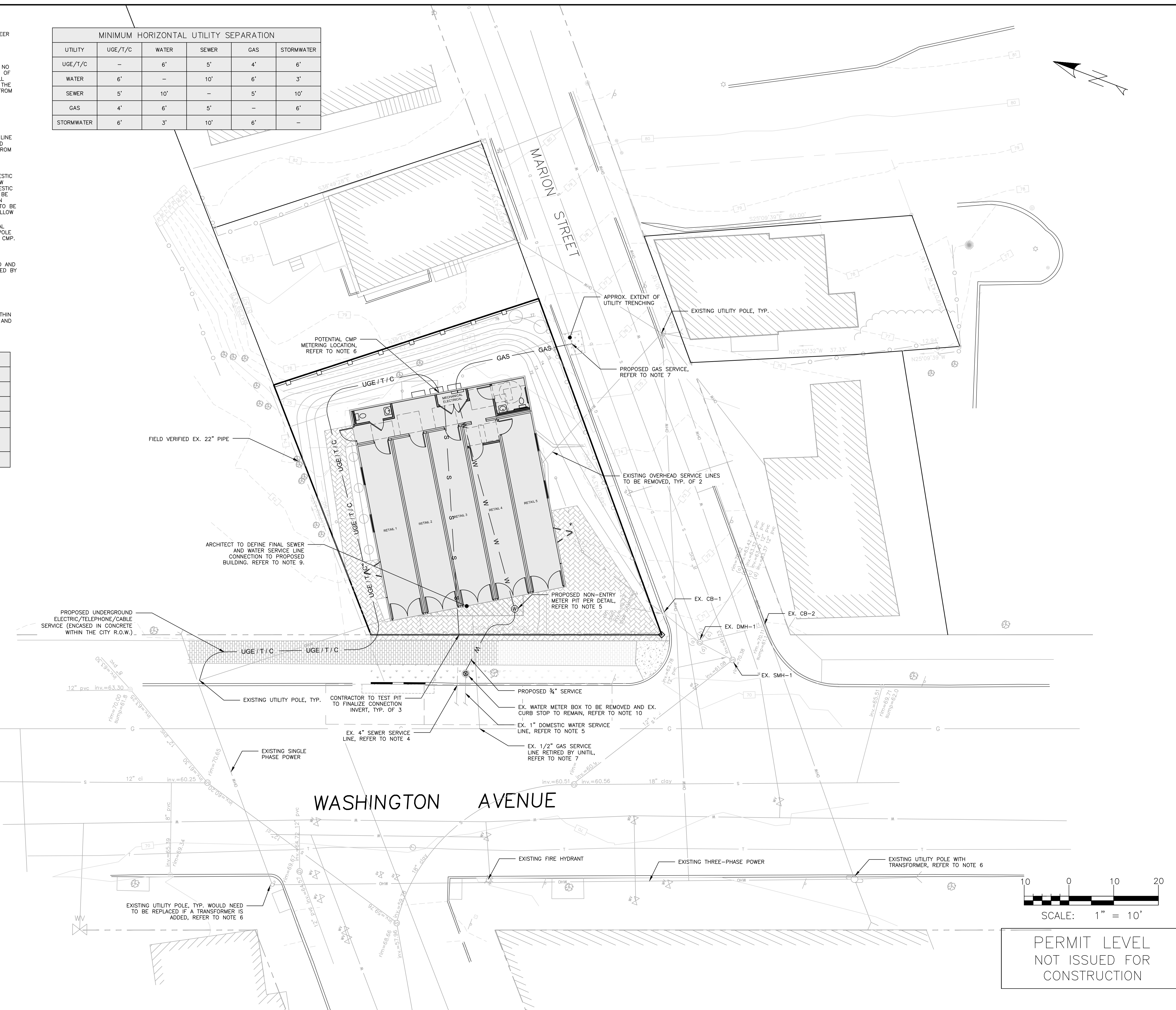

PERMIT LEVEL  
NOT ISSUED FOR  
CONSTRUCTION

ISSUED FOR	BY
ABILITY TO SERVE	WHS
FINAL APPLICATION	WHS
BUILDING PERMIT	WHS

DATE: 6/29/16  
DATE: 7/15/16  
DATE: 7/29/16

DRAWING NAME: UTILITY PLAN  
PROJECT NAME: THE BLACK BOX AT 93 WASHINGTON  
CLIENT: COTTON STREET HOLDINGS, LLC  
75 WASHINGTON AVE SUITE 2H PORTLAND, ME 04101

ACORN ENGINEERING, INC.  
168 DANFORTH ST. PORTLAND, MAINE 04102  
(207) 775-2655

FILE: CIVIL\_1073  
JN: 1073  
SCALE: 1" = 10'  
DESIGNED BY: OJD  
DRAWN BY: OJD  
CHECKED BY: WHS

DRAWING NO. C-20