

GENERAL NOTES

- DRAWING NOTES:** CONTRACTOR TO FURNISH AND INSTALL ALL NOTED LABOR AND MATERIALS UNLESS OTHERWISE NOTED.
- CODE COMPLIANCE:** ALL WORK SHALL CONFORM TO THE LATEST EDITION OF STATE, LOCAL AND OTHER CODES WHICH APPLY TO THIS PROJECT OR HAVE JURISDICTION.
- COORDINATION:** IT IS THE RESPONSIBILITY OF THE CONTRACTOR TO COORDINATE ALL DISCIPLINES AND TRADES SO THAT ALL BUILDING SYSTEMS AND COMPONENTS CAN BE ASSEMBLED WITHOUT CONFLICTS. IN THE EVENT THAT THE CONSTRUCTION DOCUMENTS DEFINE CONDITIONS WHICH PROHIBIT, OR MAY PROHIBIT, SUCH ASSEMBLY, THE CONTRACTOR SHALL BRING TO THE ARCHITECTS ATTENTION, IN WRITING AND IN A TIMELY FASHION, SUCH CONDITION. THE CONTRACTOR SHALL NOT PROCEED WITH RELATED WORK WITHOUT A WRITTEN RESOLUTION CLARIFICATION FROM THE ARCHITECT. THE CONTRACTOR AND HIS/HER SUBCONTRACTORS SHALL BE RESPONSIBLE FOR PROVIDING MATERIALS AND SYSTEMS SHOWN IN THE CONSTRUCTION DOCUMENTS REGARDLESS OF WHERE THE INFORMATION IS LOCATED. WHERE COMPONENTS OF A SYSTEM ARE INDICATED THE CONTRACTOR SHALL BE RESPONSIBLE FOR PROVIDING ALL LABOR AND MATERIALS NECESSARY TO COMPLETE THE SYSTEM.
- DISCREPANCIES & CLARIFICATIONS:** IT IS THE RESPONSIBILITY OF THE CONTRACTOR TO BRING TO THE ARCHITECTS ATTENTION, IN WRITING, ANY DISCREPANCIES OR AMBIGUITIES IN THE DRAWINGS AND/OR SPECIFICATIONS. THE CONTRACTOR SHALL NOT PROCEED WITH RELATED WORK WITHOUT A WRITTEN RESOLUTION OR CLARIFICATION FROM THE ARCHITECT.
- LAYOUT:** UNLESS INDICATED OTHERWISE, CENTER WALL FRAMING AND PARTITION FRAMING ON COLUMN LINES. FLOOR PLAN DIMENSIONS ARE TO CENTER OF FRAMING, FACE OF CONCRETE, FACE OF CMU, OR FROM COLUMN CENTERLINES, UNLESS INDICATED OTHERWISE. DOORS AND WINDOWS ARE DIMENSIONED TO CENTERLINES UNLESS INDICATED OTHERWISE.
- CENTERING:** UNLESS INDICATED OTHERWISE, CENTER BUILDING ELEMENTS WITHIN OR BETWEEN OTHER BUILDING ELEMENTS WHEN CONDITIONS OR THE DRAWINGS INDICATE OR IMPLY THAT SUCH IS THE INTENT, WHETHER OR NOT DIMENSIONS ARE INCLUDED.
- SYMMETRY:** WHERE CONDITIONS OR THE DRAWINGS INDICATE OR IMPLY THAT SYMMETRY IS INTENDED, INFORMATION PROVIDED AT ONE SIDE APPLIES EQUALLY TO BOTH SIDES, UNLESS CONDITIONS CLEARLY PRECLUDE SUCH APPLICATION.
- ACCESSIBILITY:** ALL HANDICAPPED ACCESSIBLE BATHROOMS, GRAB BARS, AND DOOR OPENINGS SHALL MEET THE REQUIREMENTS OF TITLE 94-348, CHAPTER 5 OF THE MAINE HUMAN RIGHTS COMMISSION TITLE LATEST EDITION & THE DEPARTMENT OF JUSTICE ADA STANDARDS FOR ACCESSIBLE DESIGN.
- DRAWING SCALES:** WORK FROM THE GIVEN DIMENSIONS ONLY. SCALE IS INDICATED ON THE DRAWINGS FOR CONVENIENCE ONLY. IT IS NOT INTENDED THAT INFORMATION BE DETERMINED BY SCALING THE DRAWINGS SINCE SOME ITEMS MAY NOT BE TO SCALE.
- WATER-RESISTANT GWB:** INSTALL WATER-RESISTANT GYPSUM WALL BOARD IN ALL REST ROOMS & TOILET ROOMS OR AT ANY WALL WITH PLUMBING FIXTURES.
- HIGH IMPACT GWB:** INSTALL HIGH IMPACT GYPSUM WALL BOARD IN ALL STAIRWELLS
- INTERIOR ELEVATIONS:** INTERIOR ELEVATIONS MAY BE REVERSED FROM AND/OR SIMILAR TO ACTUAL CONDITIONS. SEE FLOOR PLANS FOR WINDOW AND DOOR QUANTITIES AND LOCATIONS. FOR CASEWORK LAYOUTS, AND FOR MONITOR LOCATIONS.
- BUILDING INSULATION:** PROVIDE AS INDICATED IN WALL SECTIONS AND IN ACCORDANCE WITH PARTITION TYPES, WHETHER OR NOT SHOWN IN DETAILS AND OTHER DRAWINGS. FOR CLARITY, INSULATION MAY NOT BE SHOWN IN SOME CASES, EVEN IF IT IS TO BE PROVIDED.
- BLOCKING:** INSTALL BLOCKING BEHIND ALL SURFACE-APPLIED FIXTURES TRIM, CASEWORK, SHELVES, BRACKETS, TOILET ACCESSORIES, CHAIR RAILS, PICTURE RAILS, GRAB BARS, BASE MOLDINGS, AND AS OTHERWISE REQUIRED, WHEN SUCH ITEMS ARE APPLIED ON STUD WALLS.
- PENETRATIONS AT STRUCTURAL MEMBERS:** BEFORE PENETRATING JOISTS, BEAMS OR OTHER STRUCTURAL MEMBERS, CONSULT WITH THE ARCHITECT.
- DAMAGED WORK:** BUILDING OR SITE COMPONENTS WHICH ARE AFFECTED BY NEW WORK, DEMOLITION, OR WHICH MAY BE DAMAGED BY THE GENERAL CONTRACTOR OR ANY SUB-CONTRACTOR SHALL BE REPLACED OR RESTORED TO ORIGINAL CONDITION AND COLOR TO MEET THE APPROVAL OF THE ARCHITECT.
- UTILITIES:** VERIFY THE SIZE AND LOCATION OF ALL UNDERGROUND UTILITIES AND REPORT ANY DISCREPANCIES TO THE ARCHITECT IN WRITING. DO NOT PROCEED WITH WORK UNTIL THE DISCREPANCY HAS BEEN RESOLVED TO THE SATISFACTION OF THE ARCHITECT.
- RATED CONSTRUCTION:** PROVIDE RATED CONSTRUCTION AS REQUIRED BY CODE, AS SPECIFIED, AND AS INDICATED ON DRAWINGS. IT IS THE RESPONSIBILITY OF THE CONTRACTOR TO PROVIDE AND INSTALL ALL COMPONENTS REQUIRED TO CREATE SUCH RATED CONSTRUCTION, REGARDLESS OF WHETHER OR NOT SUCH COMPONENTS ARE INDICATED. PROVIDE CONTINUITY OF SUCH RATED CONSTRUCTION AROUND AND BETWEEN SPACES INCLUDING AT CHASES AND AT FLOORS, TO MAINTAIN COMPLETE SEPARATIONS, EVEN IF NOT SPECIFICALLY INDICATED.
- SHOP DRAWINGS:** SUBMIT SHOP DRAWINGS TO THE ARCHITECT FOR REVIEW PRIOR TO FABRICATIONS. SUBMITTALS REQUIRED INCLUDE, BUT ARE NOT LIMITED TO, SHOP DRAWINGS FOR ALL PREFABRICATED CONCRETE, STEEL, MILLWORK & SIGNAGE, SAMPLES OF ALL PROPOSED PAINTS, METALS, WALL COVERINGS, LAMINATES, SOLID SURFACE MATERIALS, CERAMIC TILE, AND HARDWARE. SUBMIT MANUFACTURERS' DATA FOR ALL LIGHTING SYSTEMS, AND HARDWARE.
- PERMITS:** THE GENERAL CONTRACTOR SHALL OBTAIN AND PAY FOR ANY BUILDING PERMITS REQUIRED AND CARRY ANY INSURANCE COVERAGES REQUIRED.
- INTERIOR FINISHES:** ALL INTERIOR FINISHES AND FURNISHINGS ARE TO BE CLASS 'A' FIRE-RATED AND ARE TO COMPLY WITH SECTION 920.0 BOCCA (INTERIOR FLAME SPREAD).
- ELECTRICAL DESIGN:** REFER TO ELECTRICAL DRAWINGS AND SPECIFICATIONS
- WASTE REMOVAL:** THE GENERAL CONTRACTOR SHALL DISPOSE OF ALL WASTE AND DEBRIS OFF THE PREMISES.
- TEMPORARY FACILITIES:** PROVIDE ALL TEMPORARY FACILITIES AND SERVICES, CONSTRUCTION AND SUPPORT FACILITIES, AND SECURITY AND PROTECTION AS NEEDED TO PROTECT NEW AND EXISTING CONSTRUCTION FOR THE DURATION OF A COMPLETE INSTALLATION.
- FINAL CLEANING:** EMPLOY EXPERIENCED WORKERS FOR FINAL CLEANING. CLEAN EACH SURFACE TO THE CONDITION EXPECTED IN A COMMERCIAL BUILDING CLEANING PROGRAM.
- MANUFACTURERS INSTRUCTIONS:** ALL MATERIALS & EQUIPMENT SHALL BE INSTALLED ACCORDING TO MANUFACTURER'S SPECIFICATIONS.
- GUARANTEE:** ALL MATERIALS AND WORKMANSHIP SHALL BE GUARANTEED FOR A PERIOD OF ONE YEAR FROM THE DATE OF FINAL ACCEPTANCE UNLESS OTHERWISE SPECIFIED FOR A LONGER PERIOD OF TIME ON A CERTAIN ITEM.
- ASBESTOS:** ALL MATERIAL USED FOR THE CONSTRUCTION OF THIS PROJECT, WHETHER BUILDING MATERIALS OR APPURTENANCES, SHALL BE NON-ASBESTOS CONTAINING MATERIAL.
- HAZARDOUS FUMES:** THE GENERAL CONTRACTOR SHALL CONFIRM THAT ALL MATERIAL AND FINISHES SPECIFIED AND THEIR FABRICATION OR INSTALLATION WILL NOT RELEASE FUMES OR AROMAS DURING CONSTRUCTION WHICH MAY BE A HAZARD OR NUISANCE TO PERSONNEL.
- PEST CONTROL:** SEAL AND CAULK AROUND ALL PENETRATIONS, CRACKS AND CREVICES AND ANY OPENINGS CAPABLE OF HARBORING INSECTS/RODENTS.
- EXPOSED UTILITIES:** ALL EXPOSED UTILITY WIRES AND PIPES (ELECTRICAL, PLUMBING, ETC.) SHALL BE INSTALLED IN A WAY THAT DOES NOT OBSTRUCT OR PREVENT THE CLEANING OF FLOORS, WALLS, AND CEILING AREAS. THEY SHALL BE INSTALLED A MINIMUM OF 6" OFF FLOORS AND 1" OFF WALLS, CEILINGS AND ADJACENT PIPES.
- OWNER SUPPLIED EQUIPMENT:** EQUIPMENT SUPPLIED BY THE OWNER AND INSTALLED BY THE GENERAL CONTRACTOR. EQUIPMENT INFORMATION AND SPECIFICATIONS ARE TO BE THE MOST CURRENT AVAILABLE AT THE TIME OF DOCUMENTATION PREPARATION. THE GENERAL CONTRACTOR SHALL BE RESPONSIBLE FOR VERIFYING WITH THE OWNER THE EXACT DIMENSIONS AND EQUIPMENT CONNECTION REQUIREMENTS (INCLUDING ELECTRICAL CIRCUIT REQUIREMENTS) OF EQUIPMENT TO BE SUPPLIED. THE GENERAL CONTRACTOR SHALL MAKE ALL FINAL CONNECTIONS AS NOTED ON THE DRAWINGS, INSTALL THE SET UP IN WORKING ORDER, CHECK WARRANTIES, TEST AND NOT VOID WARRANTIES. THE GENERAL CONTRACTOR SHALL COORDINATE WITH THE OWNER DELIVERY, STORAGE AND INSTALLATION OF ALL OWNER SUPPLIED EQUIPMENT. THE GENERAL CONTRACTOR SHALL STORE EQUIPMENT IF REQUESTED BY THE OWNER UNTIL INSTALLATION. SEE DRAWINGS FOR OTHER OWNER SUPPLIED GENERAL CONTRACTOR INSTALLED ITEMS.
- SOILS AT FOOTINGS:** REPORT THE LOCATION OF ALL UNSUITABLE SOILS AND MATERIALS BELOW ANTICIPATED LEVEL OF FOOTING TO THE ARCHITECT PRIOR TO THE SETTING OF FORMS.
- ACCESS PANELS:** CONTRACTOR IS RESPONSIBLE FOR COORDINATING QUANTITY AND LOCATION OF ALL REQUIRED ACCESS PANELS FOR ALL MEP CONTROLS, CLEANOUTS, DAMPERS, PULL BOXES, ETC.
- EXISTING HAZARDOUS MATERIALS** ALL HAZARDOUS MATERIALS INCLUDING BUT NOT LIMITED TO ASBESTOS AND LEAD PAINT ARE TO BE HANDLED, ENCAPSULATED, ABATED AND DISPOSED OF IN ACCORDANCE WITH ANY AND ALL FEDERAL, STATE AND LOCAL REQUIREMENTS AND REGULATIONS.
- INDUSTRY STANDARDS:** ALL WORK SHALL BE PERFORMED IN ACCORDANCE WITH INDUSTRY STANDARDS. STANDARDS INCLUDE BUT ARE NOT LIMITED TO THE FOLLOWING:

AAMA	AMERICAN ARCHITECTURAL MANUFACTURERS ASSOCIATION
ACI	AMERICAN CONCRETE INSTITUTE
ANSI	AMERICAN NATIONAL STANDARDS INSTITUTE
ASTM	AMERICAN SOCIETY FOR TESTS AND MATERIALS
AWI	ARCHITECTURAL WOODWORK INSTITUTE
AWS	AMERICAN WELDING SOCIETY
IGMA	INSULATING GLASS MANUFACTURERS ALLIANCE
NAAMM	NATIONAL ASSOCIATION OF ARCHITECTURAL METAL MANUFACTURERS
NRCA	NATIONAL ROOFING CONTRACTORS ASSOCIATION
NTCA	NATIONAL TILE CONTRACTORS ASSOCIATION
SMACNA	SHEET METAL AND AIR CONDITIONING NATIONAL ASSOCIATION
WDMA	WINDOW AND DOOR MANUFACTURERS ASSOCIATION

ABBREVIATIONS

A AC	AIR CONDITIONING	L LAB	LABORATORY
AD	ACOUSTICAL CEILING TILE	LAM	LAMINATED
ADAAG	AREA DRAIN	LD	LEAD
ADD	AMERICANS WITH DISABILITIES ACT	LH	LEFT-HAND
ADDENDUM	ACCESSIBILITY'S GUIDELINES	LCC	LEAD COATED COPPER
ADD	ABOVE FINISHED FLOOR	M MACH	MACHINE
AFF	AIR-HANDLING UNIT	MAS	MASONRY
AHJ	ALUMINUM	MAT	MATERIAL
ARCH	ARCHITECT/ARCHITECTURAL	MAX	MAXIMUM
AWP	ACOUSTIC WALL PANEL	MDO	MEDIUM DENSITY OVERLAY
B TO BLS	BACK-TO-BACK ANGLES	MECH	MECHANICAL
B.B.G.C.	BASE BUILDING GENERAL CONTRACTOR	MEMB	MEMBRANE
BLDG	BUILDING LINE	MET	METAL
BLKG	BLOCKING	MAN	MANUFACTURER
BSMT	BASEMENT	MIN	MINIMUM
BTWN	BETWEEN	MISC	MISCELLANEOUS
BO	BY OTHERS	MO	MASONRY OPENING
C	COURSE (MASONRY)	MTL	MOUNTED
CER	CERAMIC	NL	NITEL
CG	CORNER GUARD	NB	NORTH
CH	COAT HOOK	N#	NUMBER
CJ	CONTROL JOINT	NI	NOT IN CONTACT
CL	CENTER LINE	NOM	NOMINAL DIMENSION
CLG	CEILING	NTS	NOT TO SCALE
CMU	CONCRETE MASONRY UNIT	O	ON/OVER
CO	COLUMN	OC	ON CENTER
CONC	CONCRETE	OD	OUTSIDE DIAMETER/OUTSIDE DIMENSION
COND	CONDITION	OFF	OFFICE
CONN	CONNECT/CONNECTION	OPNG	OPENING
CONSTR	CONSTRUCTION	OPST	OPPOSITE
CONT	CONTINUOUS	OPH	OPPOSITE HAND
CORR	CORRIDOR	OSB	ORIENTED STRAND BOARD
CT	CERAMIC TILE	OZ	OUNCE
CUH	CABINET UNIT HEATER	P	PURCHASED BY OWNER INSTALLED BY CONTRACTOR
D	DOUBLE	PC	PRECAST
DBL	DRINKING FOUNTAIN	PLAM	PLASTIC LAMINATE
DI	DIAMETER	PR	PREFABRICATE
DIFF	DIFFUSER	PRIV	PRIVACY
DIM	DIMENSION	PRIM	PRIMED
DN	DOWN	PSF	POUNDS PER SQUARE FOOT
DR	DR	PTD	PAINTED
DSP	DRY STAND PIPE	PTN	PARTITION
DWG	DRAWING	PVC	POLYVINYL CHLORIDE
E	EAST	PWD	PLYWOOD
EA	EACH	PT	PRESSURE TREATED
ELEV	ELEVATION	PERF	PERFORATED
ELEC	ELECTRICAL	Q	QUARRY TILE
ELEVATOR	ELEVATOR	QTR	QUARTER
ENTR	ENTRANCE	R	RISER/RADIUS
EQUIP	EQUIPMENT	RB	RADIUS
EXP	EXPANSION	RAD	RUBBER BASE
EXPB	EXPANSION BOLT	RCP	REFLECTION GELLING PLAN
EXPJ	EXPANSION JOINT	RD	ROOF DRAIN
EXT	EXTERIOR	REBAR	REINFORCING BAR
EPDM	ETHYLENE PROPYLENE DIENE MONOMER	REF	REFRIGERATOR
EW	ELECTRIC WATER COOLER	REINF	REINFORCED
F	FAHRENHEIT	REQ	REQUIRED
FB	FLAT BAR	RES	RESILIENT
FD	FIRE EXTINGUISHER AND CABINET	REV	REVERSE
FE	FIRE EXTINGUISHER	RM	ROOM
FEC	FIRE EXTINGUISHER CABINET	ROW	ROUGH OPENING
FTWD	FIRE TREATED WOOD	ROW	RIGHT OF WAY
FIN	FINISH	S	SOUTH
FL	FLOOR	SCHED	SCHEDULE
FB	FACE OF BRICK	SF	SQUARE FEET
FOC	FACE OF CONCRETE	SM	SIMILAR
FOF	FACE OF FINISH	SPEC	SPECIFICATION
FOS	FACE OF STUDS	SQ	SQUARE
FOW	FACE OF WALL	ST	STAINLESS STEEL
FS	FIRE SUPPRESSION SYSTEM	STD	STANDARD
FT	FOOT	STL	STEEL
FTG	FOOTING	STOR	STORAGE
FRG	FIBER REINFORCED GYPSUM	STRUC	STRUCTURE/STRUCTURAL
FTR	FIN TUBE RADIATION	SUSP	SUSPENSION
FHM	FUME HOOD	T	TONGUE/GROOVE
G	GAUGE	TEL	TELEPHONE
GALV	GALVANIZED	THK	THICK
GB	GRAB BAR	TOD	TOP OF DECK
GC	GENERAL CONTRACTOR	TOS	TOP OF STEEL
GFI	GROUND-FAULT INTERRUPTER	TYP	TYPICAL
GL	GLASS/LAMINATED GLAZED	TV	TELEVISION
GLAM	GLUE LAMINATED WOOD	TACK	TACK BOARD
GND	GROUND	TOC	TOP OF CONCRETE
GWB	GYPSUM WALL BOARD	U	UNDERWRITERS LABORATORIES, INC.
H	HANDICAP	UV	UNIT VENTILATOR
HB	HOSE BIB	V	VCT
HC	HANDICAP	VCT	VINYL COMPOSITION TILE
HM	HOLLOW METAL	VER	VERTICAL
HORIZ	HORIZONTAL	VIF	VERIFY IN FIELD
HR	HORSE POWER/HIGH POINT/HEAT PUMP	VOL	VOLUME
HW	HOT WATER	W	WEST
HVAC	HEATING VENTILATION AIR CONDITIONING	W/O	WITHOUT
I	INSIDE DIMENSION/INSIDE DIAMETER	W	WOOD
ID	INCHES	WF	WIDE FLANGE
IN	INFORMATION	WP	WORK POINT
INSUL	INSULATION	WT	WEIGHT
J	JOIST		
JT	JOINT		
K	KILN-DRIED		
KIP	1000 POUNDS		

FIRESTOPPING DETAILS

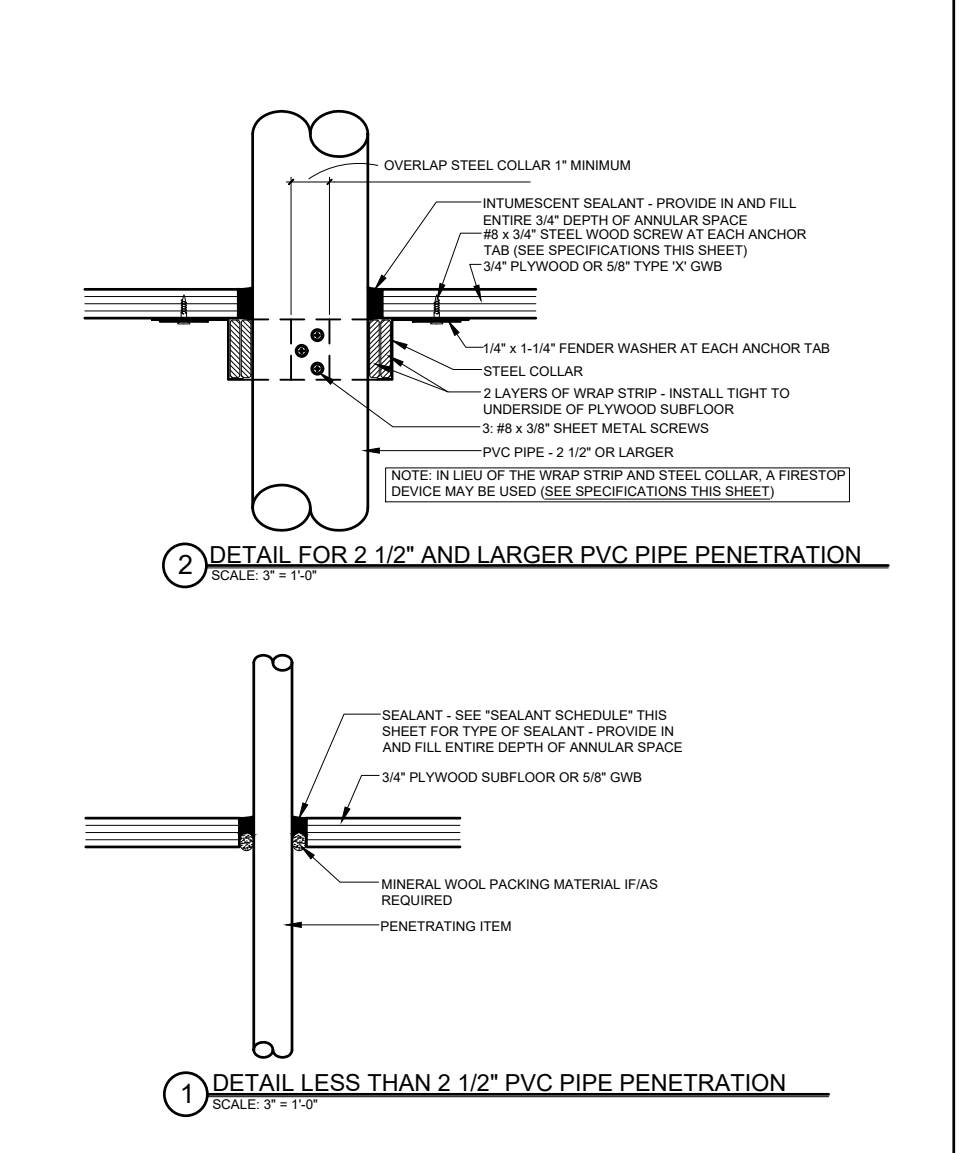

SPECIFICATIONS

WRAP STRIP: 1/4" THICK x 1 1/2" MINIMUM WIDTH INTUMESCENT MATERIAL WITH PLASTIC FILM FACINGS BOTH SIDES. TEMPORARILY SECURE WITH MAKING TAPE. SPECIFIED TECHNOLOGIES INC. (STI) "SpecSeal RED Wrap Strip" OR "SpecSeal BLU Wrap Strip" OR EQUAL.

STEEL COLLAR: WRAP STRIP MANUFACTURER'S STEEL COLLAR, FABRICATED FROM .016 INCH THICK GALVANIZED SHEET STEEL. WIDTH TO MATCH WRAP STRIP (1 1/2" MINIMUM), WITH 1 INCH x 2 INCH ANCHOR TABS AND RETAINER TABS. ANCHOR TABS TO BE SYMMETRICALLY OPPOSED AROUND COLLAR; PROVIDE 3 TABS FOR 2 1/2" AND 3" PIPE; PROVIDE 4 TABS FOR 4" PIPE.

INTUMESCENT SEALANT: ONE-PART, INTUMESCENT, LATEX ELASTOMER TESTED TO ASTM E 814. MINIMUM EXPANSION OF 3x AT 1000°F. 3M "FIRE BARRIER SEALANT" OP 25WB+ OR EQUAL.

FIRESTOP SEALANT: SINGLE COMPONENT NONCOMBUSTIBLE FIRE RATED SEALANT TESTED TO ASTM E 814. TESTED TO 3000°F. "BOSS 138 FIRESTOP/DRAFT SEALANT" MANUFACTURED BY ACCUMETRIC, LLC, OR EQUAL.

SEALANT SCHEDULE:
INTUMESCENT SEALANT: PROVIDE AT ALL PENETRATIONS THROUGH RATED CONSTRUCTION FOR PENETRATING ITEMS INCLUDING BUT NOT LIMITED TO: PVC PIPE; ROOF LEADER PIPES; GAS PIPES & LINES; SPRINKLER PIPES; ELECTRICAL & COMMUNICATIONS CABLES & WIRES; AND ALARM SYSTEM WIRES. DO NOT USE INTUMESCENT SEALANT AT DOMESTIC HOT WATER OR HYDRONIC HEATING SYSTEM PIPES.
FIRESTOP SEALANT: PROVIDE AT ALL PENETRATIONS THROUGH RATED CONSTRUCTION FOR PENETRATING ITEMS INCLUDING DOMESTIC HOT AND COLD WATER PIPES AND HYDRONIC HEATING SYSTEM PIPES.

NOTE:
 FOR LOCATIONS OF RATED CONSTRUCTION, SEE ARCHITECTURAL FLOOR PLANS AND SECTIONS.

DRAWING LEGEND

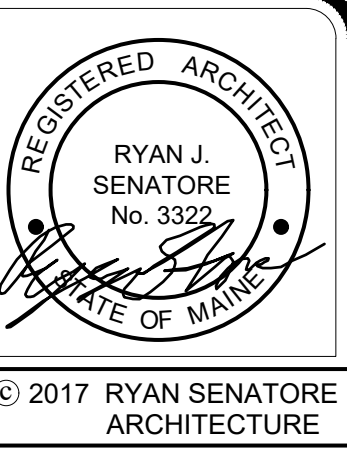
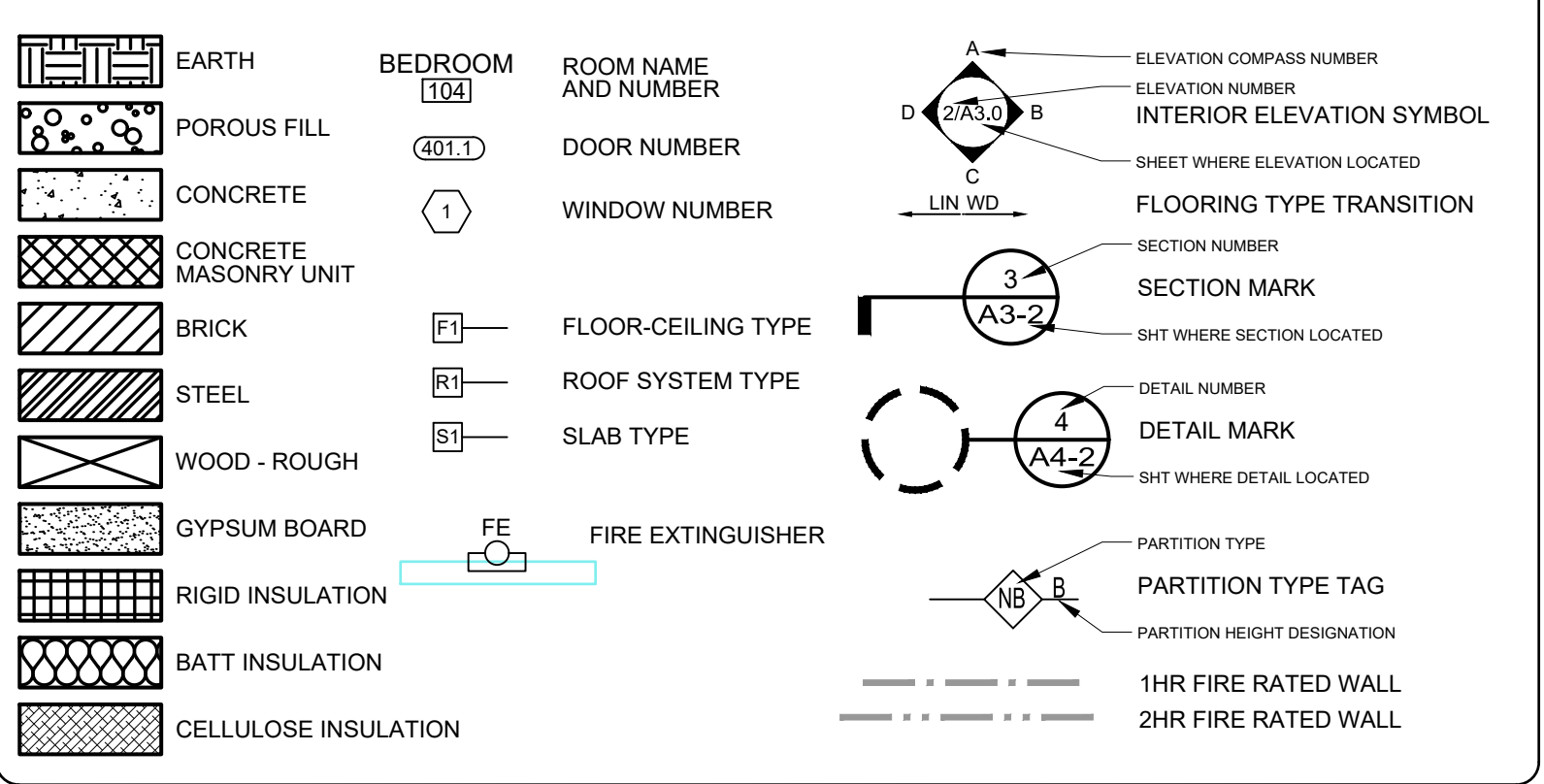

© 2017 RYAN SENATORE ARCHITECTURE

93 WASHINGTON AVE.
PORTLAND, MAINE



RYAN SENATORE ARCHITECTURE

CONSULTANTS:

REVISIONS:

DATE: JULY 22, 2017

PROJECT No. 1626

DRAWN BY: RJS / RRT

CHECKED BY: RJS

SCALE: AS NOTED

SHEET TITLE:
GENERAL NOTES AND ABBREVIATIONS

G1-0