

GENERAL NOTES:

- CONTRACTOR SHALL PLACE CATCH BASIN INLET PROTECTION ON CATCH BASINS AND FIELD INLETS DOWN-GRADE OF ALL NON-STABILIZED SURFACES, PER DETAIL.
- LOCATION OF PROPOSED SEDIMENTATION BARRIER IS INDICATED ON PLAN. CONTRACTOR TO ENSURE THAT SEDIMENTATION BARRIER IS INSTALLED ALONG THE DOWN-GRADE LOCATION OF DISTURBANCE, PER DETAIL.
- CONTRACTOR SHALL INSTALL CONSTRUCTION ENTRANCE AT ALL LOCATIONS OF INGRESS AND EGRESS DURING CONSTRUCTION TO THE SITE. SEE DETAIL.
- CURB TO BE REMOVED, STOCKPILED AND RESET IN ACCORDANCE WITH DETAIL. BROKEN CURB SHALL BE PROPERLY DISPOSED OF AND SHALL BE REPLACED AT THE CONTRACTOR'S EXPENSE.
- CONTRACTOR SHALL ENSURE THAT FOUNDATION DRAINS AND UNDERDRAINS ARE CONSTRUCTED WITH POSITIVE OUTLET TO PROPOSED CONNECTIONS.
- RIPRAP SLOPE TO BE PLACE IN ALL AREAS WITH A SLOPE GREATER THAN 2H:1V.
- ALL WORK WITHIN THE CITY STREET RIGHT OF WAY SHALL MEET CITY OF PORTLAND TECHNICAL MANUAL STANDARDS.
- REFER TO STRUCTURAL PLANS FOR FOUNDATION AND SUB-CONTAINER CONSTRUCTION REQUIREMENTS.

PROPOSED STRUCTURE SCHEDULE				
STRUCTURE	DIAMETER	RIM	INV. IN	INV. OUT
DC-1	6"	70.00'	-	66.47'
DC-2	6"	70.00'	-	66.40'
FI-1	6"	70.40'	-	66.44'
FI-2	6"	70.25'	66.20'	66.20'
FI-3	6"	70.75'	66.11'	66.11'

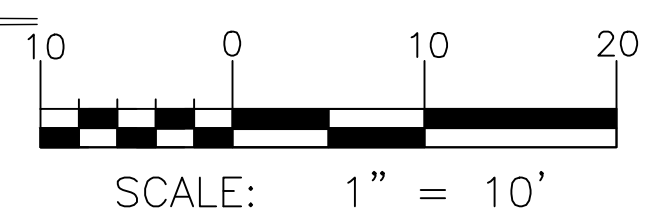
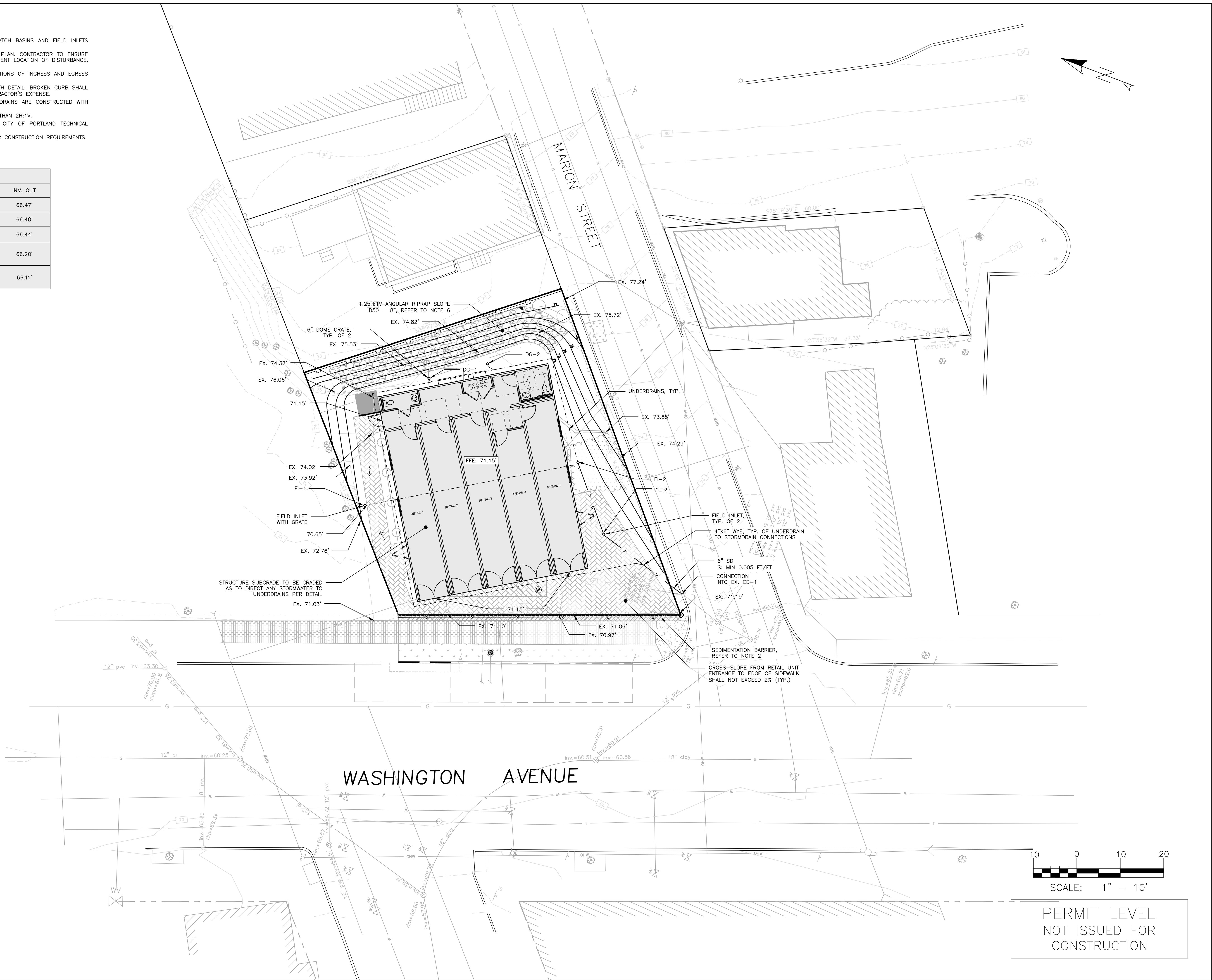

PERMIT LEVEL
NOT ISSUED FOR
CONSTRUCTION

ISSUED FOR	BY
FINAL APPLICATION	WHS
BUILDING PERMIT	WHS

DRAWING NAME: **GRADING, DRAINAGE, & EROSION CONTROL PLAN**
 PROJECT NAME: **THE BLACK BOX AT 93 WASHINGTON**
 CLIENT: **COTTON STREET HOLDINGS, LLC**
 75 WASHINGTON AVE SUITE 2H PORTLAND, ME 04101

A C C O R N
ENGINEERING, INC.

ACCORN ENGINEERING, INC. IS AN EQUAL OPPORTUNITY EMPLOYER. ALL RIGHTS RESERVED. FROM ACCORN ENGINEERING, INC. ANY REPRODUCTION, TRANSMISSION OR DISTRIBUTION WITHOUT WRITTEN PERMISSION IS STRICTLY PROHIBITED. 158 BANKFOUN ST. PORTLAND, MAINE 04102 (207) 775-2655

FILE: CIVIL_1073
 JN: 1073
 SCALE: 1"=10"
 DESIGNED BY: WHS
 DRAWN BY: OJD
 CHECKED BY: WHS

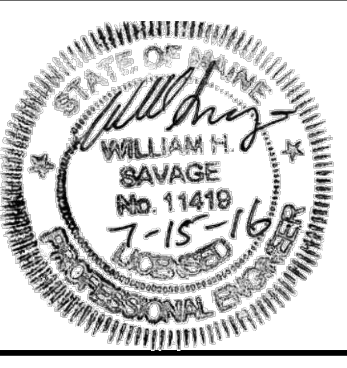

DRAWING NO.
C-30